

CIVIL CONSTRUCTION PLANS

LAKEVIEW SUMMIT

PHASE ONE

NATHAN BUTLER SURVEY, ABSTRACT NO. 21
 CITY OF ROCKWALL
 ROCKWALL COUNTY, TEXAS
 34.839 ACRES

GENERAL NOTES
 (APPLICABLE TO ALL SHEETS)

- Excavated material shall be placed as directed by the Owner.
- Construction shall meet the requirements of the latest revision of the Standards of Design and Standard Details for the City of Rockwall.
- All fill areas to be density controlled and compacted to 95% density at optimum moisture content.
- Pavement thickness shall be a minimum of 6" thickness with a strength of 3600 psi at 28 days and reinforced with No.3 bar at 24" centers each way.
- All streets shall be constructed with min. 6% lime stabilized subgrade compacted to 95% standard proctor density, lime series needs to be performed to verify.
- It shall be the responsibility of the Contractor to locate and verify all existing utilities prior to the beginning of construction to insure no conflicts between all utility lines.
- Where water pipelines either cross or otherwise come within 9 feet of a sanitary sewer pipeline, the sewer pipeline shall be with a minimum working pressure Class 150 psi.
- All water lines installed to be PVC pipe Class 200 conforming to AWWA Standard C-900, fitting shall be mechanical or O-ring.
- All water lines are to be installed a minimum of 48" deep measured from top of pipe.
- All storm inlets shall be cast-in-place.
- Utility contractor shall use MEGALUGS when install the water line and double strap services when installing the services.
- Water services shall be a minimum of 1" schedule 40 polyethylene pipe installed with two in-line nylon ball cutoff valves inside the meter box. Corporation cock shall be Mueller No. H-15000 w/ straight coupling nut or approved equal. Curb stops shall be Mueller No. H-15174 MK orisreal or approved equal.
- All water lines shall be pressure tested and disinfected in accordance with AWWA C 601.
- All gate valves shall be Mueller or approved equal and conform to AWWA C-500 specifications. All gate valves shall be iron body, bronze mounted, double disk, parallel seat, non-rising stem, internal wedging type.
- All fire hydrants shall be located 2' to 6' behind curb line. All fire hydrants shall be Mueller or approved equal.

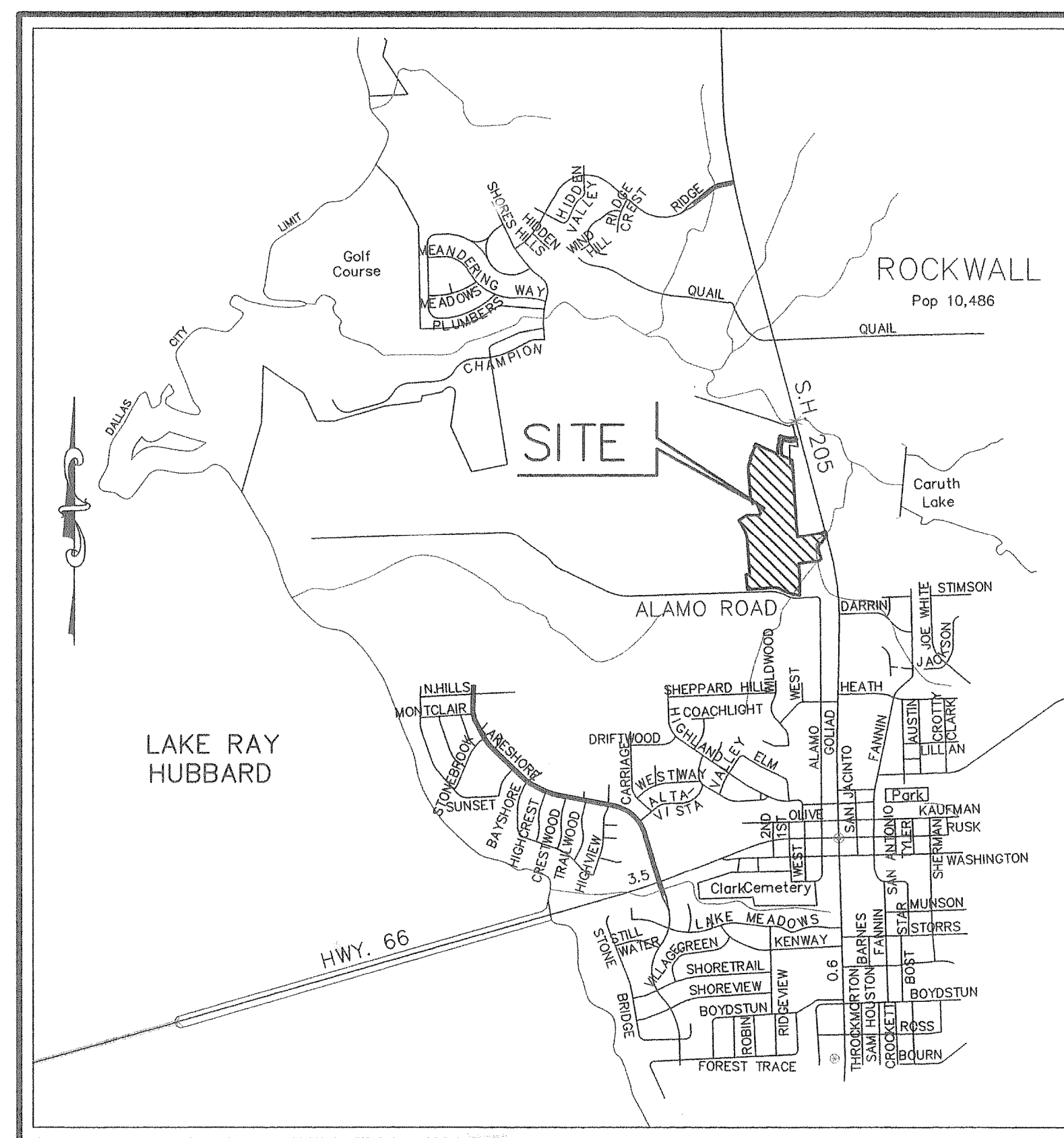

VICINITY MAP

SHEET INDEX

- | | |
|---|--|
| 1. COVER SHEET | 26. PAVING PLAN & PROFILE-ALLEY X
STA 8+90.30 TO 14+70.99 |
| 2. FILE PLAT | 27. PAVING PLAN & PROFILE-
JOGGING TRAIL |
| 3. FILE PLAT | 27A. S.H. 205 TURN LANES-NORTH |
| 4. FILE PLAT | 27B. S.H. 205 TURN LANES-SOUTH |
| 5. DRAINAGE AREA MAP | 28. WATER PLAN |
| 5A. DRAINAGE AREA MAP-PHASE ONE | 29. SANITARY SEWER PLAN |
| 6. GRADING PLAN-PHASE ONE | 30. SANITARY SEWER PROFILE
LINES C, D & D-1 |
| 6A. GRADING PLAN-PHASE ONE | 31. SANITARY SEWER PROFILE
LINES E, F, G & H |
| 6B. GRADING PLAN-PHASE ONE | 32. SANITARY SEWER PROFILE
LINE I |
| 6C. RETAINING WALL PLAN | 33. STORM PLAN & PROFILE
LINE B |
| 6D. RETAINING WALL PROFILE | 34. STORM PLAN & PROFILE
LINES C & D |
| 6E. TEMPORARY DITCH PROFILE | 35. STORM PLAN & PROFILE
LINES E & F |
| 7. GRADING PLAN W/TREES-PRELIMINARY OFFSITE | 36. STORM PLAN & PROFILE
LINES G, H & I |
| 8. GRADING PLAN W/TREES-PRELIMINARY OFFSITE | 37. STORM PLAN & PROFILE
LINE J |
| 9. GRADING PLAN W/TREES-PRELIMINARY OFFSITE | 38. STORM PLAN & PROFILE
LINE K & DETENTION POND |
| 10. TREE PLAN-PHASE ONE | 39. STORM PLAN & PROFILE
LINE L |
| 11. PAVING PLAN & PROFILE-CALISTOGA
STA 0+00 TO 11+00 | 40. STORM PLAN & PROFILE
LINES M & N |
| 12. PAVING PLAN & PROFILE-CALISTOGA
11+00 TO 22+39.66 | 40A. STORM PLAN & PROFILE
LINE O |
| 13. PAVING PLAN & PROFILE-BERKELEY
STA 7+67.07 TO 10+79.00 | 40B. DETENTION POND CALCULATIONS |
| 14. PAVING PLAN & PROFILE-FREMONT
STA 4+49.33 TO 9+08.66 | 41. EROSION CONTROL PLAN |
| 15. PAVING PLAN & PROFILE-SAUSALITO
STA 14+85.84 TO 1944.01 | 41A. LANDSCAPING PLANS |
| 16. PAVING PLAN & PROFILE-GEARY
STA 19+27.36 TO 25+24.39 | 41B. LANDSCAPING PLANS |
| 17. PAVING PLAN & PROFILE-MONTERREY
STA 16+51.01 TO 24+30.77 | 41C. LANDSCAPING PLANS |
| 18. PAVING PLAN & PROFILE-SALINAS
STA 0+00 TO 6+93.31 | 42. EROSION CONTROL DETAILS |
| 19. PAVING PLAN & PROFILE-HAYWARD
STA 0+00 TO 5+31.11 | 43. DETAILS |
| 20. PAVING PLAN & PROFILE-LOS ALTOS
STA 0+00 TO 7+22.58 | |
| 21. PAVING PLAN & PROFILE-N. ALAMO
STA 16+00 TO 27+69.33 | |
| 22. PAVING PLAN & PROFILE-ALLEY K
STA 0+00 TO 6+51.94 | |
| 23. PAVING PLAN & PROFILE-ALLEY L
STA 0+00 TO 4+24.53 | |
| 24. PAVING PLAN & PROFILE-ALLEY O
STA 0+00 TO 6+21.24 | |
| 25. PAVING PLAN & PROFILE-ALLEY N
STA 0+00 TO 7+70.95 | |

RECORD DRAWINGS:

THE INTENT OF THE OWNER AND ENGINEER WAS TO CONSTRUCT THESE FACILITIES ACCORDING TO THESE PLANS AS APPROVED BY THE CITY OF Rockwall. THE LINES AND GRADES WERE SET ON THE GROUND FOR CONSTRUCTION ACCORDING TO SAID PLANS. THE CITY OF Rockwall INSPECTED THE CONSTRUCTION. THE OWNER NOR ENGINEER DID NOT VERIFY LINES OR GRADES AFTER CONSTRUCTION. WE ARE NOT AWARE OF ANY CHANGES OR REVISIONS TO THESE PLANS DURING CONSTRUCTION EXCEPT AS NOTED

NOTE: CONTRACTOR TO VERIFY IN THE FIELD THE LOCATION OF ALL EXISTING UTILITIES PRIOR TO CONSTRUCTION. INFORMATION PROVIDED WITHIN THESE PLANS DOES NOT RELIEVE THE CONTRACTOR OF THE FULL AND TOTAL RESPONSIBILITY FOR THE PROTECTION OF EXISTING UTILITIES NOR ANY DAMAGES CAUSED BY SAID CONTRACTOR DURING CONSTRUCTION.

BENCHMARK:

BRASS CAP MONUMENT NO. 10 SET IN CONCRETE IN THE CENTER OF GRASS MEDIAN IN MASTERS DRIVE BETWEEN NORTH LAKESHORE & SHORES BLVD.
 N 7032464.6317, E 2589554.1518
 ELEV. = 524.62

OWNER/DEVELOPER:
PULTE HOMES OF TEXAS, L.P.
 1431 GREENWAY DRIVE, SUITE 700
 IRVING, TEXAS 75038
 (972) 751-1499

DOUPHRATE & ASSOCIATES, INC.
 ENGINEERING • PROJECT MANAGEMENT • SURVEYING
 P.O. BOX 1336 ROCKWALL, TEXAS 75087
 PHONE: (972)771-9004 FAX: (972)771-9005

THE SEAL APPEARING ON THIS DOCUMENT WAS AUTHORIZED BY W.L. DOUPHRATE II TEXAS, P.E. NO. 60102 ON 7/10/00

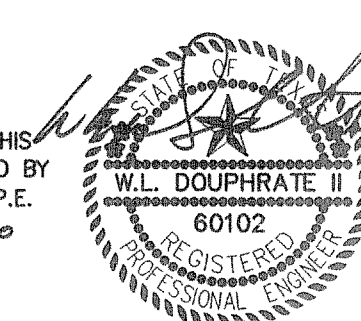

FEBRUARY 2000