

STORM SEWER CURVE DATA				
CURVE NO.	①	②		
Δ	32° 04' 43"	0	'	"
R	175.00'			
T	50.31'			
L	97.98'			

NOTE:
STORM SEWER OUTFALL AREA TO BE GRASS SEEDED AND MAINTAINED.

BENCHMARKS:
"□" found on the top of curb of the northwest corner of railroad bridge @ Village Drive.
ELEVATION = 506.23

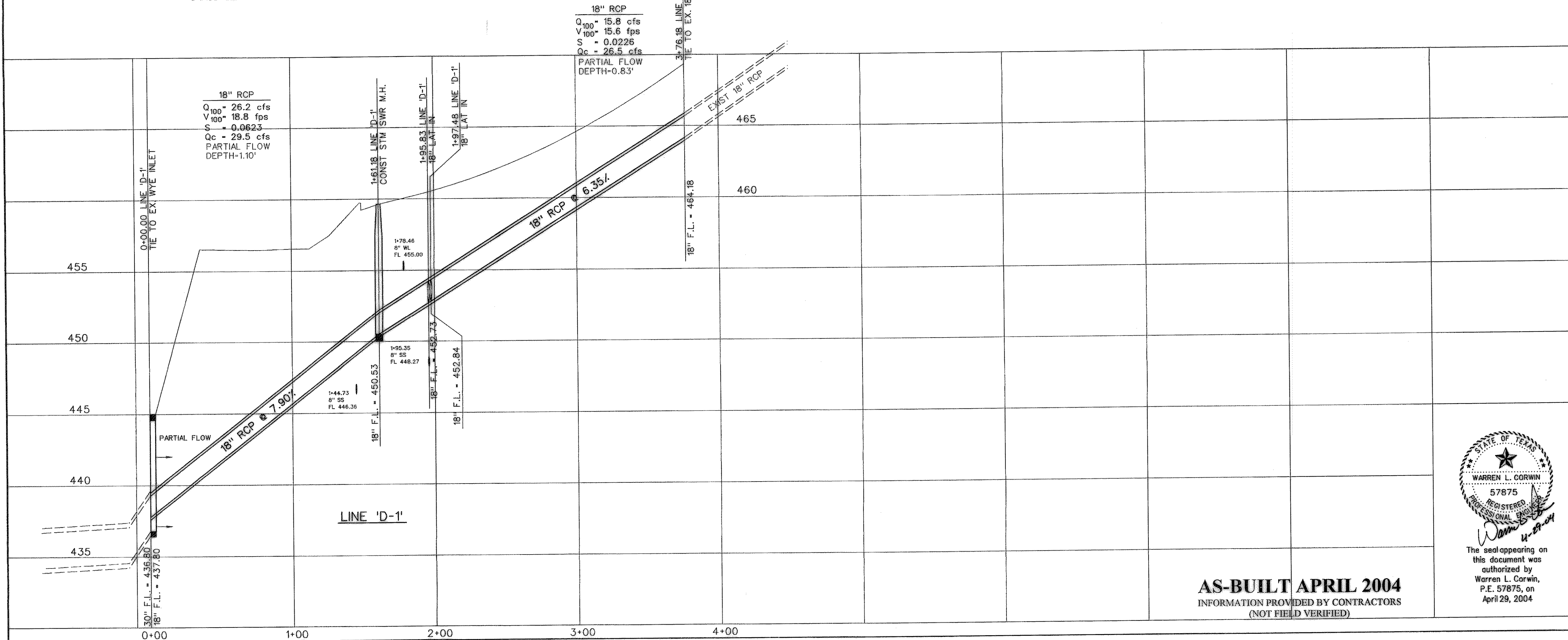

1	PER CITY COMMENTS	CEI	6-18-02
NO.	REVISIONS	BY	DATE

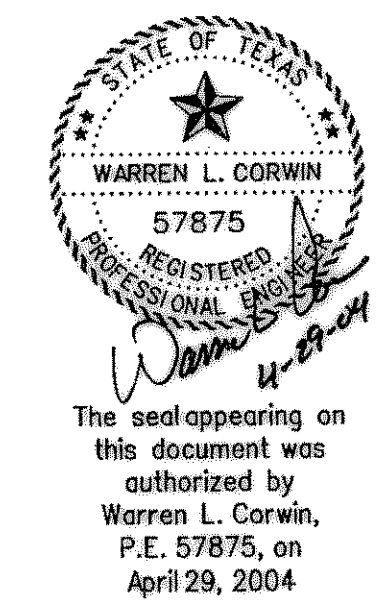

CORWIN ENGINEERING, INC.
200 W. BELMONT SUITE E
ALLEN, TEXAS 75013 (972) 396-1200

DEVELOPMENT PLANS FOR LAKESIDE VILLAGE PHASE V-C
ROCKWALL, TEXAS

STORM SEWER PLAN AND PROFILE
LINES 'D-1'

AS-BUILT APRIL 2004
INFORMATION PROVIDED BY CONTRACTORS
(NOT FIELD VERIFIED)

DRAWN BY RDS	DESIGNED BY CEI	CHECKED BY CEI	SHEET NO. 8 OF 13
JOB NUMBER 0209	DATE MARCH 2003	SCALE: 1"=4' V 1"=40' H	