

0+00 1+00 2+00 3+00 4+00 5+00 6+00 7+00 8+00

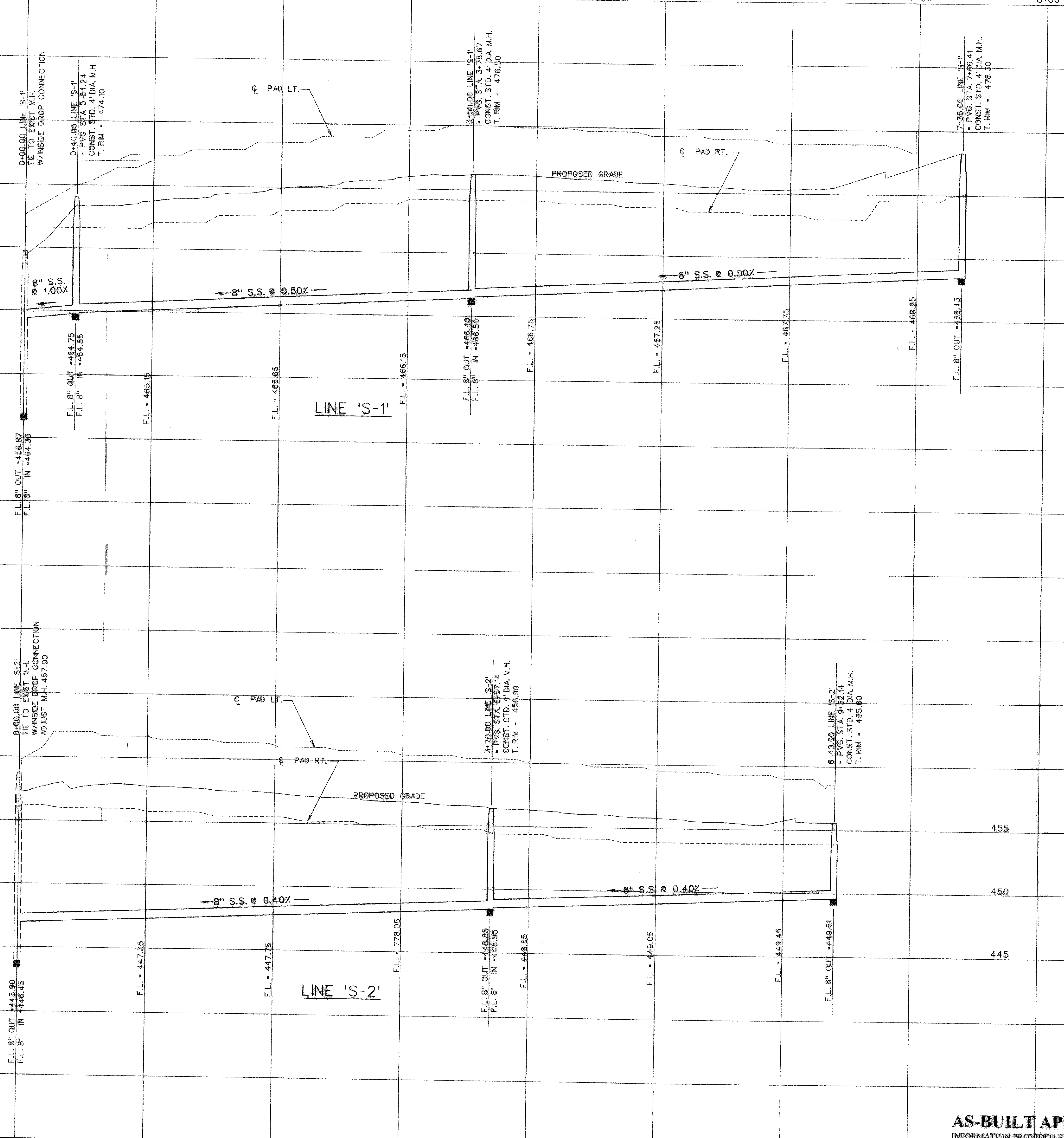

0+00 1+00 2+00 3+00 4+00 5+00 6+00 7+00 8+00

1	PER CITY COMMENTS	CEI	8-18-02
NO.	REVISIONS	BY	DATE

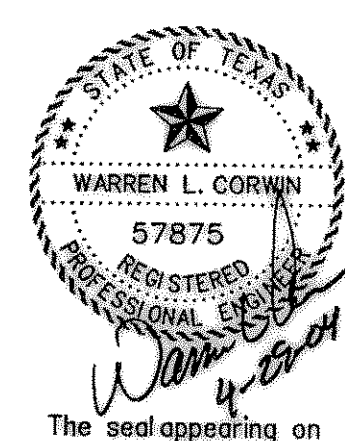

The seal appearing on this document was authorized by  
 Warren L. Corwin,  
 P.E. 57875, on  
 April 29, 2004

**CORWIN ENGINEERING, INC.**  
 200 W. BELMONT, SUITE E  
 ALLEN, TEXAS 75013 (972) 396-1200

**DEVELOPMENT PLANS FOR  
 LAKESIDE VILLAGE  
 PHASE V-C  
 ROCKWALL, TEXAS**

SANITARY SEWER PROFILES

**AS-BUILT APRIL 2004**  
 INFORMATION PROVIDED BY CONTRACTORS  
 (NOT FIELD VERIFIED)

DRAWN BY CMF	DESIGNED BY CEI	CHECKED BY WLC	SHEET NO. 7 OF 13
JOB NUMBER 0209	DATE MARCH 2003	SCALE: 1"=4' V 1"=40' H	