

LOCAL RESIDENTIAL  
N.T.S.

0+80.00 TIE TO EX. PVMT LT  
TC 508.24

PVG STA 4+15.89  
CONST. 10' CURB INLET  
T.C. 500.62  
F.L. 496.62

CONST. 8 L.F. 4' CONC.  
POSITIVE OVERFLOW

3.84.85 TAHOE DR.  
TP 501.00

BENCHMARKS:  
"□" found on the top of curb of the northwest  
corner of railroad bridge @ Lakeside Drive.  
ELEVATION = 506.23

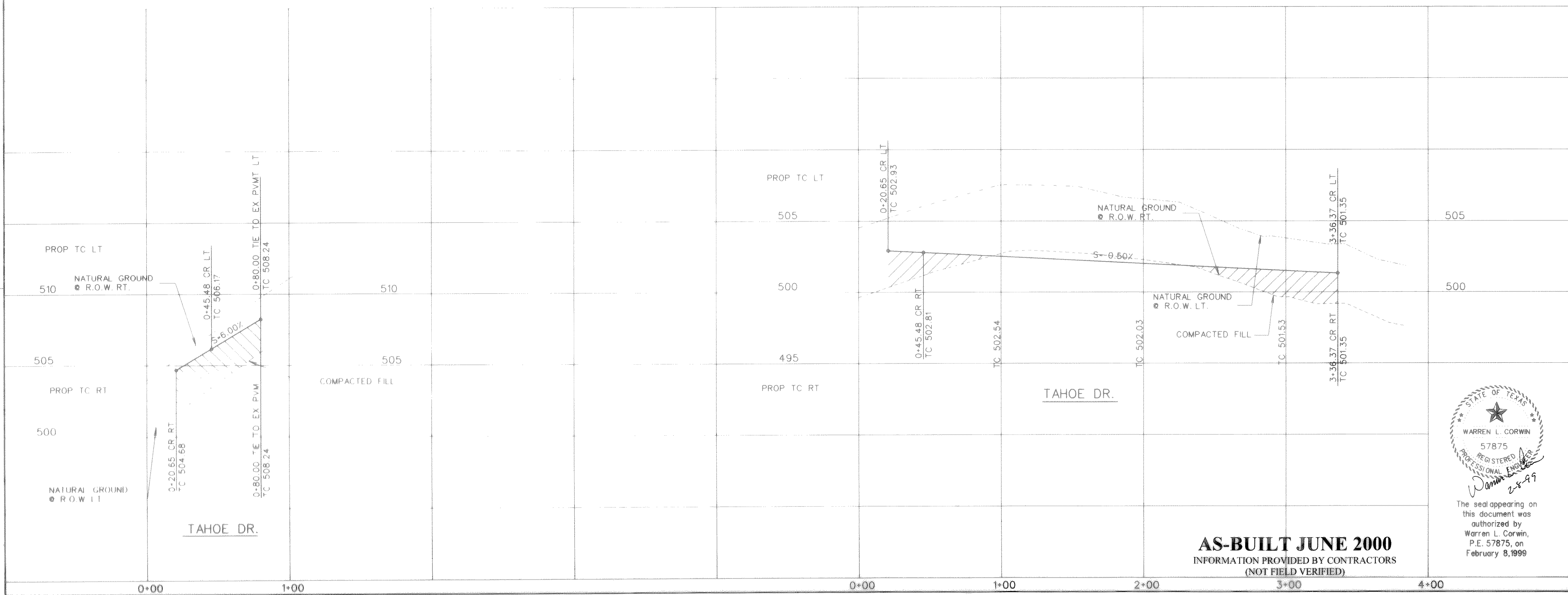

NO.	REVISIONS	BY	DATE

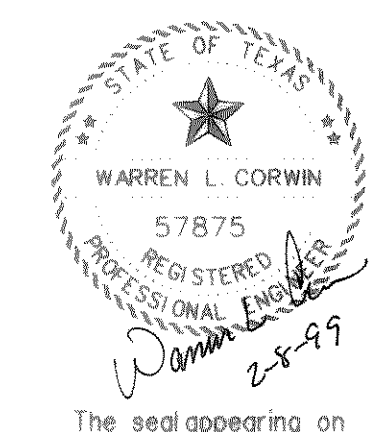

The seal appearing on  
this document was  
authorized by  
Warren L. Corwin,  
P.E. 57875, on  
February 8, 1999

**CORWIN ENGINEERING, INC.**  
8131 LBJ FREEWAY, SUITE 333  
DALLAS, TEXAS 75251 (972) 480-0305

DEVELOPMENT PLANS FOR  
**LAKEVILLE VILLAGE**  
PHASE V-B  
ROCKWALL, TEXAS

TAHOE DRIVE

**AS-BUILT JUNE 2000**  
INFORMATION PROVIDED BY CONTRACTORS  
(NOT FIELD VERIFIED)

DRAWN BY	DESIGNED BY	CHECKED BY	SHEET NO.
RDS	CEI	CEI	5 of 10
JOB NUMBER	DATE	SCALE: H=4' V=1'	
9853	OCTOBER 1998	1"=40' H	