

STORM SEWER CURVE DATA		
CURVE NO.	①	②
Δ	12° 35' 33"	85° 44' 30"
R	227.50'	65.00'
T	25.10'	60.34'
L	50.00'	97.27'

BENCHMARKS:

"□" found on the top of curb of the northwest corner of railroad bridge @ Lakeside Drive.

ELEVATION = 506.23

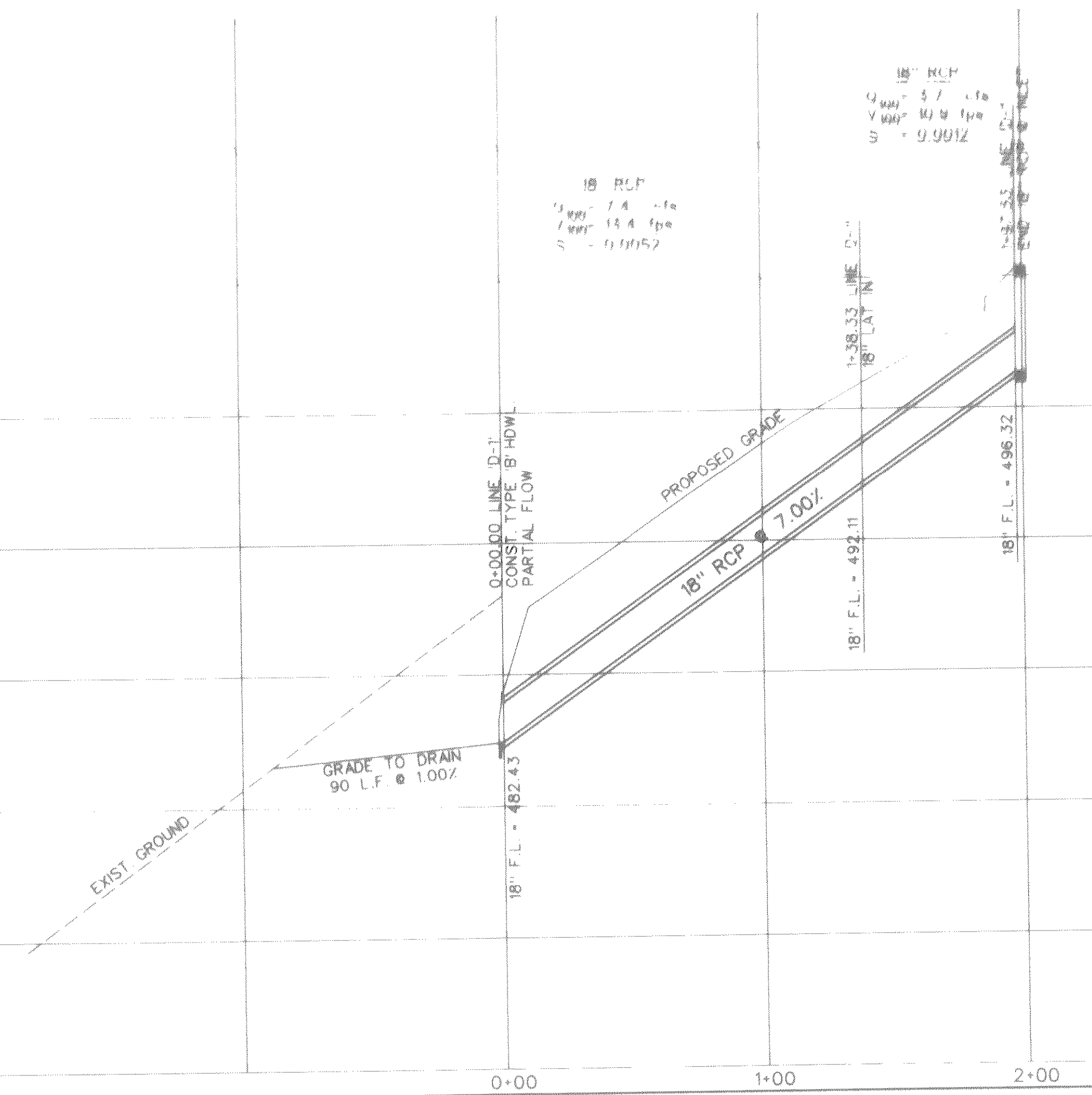

1	ADDED ENGRESS & INGRESS ESMT.	CMF	5-19-98
NO.	REVISIONS	BY	DATE

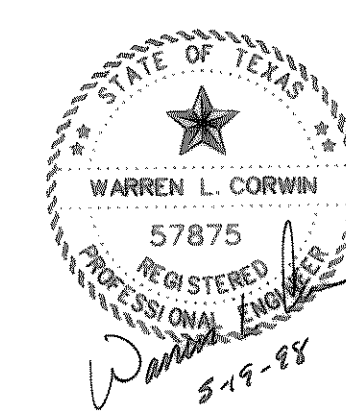

The seal appearing on this document was authorized by Warren L. Corwin, P.E. 57875, on May 19, 1998

CORWIN ENGINEERING, INC.
8131 LBJ FREEWAY, SUITE 333
DALLAS, TEXAS 75251 (972) 480-0305

DEVELOPMENT PLANS FOR
LAKESIDE VILLAGE
PHASE V-A
ROCKWALL, TEXAS

STORM SEWER PLAN AND PROFILE
LINE 'D-1'

AS-BUILT NOVEMBER 1998
INFORMATION PROVIDED BY CONTRACTORS
(NOT FIELD VERIFIED)

DRAWN BY RDS	DESIGNED BY CEI	CHECKED BY CEI	SHEET NO. 10 of 12
JOB NUMBER 9766	DATE JANUARY 1998	SCALE: 1"=4' V 1"=40' H	

FILE: 9766SD1.DGN
REF. FILE:
VIEW:
DATE:

PF.