

REINFORCING TABLE				
< A O T U R I S E R	A	O A	REINFORCING	**BEARING PRESSURE (PSF)
24"	1 @ 4'x4'	26"	#5 @ 10" OCEW #5 @ 10" OCEW	2,540 1,900
30"	1 @ 4'-6" x 4'-6"	32"	#5 @ 10" OCEW #5 @ 9" OCEW	2,260 1,670
36"	1 @ 5' x 5'	38"	#5 @ 9" OCEW #5 @ 8" OCEW	2,060 1,500
42"	1 @ 5'-6" x 5'-6"	44"	#5 @ 8" OCEW #5 @ 8" OCEW	1,490 1,370
48"	1 @ 6' x 6'	50"	#5 @ 7" OCEW #5 @ 7" OCEW	1,210 1,270

CONSTRUCTION LOADS

FOR TEMPORARY CONSTRUCTION VEHICLE LOADS, AN EXTRA AMOUNT OF COMPACTED COVER MAY BE REQUIRED OVER THE TOP OF THE PIPE. THE HEIGHT-OF-COVER SHALL MEET THE MINIMUM REQUIREMENTS SHOWN IN THE TABLE BELOW. THE USE OF HEAVY CONSTRUCTION EQUIPMENT NECESSITATES GREATER PROTECTION FOR THE PIPE THAN FINISHED GRADE COVER MINIMUMS FOR NORMAL HIGHWAY TRAFFIC.

PIPE SPAN, INCHES	AXLE LOADS (kips)			
	18-50	50-75	75-110	110-150
	MINIMUM COVER (FT)			
12-42	2.0	2.5	3.0	3.0
48-72	3.0	3.0	3.5	4.0
78-120	3.0	3.5	4.0	4.0
126-144	3.5	4.0	4.5	4.5

*MINIMUM COVER MAY VARY, DEPENDING ON LOCAL CONDITIONS. THE CONTRACTOR MUST PROVIDE THE ADDITIONAL COVER REQUIRED TO AVOID DAMAGE TO THE PIPE. MINIMUM COVER IS MEASURED FROM THE TOP OF THE PIPE TO THE TOP OF THE MAINTAINED CONSTRUCTION ROADWAY SURFACE.

CONSTRUCTION LOADING DIAGRAM
NOT TO SCALE

SPECIFICATION FOR CORRUGATED STEEL PIPE-ALUMINIZED TYPE 2 STEEL

SCOPE

THIS SPECIFICATION COVERS THE MANUFACTURE AND INSTALLATION OF THE CORRUGATED STEEL PIPE (CSP) DETAILED IN THE PROJECT PLANS.

MATERIAL

THE ALUMINIZED TYPE 2 STEEL COILS SHALL CONFORM TO THE APPLICABLE REQUIREMENTS OF AASHTO M274 OR ASTM A929.

PIPE

THE CSP SHALL BE MANUFACTURED IN ACCORDANCE WITH THE APPLICABLE REQUIREMENTS OF AASHTO M36 OR ASTM A760. THE PIPE SIZES, GAGES AND CORRUGATIONS SHALL BE AS SHOWN ON THE PROJECT PLANS.

ALL FABRICATION OF THE PRODUCT SHALL OCCUR WITHIN THE UNITED STATES.

HANDLING AND ASSEMBLY

SHALL BE IN ACCORDANCE WITH RECOMMENDATIONS OF THE NATIONAL CORRUGATED STEEL PIPE ASSOCIATION (NCSPA)

INSTALLATION

SHALL BE IN ACCORDANCE WITH AASHTO STANDARD SPECIFICATIONS FOR HIGHWAY BRIDGES, SECTION 26, DIVISION II OR ASTM A798 AND IN CONFORMANCE WITH THE PROJECT PLANS AND SPECIFICATIONS. IF THERE ARE ANY INCONSISTENCIES OR CONFLICTS THE CONTRACTOR SHOULD DISCUSS AND RESOLVE WITH THE SITE ENGINEER.

IT IS ALWAYS THE RESPONSIBILITY OF THE CONTRACTOR TO FOLLOW OSHA GUIDELINES FOR SAFE PRACTICES.

MATERIAL SPECIFICATION
NOT TO SCALE

ACCESS CASTING NOT SUPPLIED BY CONTECH

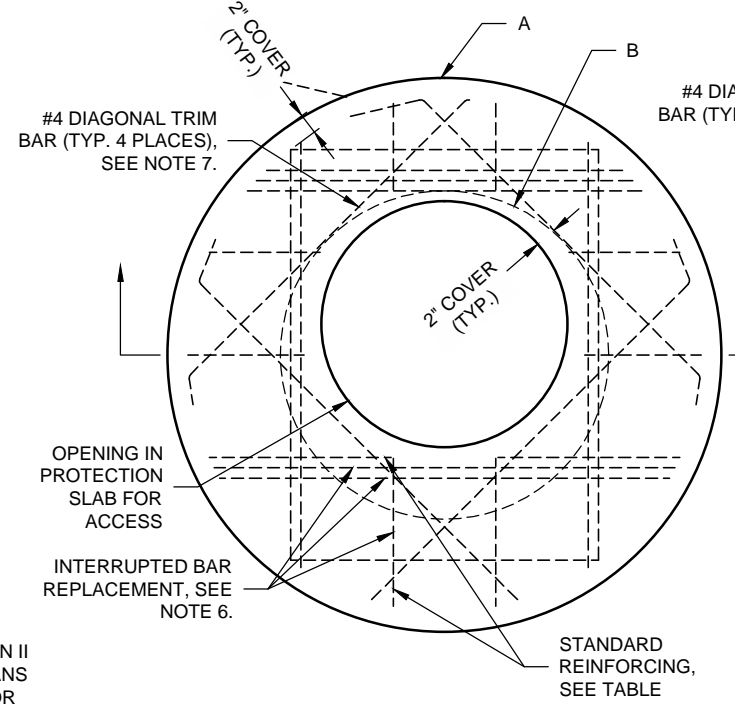

ROUND OPTION PLAN VIEW

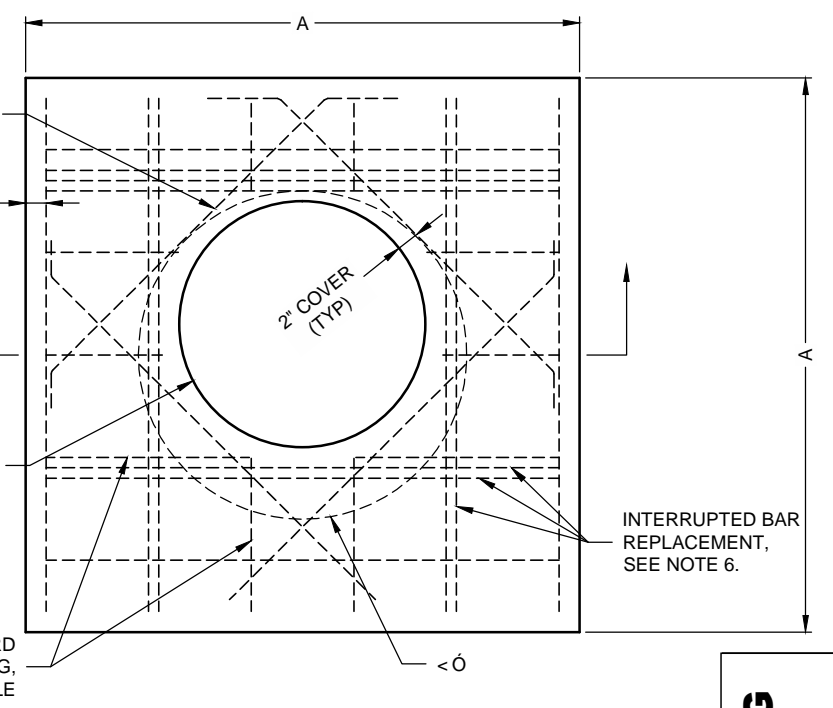

SQUARE OPTION PLAN VIEW

- NOTES:
- DESIGN IN ACCORDANCE WITH AASHTO, 17th EDITION AND ACI 350.
 - DESIGN LOAD HS25.
 - EARTH COVER = 1' MAX.
 - CONCRETE STRENGTH = 4,000 psi
 - REINFORCING STEEL = ASTM A615, GRADE 60.
 - PROVIDE ADDITIONAL REINFORCING AROUND OPENINGS EQUAL TO THE BARS INTERRUPTED, HALF EACH SIDE. ADDITIONAL BARS TO BE IN THE SAME PLANE.

- TRIM OPENING WITH DIAGONAL #4 BARS, EXTEND BARS A MINIMUM OF 12" BEYOND OPENING, BEND BARS AS REQUIRED TO MAINTAIN BAR COVER.
- PROTECTION SLAB AND ALL MATERIALS TO BE PROVIDED AND INSTALLED BY CONTRACTOR.
- DETAIL DESIGN BY DELTA ENGINEERS, ARCHITECTS AND LAND SURVEYORS, ENDWELL, NY.

MANHOLE CAP DETAIL
NOT TO SCALE

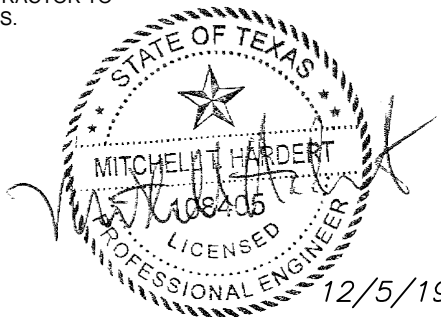

CBC ENGINEERS & ASSOCIATES, LTD.
TBPE FIRM NUMBER F-16105

Approved By	Date	Rev.	Date	By	Description
MTH	12/5/19				
Project No.	Rev.				
CBC-22908	-				

The design and information shown on this drawing is provided as a service to the project owner, engineer and contractor by Contech Engineered Solutions LLC ("Contech"). Neither this drawing, nor any part thereof, may be used, reproduced or modified in any manner without the prior written consent of Contech. Failure to comply is done at the user's own risk and Contech expressly disclaims any liability or responsibility for such use.					
If discrepancies between the supplied information upon which the drawing is based and actual field conditions are encountered as site work progresses, these discrepancies must be reported to Contech immediately for re-evaluation of the design. Contech accepts no liability for designs based on missing, incomplete or inaccurate information supplied by others.					
MARK	DATE	REVISION DESCRIPTION	BY		
1	10/15/2019	STUB SIZE CHANGE	SJ		

CONTECH
ENGINEERED SOLUTIONS LLC
www.ContechES.com
11815 NE Glenn Widing Drive, Portland, OR 97220
800-548-4667 503-240-3393 800-561-1271 FAX

CONTECH
CMP DETENTION SYSTEMS
CONTECH CONTRACT DRAWING

577163-010 - 577163-010
CHICK FIL A - LAKESHORE COMMONS
ROCKWALL, TX
SITE DESIGNATION: UNDERGROUND STORAGE

PROJECT No.:	SEQ. No.:	DATE:
577163	010	10/15/2019
DESIGNED:	DRAWN:	
LMO	PDW/SJ	
CHECKED:	APPROVED:	
SHEET NO.:		
C4	OF	C5

RECORD DRAWING
June 9, 2020
To the best of our knowledge Wier & Associates, Inc., states this plan is As-Built. This information provided is based on surveying at the site and information provided by the contractor.