

- GENERAL NOTES:**
- RAIN BIRD ESP-SMT SENSOR SHALL BE MOUNTED ON A WALL.
  - 1/2" PVC SCH 40 CONDUIT AND FITTINGS.
  - WIRES TO REMOTE CONTROL VALVES AND SENSOR.
  - STANDARD MODULE FOR 4-STATION CONTROLLER.
  - OPTIONAL MODULES FOR 22-STATION CONTROLLER.
  - 120 VAC, 60 HZ EXTERNAL PLUG-IN TRANSFORMER.
  - CONNECTION FOR WIRES FROM SENSOR.

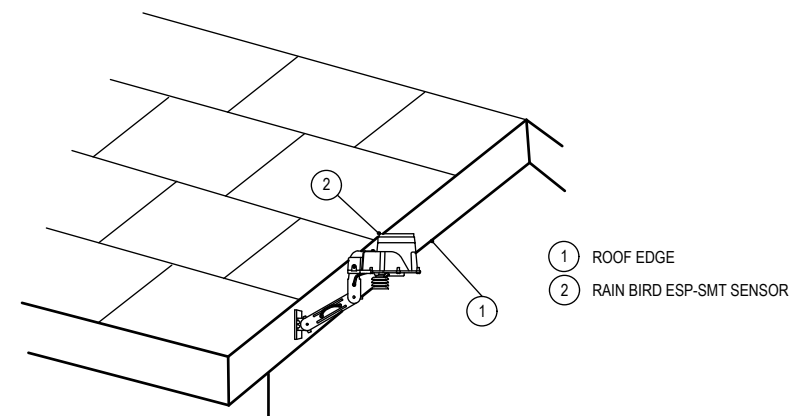
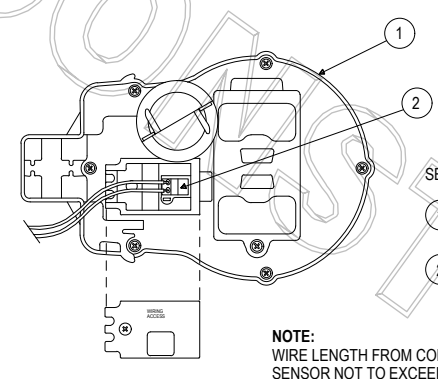

- NOTES:**
- LENGTH OF WIRE FROM CONTROLLER TO SENSOR SHOULD BE NO GREATER THAN 200 FEET.
  - SENSOR MAY BE MOUNTED ON FENCE, FENCE POST OR ON EAVE OF BUILDING.
  - SENSOR SHOULD NOT BE MOUNTED UNDER TREES IN AREAS AFFECTED BY SPRINKLER SYSTEM OR UNDER EAVE OF BUILDING.

**1 IRRIGATION SMART CONTROLLER: ESP-SMT<sup>®</sup>**  
SCALE: NTS (LOCATE IN STORAGE ROOM)

**2 IRRIGATION WEATHER SENSOR**  
SCALE: NTS (LOCATE AT DUMPSTER WALL)

**3 IRRIGATION TRENCHING AND PIPE DEPTH**  
SCALE: NTS

**4 IRRIGATION SLEEVING**  
SCALE: NTS

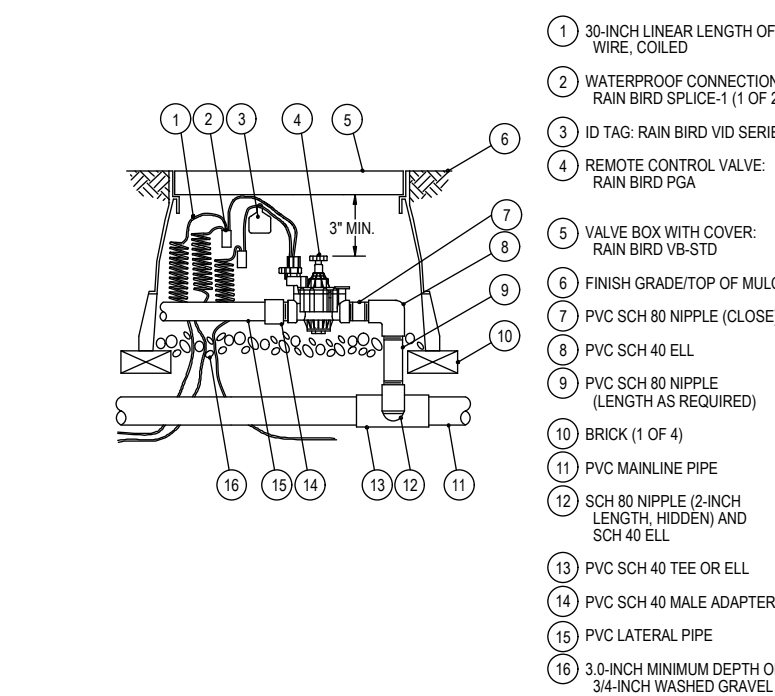

- 3/8" INCH LINEAR LENGTH OF WIRE COILED
- WATERPROOF CONNECTION RAIN BIRD SPLICE 1 (1 OF 2)
- ID TAG: RAIN BIRD VDS SERIES RAIN BIRD 704
- REMOTE CONTROL VALVE RAIN BIRD 704
- VALVE BOX WITH COVER: RAIN BIRD VB-STD
- FINISH GRADE/TOP OF MULCH
- PVC SCH 80 NIPPLE (LENGTH AS REQUIRED)
- PVC SCH 40 ELL
- PVC SCH 80 NIPPLE (LENGTH AS REQUIRED)
- BRICK (1 OF 4)
- PVC MAINLINE PIPE
- SCH 80 NIPPLE (2 INCH LENGTH) HIDDEN AND SCH 40 ELL
- PVC SCH 40 TEE OR ELL
- PVC SCH 40 MALE ADAPTER
- PVC LATERAL PIPE
- 3/8" INCH MINIMUM DEPTH OF 3/4" INCH WASHED GRAVEL

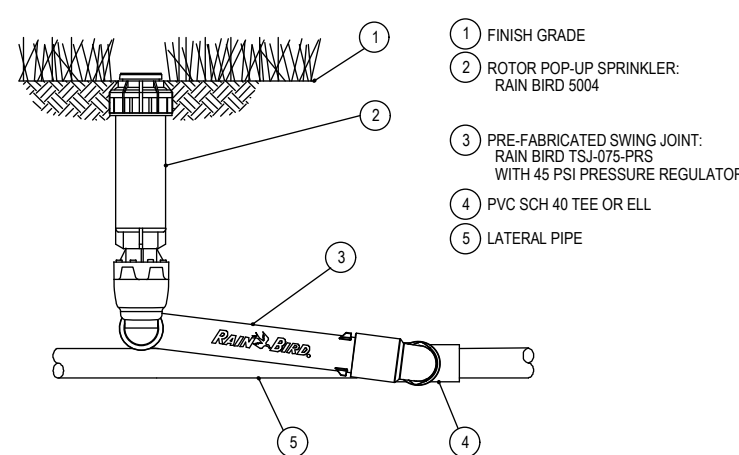

- FINISH GRADE
- ROTOR POP-UP SPRINKLER: RAIN BIRD 5004
- PRE-FABRICATED SWING JOINT: RAIN BIRD TSU-075-PRS WITH 45° PSI PRESSURE REGULATOR
- PVC SCH 40 TEE OR ELL
- LATERAL PIPE

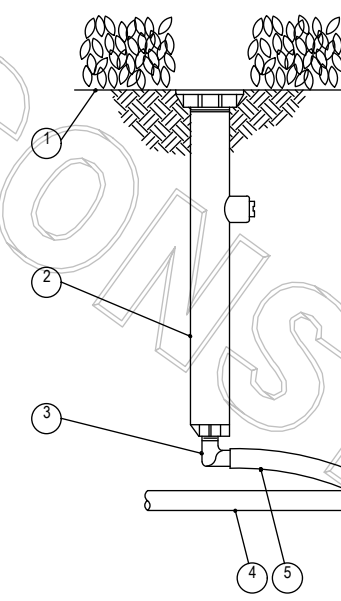

- FINISH GRADE/TOP OF MULCH
- PVC LATERAL PIPE
- POP-UP SPRAY SPRINKLER WITH U-SERIES NOZZLE (2 INCH LINEAR LENGTH) RAIN BIRD MODEL SP-100
- PVC SCH 40 TEE OR ELL

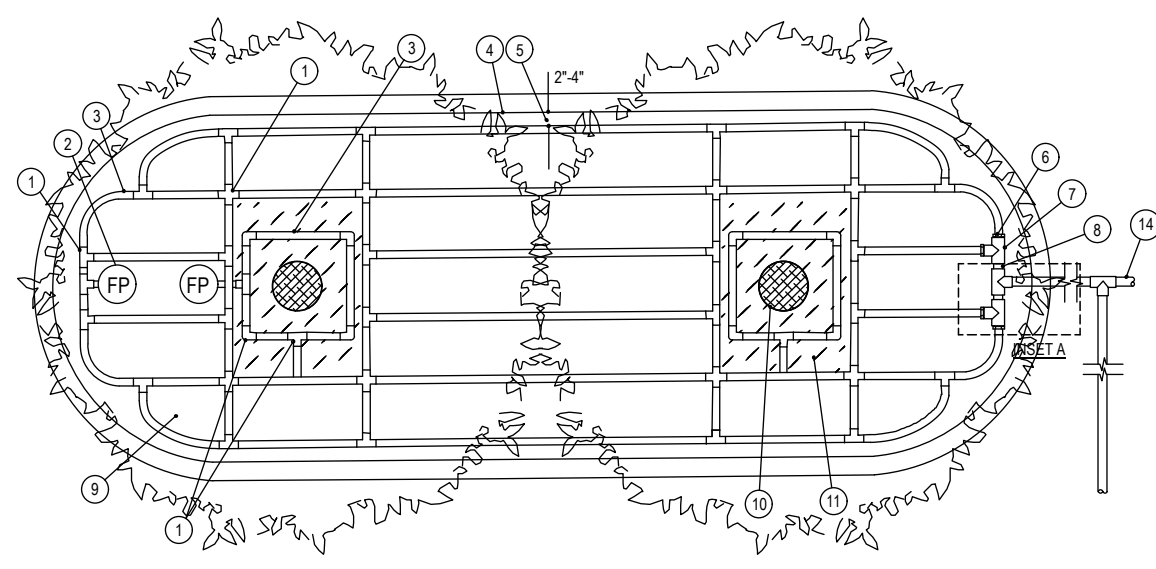

Initial Pressure psi	12" Spacing		18" Spacing	
	Normal Flow GPH	Normal Flow GPH	Normal Flow GPH	Normal Flow GPH
20	5.4	6.9	6.6	8.3
30	289	300	402	307
40	569	599	804	614
50	858	899	1206	921
60	1147	1199	1608	1228

- BARB Y BARB INSERT EL, TEE OR CROSS RAIN BIRD XFF ELBOW (TYPICAL) RAIN BIRD XFF TEE (TYPICAL) RAIN BIRD XFF CROSS (TYPICAL)
- FLUSH POINT (TYPICAL) SEE RAIN BIRD DETAIL "XFD FLUSH POINT"
- ON SURFACE DRIPLINE PIPE RAIN BIRD XFF SERIES DRIPLINE POTABLE: XFCV DRIPLINE
- PARKING ISLAND CURB
- PERMETER DRIPLINE PIPE TO BE INSTALLED 2'-4" FROM PARKING ISLAND CURB
- BARB X MALE FITTING RAIN BIRD XFF MA FITTING (TYPICAL)
- PVC SCH 40 TEE OR ELL (TYPICAL)
- PVC SUPPLY MANIFOLD
- SHRUB OR GROUND COVER BED
- TREE (TYPICAL)
- MULCH BED FOR TREE
- 2-3 INCHES DEPTH OF MULCH
- FINISH GRADE
- PVC DRIP MANIFOLD FROM RAIN BIRD CONTROL ZONE VALVE KIT (SIZED TO MEET LATERAL FLOW DEMAND)
- PVC RISER PIPE

**5 IRRIGATION VALVE: 100-PGA**  
SCALE: NTS

**6 POP-UP ROTOR: 5000 SERIES W/T MPR NOZZLE**  
SCALE: NTS

**7 POP-UP SPRAY: 1800 SERIES**  
SCALE: NTS

**8 DRIP: SYSTEM LAYOUT AND INSTALLATION OVERVIEW**  
SCALE: NTS

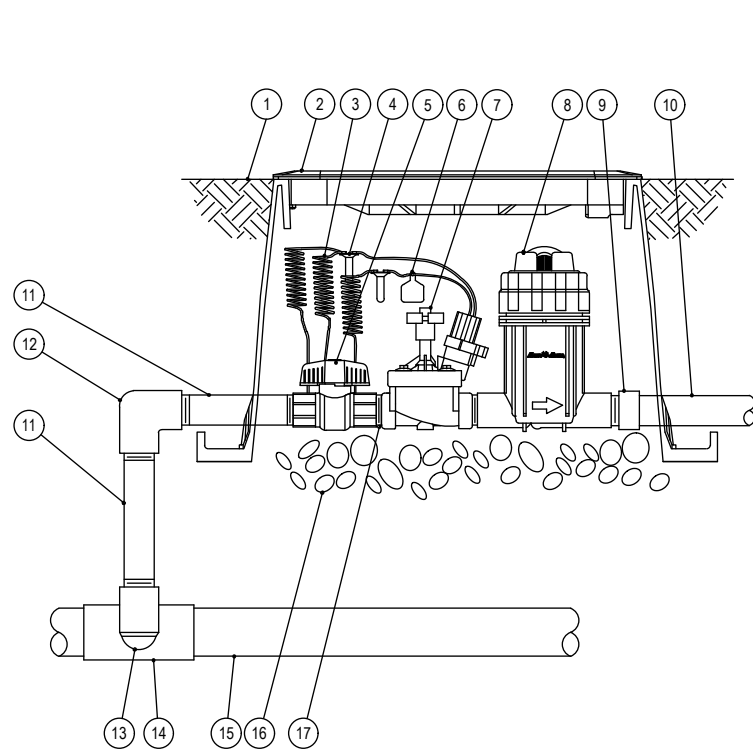

- FINISH GRADE/TOP OF MULCH
- VALVE BOX WITH COVER: RAIN BIRD VB-STD
- 3/8" INCH LINEAR LENGTH OF WIRE COILED
- WATERPROOF CONNECTION: RAIN BIRD DS SERIES
- 1 INCH BALL VALVE (INCLUDED IN XCZ-PRB-100-COM KIT)
- ID TAG
- REMOTE CONTROL VALVE: RAIN BIRD 704 (INCLUDED IN XCZ-PRB-100-COM KIT)
- PRESSURE REGULATING CHECK BACKS: RAIN BIRD PRB-QKCHK-100 (INCLUDED IN XCZ-PRB-100-COM KIT)
- PVC SCH 40 FEMALE ADAPTOR
- LATERAL PIPE
- PVC SCH 80 NIPPLE (LENGTH AS REQUIRED)
- PVC SCH 40 ELL
- PVC SCH 80 NIPPLE (2 INCH LENGTH) HIDDEN AND PVC SCH 40 ELL
- PVC SCH 40 TEE OR ELL
- MAINLINE PIPE
- 3 INCH MINIMUM DEPTH OF 3/4 INCH WASHED GRAVEL
- PVC SCH 80 NIPPLE (CLOSE INCLUDED IN XCZ-PRB-100-COM KIT)

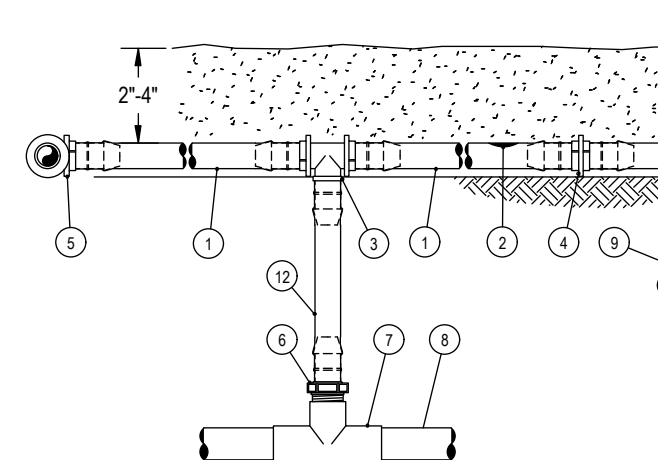

- NOTES:**
- PLACE TIE DOWN STAKES EVERY THREE FEET IN SAND, FOUR FEET IN LOAM AND FIVE FEET IN CLAY.
  - AT FITTINGS WHERE THERE IS A CHANGE OF DIRECTION SUCH AS TEES OR ELBOWS, USE TIE DOWN STAKES ON EACH LEG OF THE CHANGE OF DIRECTION.
  - SAVE YOUR HANDS. USE THE RAIN BIRD FITTING TOOL FOR INSERTION TOOL FOR FITTING ASSEMBLY.

- ON SURFACE DRIPLINE: RAIN BIRD XFF SERIES DRIPLINE POTABLE: XFCV DRIPLINE
- INLINE DRIPLINE EMITTER OUTLET. SEE PLANS FOR DRIPLINE OUTLET SPACING.
- BARB TEE (1 1/2" x 1/2") RAIN BIRD XFF-T
- BARB COUPLING (1 1/2" x 1/2") RAIN BIRD XFF-COUP
- BARB ELBOW (1 1/2" x 1/2") RAIN BIRD XFF-ELBOW
- BARB MALE ADAPTER (1 1/2" x 1/2" MPT) RAIN BIRD XFF-MA-050 (1 1/2" x 3/4" MPT) RAIN BIRD XFF-MA-075
- PVC TEE 1/2" x 1/2"
- PVC LATERAL SUPPLY HEADER
- TIE DOWN STAKE: RAIN BIRD TDS-050 WITH BEND (TYPICAL)
- MULCH
- FINISH GRADE
- RAIN BIRD XFF SERIES BLANK TUBING LENGTH AS REQUIRED

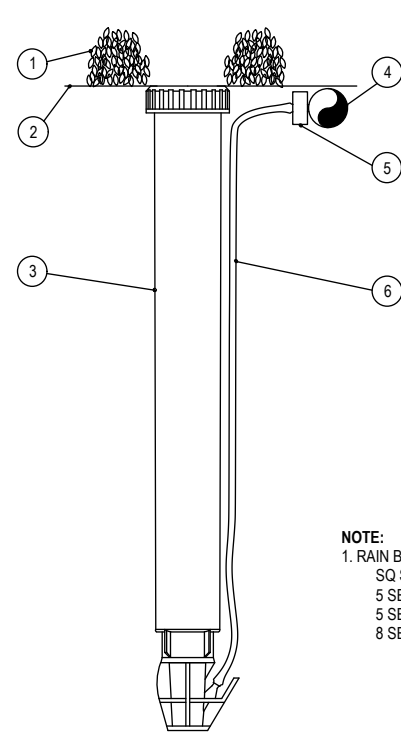

- PLANT MATERIAL
- FINISH GRADE
- MICRO-SPRAY POP-UP: RAIN BIRD XERI-POP 200-100X
- 1/2" POLYETHYLENE TUBING: RAIN BIRD XFF SERIES TUBING OR RAIN BIRD XFF SERIES TUBING OR 1/2" SELF-PEPPERING BARB CONNECTOR: RAIN BIRD SPB-025 1/2" DISTRIBUTION TUBING: RAIN BIRD XFF-TUBING (LENGTH AS REQUIRED)

- NOTE:**
- RAIN BIRD XERI-POP CAN UTILIZE THE FOLLOWING NOZZLES: SQ SQUARE NOZZLES (FORMERLY XPCN)
  - SERIES MPR NOZZLES (ALL CONFIGURATIONS)
  - SERIES PLASTIC BUBBLERS
  - SERIES MPR NOZZLES (S1, S1T AND S2)

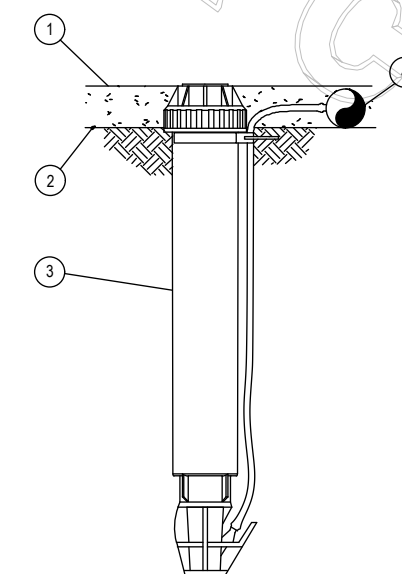

- MULCH
- FINISH GRADE
- OPERATION INDICATOR: RAIN BIRD MODEL OPERIND
- ON SURFACE DRIPLINE: RAIN BIRD XFF SERIES DRIPLINE POTABLE: XFCV SERIES

- NOTE:**
- USE XERIMAN TOOL, XM-TOOL, TO INSERT BARB TRANSFER FITTING DIRECTLY INTO DRIPLINE TUBING
  - VAN NOZZLE MAY BE SET TO CLOSED, OR IF IT IS DESIRED TO SEE SPRAY FROM THE NOZZLE, SET THE ARC TO W-PATTERN. THE FLOW FROM THE NOZZLE, 0.3 GPM, SHOULD BE ACCOUNTED FOR IN THE SYSTEM DESIGN.

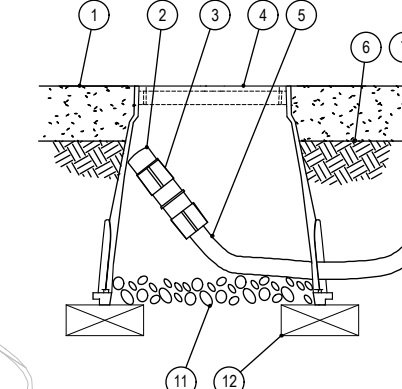

- MULCH
- FLUSH CAP FOR EASY FIT COMPRESSION FITTINGS: POTABLE: RAIN BIRD MDCFCAP
- EASY FIT COUPLING: RAIN BIRD MDCFCOUP
- SUBTERRANEAN EMITTER BOX: RAIN BIRD SEB-7X5
- 1/2" POLYETHYLENE TUBING: RAIN BIRD XFF BLANK TUBING POTABLE: XFCV DRIPLINE
- PVC EXHAUST HEADER
- PVC SCH 40 TEE OR ELL
- BARB X MALE FITTING: RAIN BIRD XFF MA FITTING (TYPICAL)
- ON SURFACE DRIPLINE: RAIN BIRD XFF SERIES DRIPLINE POTABLE: XFCV DRIPLINE
- 3 INCH MINIMUM DEPTH OF 3/4" WASHED GRAVEL BRICK (1 OF 2)

- NOTE:**
- ALLOW A MINIMUM OF 6 INCHES OF DRIP TUBING IN VALVE BOX IN ORDER TO DIRECT FLUSHED WATER OUTSIDE VALVE BOX.

**9 DRIP VALVE: XCZ-PRB-100-COM**  
SCALE: NTS

**10 DRIP: ON-SURFACE RISER ASSEMBLY**  
SCALE: NTS

**11 DRIP: XERI-POP MICRO SPRAY**  
SCALE: NTS

**12 DRIP: OPERATION INDICATOR**  
SCALE: NTS

**13 DRIP: DRIPLINE FLUSH POINT**  
SCALE: NTS



**Chick-fil-A**  
Chick-fil-A  
5200 Buffington Road  
Atlanta, Georgia 30349-2998



**manley**  
LAND DESIGN  
Landscape Architecture  
770.442.8171 tel  
770.442.1123 fax  
Manley Land Design, Inc.  
51 Old Canton Street  
Alpharetta, Georgia 30009  
manleylanddesign.com



**CHICK-FIL-A**  
Lakeshore  
Hwy. 205 @ N. Lakeshore Drive  
Rockwall, TX 75087

**FSU# 03897**

**REVISION SCHEDULE**

NO.	DATE	DESCRIPTION
1	8/3/18	City Comments
2	9/17/18	City Comments
3	10.5.18	City Comments
4	10/23/19	Revised Site Plan
5	11/14/19	Issued For Bid
6	12/17/19	Issued For Construction

**ISSUED FOR CONSTRUCTION**  
MLD PROJECT # 2018115  
PRINTED FOR ISSUED FOR CONSTRUCTION  
DATE 7.19.18  
DRAWN BY ADN

Information contained on this drawing and in all digital files produced for above named project may not be reproduced in any manner without express written or verbal consent from authorized project representatives.  
**Irriation**  
Details  
SHEET  
L-201