

PROPOSED DRAINAGE AREA CALCULATIONS													
DA	Area (ac)	C	C*A	Tc (min)	I ₅ (in/hr)	I ₁₀ (in/hr)	I ₂₅ (in/hr)	I ₁₀₀ (in/hr)	Q ₅ (cfs)	Q ₁₀ (cfs)	Q ₂₅ (cfs)	Q ₁₀₀ (cfs)	NOTES
3-1.0	0.12	0.90	0.11	10.00	6.10	7.10	8.30	9.80	0.66	0.77	0.90	1.06	Runoff to Roof Drains
3-1.1	0.06	0.90	0.05	10.00	6.10	7.10	8.30	9.80	0.33	0.38	0.45	0.53	Proposed 5' Curb Inlet
3-1.2	0.04	0.90	0.04	10.00	6.10	7.10	8.30	9.80	0.22	0.26	0.30	0.35	Proposed 5' Curb Inlet
3-1.3	0.03	0.90	0.03	10.00	6.10	7.10	8.30	9.80	0.16	0.19	0.22	0.26	Proposed 5' Curb Inlet
3-1.3A	0.06	0.90	0.05	10.00	6.10	7.10	8.30	9.80	0.33	0.38	0.45	0.53	Proposed 2'x2' Drop Inlet
3-1.4	0.02	0.90	0.02	10.00	6.10	7.10	8.30	9.80	0.11	0.13	0.15	0.18	Proposed 12"x12" Grate Inlet
3-1.4A	0.01	0.90	0.01	10.00	6.10	7.10	8.30	9.80	0.05	0.06	0.07	0.09	Proposed 12"x12" Grate Inlet
3-1.5	0.03	0.90	0.03	10.00	6.10	7.10	8.30	9.80	0.16	0.19	0.22	0.26	Proposed 5' Curb Inlet
3-1.6	0.21	0.90	0.19	10.00	6.10	7.10	8.30	9.80	1.15	1.34	1.57	1.85	Proposed 5' Curb Inlet
-	0.58	-	0.52	-	-	-	-	-	3.18	3.71	4.33	5.12	
3-2.0	0.45	0.90	0.41	10.00	6.10	7.10	8.30	9.80	2.47	2.88	3.36	3.97	Proposed 5' Curb Inlet
-	0.45	-	0.41	-	-	-	-	-	2.47	2.88	3.36	3.97	
3-3.0	0.29	0.90	0.26	10.00	6.10	7.10	8.30	9.80	1.59	1.85	2.17	2.56	Proposed 5' Curb Inlet
-	0.29	-	0.26	-	-	-	-	-	1.59	1.85	2.17	2.56	
3A	0.09	0.90	0.08	10.00	6.10	7.10	8.30	9.80	0.49	0.58	0.67	0.79	Goes to DA3-3.0
-	0.09	-	0.08	-	-	-	-	-	0.49	0.58	0.67	0.79	

- Notes:
- Runoff coefficients obtained from Table 3.2 (Runoff Coefficient for Types of Land Use) from the City of Rockwall, *Standards of Design and Construction Manual*.
 - Time of Concentration obtained from Table 3.3 (Minimum Inlet Time of Concentration) from the City of Rockwall, *Standards of Design and Construction Manual*.
 - Rainfall Intensities obtained from Figure 3.1 (IDF Curve) from the City of Rockwall, *Standards of Design and Construction Manual*.
 - Drainage Design Discharge Method: Rational Formula: $Q=CIA$
c = 0.90 for Commercial Uses
 - All coefficients, times of concentrations, and intensities are consistent with Hickman Consulting Engineers Inc's proposed Drainage Area Map, sheet C-4, area 3 (to be considered as existing conditions at the start of this project)

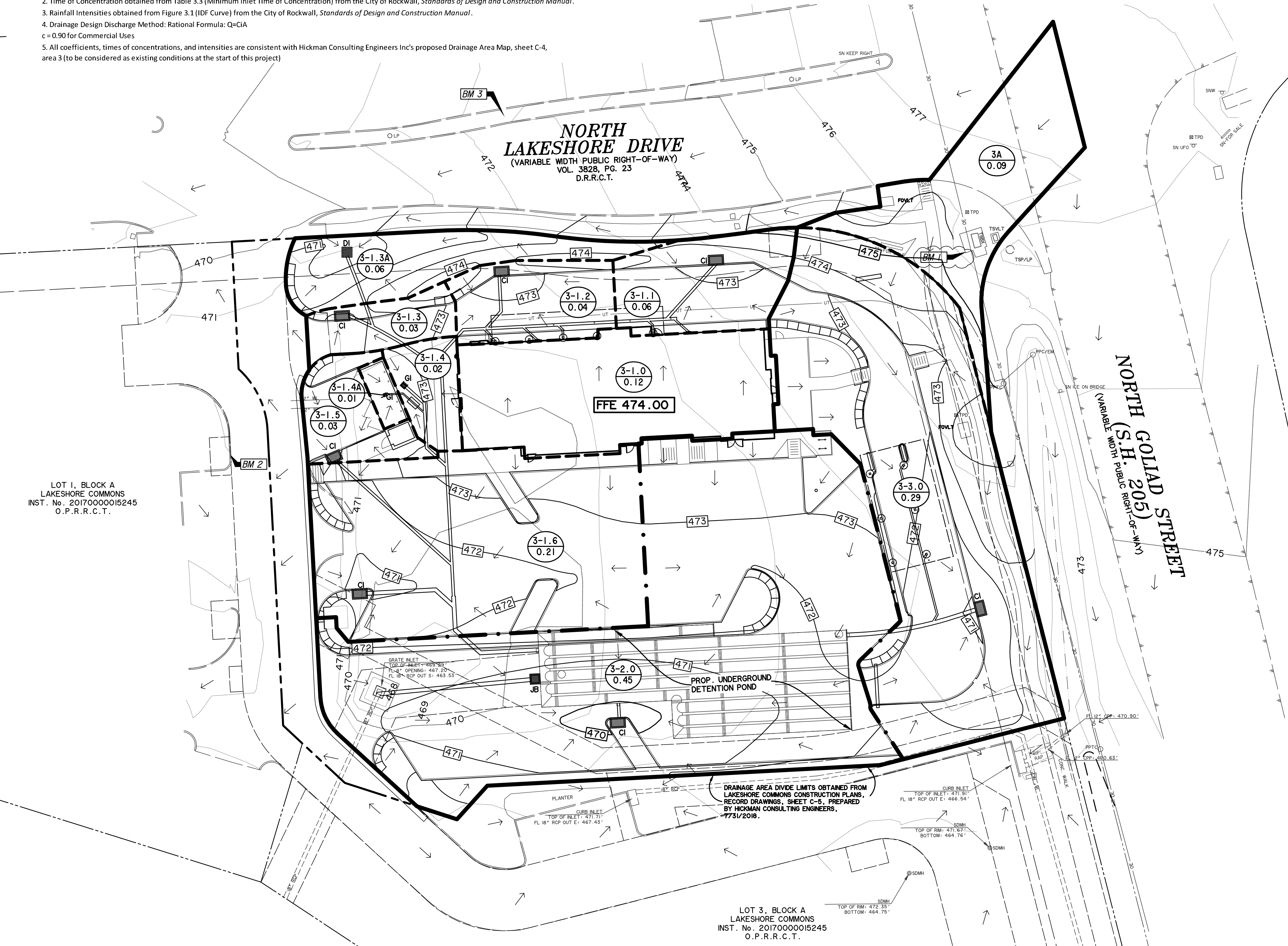

CAUTION !!!
EXISTING UTILITIES ARE INDICATED ON THE PLANS FROM AVAILABLE INFORMATION. IT SHALL BE THE RESPONSIBILITY OF THE CONTRACTOR TO VERIFY THE LOCATION OF ALL UTILITIES, TO NOTIFY ALL UTILITY COMPANIES OF THE CONTRACTORS OPERATIONS, TO PROTECT ALL UTILITIES FROM DAMAGE, TO REPAIR ALL UTILITIES DAMAGED DUE TO THE CONTRACTORS OPERATIONS, AND TO NOTIFY THE ENGINEER PROMPTLY OF ALL CONFLICTS OF THE WORK WITH EXISTING UTILITIES.

RECORD DRAWING
June 9, 2020

To the best of our knowledge Wier & Associates, Inc. states this plan is As-Built. This information provided is based on surveying at the site and information provided by the contractor.

ALL RESPONSIBILITY FOR ADEQUACY OF DESIGN REMAINS WITH THE DESIGN ENGINEER. THE CITY OF ROCKWALL, IN REVIEWING AND RELEASING PLANS FOR CONSTRUCTION, ASSUMES NO RESPONSIBILITY FOR ADEQUACY OR ACCURACY OF DESIGN.

TOTAL SITE ACREAGE = 1.40 ACRES



- LEGEND**
- 560 EXIST. CONTOUR
 - 560 PROP. CONTOUR
 - 560 OMIT
 - 3 DRAINAGE AREA NUMBER ACRES
 - DRAINAGE DIVIDE
 - DIRECTION OF FLOW
 - CI CURB INLET
 - GI GRATE INLET
 - DI DROP INLET
 - JB JUNCTION BOX

VERTICAL DATUM NOTE:
REFERENCE DATUM = NORTH AMERICAN VERTICAL DATUM (NAD) 88 UTILIZING THE RTK NETWORK ADMINISTERED BY WESTERN DATA SYSTEMS.

SITE BENCHMARK NO. 1 AN "X" CUT ON THE SOUTHWEST CORNER OF THE CONCRETE PAD OF A TRAFFIC SIGNAL BOX LOCATED AT THE SOUTHWEST CORNER OF N LAKESHORE DR AND N GOLLAD ST., 4' +/- SOUTHWEST OF THE SOUTHWEST CORNER OF THE TRAFFIC SIGNAL BOX, 16' +/- SOUTH OF A FIBER OPTIC PEDESTAL, AND 17' +/- WEST OF THE TRAFFIC SIGNAL POLE.
ELEVATION = 476.04'

SITE BENCHMARK NO. 2 AN "X" CUT IN CONCRETE BACK OF CURB WEST SIDE OF ACCESS DRIVE WEST OF LOT 2, LAKESHORE COMMONS, ±3' EAST OF FIRE HYDRANT AND ±12' SOUTHWEST OF SANITARY SEWER MAN HOLE.
ELEVATION = 471.87'

SITE BENCHMARK NO. 3 AN "X" CUT IN PAVERS BRICK MEDIAN OF NORTH LAKESHORE DRIVE ±45' DIRECTLY EAST OF A LIGHT POLE ±176' WEST OF INTERSECTION WITH NORTH GOLLAD STREET.
ELEVATION = 472.68'

PREPARED BY:
WIA WIER & ASSOCIATES, INC.
ENGINEERS SURVEYORS LAND PLANNERS
2201 E. LAMAR BLVD., SUITE 200E ARLINGTON, TEXAS 76006 METRO (817)467-7700
Texas Firm Registration No. F-2776 www.WierAssociates.com

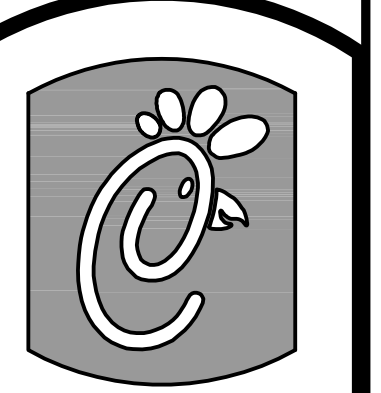

Wier & Associates
5200 Buffington Rd.
Atlanta Georgia,
30349-2998

Revisions:
Mark Date By
12/17/19 RBC

ISSUED FOR CONSTRUCTION

Mark Date By

Mark Date By



LOT 2, BLOCK A
LAKESHORE COMMONS
1979 NORTH LAKESHORE DRIVE
ROCKWALL, TEXAS
STORE# 03897

STORE SERIES P13-LSR

SHEET TITLE
DRAINAGE AREA MAP

For Permit
 For Bid
 For Construction

Job No. : 17144
Store : #03897
Date : 1/2/2020
Drawn By : RRW
Checked By : RSE

Sheet

C-7