

- NOTES
1. All materials and workmanship shall conform to the City of Rockwall standards and governed by the North Central Texas Council of Government's (NCTCOG) Standard Specifications for Public Works Construction, 3RD Edition.
 2. In case of conflict or contradictions between the construction standards of the City of Rockwall and the NCTCOG specifications, the following hierarchy shall preside: City of Rockwall Construction Standard Details, City of Rockwall standard general notes, NCTCOG specifications.
 3. Access to properties shall not be denied during construction.
 4. All driveways and culverts damaged during construction shall be restored to existing condition prior to construction, or better.
 5. Contractor shall locate all existing utilities.
 6. 8" sanitary sewer shall be wrapped with sanitary sewer tape. Green disks shall be installed on sewer every 250', each manhole, clean out, and service.
 7. Manholes to be Raven lined or approved equal, spark and pressure tested.
 8. No services allowed to tie to sewer line except at the manholes
 9. Manholes to be sealed to prevent inflow and infiltration.
 10. All trench backfill to be compacted to min 95%
 11. Per TCEQ requirements, maintain minimum 2' vertical & 4' horizontal separation between outside of water & sewer pipes when sewer is rated to 150 psi.

B.M. 5/8" IRON ROD WITH YELLOW CAP FOUND ON SOUTH CORNER OF THE INTERSECTION OF INDUSTRIAL BLVD. AND AIRPORT ROAD ELEVATION = 581.84

"ALL RESPONSIBILITY FOR ADEQUACY OF DESIGN REMAINS WITH THE DESIGN ENGINEER. THE CITY OF ROCKWALL, IN REVIEWING AND RELEASING PLANS FOR CONSTRUCTION, ASSUMES NO RESPONSIBILITY FOR ADEQUACY OR ACCURACY OF DESIGN"

RECORD DRAWINGS
 TO THE BEST OF OUR KNOWLEDGE BINKLEY & BARFIELD - C&P, INC., HEREBY STATES THAT THIS PLAN IS AS-BUILT. THIS INFORMATION PROVIDED IS BASED ON SURVEYING AT THE SITE AND INFORMATION PROVIDED BY THE CONTRACTOR.
 DATE: 7.1.2014 SIGNATURE: [Signature] BINKLEY & BARFIELD - C&P, INC.

OWNER:
 ROCKWALL 12.833
 VOL. 1325, PG. 5
 D.R.R.C.T.

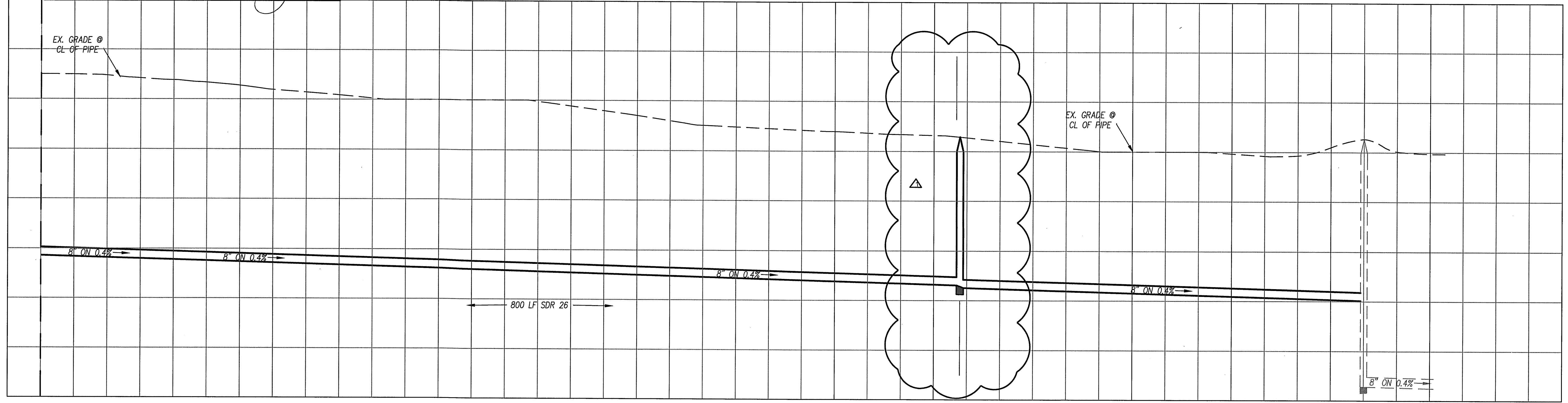

S:\153000 Lakes Reg MHMR Center\154 - BC12049 FORCE MAIN PP.dwg-PP SHEET 1 Plotted Jul 01, 2014 at 12:39pm by kanderon | Last Saved by kanderon

Rev	Date	Description	App.
9-20-13		MOVED SAN. SEW. LINE 3" NORTH & ADJUSTED MANHOLE.	T.P.J.

Designed By: RAA
 Drawn By: BS
 Checked By: TPJ
 Job No.: BC12049
 Date: MAR. 28, 2013
 Scale: 1"=30' H (22"X34")
 Approved By: _____

The seal appearing on this document was authorized by Thomas P. Jones, P.E. 58887. Alteration of a sealed document without proper notification to the responsible engineer is an offense under the Texas Engineering Practice Act. Apr. 22, 2013

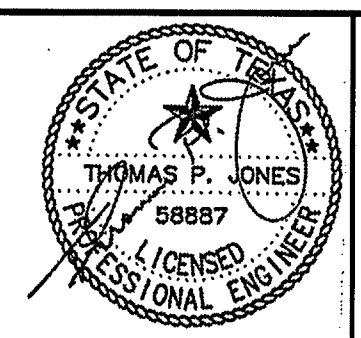

Binkley & Barfield | C&P
 consulting engineers
 1801 Gateway Blvd, Suite 101 Richardson Texas 75080 www.bbcp.com
 Firm Registration #F-3185

LAKES REGIONAL MHMR CENTER
 MR. DON SMITH
 P.O. BOX 747
 TERRELL, TX 75160
 972-388-2000, EXT. 1196
 DONS@LRMHMRC.ORG

OFFSITE SANITARY SEWER PLAN/PROFILE
 BLOCK A, LOT 4, COLUMBIA PARK ADDITION
 ROCKWALL, TEXAS
 LAKES REGIONAL
 MENTAL HEALTH MENTAL RETARDATION CENTER
 ROCKWALL, TEXAS

Sheet No:
SS1
 of NS