

# ENGINEERING SITE PLAN

## FOR

# LAKE POINTE BAPTIST CHURCH

### (LOT 1, BLOCK A)

## SITE IMPROVEMENTS

## CITY OF ROCKWALL, TEXAS

**DEVELOPER :**  
 LAKE POINTE BAPTIST CHURCH  
 701 INTERSTATE HIGHWAY 30  
 ROCKWALL, TEXAS 75087  
 (972) 771-2322  
 MR. JOHN WARDELL

**ENGINEER :**  
 GRAHAM ASSOCIATES, INC.  
 616 SIX FLAGS DR., SUITE 400  
 ARLINGTON, TEXAS 76011  
 (817) 640-8535  
 MR. W.J. WILLIAMS, P.E.

**ARCHITECT :**  
 H.H. ARCHITECTS  
 14951 DALLAS PARKWAY, SUITE 200  
 DALLAS, TEXAS 75240  
 (972) 404-1034  
 MR. TIM BROYLES

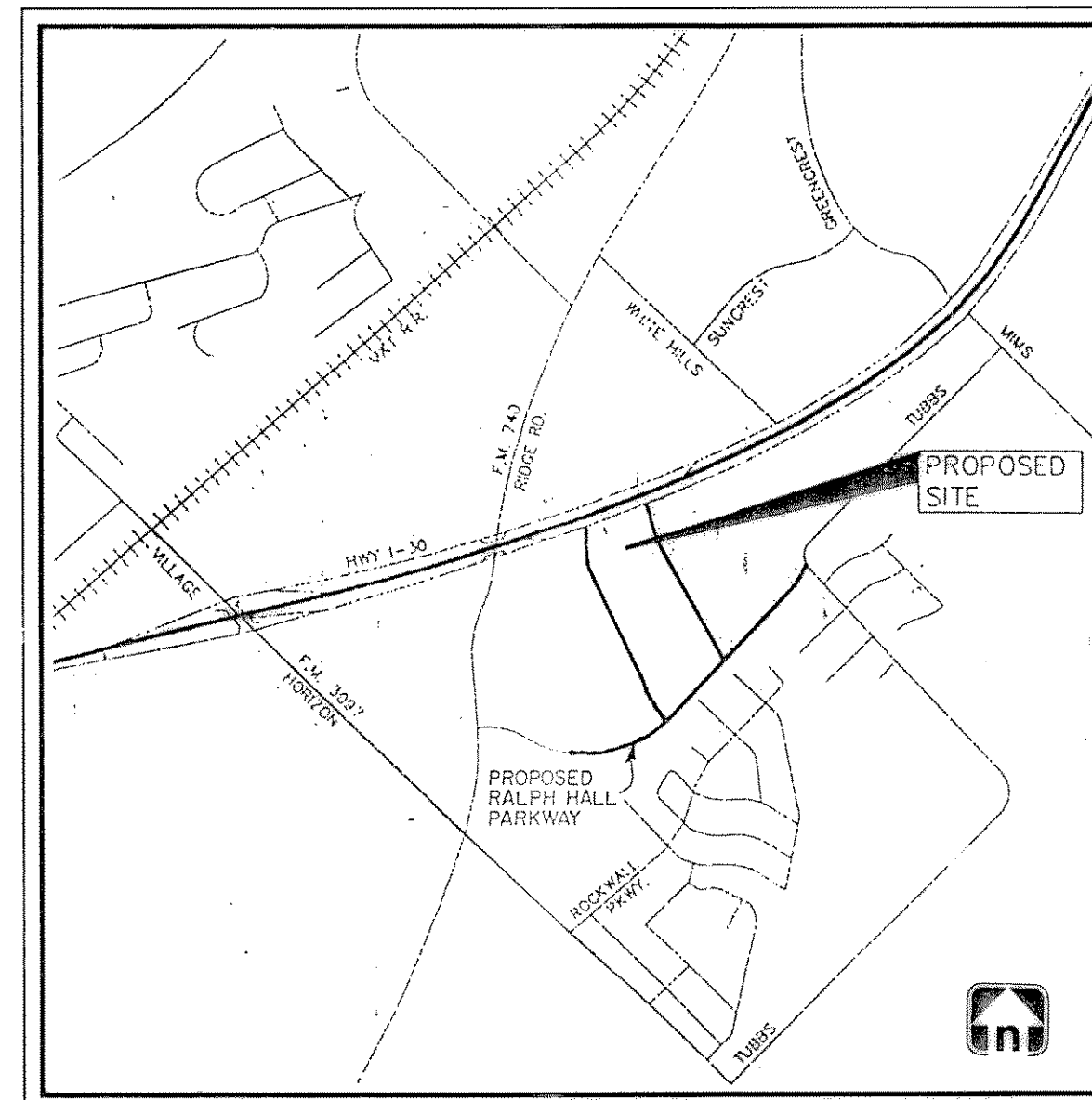

LOCATION MAP

### INDEX

SHEET NO.	DESCRIPTION
2.00 - 2.01	COVER SHEET
2.10 - 2.11	FINAL PLAT (KIMLEY-HORN & ASSOCIATES, INC.)
2.12 - 2.13	SITE PLAN
2.20	DEMOLITION PLAN
2.21	DRAINAGE AREA MAP
2.22	GRADING PLAN INDEX
2.23A - 2.23B	BERM GRADING PLAN
2.24 - 2.25	GRADING PLAN
2.25A	STORM DRAIN PLAN
2.26 - 2.28	STORM DRAIN HEADWALL DETAIL
2.30	STORM DRAIN PROFILES
2.31 - 2.32	UTILITY PLAN
2.40	SLEEVING PLAN
2.50	PAVING PLAN & PROFILE (MAIN ENTRANCE ROAD)
2.60	LIGHTING LAYOUT
2.61	EROSION CONTROL PLAN
	EROSION CONTROL DETAILS



CONSTRUCTION SHALL COMPLY WITH THE CITY OF ROCKWALL SPECIFICATIONS AND THE LATEST EDITION OF THE PUBLIC WORKS SPECIFICATIONS PUBLISHED BY THE NORTH CENTRAL TEXAS COUNCIL OF GOVERNMENTS.

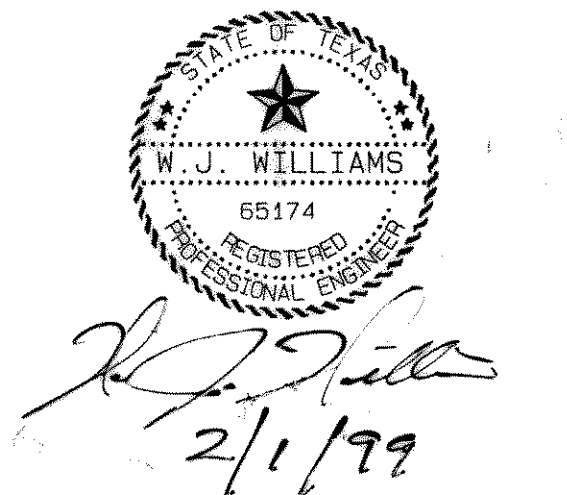

NOVEMBER, 1998

PROJECT NO. 9762-1011

