

**CAUTION:**  
 EXISTING UTILITIES AND UNDERGROUND FACILITIES OF THESE PLANS HAVE BEEN LOCATED FROM REFERENCE INFORMATION AND AS-BUILT PLANS. IT SHALL BE THE RESPONSIBILITY OF THE CONTRACTOR TO VERIFY HORIZONTAL AND VERTICAL LOCATION OF ALL EXISTING UTILITIES PRIOR TO CONSTRUCTION. THE CONTRACTOR SHALL TAKE NECESSARY PRECAUTIONS TO PROTECT ALL EXISTING UTILITIES AND WILL BE RESPONSIBLE FOR ANY DAMAGE TO SAID UTILITIES. THE CONTRACTOR SHALL NOTIFY ALL UTILITY COMPANIES PRIOR TO CONSTRUCTION.

- LEGEND:**
- 535 — PROPOSED 1' CONTOUR
  - - - 535.5 - - - PROPOSED 0.5' CONTOUR
  - 543.5 — x — PROPOSED SPOT ELEVATION
  - 540 — EXISTING 5' CONTOUR
  - - - 542 - - - EXISTING 1' CONTOUR

**RECORD DRAWING**  
 This is to certify that changes and corrections have been made to conform to the contractor's record of this project.  
 [Signature] 4/12/00  
 Date  
 Graham Associates, Inc.  
 CONSULTING ENGINEERS & PLANNERS

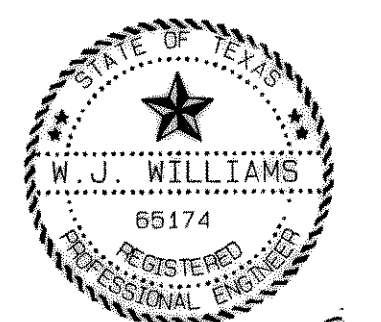

[Signature]  
 2/1/99

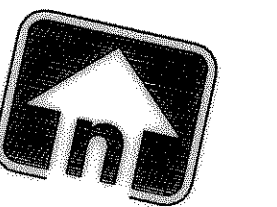

0 25 50 100  
 SCALE: 1" = 50'

2.22

BERM GRADING PLAN	
LOT 1, BLOCK A LAKE POINTE BAPTIST CHURCH	
CITY OF ROCKWALL ROCKWALL COUNTY, TEXAS	
	Graham Associates, Inc. CONSULTING ENGINEERS & PLANNERS 616 SIX FLAGS DRIVE, SUITE 400 ARLINGTON, TEXAS 76011 (817) 640-8535
Drawn By: G.A.I.	Date: NOV., 1998 File: 9762-1011

BENCHMARK  
 TOP OF CONCRETE IN LIGHT BASE  
 N: 1,899.180, E: 1,540.853  
 ELEV. = 551.15  
 (SEE GRADING INDEX FOR LIGHT  
 BASE LOCATION.)

2-22-99 REVISED STORM SEWER

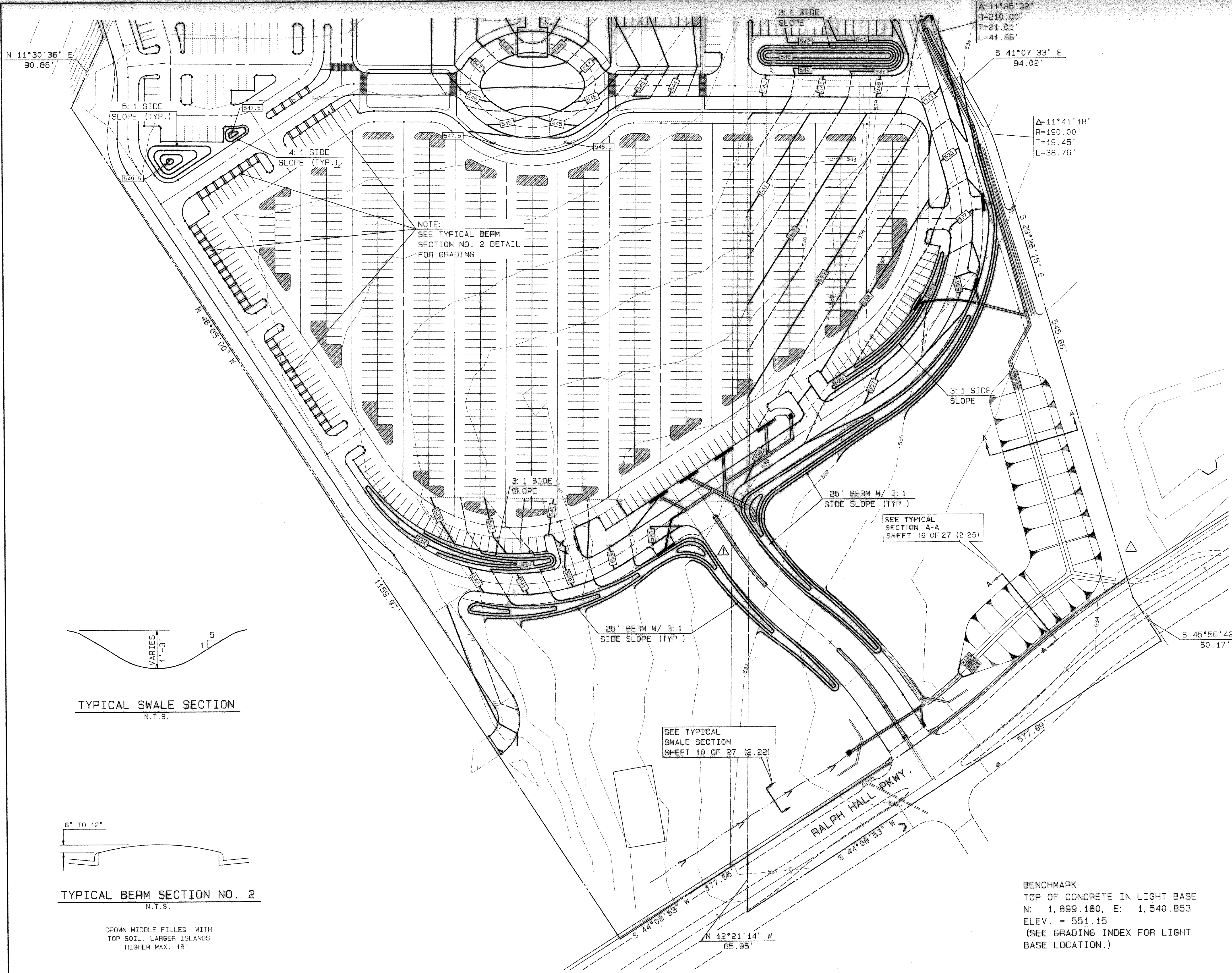

NOTE:  
 SEE TYPICAL BERM  
 SECTION NO. 2 DETAIL  
 FOR GRADING

SEE TYPICAL  
 SECTION A-A  
 SHEET 16 OF 27 (2.25)

SEE TYPICAL  
 SWALE SECTION  
 SHEET 10 OF 27 (2.22)

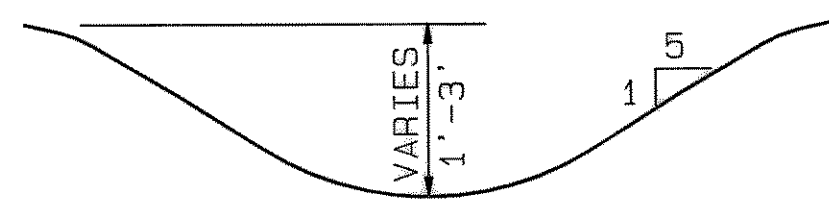

TYPICAL SWALE SECTION  
 N.T.S.

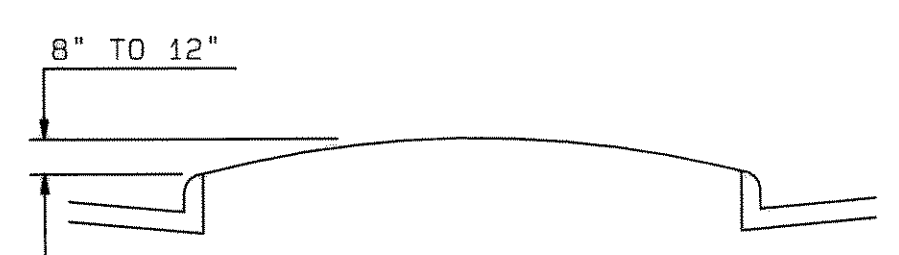

TYPICAL BERM SECTION NO. 2  
 N.T.S.

CROWN MIDDLE FILLED WITH  
 TOP SOIL. LARGER ISLANDS  
 HIGHER MAX. 18"