

ENGINEERING CONSTRUCTION PLANS FOR LAKE POINTE CHURCH

SOUTHEAST PARKING LOT EXPANSION LOT 3, BLOCK A CITY OF ROCKWALL, ROCKWALL COUNTY, TEXAS

SHEET INDEX

	COVER SHEET
	FINAL PLAT
	GENERAL NOTES
C0.02	SITE LOCATION PLAN
C1.01	SITE PLAN
C1.02	EROSION CONTROL PLAN
C2.01	EROSION CONTROL NOTES & DETAILS
C2.02	PAVING & GRADING PLAN
C3.01	PAVING DETAILS
C3.02	TREESCAPE PLAN
L1.01	LANDSCAPE PLAN
L2.01	LANDSCAPE DETAILS
L3.01	DRAINAGE AREA MAP
*C1.01	

NOTES:
*FOR REFERENCE ONLY FROM RECORD DRAWINGS

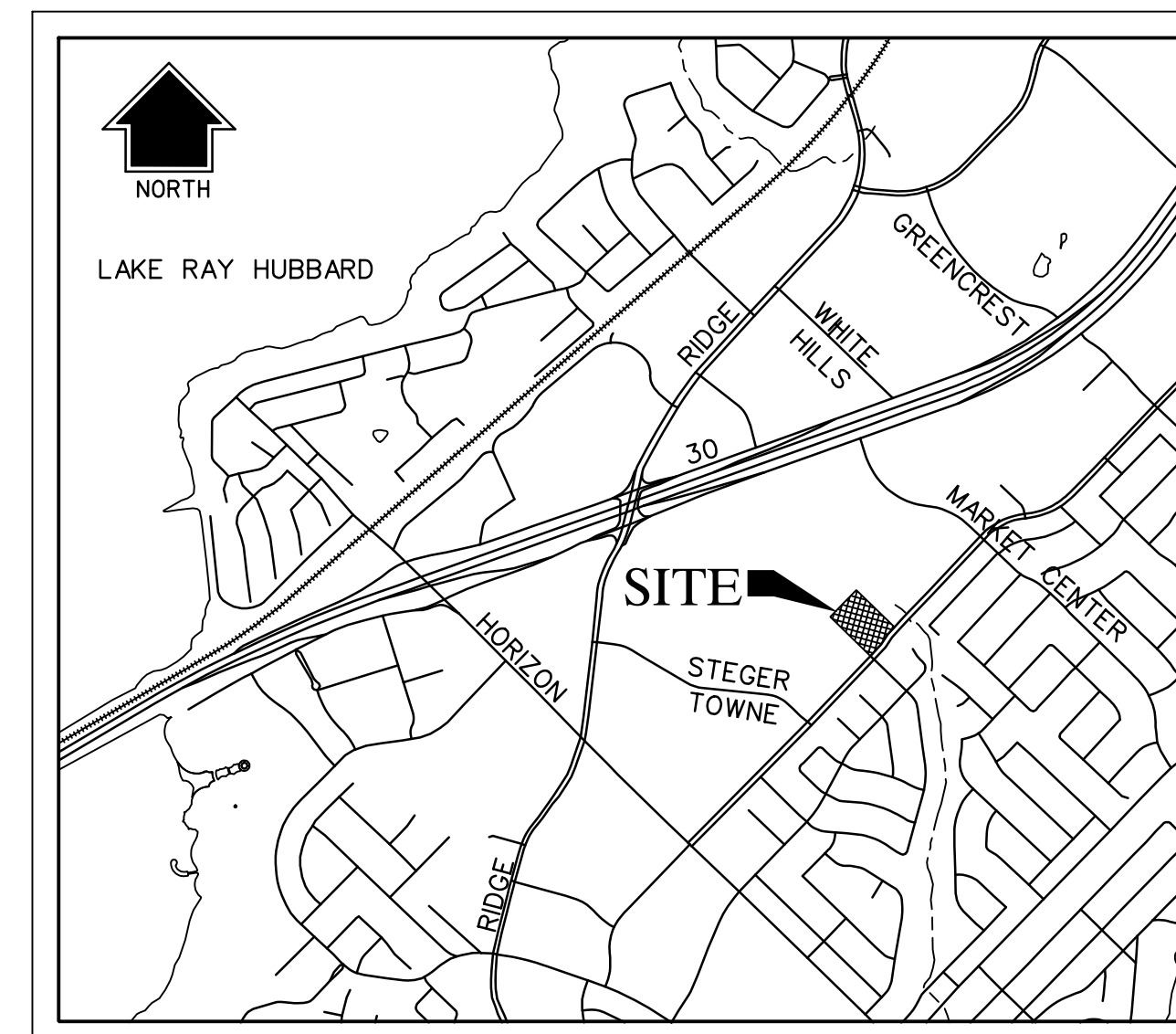

LOCATION MAP
N.T.S.
MAPSCO NO. 30C-G



3803 PARKWOOD BLVD., SUITE 800
FRISCO, TEXAS 75034-8640
TEL (214) 618-4570
FAX (214) 618-4574
TBPE FIRM #F-312

RECORD DRAWING

TO THE BEST OF OUR KNOWLEDGE HALFF ASSOCIATES, INC. HEREBY STATES THAT THIS PLAN IS A RECORD DRAWING. THESE RECORD DRAWINGS HAVE BEEN PREPARED BASED ON FIELD OBSERVATIONS, ON 09/10/2019, AND FIELD SURVEY WORK CONDUCTED AT THE SITE. THE ORIGINAL SEALED CONSTRUCTION DRAWINGS ARE ON FILE AT THE OFFICES OF: HALFF ASSOCIATES, INC., TBPE FIRM #312

ENGINEER OF RECORD:

Daniel W. Warfield
DANIEL W. WARFIELD, P.E. 95947
HALFF ASSOC. TBPE FIRM #312
DATE 09/30/2019

Revision		
No.	Date	Description
1	09/30/2019	RECORD DRAWINGS

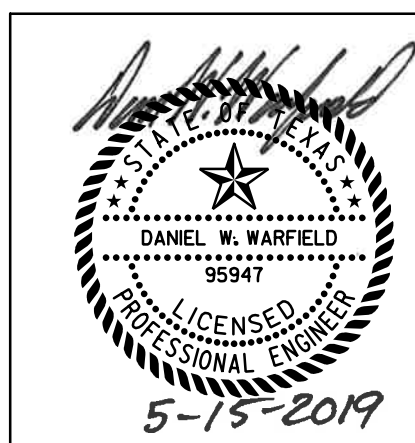

The seal appearing on this document was authorized by Daniel W. Warfield, P.E. 95947 on 05/15/19. Alteration of a sealed document without proper notification to the responsible engineer is an offense under the Texas Engineering Practice Act. The record copy of this drawing is on file at the offices of Halff Associates, Inc., 3803 Parkwood Blvd., Frisco, Texas 75034. TBPE FIRM #F-312.

OWNER / DEVELOPER

LAKE POINTE CHURCH- ROCKWALL CAMPUS
701 INTERSTATE 30
ROCKWALL, TX 75087
CONTACT: JOHN WARDELL
(PH) 469-698-2244

CIVIL ENGINEER

HALFF ASSOCIATES, INC.
3803 PARKWOOD BLVD., SUITE 800
FRISCO, TX 75034
TBPE FIRM #F-312
CONTACT: DAN WARFIELD, P.E.
(PH) 214-618-4570