

MARCIE LANE

CAUTION !!!
UNDERGROUND UTILITIES

EXISTING UTILITIES AND UNDERGROUND FACILITIES INDICATED ON THESE PLANS HAVE BEEN LOCATED FROM REFERENCE INFORMATION SUPPLIED BY VARIOUS OWNERS OF THE FACILITIES. THE ENGINEER DOES NOT ACCEPT THE RESPONSIBILITY FOR THE UTILITY LOCATIONS SHOWN. IT SHALL BE THE RESPONSIBILITY OF THE CONTRACTOR TO VERIFY BOTH HORIZONTALLY AND VERTICALLY THE LOCATION OF ALL EXISTING UTILITIES AND UNDERGROUND FACILITIES PRIOR TO CONSTRUCTION, TO TAKE NECESSARY PRECAUTIONS IN ORDER TO PROTECT ALL FACILITIES ENCOUNTERED, AND TO NOTIFY THE ENGINEER PROMPTLY OF ALL CONFLICTS OF THE WORK WITH EXISTING FACILITIES. THE CONTRACTOR SHALL PRESERVE AND PROTECT ALL EXISTING UTILITIES FROM DAMAGE DURING CONSTRUCTION. ANY DAMAGE BY THE CONTRACTOR TO EXISTING UTILITIES SHALL BE REPAIRED BY THE CONTRACTOR AT HIS EXPENSE. CONTACT ALL POSSIBLE UTILITY AND UNDERGROUND FACILITY OWNERS.

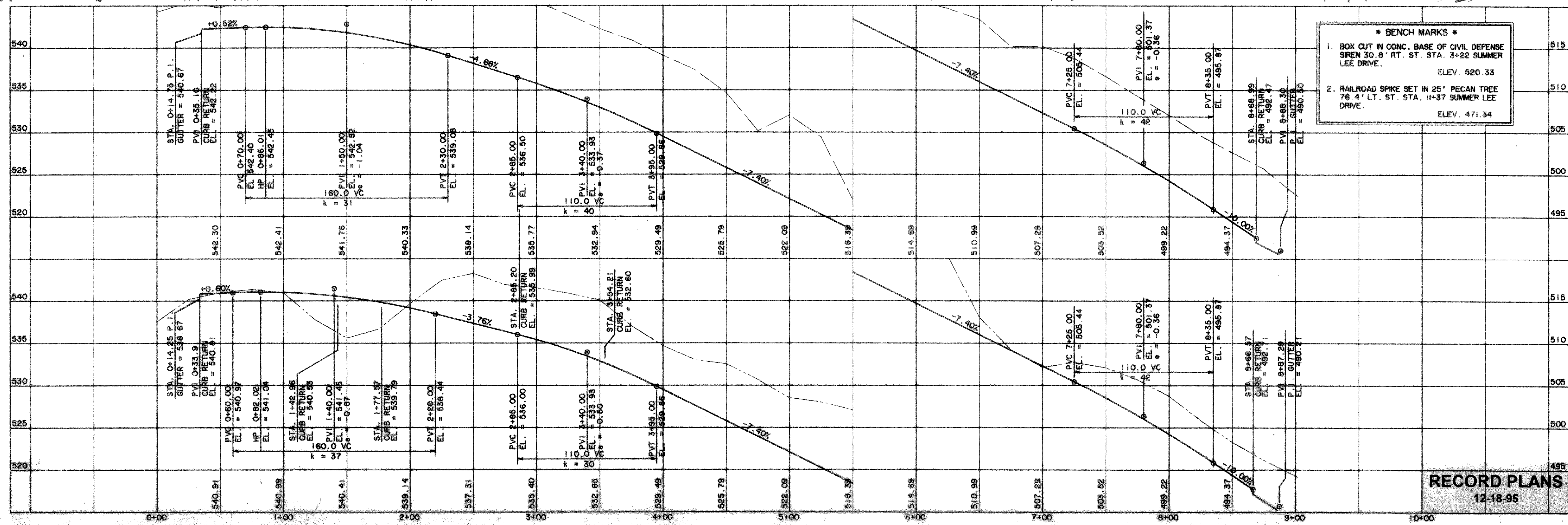

- * BENCH MARKS ***
- BOX CUT IN CONC. BASE OF CIVIL DEFENSE SREN 30.8' RT. ST. STA. 3+22 SUMMER LEE DRIVE. ELEV. 520.33
 - RAILROAD SPIKE SET IN 25' PECAN TREE 76.4' LT. ST. STA. 11+37 SUMMER LEE DRIVE. ELEV. 471.34

RECORD PLANS
 12-18-95

PREPARED BY:
WIER & ASSOCIATES, INC.
 ENGINEERS SURVEYORS LAND PLANNERS
 4300 BELTWAY PLACE SUITE 130 ARLINGTON, TEXAS 76010 (817)467-7700
 3908 SOUTH FREEMAN FORT WORTH, TEXAS 76110 (817)926-0212

CITY OF ROCKWALL
ROCKWALL COUNTY, TEXAS

MARCIE LANE
PLAN AND PROFILES
STA. 0+00 TO STA. END

STATE OF TEXAS
 JULY 1986
 40864
 REGISTERED
 PROFESSIONAL ENGINEER

COPYRIGHT ©
 WIER & ASSOCIATES, INC.
 ALL RIGHTS RESERVED
 DATE 09-01-95
 FILE PAVEB
 WA# 93049

SHEET NO.
 15