

# LA MADELEINE RESTAURANT

## ROCKWALL CROSSING

### ROCKWALL, TEXAS

#### SHEET INDEX

SHEET #	DESCRIPTION
C1.0	COVER SHEET
C2.0	PLAT
C2.1	EROSION/SEDIMENTATION CONTROL PLAN
C2.2	SURVEY & DEMOLITION PLAN
C3.0	SITE & DEMENSION CONTROL PLAN
C4.0	UTILITY PLAN
C5.0	GRADING PLAN
C5.1	STORM DRAIN PLAN & PROFILE
C5.2	CHANNEL PLAN & PROFILE
C5.3	CHANNEL PLAN & PROFILE
C5.4	DRAINAGE AREA MAP & CALCULATIONS
C6.0	DETAILS
C6.1	DETAILS
LA-1	LANDSCAPE PLAN
LA-2	LANDSCAPE SPECIFICATIONS

**OWNER/DEVELOPER:**  
 ROCKWALL CROSSING LTD.  
 2100 WEST 7TH STREET  
 FORT WORTH, TEXAS 76107  
 PHONE: (817) 377-7736  
 FAX: (817) 735-4738  
 CONTACT: DON DALTON

**CIVIL ENGINEER:**  
 THE WALLACE GROUP, INC.  
 3636 EXECUTIVE CENTER DRIVE, SUITE 210  
 AUSTIN, TEXAS 78731  
 PHONE: (512) 833-6828  
 FAX: (512) 833-6811  
 CONTACT: ROBERT D. CALDERON, P.E.

**ARCHITECT:**  
 HERSCHMAN ARCHITECTS  
 25001 EMERY ROAD, SUITE 400  
 CLEVELAND, OHIO 44128  
 PHONE: (216) 223-3230  
 FAX: (216) 223-3210  
 CONTACT: JIM FREEMAN, A.I.A.

**GEOTECHNICAL ENGINEER:**  
 REED ENGINEERING GROUP  
 2424 STUTZ DRIVE, SUITE 400  
 DALLAS, TEXAS 75235  
 PHONE: (214) 350-5600  
 FAX: (214) 350-0019  
 CONTACT: RONALD F. REED, P.E.

**GENERAL NOTES:**

- ALL WORK ON THIS PROJECT/CONTRACT SHALL COMPLY WITH ALL REQUIREMENTS OF THE CITY OF ROCKWALL AND OTHER AUTHORITIES HAVING JURISDICTION.
- REFER TO CITY OF ROCKWALL SPECIAL PROVISIONS TO SECTION II, STANDARD DRAWINGS OF THE STANDARD SPECIFICATIONS FOR PUBLIC WORKS CONSTRUCTION, NORTH CENTRAL TEXAS COUNCIL OF GOVERNMENTS, THIRD EDITION, 1998 (CITY REVISIONS - AUGUST 2003).
- THE LOCATION OF EXISTING UNDERGROUND UTILITIES SHOWN ON THESE PLANS WAS COMPILED FROM RECORD INFORMATION. NO WARRANTY IS IMPLIED AS TO THE ACTUAL LOCATION OF EXISTING UNDERGROUND UTILITIES.
- CONTRACTOR SHALL PROTECT ALL EXISTING UTILITIES FROM DAMAGE. THE CONTRACTOR AT ITS EXPENSE SHALL IMMEDIATELY REPAIR ANY DAMAGE TO EXISTING FACILITIES CAUSED BY THE CONTRACTOR'S OPERATIONS AND NOTIFY THE APPLICABLE UTILITY COMPANY.
- CONTRACTOR SHALL NOTIFY AND COOPERATE WITH APPLICABLE UTILITY COMPANY TO MAINTAIN EXISTING UTILITY SERVICES TO THE SATISFACTION OF THE UTILITY COMPANY AND ITS CUSTOMERS.
- CONTRACTOR SHALL LOCATE AT ITS EXPENSE ALL EXISTING UTILITIES AT LEAST TWO WEEKS PRIOR TO CONSTRUCTION AND IMMEDIATELY NOTIFY THE ENGINEER IF FIELD CONDITIONS VARY FROM THOSE SHOWN ON THE PLANS.

RE-PLAT LOT 8, BLOCK A OF ROCKWALL CROSSING

\*\*\*

### PROJECT LOCATION MAP

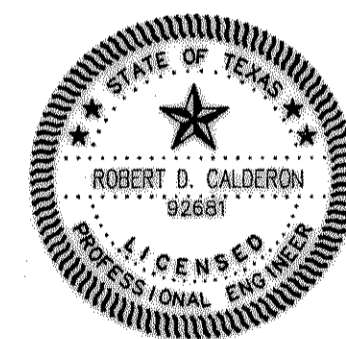
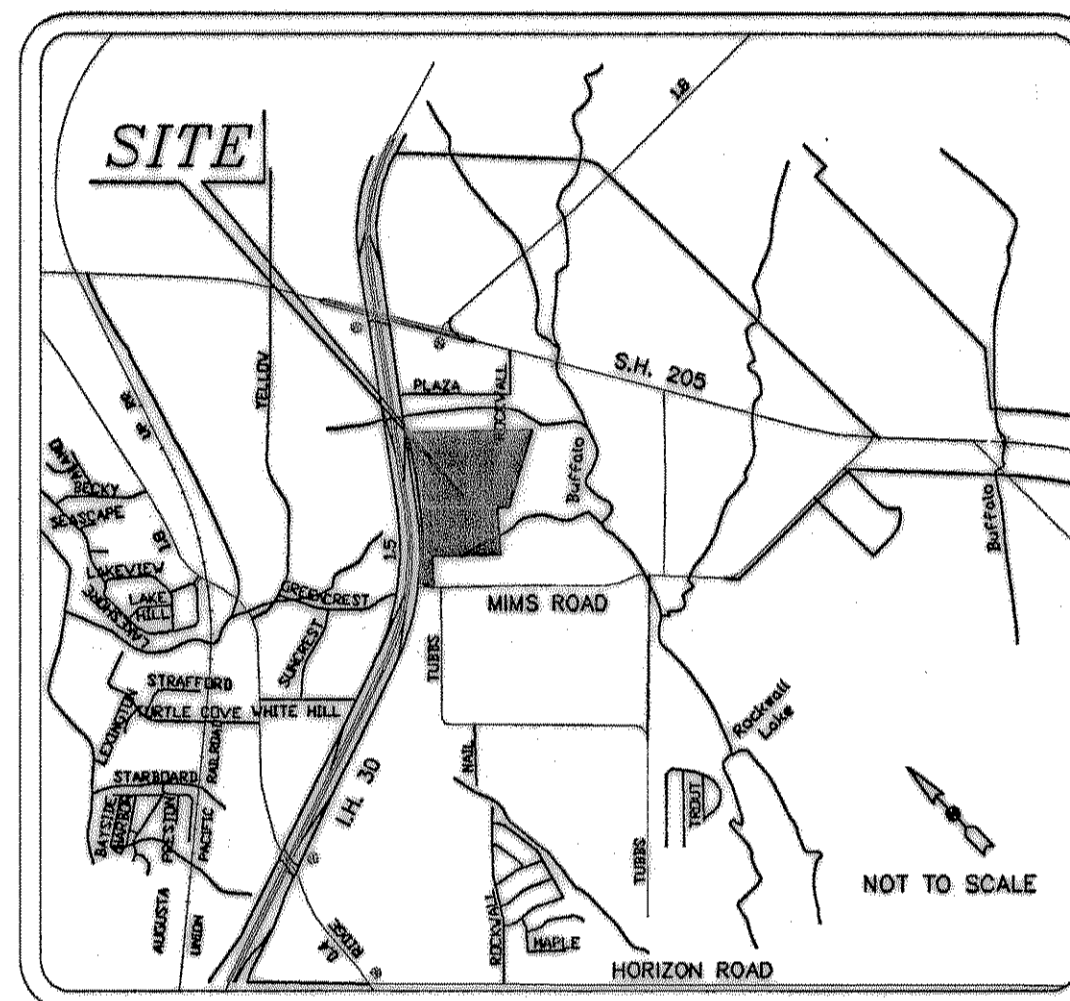

SUBMITTED BY: *RDC* ROBERT D. CALDERON, P.E. #92681 DATE 11-16-06  
 THE WALLACE GROUP, INC.

I, ROBERT D. CALDERON, P.E., CERTIFY THAT THESE ENGINEERING DOCUMENTS ARE COMPLETE, ACCURATE AND ADEQUATE FOR THE INTENDED PURPOSES, INCLUDING CONSTRUCTION, BUT ARE NOT AUTHORIZED FOR CONSTRUCTION PRIOR TO FORMAL CITY APPROVAL.

**RECORD DRAWING**  
 THESE PLANS HAVE BEEN REVISED TO REFLECT FIELD CHANGES AS INDICATED BY CONSTRUCTION RECORDS.  
 DATE 11-16-06

CONTRACTOR SHALL CALL 1-800-DIG-TESS FOR UTILITY LOCATIONS PRIOR TO ANY WORK IN EASEMENTS OR RIGHT-OF-WAY

**W** The Wallace Group, Inc.  
 Engineers ■ Architects ■ Planners ■ Surveyors

- WATER/WASTEWATER
- ENVIRONMENTAL
- STREETS/DRAINAGE
- BUILDING DESIGN
- FACILITIES MANAGEMENT



- MECHANICAL
- ELECTRICAL
- STRUCTURAL
- CADD
- GIS

3636 EXECUTIVE CENTER DRIVE, SUITE 210, AUSTIN, TEXAS 78731 PH: (512) 833-6828 FAX: (512) 833-3811

