

VICINITY MAP
NOT TO SCALE

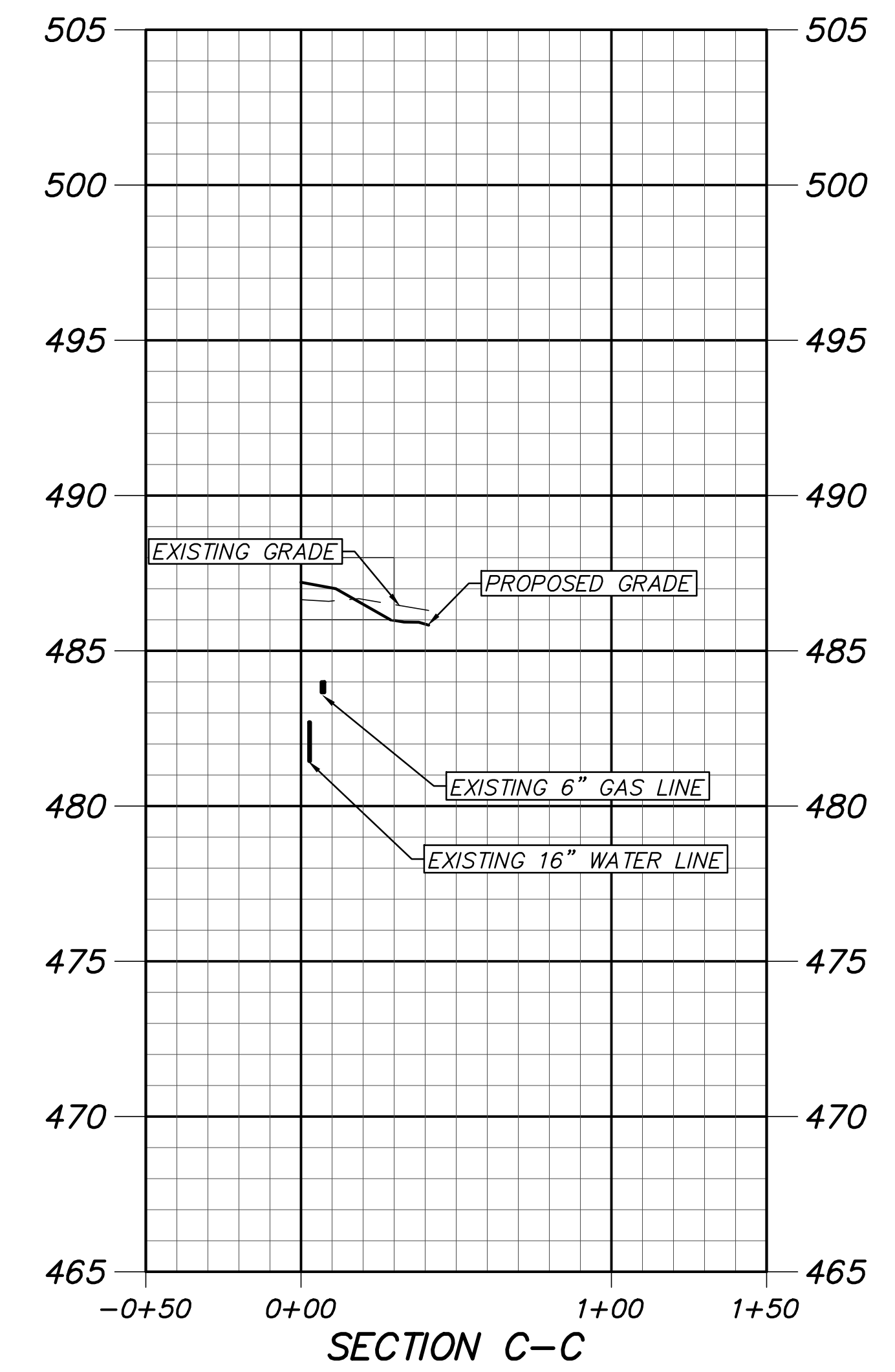
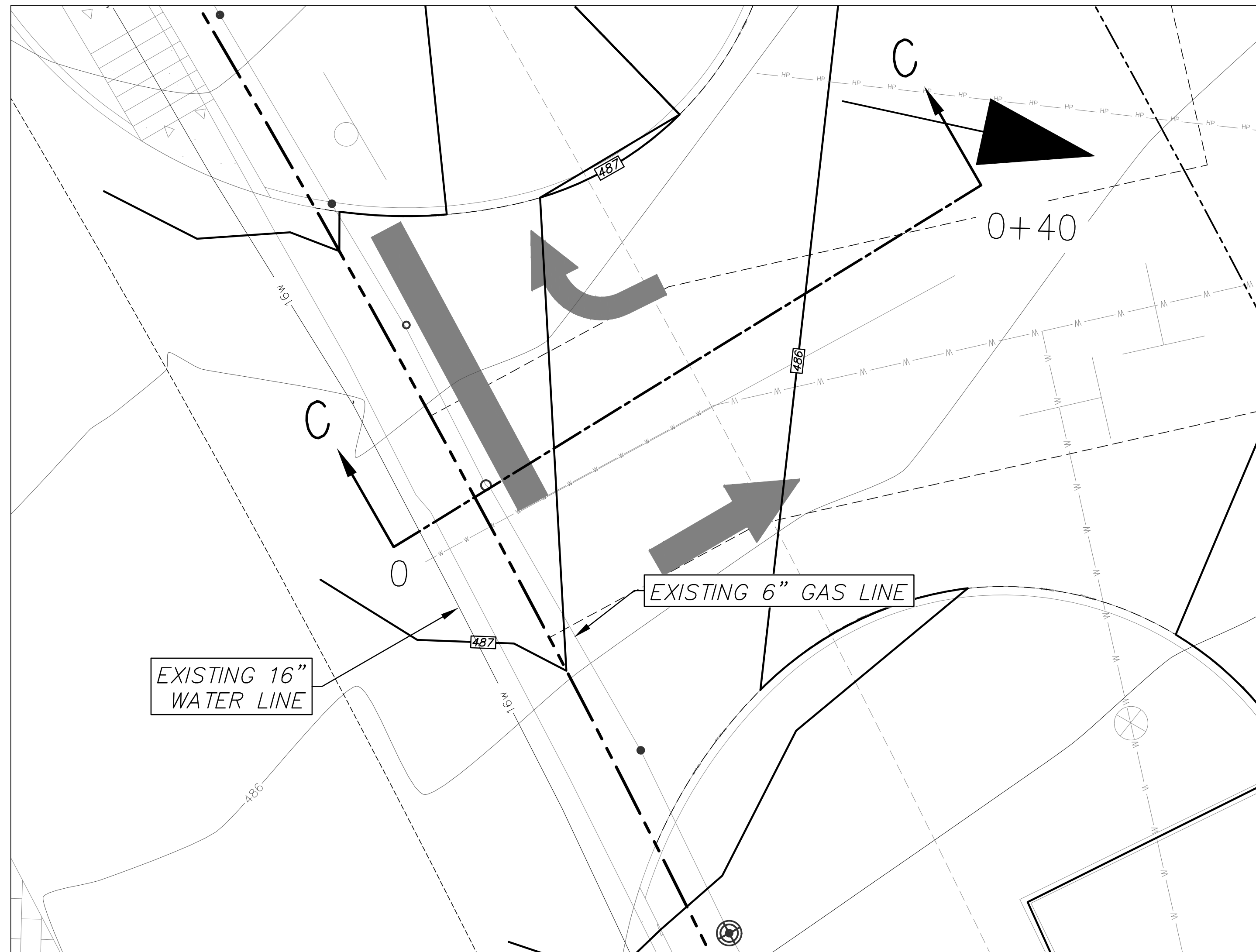
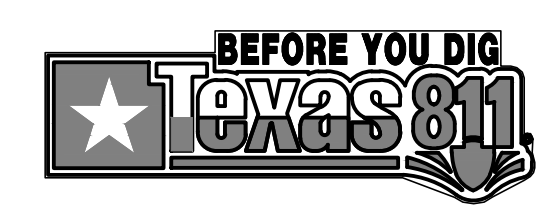

BENCH MARKS:

BM#1 - "X" cut inside of "d" cut at the centerline of a curb inlet, southeasterly curb line of Quail Run, ±23.6 feet northeast of the POINT OF BEGINNING.
ELEVATION - 482.71 feet

BM#2 - "X" cut at the southeast end of a curb inlet, northeasterly curb line of Memorial Drive, ±13.4 feet southeast of the southeast property corner.
ELEVATION - 472.19 feet

*****NOTICES TO CONTRACTOR*****

EXISTING UNDERGROUND/BURIED PUBLIC, PRIVATE, AND FRANCHISE UTILITIES/FACILITIES AFFECT THIS SITE, AND ARE DEPICTED ON THE PLANS PER THE BEST AVAILABLE INFORMATION AT THE TIME THE PLANS WERE PRODUCED. WINKELMANN & ASSOC., INC. SHALL NOT BE RESPONSIBLE FOR KNOWING THE EXACT LOCATION OF ALL FACILITIES OR DEPICTING EXACT LOCATIONS OF SAID FACILITIES ON THE PLANS BEYOND WHAT IS STATED ABOVE.

CONTRACTOR(S) SHALL CALL "811" A MINIMUM OF 48 HOURS PRIOR TO BEGINNING WORK ON THE SITE, AND SHALL NOT BEGIN ANY EXCAVATION OR DEMOLITION ACTIVITIES UNTIL AFTER SAID FACILITIES HAVE BEEN MARKED AND/OR FLAGGED PER "811" OR THE FACILITY OWNERS.

CONTRACTOR(S) SHALL BE WHOLLY RESPONSIBLE FOR ANY DAMAGE THAT MAY OCCUR TO SAID FACILITIES DUE TO WORK BEING DONE WITHOUT FOLLOWING THE PROCEDURES ABOVE.

ALL RESPONSIBILITY FOR ADEQUACY OF DESIGN REMAINS WITH THE DESIGN ENGINEER. THE CITY OF ROCKWALL, IN REVIEWING AND RELEASING PLANS FOR CONSTRUCTION, ASSUMES NO RESPONSIBILITY FOR ADEQUACY OR ACCURACY OF DESIGN.

AS-BUILT

THIS RECORD DRAWING IS COMPILATION OF A COPY OF THE SEALED ENGINEERING DRAWING FOR THIS PROJECT; MODIFIED BY ADDENDA, CHANGE ORDERS, AND INFORMATION FURNISHED BY THE CONTRACTOR. THE INFORMATION SHOWN ON THE RECORD DRAWINGS IS PROVIDED BASED ON SURVEYING AT THE SITE AND INFORMATION PROVIDED BY THE CONTRACTOR OR OTHERS NOT ASSOCIATED WITH THE DESIGN ENGINEER. THE ORIGINAL SEALED DRAWING ARE ON FILE AT THE OFFICES OF WINKELMANN AND ASSOCIATES, INC.

Maria C. Boilla 10-19-2016
WINKELMANN AND ASSOCIATES, INC. DATE

LEGEND

PP	Power Pole	IRF	Iron Rod Found
CW	Guy Wire	IRS	Iron Rod Set
MH	Manhole	CIRS	Iron Rod Set w/ cap "WAI"
WV	Water Valve	CIRF	Iron Rod Found w/ cap
TP	Telephone Pedestal	XCS	"X" Cut in Concrete Set
WM	Water Meter	PKC	PK Cut in Concrete Found
FH	Fire Hydrant	PKF	PK Nail Found
LP	Light Pole	SS	Sanitary Sewer
IV	Irrigation Valve	SW	Storm Sewer
CO	Clean Out	TF	Transformer pad
AC	Air Conditioner	GM	Gas Meter
TV	Cable Box	GMK	Gas Marker
SB	Signal Box	TSN	Traffic Sign
SP	Signal Pole	UGC	Underground Cable Marker
SN	Sign	EB	Electric Box
CM	Control Monument	EM	Electric Meter

6.					
5.					
4.					
3.					
2.	12/18/2015	ISSUE FOR CONSTRUCTION	M.B.		
1.	12/09/2015	BULLETIN #1	M.B.		
No.		REVISION	DATE		APPROV

Winkelmann & Associates, Inc.
CONSULTING CIVIL ENGINEERS ■ SURVEYORS
1720 HILGRET PLAZA DRIVE, SUITE 325
ROCKWALL, TEXAS 75087
(972) 940-7090
FAX (972) 940-7098
Surveyors Registration No. 89
Professional Engineer Registration No. 100866-00
Surveyor of Public Infrastructure & Associates, Inc.

STATE OF TEXAS
MARIA C. BOILLA-NICHOLS
10016
LICENSED
PROFESSIONAL ENGINEER

10-19-2016
THE SEAL APPEARING ON THIS DOCUMENT WAS AUTHORIZED BY MARIA C. BOILLA-NICHOLS, P.E. # 100106

FUEL CENTER DRIVE CROSS SECTION
SEC. N. GOLIAD ST. AND E. QUAIL RUN RD., ROCKWALL, TEXAS

C-13.11
DAL574

G:\1315\ENGINEERING\Construction\Plans\1315-EX UTILITIES.dwg
J:\9855.00

LAST SAVED BY: MMHOLLAND October 20, 2016