

VICINITY MAP
NOT TO SCALE

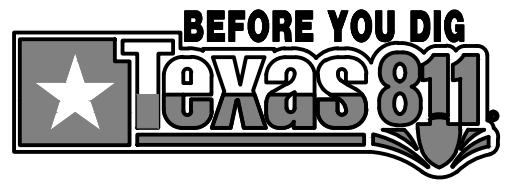

BULLETIN #	DATE	REVISION
6.	04/05/2016	
5.	02/23/2016	RESPONSE TO RFI 004
4.	02/16/2016	RESPONSE TO RFI 020
3.	02/16/2016	ISSUE FOR CONSTRUCTION
2.	12/18/2015	
1.	12/09/2015	

Winkelman & Associates, Inc.
CONSULTING CIVIL ENGINEERS
7070 HILLCREST PLAZA DRIVE, SUITE 325
DALLAS, TEXAS 75231
(972) 490-7099
Professional Registration No. 89
Professional Engineer Registration No. 101066-00
Professional Engineer Registration No. 101066-00
Professional Engineer Registration No. 101066-00

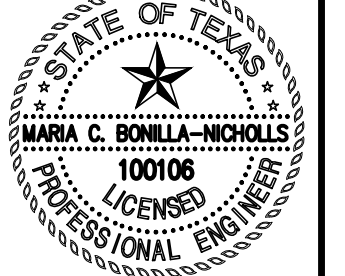

10-19-2016
THE SEAL APPEARING ON THIS DOCUMENT WAS AUTHORIZED BY MARIA C. BONILLA-NICHOLS, P.E. # 10106

STORM PLAN
SEC. N. GOLIAD ST. AND E. QUAIL RUN RD., ROCKWALL, TEXAS

C-11.02
DAL574

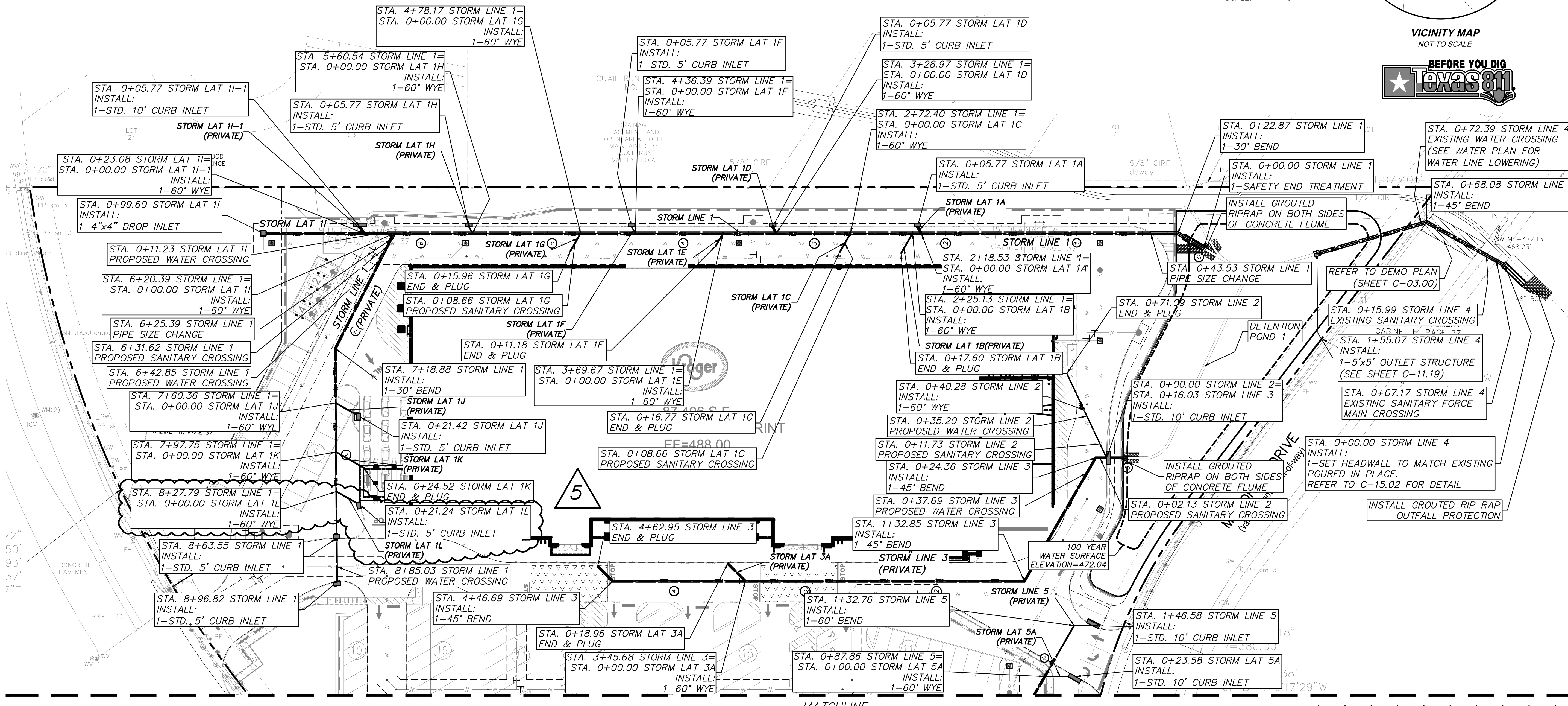

BENCH MARKS:
BM#1 - "X" cut inside of "a" cut at the centerline of a curb inlet, southeasterly curb line of Quail Run, ±23.6 feet northeast of the POINT OF BEGINNING.
ELEVATION - 482.71 feet
BM#2 - "X" cut at the southeast end of a curb inlet, northeasterly curb line of Memorial Drive, ±13.4 feet southeast of the southeast property corner.
ELEVATION - 472.19 feet

ALL RESPONSIBILITY FOR ADEQUACY OF DESIGN REMAINS WITH THE DESIGN ENGINEER. THE CITY OF ROCKWALL, IN REVIEWING AND RELEASING PLANS FOR CONSTRUCTION, ASSUMES NO RESPONSIBILITY FOR ADEQUACY OR ACCURACY OF DESIGN.

- NOTES:**
- REFER TO GRADING PLAN FOR ALL RIM ELEVATIONS
 - GENERAL CONTRACTOR IS TO COORDINATE WITH KROGER BUILDING CONTRACTOR TO CONFIRM ALL UTILITY CONNECTIONS PRIOR TO INSTALLATION. GENERAL CONTRACTOR TO INSTALL ALL UTILITIES 4' FROM BUILDING FACE

AS-BUILT
THIS RECORD DRAWING IS COMPILATION OF A COPY OF THE SEALED ENGINEERING DRAWING FOR THIS PROJECT; MODIFIED BY ADDENDA, CHANGE ORDERS, AND INFORMATION FURNISHED BY THE CONTRACTOR. THE INFORMATION SHOWN ON THE RECORD DRAWINGS IS PROVIDED BASED ON SURVEYING AT THE SITE AND INFORMATION PROVIDED BY THE CONTRACTOR OR OTHERS NOT ASSOCIATED WITH THE DESIGN ENGINEER. THE ORIGINAL SEALED DRAWING ARE ON FILE AT THE OFFICES OF WINKELMANN AND ASSOCIATES, INC.
Maria C. Bonilla
WINKELMANN AND ASSOCIATES, INC. 10-19-2016 DATE

LEGEND

PP	Power Pole	IRF	Iron Rod Found
GW	Guy Wire	IRS	Iron Rod Set
MH	Manhole	CIRS	Iron Rod Set w/ cap "WAI"
WV	Water Valve	CIRF	Iron Rod Found w/ cap
TP	Telephone Pedestal	XCS	Cut in Concrete Set
WM	Water Meter	XCF	Cut in Concrete Found
FH	Fire Hydrant	PKS	PK Nail Set
LP	Light Pole	PKF	PK Nail Found
IV	Irrigation Valve	SS	Sanitary Sewer
CO	Clean Out	SW	Storm Sewer
AC	Air Conditioner	TF	Transformer pad
TV	Cable Box	GM	Gas Meter
SB	Signal Box	GMK	Gas Marker
SN	Signal Pole	TSN	Traffic Sign
SN	Sign	UCG	Underground Cable Marker
CM	Control Monument	EB	Electric Box
		EM	Electric Meter

*****NOTICES TO CONTRACTOR*****
EXISTING UNDERGROUND/BURIED PUBLIC, PRIVATE, AND FRANCHISE UTILITIES/FACILITIES AFFECT THIS SITE, AND ARE DEPICTED ON THE PLANS PER THE BEST AVAILABLE INFORMATION AT THE TIME THE PLANS WERE PRODUCED. WINKELMANN & ASSOC., INC. SHALL NOT BE RESPONSIBLE FOR KNOWING THE EXACT LOCATION OF ALL FACILITIES OR DEPICTING EXACT LOCATIONS OF SAID FACILITIES ON THE PLANS BEYOND WHAT IS STATED ABOVE.
CONTRACTOR(S) SHALL CALL "811" A MINIMUM OF 48 HOURS PRIOR TO BEGINNING WORK ON THE SITE, AND SHALL NOT BEGIN ANY EXCAVATION OR DEMOLITION ACTIVITIES UNTIL AFTER SAID FACILITIES HAVE BEEN MARKED AND/OR FLAGGED PER "811" OR THE FACILITY OWNERS.
CONTRACTOR(S) SHALL BE WHOLLY RESPONSIBLE FOR ANY DAMAGE THAT MAY OCCUR TO SAID FACILITIES DUE TO WORK BEING DONE WITHOUT FOLLOWING THE PROCEDURES ABOVE.