

IF GENERAL CONTRACTOR SELECTS TO USE OTHER WALL CONTRACTOR, MUST SUBMIT SIGNED AND SEALED PLANS.

LEGEND

PP	Power Pole	IRF	Iron Rod Found
GW	Guy Wire	IRS	Iron Rod Set
MH	Manhole	CIRS	Iron Rod Set w/ cap "WAI"
WV	Water Valve	IRF	Iron Rod Found w/ cap
TP	Telephone Pedestal	XOC	cut in Concrete Found
WM	Water Meter	PK	PK Nail Set
FH	Fire Hydrant	PK	PK Nail Found
LP	Light Pole	SS	Sanitary sewer
IV	Irrigation Valve	SW	Storm Sewer
CO	Clean Out	TF	Transformer pad
AC	Air Conditioner	GM	Gas Meter
TV	Cable Box	GMK	Gas Marker
SB	Signal Box	TSN	Traffic Sign
SP	Signal Pole	UCG	Underground Cable Marker
SN	Sign	EB	Electric Box
CM	Control Monument	EM	Electric Meter

*****NOTICES TO CONTRACTOR*****

EXISTING UNDERGROUND/BURIED PUBLIC, PRIVATE, AND FRANCHISE UTILITIES/FACILITIES AFFECT THIS SITE, AND ARE DEPICTED ON THE PLANS PER THE BEST AVAILABLE INFORMATION AT THE TIME THE PLANS WERE PRODUCED. WINKELMANN & ASSOC., INC. SHALL NOT BE RESPONSIBLE FOR KNOWING THE EXACT LOCATION OF ALL FACILITIES OR DEPICTING EXACT LOCATIONS OF SAID FACILITIES ON THE PLANS BEYOND WHAT IS STATED ABOVE.

CONTRACTOR(S) SHALL CALL "811" A MINIMUM OF 48 HOURS PRIOR TO BEGINNING WORK ON THE SITE, AND SHALL NOT BEGIN ANY EXCAVATION OR DEMOLITION ACTIVITIES UNTIL AFTER SAID FACILITIES HAVE BEEN MARKED AND/OR FLAGGED PER "811" OR THE FACILITY OWNERS.

CONTRACTOR(S) SHALL BE WHOLLY RESPONSIBLE FOR ANY DAMAGE THAT MAY OCCUR TO SAID FACILITIES DUE TO WORK BEING DONE WITHOUT FOLLOWING THE PROCEDURES ABOVE.

AS-BUILT

THIS RECORD DRAWING IS COMPILATION OF A COPY OF THE SEALED ENGINEERING DRAWING FOR THIS PROJECT; MODIFIED BY ADDENDA, CHANGE ORDERS, AND INFORMATION FURNISHED BY THE CONTRACTOR. THE INFORMATION SHOWN ON THE RECORD DRAWINGS IS PROVIDED BASED ON SURVEYING AT THE SITE AND INFORMATION PROVIDED BY THE CONTRACTOR OR OTHERS NOT ASSOCIATED WITH THE DESIGN ENGINEER. THE ORIGINAL SEALED DRAWING ARE ON FILE AT THE OFFICES OF WINKELMANN AND ASSOCIATES, INC.

Maria L. Borilla
 WINKELMANN AND ASSOCIATES, INC. 10-19-2016 DATE

BULLETIN #	DATE	REVISION
6.	04/05/2016	RESPONSE TO MIA-SURVEY
5.	03/11/2016	REVISION #1
4.	07/27/2016	ISSUE FOR CONSTRUCTION
3.	12/18/2015	BULLETIN #1
2.	12/09/2015	REVISION
1.		
No.		

Winkelmann & Associates, Inc.
 CONSULTING CIVIL ENGINEERS • SURVEYORS
 1720 HILGREN PLAZA DRIVE, SUITE 325
 ROCKWALL, TEXAS 75087
 (972) 460-7099
 (972) 460-7098 FAX
 State Engineer Registration No. 89
 State Surveyor Registration No. 103666-00
 State Professional Engineer Registration No. 100106
 State Professional Engineer Registration No. 100106

10-19-2016
 THE SEAL APPEARING ON THIS DOCUMENT WAS AUTHORIZED BY MARIA C. BORILLA-NICHOLS, P.E. # 100106

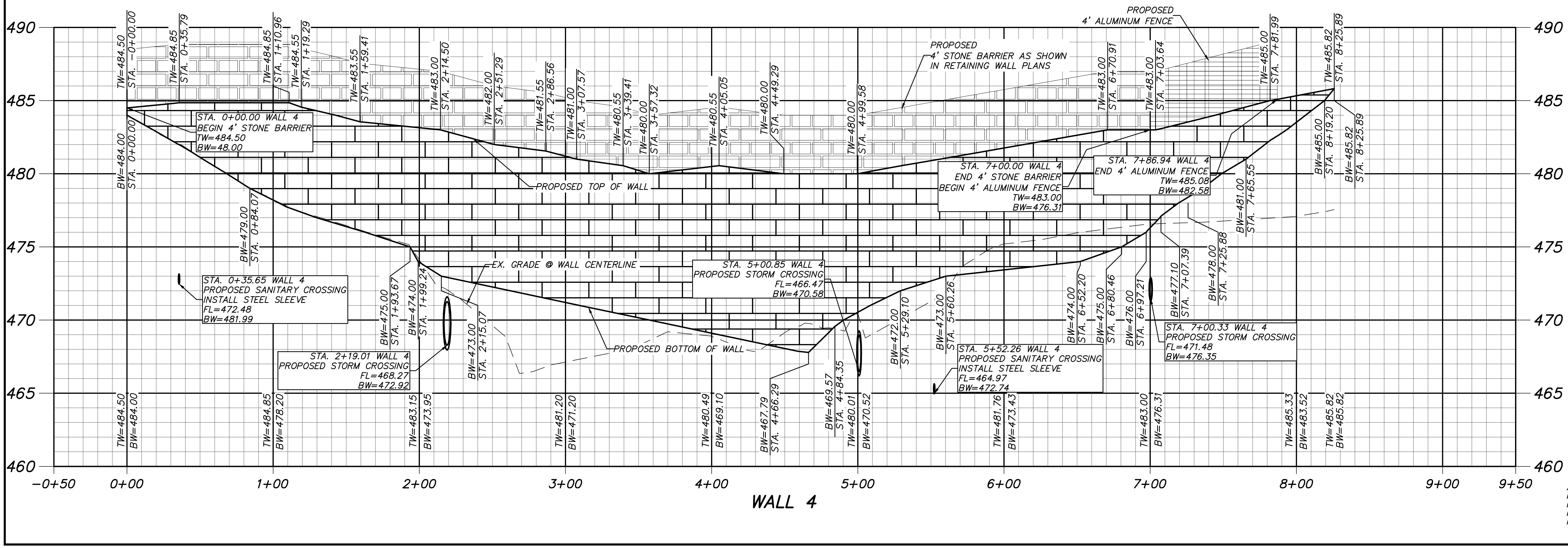

GRADING LEGEND

---	493	EXISTING CONTOURS
---	488	PROP. CONTOURS
---	---	RETAINING WALL
---	---	GRADE BREAK HP
---	---	GRADE BREAK LP

WALL 4 PROFILE
 SEC. N. GOLIAD ST. AND E. QUAIL RUN RD., ROCKWALL, TEXAS

ALL RESPONSIBILITY FOR ADEQUACY OF DESIGN REMAINS WITH THE DESIGN ENGINEER. THE CITY OF ROCKWALL, IN REVIEWING AND RELEASING PLANS FOR CONSTRUCTION, ASSUMES NO RESPONSIBILITY FOR ADEQUACY OR ACCURACY OF DESIGN.

C-08.09
 DAL574