

LEGEND

EXISTING		PROPOSED	
---	BOUNDARY LINE	---	BOUNDARY LINE
---	RIGHT OF WAY LINE	---	GRADE BREAK
---	STORM DRAIN	---	SUB AREA
---	GAS	---	ACRES
---	OVERHEAD ELECTRIC	---	9.00
---	OVERHEAD ELECTRIC AND TELEPHONE	---	DRAINAGE AREA DIVER
---	OVERHEAD TELEPHONE	---	EXISTING DRAINAGE AREA DIVER
---	OVERHEAD TV	---	
---	SEWER	---	
---	UNDERGROUND ELECTRIC	---	
---	UNDERGROUND ELECTRIC AND TELEPHONE	---	
---	UNDERGROUND TV	---	
---	UNDERGROUND WATER	---	
---	EAST OR ELECTRIC	---	
---	OVERHEAD	---	
---	SOUTH OR SEWER	---	
---	TELEPHONE	---	
---	UNDERGROUND	---	
---	WEST OR WATER	---	

PRE DEVELOPMENT RUNOFF SUMMARY

Area No.	Total Area (Ac.)	Average Runoff Coefficient "C"	TC (1100 cfs)	Q100 (cfs)
E	0.62	0.8	10.0 9.80	4.90

SHEET FLOW TO INLET A

POST DEVELOPMENT RUNOFF SUMMARY

Area No.	Total Area (Ac.)	Average Runoff Coefficient "C"	TC (1100 cfs)	Q100 (cfs)
A	0.64	0.9	10.0 9.80	5.65

SHEET FLOW TO INLET A
INLET A LOCATION ADJUSTED ON POST DEVELOPMENT

INLET CALCULATIONS

INLET #	INLET TYPE	INLET SIZE (CFS)	Q100 DEPTH HD (CFS)	HEADWATER DEPTH (CFS)	INLET CAPACITY, DEPTH (CFS)
1	CURB INLET (SAG)	5'	5.65	0.5'	7.42

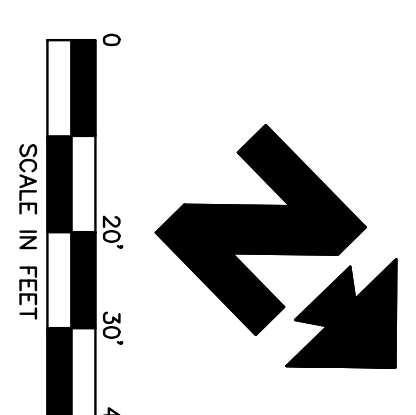
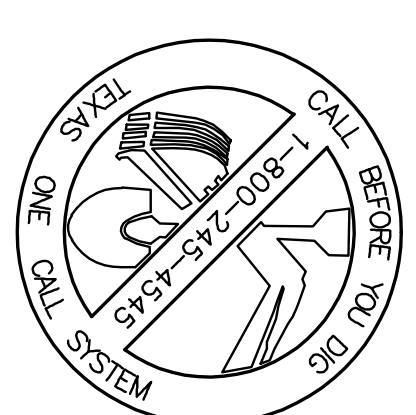
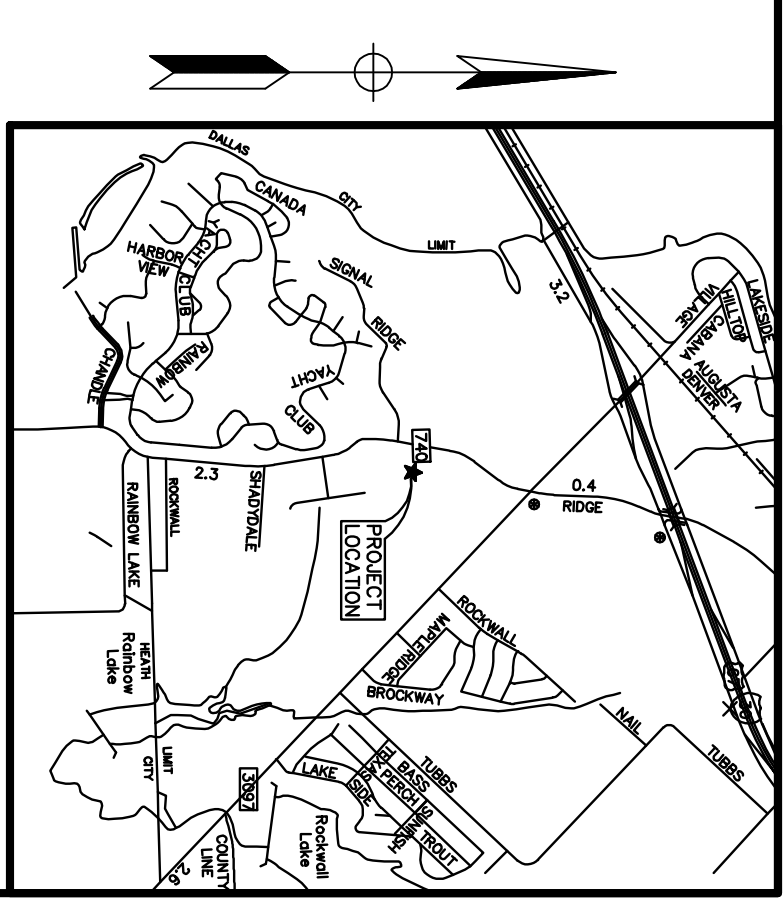

BENCHMARK INFORMATION:
 BM #1 - AN "X" CUT FOUND ELEVATION = 563.79
 BM #2 - A PK NAIL FOUND ELEVATION = 566.80

ALL RESPONSIBILITY FOR ADEQUACY OF DESIGN REMAINS WITH THE DESIGN ENGINEER. THE CITY OF ROCKWALL, IN REVIEWING AND RELEASING PLANS FOR CONSTRUCTION, ASSUMES NO RESPONSIBILITY FOR ADEQUACY OR ACCURACY OF DESIGN.

INITIAL DESIGN DATE 11/28/71 LWP GMD TZA LZA
 DATE FRN FMW DES DRW

KROGER SW-575 FUEL CENTER

Engineering Associates, Inc.
 ENGINEERS PLANNERS SURVEYORS
 LANDSCAPE ARCHITECTS ENVIRONMENTAL SCIENTISTS

3030 LeBlanc Freeway, Suite 100
 Dallas, TX 75234 (972) 488-3737
 (972) 488-6732

AS-BUILT



DRAINAGE PLAN
 2935 RIDGE ROAD
 ROCKWALL, TEXAS
 DATE 12/1/11 10:07 AM
 SHEET NO. C41 OF 11
 F-7524