

TYPICAL PAVING SECTION

TEMPORARY WEIR SECTION

BENCH MARK
Top of exist. M.H. in intersection of
Stimson St. & Joe White St. - Elev. 511.98

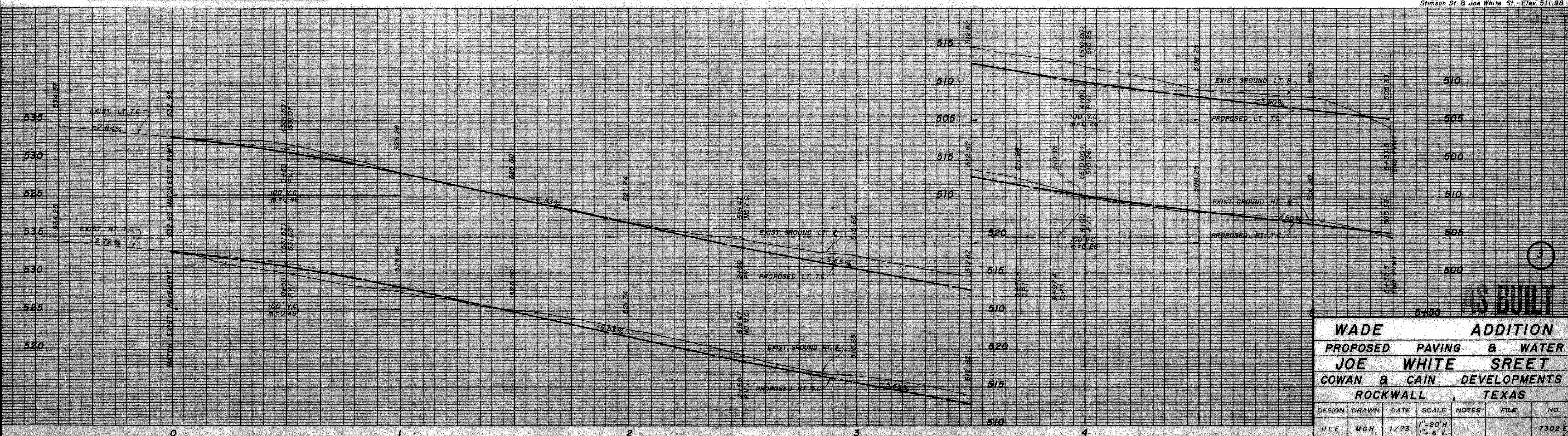

WADE		ADDITION	
PROPOSED PAVING & WATER			
JOE WHITE STREET			
COWAN & CAIN DEVELOPMENTS			
ROCKWALL, TEXAS			
DESIGN	DRAWN	DATE	SCALE
HLE	MGH	1/73	1"=20'H 1"=6'V.
FILE	NO.		
	7302 E		