

NOTE:  
 1. Contractors shall not run heavy construction equipment over existing sewer lines more than necessary and shall be responsible to repair any damage caused by his equipment.  
 2. All sewer taps made to existing sewer mains shall be made with a tapping machine made to tap clay pipe".

$$Q_{top} = (0.56)(26/0.015)(0.0134)^5(0.667)^{2.667}$$

$$Q_{top} = 38.22 \text{ c.f.s.}$$

$$Q_5 = (0.40)(5.4)(17.22)$$

$$Q_5 = 37.19 \text{ c.f.s.}$$

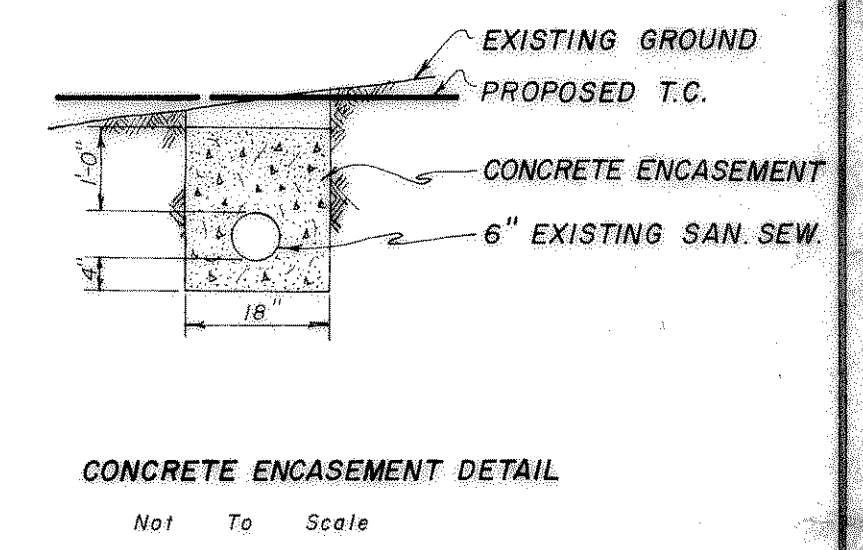
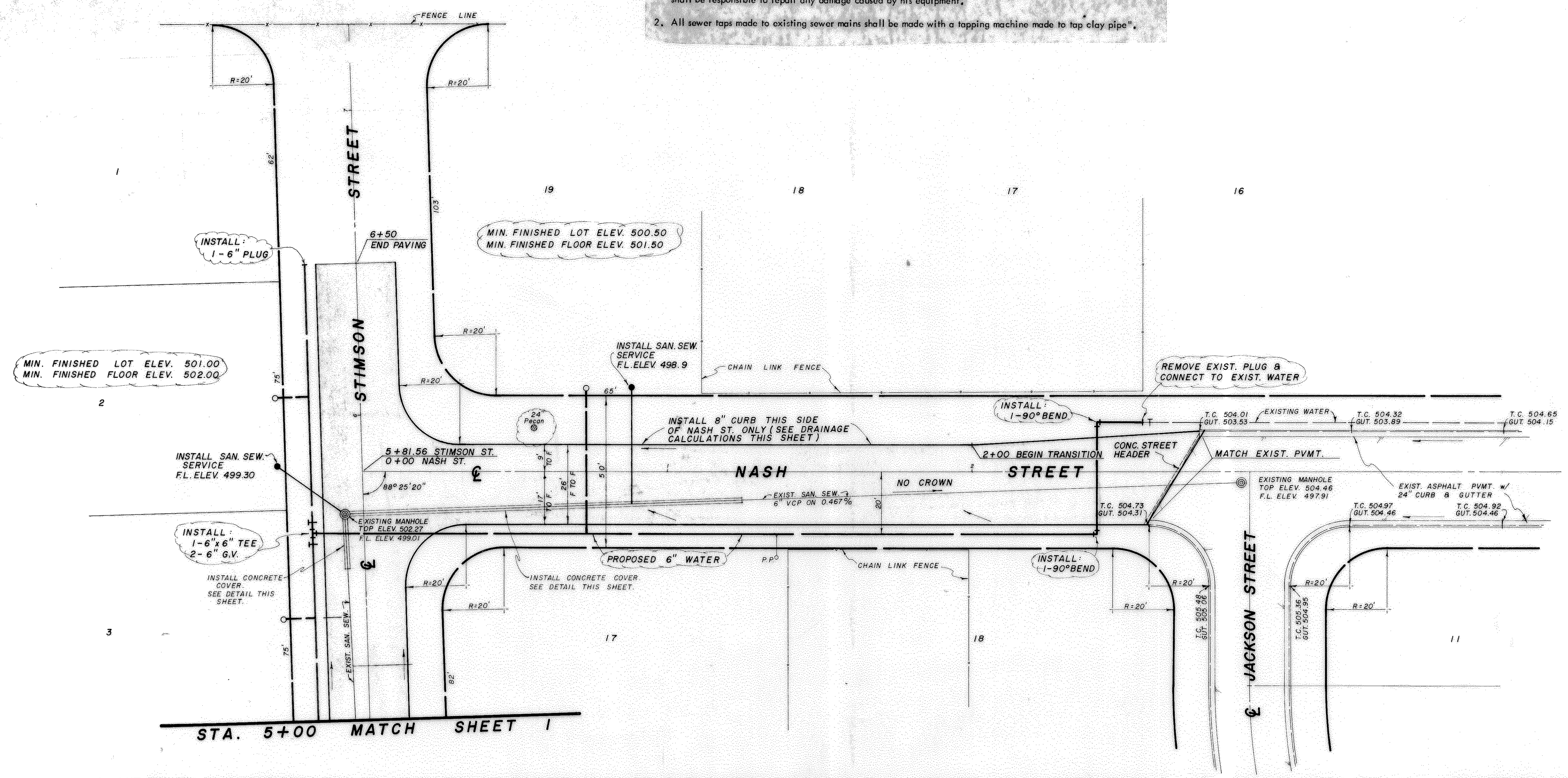

BENCH MARK  
 Top of FH in Joe White St. - 240' south of inter-section with Stimson St. Elev. 527.07

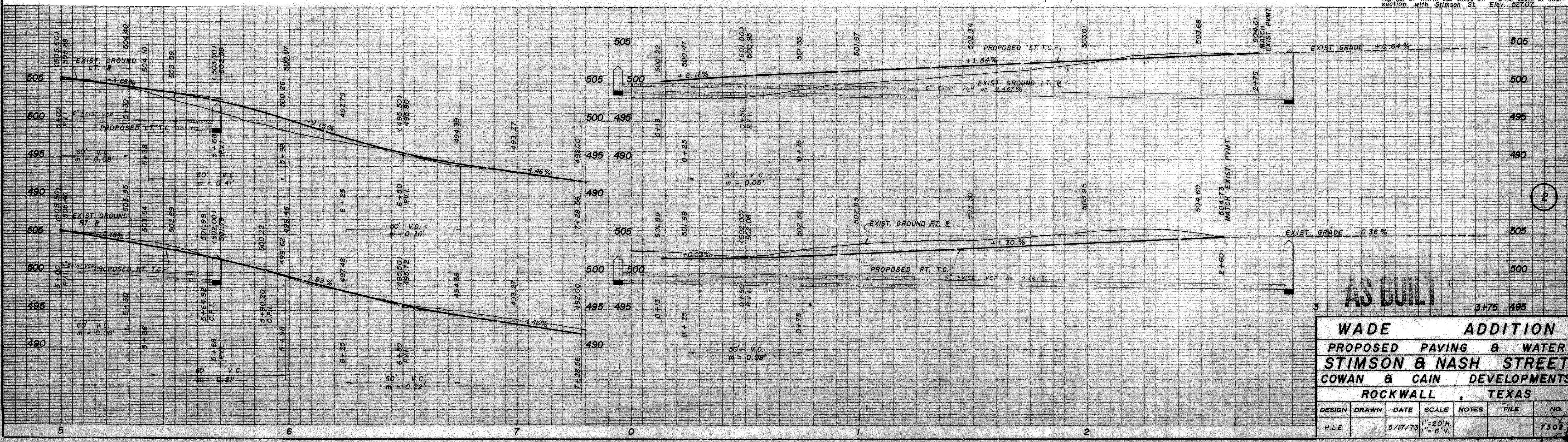

**AS BUILT**

<b>WADE</b>		<b>ADDITION</b>	
<b>PROPOSED PAVING &amp; WATER</b>			
<b>STIMSON &amp; NASH STREET</b>			
<b>COWAN &amp; CAIN DEVELOPMENTS</b>			
<b>ROCKWALL, TEXAS</b>			
DESIGN	DRAWN	DATE	SCALE
H.L.E.		5/17/73	1"=20'H 1"=6'V
FILE	NO.		
	7302		