

"ALL RESPONSIBILITY FOR ADEQUACY OF DESIGN REMAINS WITH THE DESIGN ENGINEER. THE CITY OF ROCKWALL, IN REVIEWING AND RELEASING PLANS FOR CONSTRUCTION, ASSUMES NO RESPONSIBILITY FOR ADEQUACY OR ACCURACY OF DESIGN."

BM: HIGHWAY MONUMENT AT THE NORTH END OF CORNER CLIP AT THE INTERSECTION OF THE SOUTHEAST RIGHT-OF-WAY LINE OF I.H. 30 WITH THE NORTHEAST RIGHT-OF-WAY LINE OF S.H. 205. ELEVATION = 551.36'
 TBM: SQ. CUT ON THE TOP OF THE HEAD WALL AT SOUTHWEST CORNER OF THE PROPERTY. ELEV = 547.74'

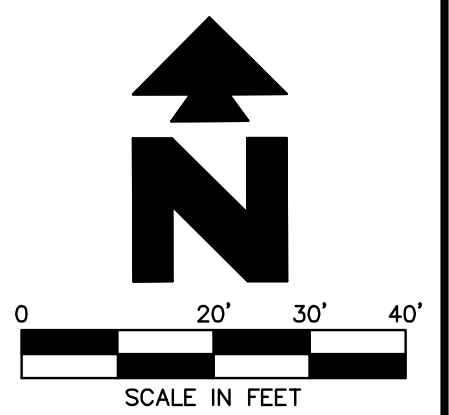

NOTE:
 THE GENERAL CONTRACTOR IS REQUIRED TO VERIFY THE GRADES AND SLOPES FOR ALL ADA SIDEWALKS AND PATHWAYS, PRIOR TO INSTALLING ANY CONCRETE IN THESE SUBJECT AREAS. ALSO, THE GENERAL CONTRACTOR MUST PROVIDE A WRITTEN REPORT TO THE ENGINEER OF RECORD, ARCHITECT OF RECORD AND TO INOB, VERIFYING THAT ALL CONCRETE FORMS FOR ALL ADA SIDEWALKS AND PATHWAYS HAVE MET THE REQUIRED ADA STANDARDS, PRIOR TO INSTALLATION OF ANY CONCRETE IN SAID ADA SIDEWALK AND PATHWAY AREAS.

NOTE:
 SEE ARCHITECTURAL PLANS FOR EXACT LOCATIONS AND DIMENSIONS OF PORCHES, RAMPS, VESTIBULE, SLOPED PAVING, TRUCK DOCKS, BUILDING UTILITY ENTRANCE LOCATIONS AND PRECISE BUILDING DIMENSIONS.

LEGEND

EXISTING					
(Symbol)	GAS METER	(Symbol)	MONITORING WELL	(Symbol)	BOUNDARY LINE
(Symbol)	IRR. CONTROL VALVE	(Symbol)	TRAFFIC SIGNAL POLE	(Symbol)	500 CONTOUR LINE
(Symbol)	TELEPHONE PEDESTAL	(Symbol)	TRAFFIC SIGNAL BOX	(Symbol)	W WATER LINE
(Symbol)	POWER POLE	(Symbol)	AT&T MAN HOLE	(Symbol)	OHE OVERHEAD SERVICE LINE
(Symbol)	DOWN GUY	(Symbol)	GAS MAN HOLE	(Symbol)	SS SANITARY SEWER LINE
(Symbol)	S.S. MAN HOLE	(Symbol)	VAULT	(Symbol)	FOC FIBER OPTIC LINE
(Symbol)	CLEAN OUT	(Symbol)	GRATE INLET	(Symbol)	YL YELLOW PAINT STRIPE LINE
(Symbol)	FIRE HYDRANT	(Symbol)	SIGN	(Symbol)	PS RED PAINT STRIPE LINE
(Symbol)	WATER METER	(Symbol)	LIGHT POLE	(Symbol)	ST STORM SEWER LINE
(Symbol)	FUEL PORT	(Symbol)	BRICK	(Symbol)	EASEMENT LINE
(Symbol)	WATER VALVE	(Symbol)	CONCRETE	(Symbol)	BUILDING LINE
(Symbol)	TRANSFORMER PAD	(Symbol)	BOLLARD		
(Symbol)	ELECTRIC METER	(Symbol)	COVERED AREA		
(Symbol)	STORM DRAIN MAN HOLE	(Symbol)	A/C PAD		

PROPOSED	
(Symbol)	BOUNDARY LINE
(Symbol)	GRADE BREAK
(Symbol)	STORM DRAIN
(Symbol)	CONTOUR ELEVATIONS
(Symbol)	SPOT ELEVATIONS:
TC	TOP OF CURB
SW	SIDEWALK
G	GUTTER
TP	TOP OF PAVEMENT

- GENERAL GRADING NOTES**
- PRIOR TO INSTALLATION OF STORM OR SANITARY SEWER, THE CONTRACTOR SHALL EXCAVATE, VERIFY, AND CALCULATE ALL CROSSINGS AND INFORM THE OWNER AND THE ENGINEER OF ANY CONFLICTS PRIOR TO CONSTRUCTION. THE ENGINEER WILL BE HELD HARMLESS IN THE EVENT THE ENGINEER IS NOT NOTIFIED OF DESIGN CONFLICTS.
 - ALL SLOPES AND AREAS DISTURBED BY CONSTRUCTION SHALL BE GRADED SMOOTH AND FOUR INCHES OF TOPSOIL APPLIED. IF ADEQUATE TOPSOIL IS NOT AVAILABLE ON SITE, THE CONTRACTOR SHALL PROVIDE TOPSOIL, APPROVED BY THE OWNER, AS NEEDED. THE AREA SHALL THEN BE SEEDED, FERTILIZED, MULCHED, WATERED AND MAINTAINED UNTIL HARDY GRASS GROWTH IS ESTABLISHED IN ALL AREAS (SEE LANDSCAPE PLAN FOR SEED MIX AND PROPER APPLICATION RATE). ANY AREAS DISTURBED FOR ANY REASON PRIOR TO FINAL ACCEPTANCE OF THE PROJECT SHALL BE CORRECTED BY THE CONTRACTOR AT NO ADDITIONAL COST TO THE OWNER.
 - THE CONTRACTOR IS SPECIFICALLY CAUTIONED THAT THE LOCATION AND/OR ELEVATION OF EXISTING UTILITIES AS SHOWN ON THESE PLANS IS BASED ON RECORDS OF THE VARIOUS UTILITY COMPANIES, AND WHERE POSSIBLE, MEASUREMENTS TAKEN IN THE FIELD. THE INFORMATION IS NOT TO BE RELIED ON AS BEING EXACT OR COMPLETE. THE CONTRACTOR MUST CALL THE APPROPRIATE UTILITY COMPANY AT LEAST 48 HOURS BEFORE ANY EXCAVATION TO REQUEST EXACT FIELD LOCATION OF UTILITIES.
 - UNLESS OTHERWISE SHOWN, CALLED OUT OR SPECIFIED HEREON OR WITHIN THE SPECIFICATIONS:
 - ALL STORM DRAIN PIPE BEDDING SHALL BE INSTALLED PER NCTCOG STANDRAD DRAWING CITY'S REVISION
 - ALL STORM DRAIN PIPES ARE MEASURED FROM CENTER OF STRUCTURES AND ENDS OF FLARED END SECTIONS.
 - CONTRACTOR TO REFER TO GEOTECHNICAL REPORT FOR PAVING AND SUBGRADE PREPARATION AND CONSTRUCTION RECOMMENDATION.
 - ALL FILL TO BE MINIMUM 95% STANDARD DENSITY.
 - ALL FILL TO BE COMPACTED USING SHEEPSFOOT ROLLER.

GRADING DETAILS	
27B	TRENCH DRAIN
27C	FRENCH DRAIN

GRADING NOTES	
180	MATCH EXISTING PAVEMENT OR SIDEWALK ELEVATIONS
18F	CONNECT TO EXISTING STORM SEWER PIPE
51B	LIMITS OF SAWCUT AND PAVEMENT/SIDEWALK REMOVAL

INTERSTATE HIGHWAY 30
 (A VARIABLE WIDTH RIGHT-OF-WAY)
 (EAST BOUND SERVICE ROAD)

N33°16'00"E
 160.16'

N12°39'25"E
 40.34'

TBM-SQ. CUT SET
 ELEV. = 547.74'

APPROXIMATE LOCATION OF
 DIGITALLY SCALED FLOOD PLAIN LINE
 PER FEMA 48397C0040L
 DATED 09/26/08

LOT 4, BLOCK 1
 ROCKWALL CENTRE
 CORNERS ADDITION
 CAB. G, SLIDE 299
 56,314 SQ. FT. OR
 1.29 ACRE

(BASE BEARING)
 S00°56'43"W
 125.11'

AS-BUILT DRAWING
ROCKWALL CENTRE CORNERS ADDITION
LOT 4, BLOCK 1

CONSTRUCTION SET	10/10/12	LWY	FOA	PHY	PHY
DATE	PRN	PM	DES	DRW	

DRIVE-THRU RESTAURANT
Engineering Associates, Inc.
 ENGINEERS • PLANNERS • SURVEYORS
 LANDSCAPE ARCHITECTS • ENVIRONMENTAL SCIENTISTS

3030 LBJ Freeway, Suite 100 (972)488-3737
 Dallas, TX 75234 FAX: (972)488-6732

GRADING PLAN
 1106 E. I. H. 30
 DATE 01/29/13 SHEET NO. C2
 10:13 AM
 AS-BUILT

