

CIVIL CONSTRUCTION PLANS FOR

IHOP - UNIT NO. 9404 ROCKWALL, TEXAS

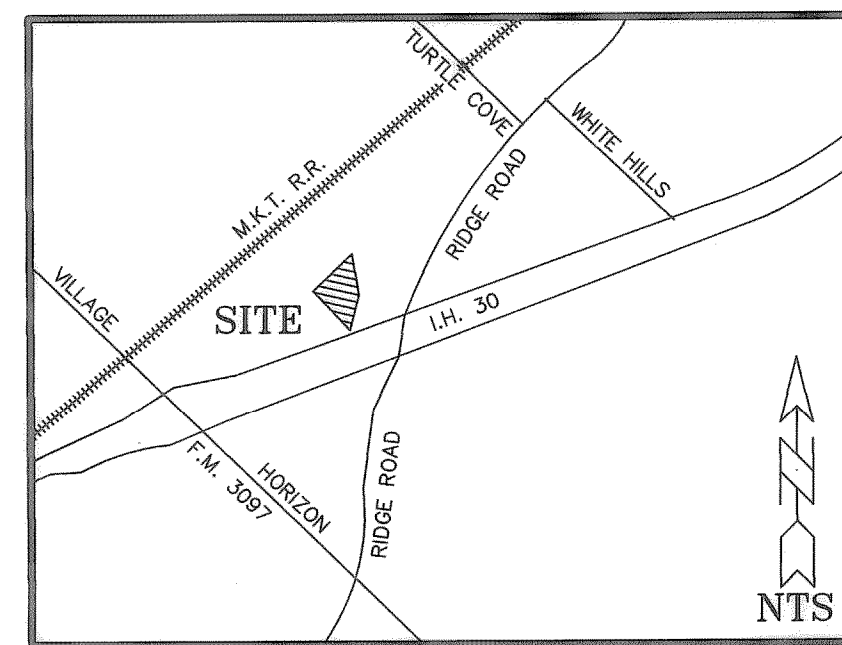

VICINITY MAP
N.T.S.

IHOP RESTAURANTS HWY. 6 & SWEETWATER SUGAR LAND, TEXAS

SHEET INDEX	
SHT #	SHEET TITLE
C-CS	COVER SHEET
C-1	FINAL PLAT
C-2	SITE PLAN (SACREY ARCHITECTS)
C-3	GRADING PLAN
C-4	UTILITY PLAN
C-5	JOINT CONTROL PLAN / PAVING PLAN
C-6	LANDSCAPE / TREE PERSERVATION PLAN
C-7	EROSION CONTROL PLAN
D-1	DETAILS & NOTES

PLAN SUBMITTALS		
No	DATE	COMMENTS
1	3/16/99	SUBMITTAL TO CITY OF ROCKWALL - (1st)
2	5/10/99	SUBMITTAL TO CITY OF ROCKWALL - (2nd)
3	6/14/99	SUBMITTAL TO CITY OF ROCKWALL - (3rd)
F	6/30/99	SUBMITTAL TO CITY OF ROCKWALL - FINAL

REVISIONS/CORRECTIONS			
DATE	No	SHTS	DESCRIPTION

MARCH 1999

AS-BUILT
DECEMBER 6, 1997-1999

NOTE: THE INTENT OF THE OWNER AND ENGINEER WAS TO CONSTRUCT THE UTILITIES ACCORDING TO THE PLANS AS APPROVED BY THE CITY OF CARROLLTON. THE ALIGNMENT AND GRADES WERE SET ON THE GROUND FOR CONSTRUCTION ACCORDING TO SAID PLANS. THE CITY OF CARROLLTON INSPECTED THE CONSTRUCTION. THE OWNER OR ENGINEER DID NOT VERIFY ALIGNMENT OR GRADES AFTER CONSTRUCTION. WE ARE NOT AWARE OF ANY CHANGES OR REVISIONS TO THESE PLANS DURING CONSTRUCTION EXCEPT AS NOTED.

HCE
Hickman Consulting Engineers, Inc.
1315 E. 19th Street, Suite 2A
Plano, Texas 75074
(972) 509-1544 • (972) 578-9644
(800) 579-4367
Engineers Planners Surveyors

COVER SHEET
IHOP RESTAURANT - UNIT NO. 9404
ROCKWALL, TEXAS
IHOP RESTAURANTS
HWY. 6 & SWEETWATER
SUGAR LAND, TEXAS

scale: NONE
date: MARCH 1999
drawn by: DJA
chk'd by: MHH
job no: 8001-62
file: 800162CS.DWG
date of submission: 6/30/99(F)

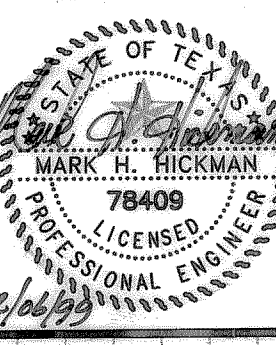

date

revisions:

sheet
C-CS