

# AS-BUILT

# COMMERCE STREET

60' R.O.W. PER CAB. B, SLIDE 323

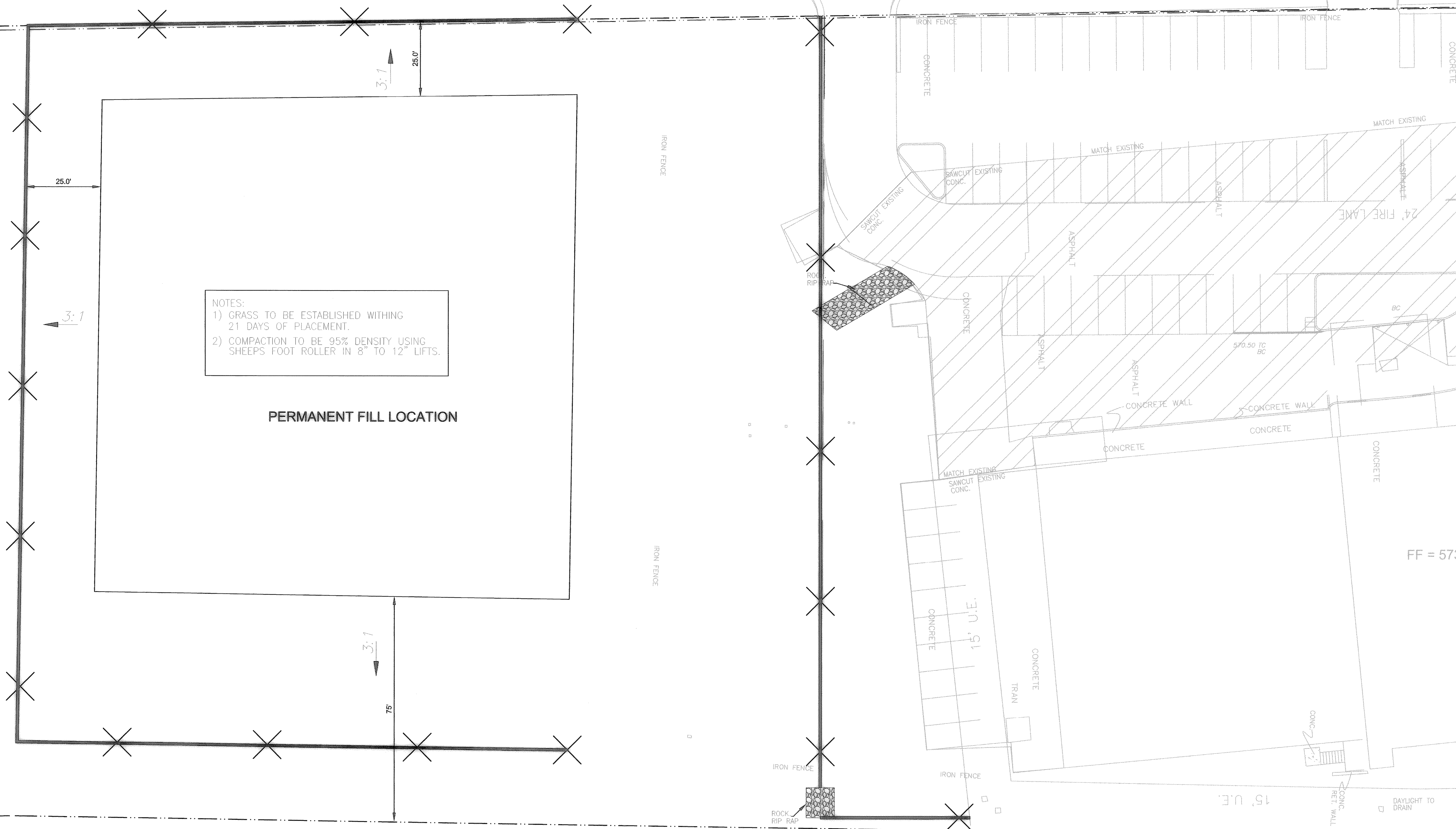

NOTES:  
 1) GRASS TO BE ESTABLISHED WITHIN 21 DAYS OF PLACEMENT.  
 2) COMPACTION TO BE 95% DENSITY USING SHEEPS FOOT ROLLER IN 8" TO 12" LIFTS.

PERMANENT FILL LOCATION

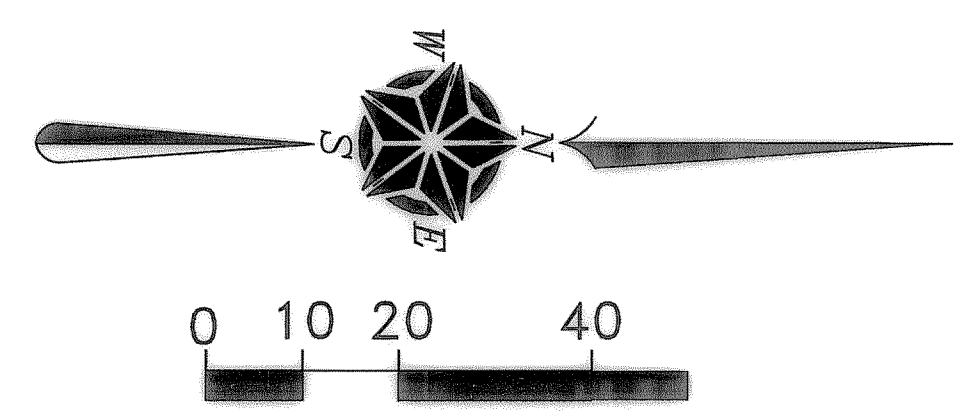
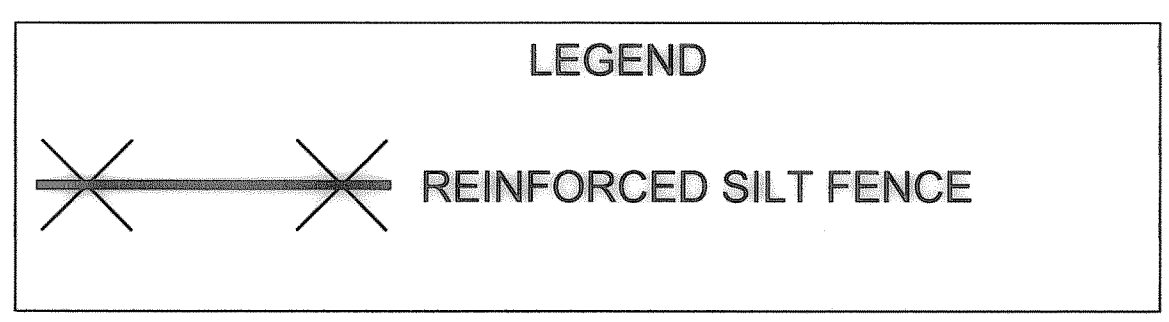

STATE OF TEXAS  
 ERIC L. DAVIS  
 86895  
 LICENSED PROFESSIONAL ENGINEER  
 4-25-13

11/28/2012

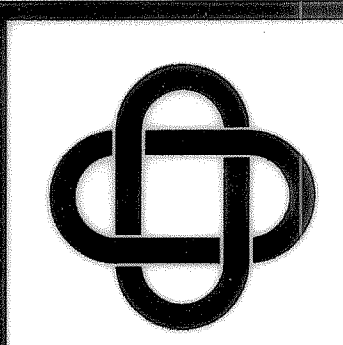

ERIC L. DAVIS ENGINEERING, INC.  
 120 East Main Street  
 Forney, Texas 75126  
 972/564-0592 Fax 972/564-6523  
 E-Mail ericdavis@eldengineering.com

PERMANENT FILL &  
 EROSION CONTROL  
 ENGINEERED FOR:  
**HYUNDAI DEALERSHIP**

PLAN: GRADING  
 ELD JOB No.:  
 DRAWN BY: BW  
 FIRM REGISTRATION #: 3987

GC: MORGAN GROUP  
 ADDITION: ROCKWALL COUNTY  
 ADDRESS: 1540 INTERSTATE 30  
 LOT: BLOCK:  
 CITY: ROCKWALL, TEXAS

SCALE: 1"=20'

SHEET: 2 OF 3