

1 HANDICAP PARKING
NOT TO SCALE

- PAVING NOTES**
1. ALL DIMENSIONS ARE FROM BACK OF CURB UNLESS OTHERWISE NOTED.
 2. UNLESS OTHERWISE NOTED, ALL CONCRETE SHALL BE CLASS "A", (3000 PSI).
 3. UNLESS NOTED, ALL FILL SHALL BE COMPACTED TO 95% STANDARD PROCTOR DENSITY IN 6 INCH LIFTS.
 4. THE CONTRACTOR SHALL SUBMIT A JOINT SPACING PLAN TO THE ENGINEER FOR APPROVAL. UNLESS NOTED, EXPANSION JOINT SPACING SHALL BE 90' MAXIMUM EACH WAY WITH NO KEYWAYS AND SAWED DUMMY JOINTS SHALL BE 15' EACH WAY.
 5. TRANSVERSE CONSTRUCTION JOINTS SHALL BE USED AT THE END OF EACH DAY'S PAVING AND WHERE INTERRUPTIONS SUSPEND OPERATIONS FOR 30 MINUTES OR MORE.
 6. ALL PAVEMENTS TO BE REMOVED SHALL BE SAWCUT TO A NEAT LINE, MINIMUM 1-1/2" DEEP, AND THE PAVEMENT REMOVED IN SUCH A MANNER AS TO PRESERVE THE EXISTING TRANSVERSE REINFORCING STEEL TO THE MAXIMUM EXTENT POSSIBLE.
 7. ALL CURB AND GUTTER SHALL BE INTEGRAL WITH THE PAVEMENT AND HAVE THE SAME COMPRESSIVE STRENGTH.
 8. PAVEMENT REINFORCEMENT SHALL BE #3 BARS, SPACED AT 18" CENTER TO CENTER EACH WAY EXCEPT WHERE NOTED IN THE PLANS.
 9. BAR LAPS SHALL BE 30 DIAMETERS IN LENGTH.
 10. ALL STRIPES SHALL BE 4" WIDE, UNLESS OTHERWISE NOTED.
 11. INSTALLATION AND PLACEMENT OF IRRIGATION SLEEVES AND UTILITY CONDUITS SHALL BE IN ACCORDANCE WITH LANDSCAPE ARCHITECTS AND MEP PLANS.
 12. SIDEWALKS AND ACCESSIBLE ROUTES SHALL HAVE A SLOPE NO GREATER THAN 5% AND A CROSS FALL NO GREATER THAN 2% UNLESS NOTED OTHERWISE.
 13. ALL FILL SHALL BE COMPACTED WITH SHEEPS FOOT ROLLER.
 14. IN AREAS WHERE THE DEDICATED FIRELANE DOES NOT EXTEND FROM FACE OF CURB TO FACE OF CURB, THE FIRELANE STRIPING SHALL EXTEND ACROSS THE FULL DRIVE AISLE.

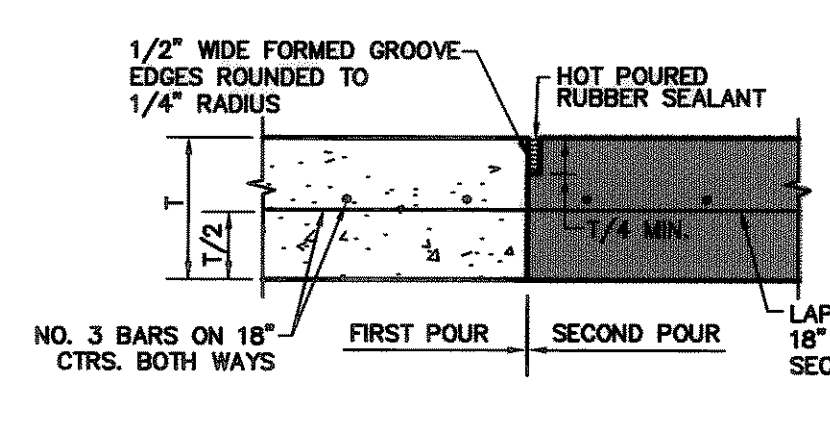

2 CONSTRUCTION JOINT
NOT TO SCALE

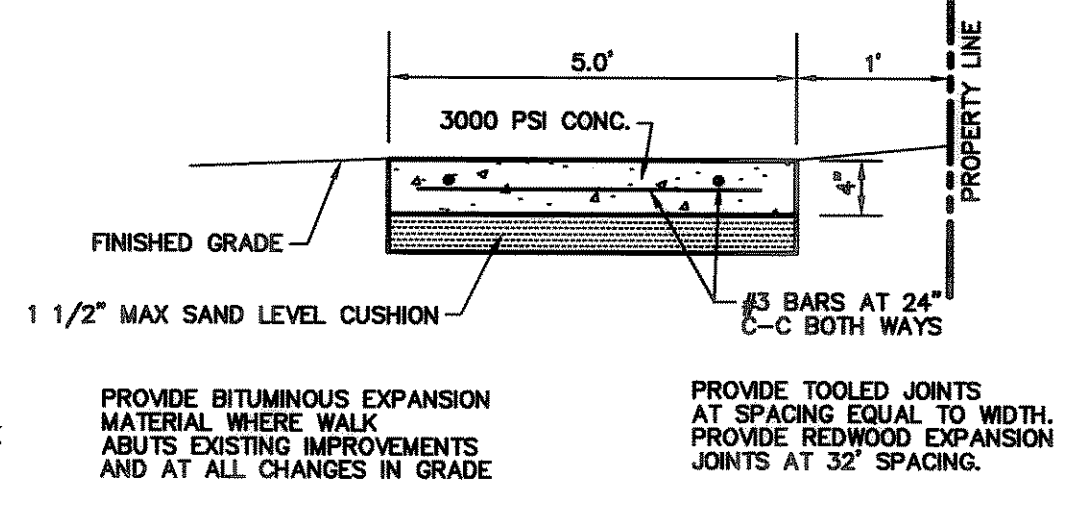

3 CONCRETE WALK
NOT TO SCALE

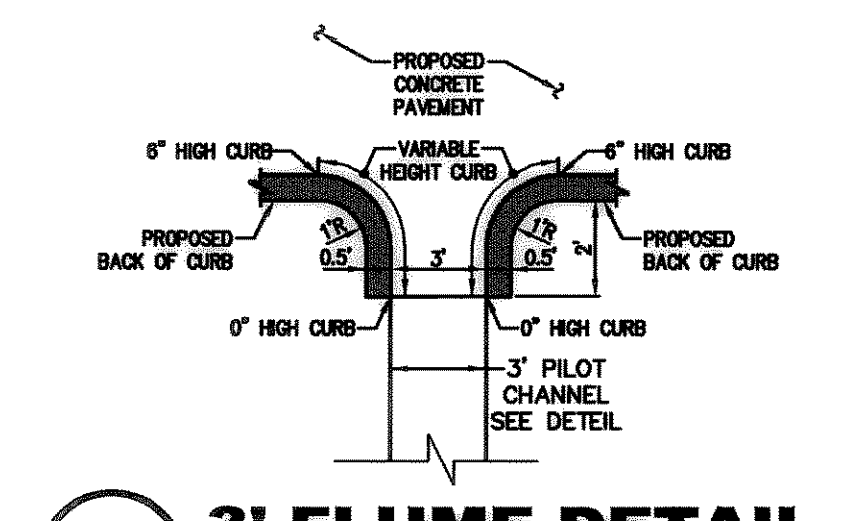

11 3' FLUME DETAIL
NOT TO SCALE

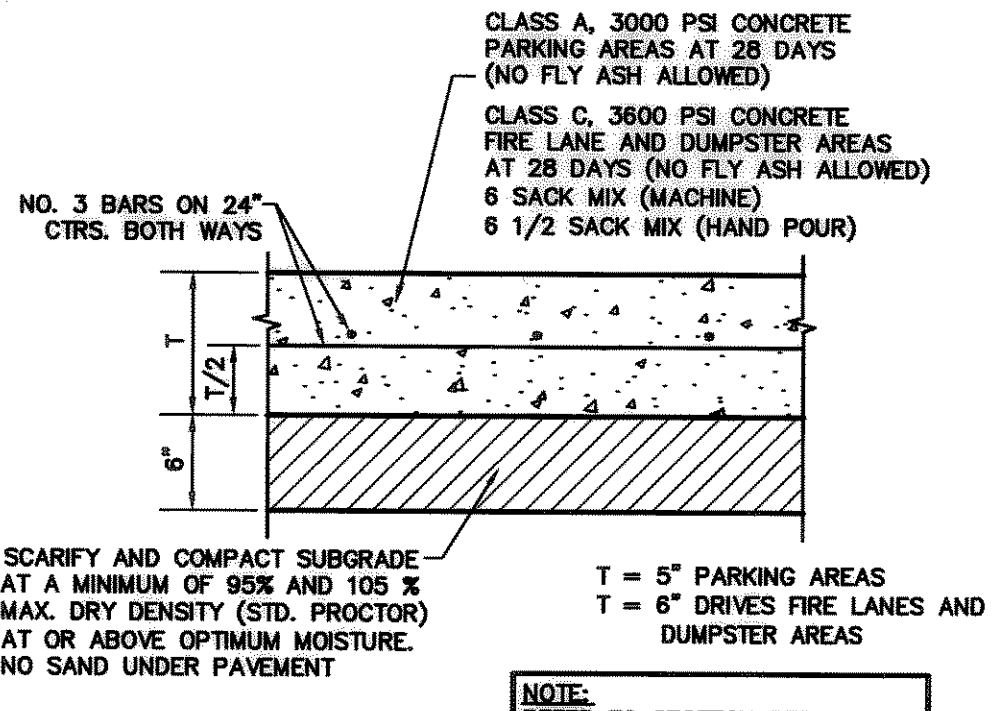

4 CONCRETE PAVEMENT SECTION
NOT TO SCALE

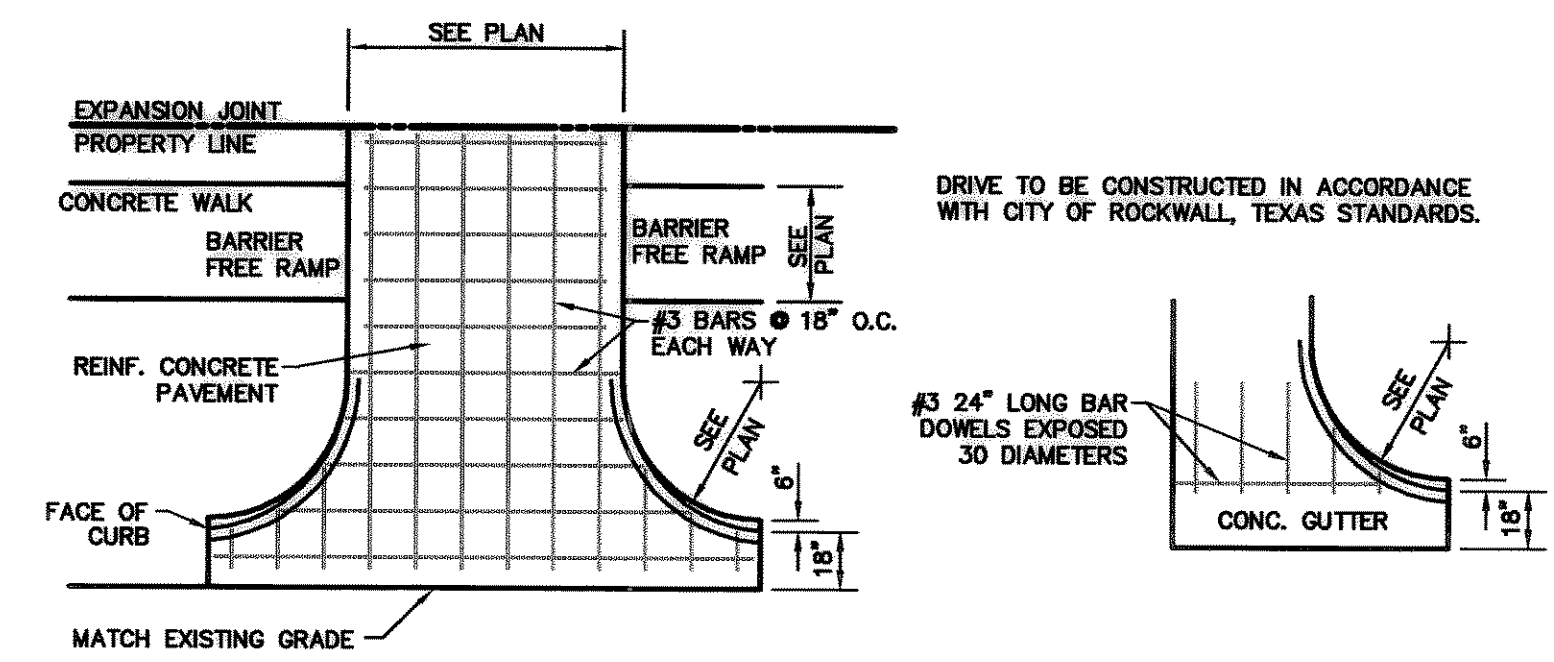

5 DRIVEWAY APPROACH
NOT TO SCALE

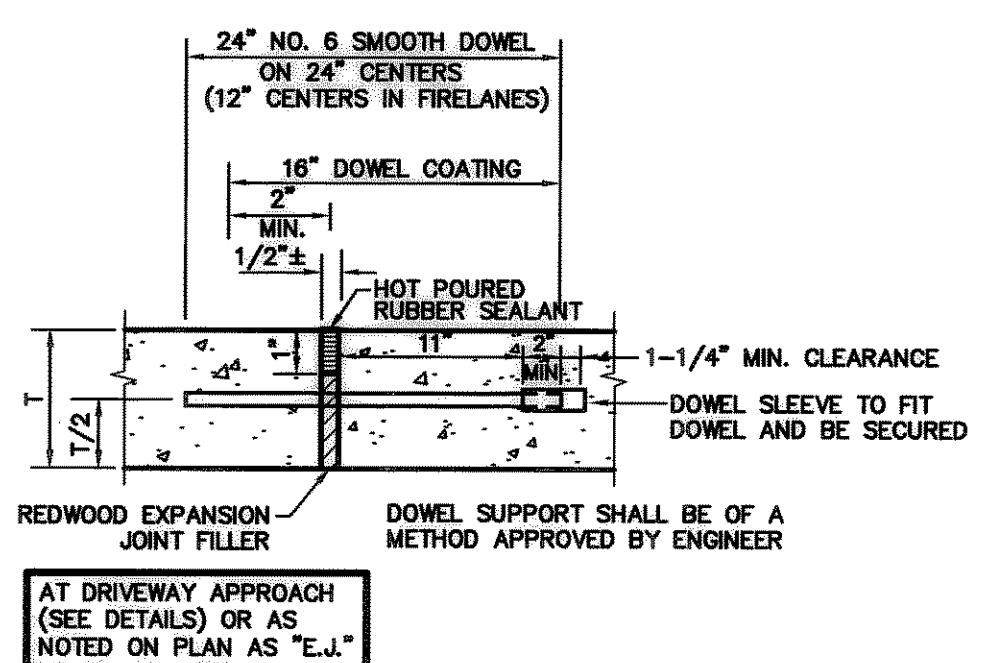

6 EXPANSION JOINT
NOT TO SCALE

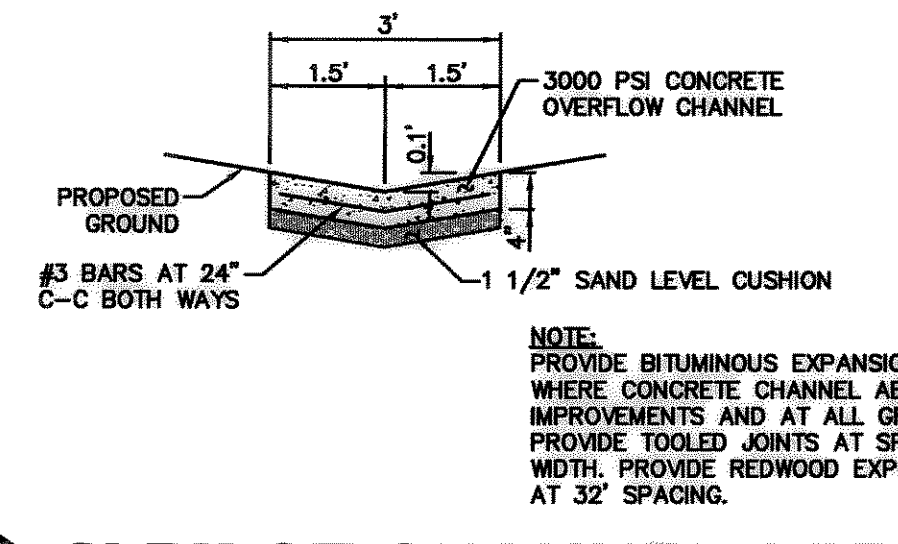

11 3' PILOT CHANNEL DETAIL
NOT TO SCALE

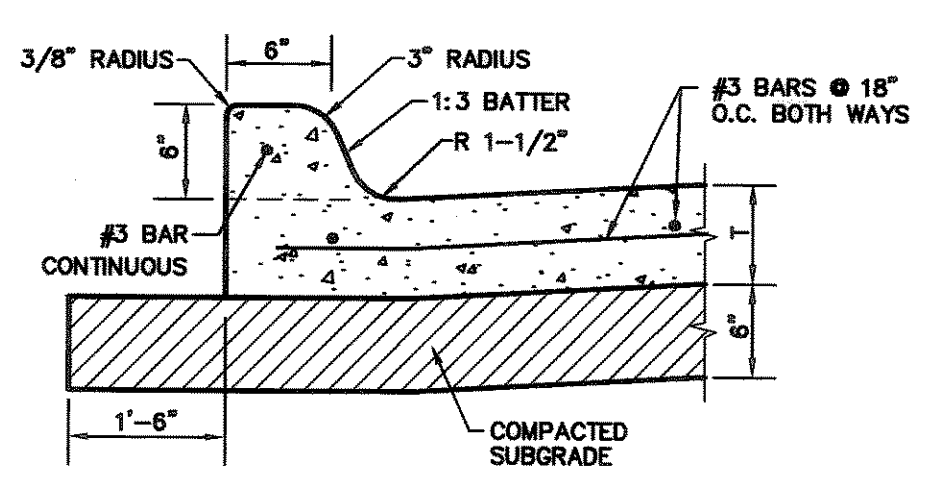

7 INTEGRAL CURB
NOT TO SCALE

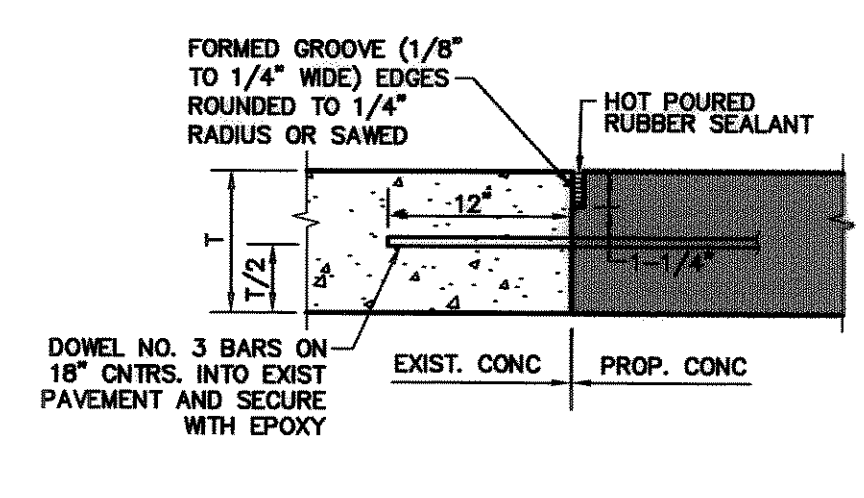

8 PAVEMENT CONNECTION
NOT TO SCALE

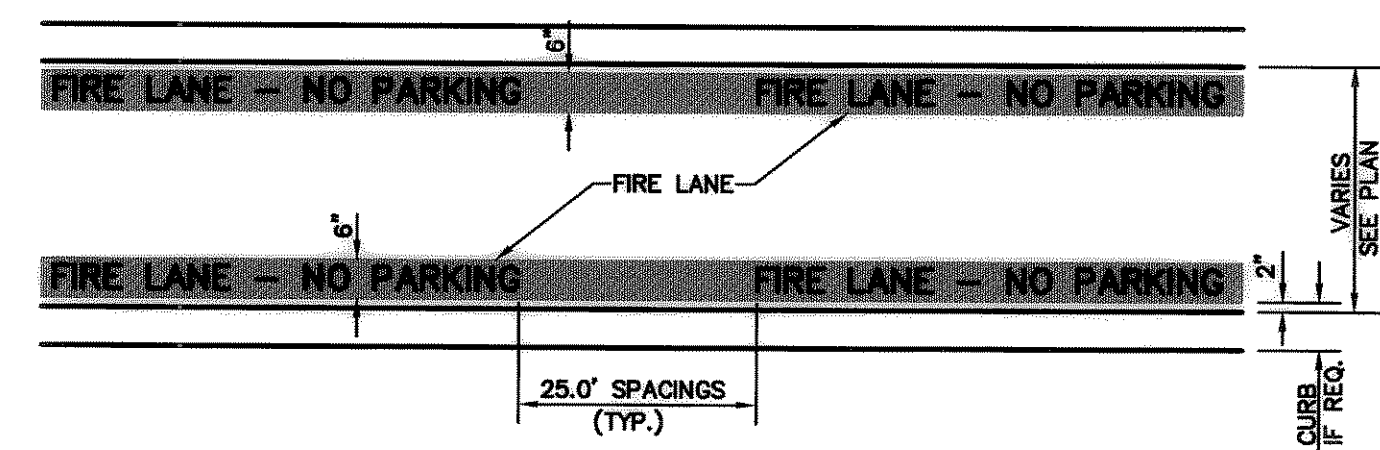

9 FIRE LANE STRIPING
NOT TO SCALE

- GENERAL NOTE:**
A. STRIPING TO BE DONE IN ACCORDANCE WITH CITY STANDARDS.
- STRIPING DETAIL NOTE:**
A. PAINT:
1. STRIPE SHALL BE FIVE (5) INCHES WIDE PAINTED WITH AN EXTERIOR ACRYLIC LATEX PAINT.
A. COLOR SHALL BE "TRAFFIC RED" GULDEN NO. 63251 OR EQUAL.
2. LETTERS SHALL BE FOUR (4) INCHES HIGH PAINTED WITH AN EXTERIOR ACRYLIC LATEX PAINT.
B. COLOR SHALL BE "TRAFFIC WHITE" GULDEN NO. 563245 OR EQUAL.
- B. APPLICATION:
1. STRIPE MAY BE BRUSHED OR SPRAYED, ONE COAT TO FINISH.
2. LETTERS SHALL BE STENCIL FORMED, BRUSH APPLIED AND SPACED AS DETAILED ON THIS SHEET.

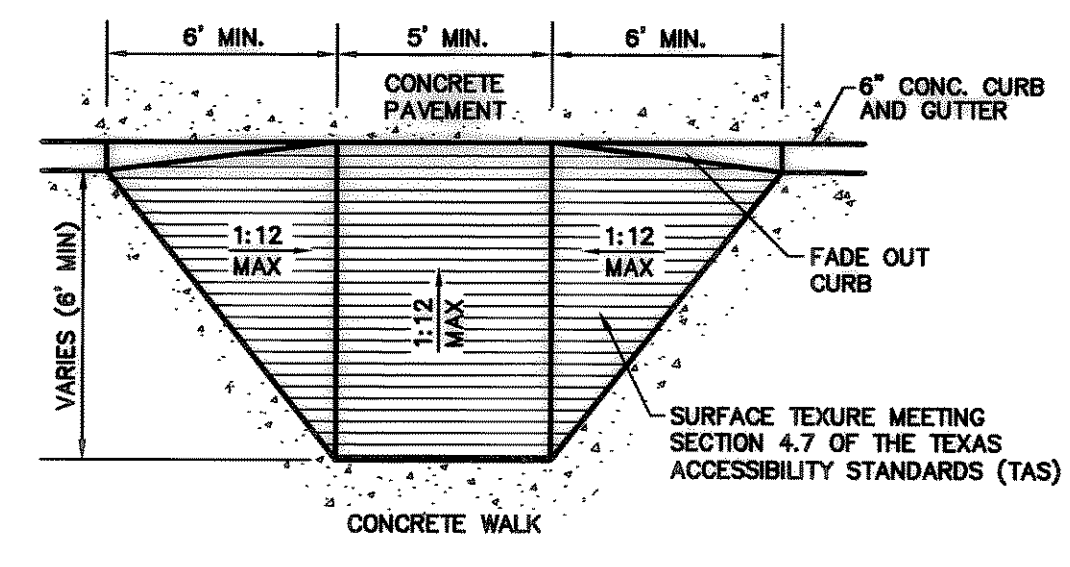

10 ACCESS RAMP
NOT TO SCALE

- NOTES:**
1. ALL HANDICAPPED SIGNAGE AND MARKINGS TO BE IN ACCORDANCE WITH FEDERAL STATE AND LOCAL REGULATIONS.
2. MAXIMUM SLOPE FOR HANDICAPPED ACCESSIBLE PATHS ARE 5% WITH A MAXIMUM CROSS FALL SLOPE OF 2% THE FIRST FIVE FEET FROM THE DOOR IS NOT TO EXCEED 2% IN ANY DIRECTION.

RECORD DRAWING

THIS DRAWING HAS BEEN REVISED TO REFLECT CONSTRUCTION RECORDS MAINTAINED AND PROVIDED BY THE CONTRACTOR FOR THIS PROJECT.

CONTRACTOR: CONSTRUCTORS

DATE REVISED: 09-28-2004

NO.	DATE	REVISION
1	09/28/04	RECORD DRAWINGS

Pacheco Koch Consulting Engineers
8350 N CENTRAL EXPWY SUITE 1000 DALLAS, TEXAS 75206 972.235.3031

PAVING PLAN AND DETAILS
ROCKWALL CAPITAL ADVISORS
SWC ARISTA & RALPH HALL
LEGAL DESCRIPTION OR ADDRESS
CITY OF ROCKWALL, TEXAS

DESIGN	DRAWN	DATE	SCALE	NOTES	FILE	NO.
CJE	FJM	NOV, 2003	1"=40'			C5.1



THE SEAL APPEARING ON THIS DOCUMENT WAS AUTHORIZED BY STEVEN A. MARKUSSEN, P.E. 70090 ON 11/24/2003. ALTERATION OF A SEALED DOCUMENT WITHOUT PROPER NOTIFICATION TO THE RESPONSIBLE ENGINEER IS AN OFFENSE UNDER THE TEXAS ENGINEERING PRACTICE ACT.

BITUMASTER 10/18/2004 9:02 AM
 H:\016-151567-03-193\CV.DWG

ROCKWALL CAPITAL ADVISORS