

**CONSTRUCTION PLANS  
FOR  
ROCKWALL PROFESSIONAL OFFICE  
LOT 9R-1, BLOCK A  
HORIZION RIDGE ADDITION  
1.718 ACRES  
EDWARD TEAL SURVEY, ABSTRACT No. 207,  
CITY OF ROCKWALL, ROCKWALL COUNTY, TEXAS**

FOR

ALLIANCE ARCHITECTS  
1600 North Collins Blvd., Suite 1000  
(972) 238-0400

DEVELOPER

ARISTA OFFICE, L.P. 801 E. I-30, Suite B, Rockwall, Tx.  
(972) 772-9041

PREPARED BY

**Pacheco Koch Consulting Engineers**  
8350 N CENTRAL EXPWY SUITE 1000 DALLAS, TEXAS 75206 972.235.3031

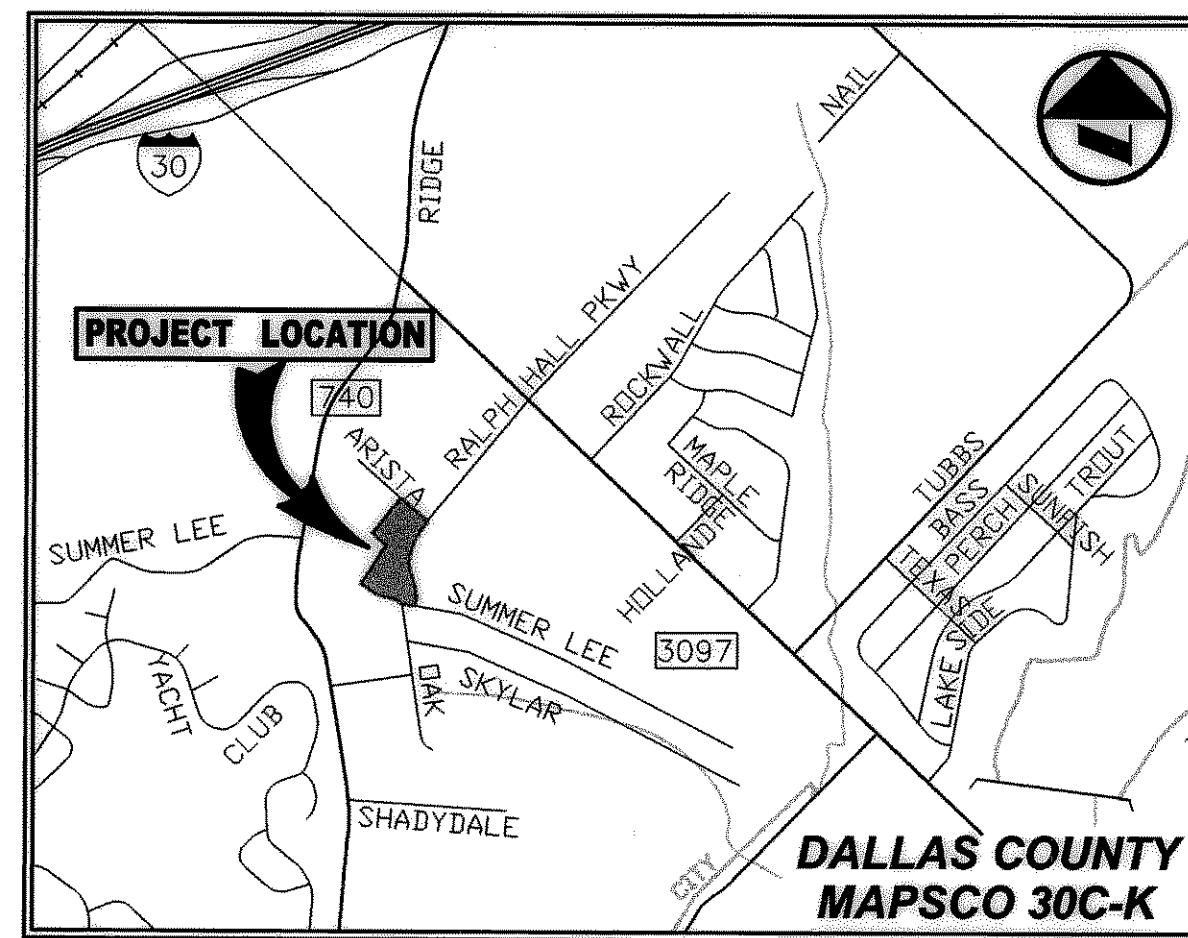

**VICINITY MAP**  
(NOT TO SCALE)

DRAWING SHEET INDEX

SHEET	DESCRIPTION
-	REPLAT (SHEET 1 OF 2)
-	REPLAT (SHEET 2 OF 2)
C1.1	DIMENSIONAL CONTROL PLAN
C3.1	STORM SEWER PLAN
C3.2	STORM SEWER PROFILES
C4.1	WATER & SANITARY SEWER PLAN
C4.2	SANITARY SEWER PLAN & PROFILE

**RECORD DRAWING**

THIS DRAWING HAS BEEN REVISED TO REFLECT CONSTRUCTION RECORDS MAINTAINED AND PROVIDED BY THE CONTRACTOR FOR THIS PROJECT.

CONTRACTOR: CONSTRUCTORS  
DATE REVISED: 09-28-2004



THE SEAL APPEARING ON THIS DOCUMENT WAS AUTHORIZED BY STEVEN A. MARKUSSEN, P.E. 70090 ON 11/24/2003. ALTERATION OF A SEALED DOCUMENT WITHOUT PROPER NOTIFICATION TO THE RESPONSIBLE ENGINEER IS AN OFFENSE UNDER THE TEXAS ENGINEERING PRACTICE ACT.