

**LANDSCAPE SPECIFICATIONS**  
**SECTION 02900**

**PART 1 - GENERAL**

- 1.1 REFERENCED DOCUMENTS**
- Refer to bidding requirements, special provisions, and schedules for additional requirements.
- 1.2 DESCRIPTION OF WORK**
- Work included. Furnish all supervision, labor, materials, services, equipment and appliances required to complete the work covered in conjunction with the landscaping covered in these specifications and landscaping plans, including:
    - Planting (trees, shrubs, and grass)
    - Bed preparation and fertilization
    - Notification of sources
    - Water and Maintenance until final acceptance
    - Guarantee
- 1.3 REFERENCE STANDARDS**
- American Standard for Nursery Stock published by American Association of Nurserymen 27 October 1980, Edition by American National Standards Institute, Inc. (ANSI) plant material.
  - American Joint Committee on Horticultural Nomenclature: 1942 Edition of Standardized Plant Names.
  - Texas Association of Nurserymen, Grades and Standards.
  - North Third, 1976 - Cornell University.
- 1.4 NOTIFICATION OF SOURCES AND SUBMITTALS**
- The Contractor shall, within ten (10) days following acceptance of bid, notify the Architect/Owner of the source of plant materials and bed preparation required for the project.
  - Submit three representative samples of each variety of ornamental tree, shrub, and groundcover plants for Architect's approval. When approved, list, install, and maintain as representative samples for final installed plant materials.
  - File Certificates of inspection of plant material by state, county, and federal authorities with Architect, if required.
  - Soil Analysis: Provide sandy loam soil analysis if requested by the Architect.

**1.5 JOB CONDITIONS**

- General Contractor to complete the following punch list. Prior to Landscape Contractor letting any portion of landscape installation, General Contractor shall leave planting bed areas three (3) inches below finish grade of sidewalks, drives and curbs as shown on the drawings. All lawn areas to receive solid sod shall be left one (1) inch below the finish grade of sidewalks, drives and curbs. All construction debris shall be removed prior to Landscape Contractor beginning any work.
- General Contractor shall provide topsoil as described in Section 02900 - Earthwork. Storage of materials and equipment at the job site will be at the risk of the Landscape Contractor. The Owner cannot be held responsible for theft or damage.

Section 02900 - 01

**PART 3 - EXECUTION**

**3.1 BED PREPARATION & FERTILIZATION**

- Landscape Contractor to inspect all existing conditions and report any deficiencies to the Owner.
- All planting areas shall be conditioned as follows:
  - Prepare new planting beds by scraping away existing grass and weeds as necessary. Fill existing soil to a depth of six inches prior to fertilizer and compost application. Apply fertilizer as per manufacturer's recommendations. Add all (6") inches of compost into a depth of one (6") inches of the native soil. Apply organic fertilizer such as Sustana or Green Sense at the rate of twenty (20) pounds per one thousand (1,000) square feet.
  - All planting bed areas shall receive a two (2") inch layer of specified mulch.
  - Backfill for tree pits shall be as follows: Use existing topsoil on site, free from large clumps, rock, debris, cellophane, subsides, etc., placed in nine (9") inch layers and watered in thoroughly.
- Grass Area:
  - Grass to be Solid Sod Bermudagrass: Blocks of sod should be laid joint to joint, staggered joint after fertilizing the ground first. Roll grass areas to achieve a smooth, even surface. The joints between the blocks of sod should be filled with topsoil where they are evidently gaped open, then watered thoroughly.
  - Grass to be Hydromulch Common Bermudagrass: Hydromulch with bermudagrass seed at a rate of two (2) pounds per one thousand (1,000) square feet. Use a 4" x 6" batter board against the bed areas.

Section 02900 - 05

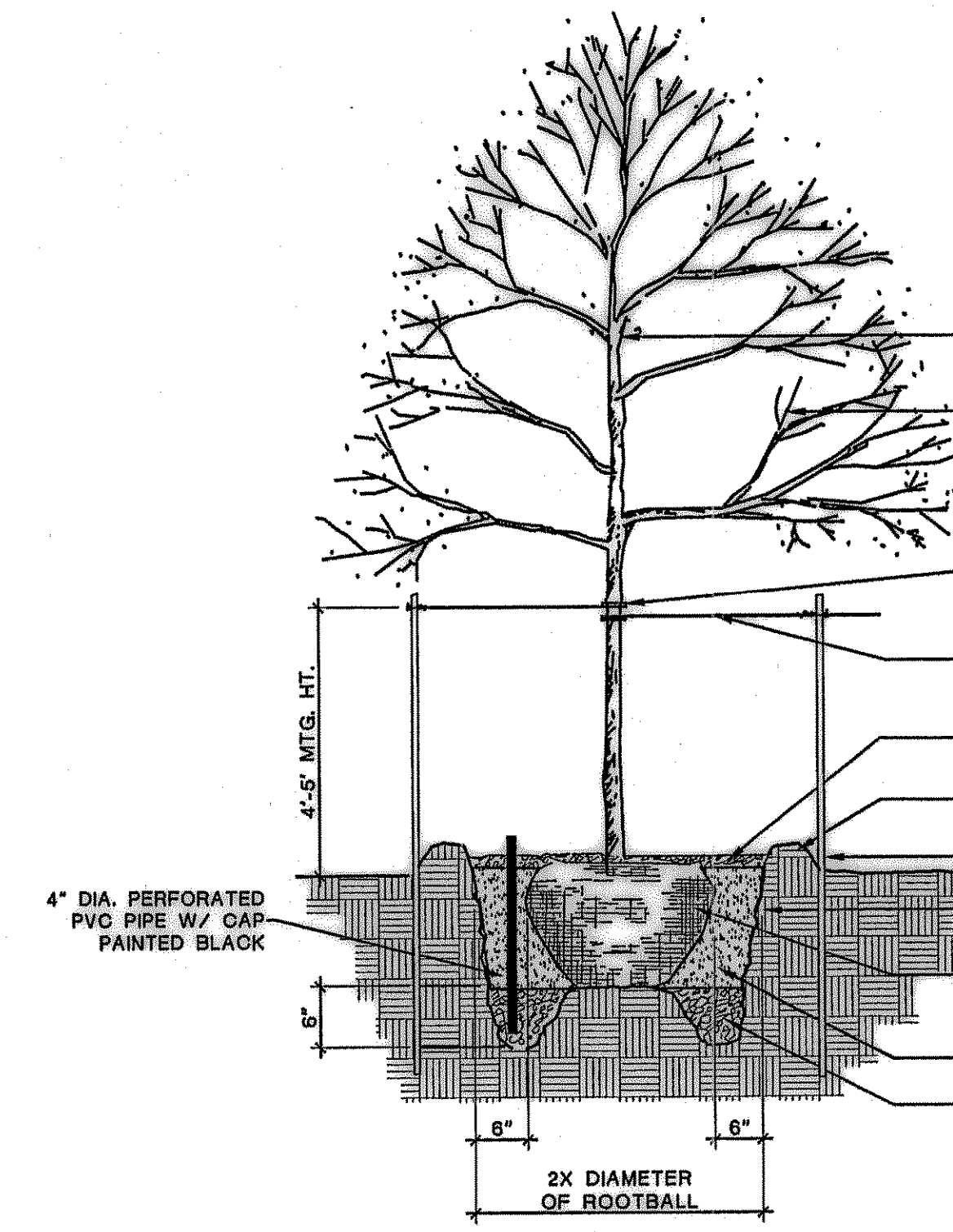

**01 TREE PLANTING DETAIL**  
NOT TO SCALE

**1.6 MAINTENANCE AND GUARANTEE**

- Maintenance**
  - The Landscape Contractor will be held responsible for the maintenance of all work from the time of planting until final acceptance by the Owner. No trees, shrubs, groundcover or grass will be accepted unless they show a healthy growth and satisfactory foliage conditions.
  - Maintenance shall include watering of trees and plants, cultivation, weeding, spraying, edging, pruning of trees, mowing of grass, cleaning up and all other work necessary of maintenance.
  - A written notice requesting final inspection and acceptance should be submitted to the Owner at least seven (7) days prior to completion. An on-site inspection by Owner and Landscape Contractor will be completed prior to written acceptance.
  - After final acceptance of installation, the Landscape Contractor will not be required to do any of the above listed work.
- Guarantee**
  - Trees shall be guaranteed for a twelve (12) month period after acceptance. Shrubs and groundcover shall be guaranteed for twelve (12) months. The Contractor shall replace all dead materials as soon as weather permits and upon notification of the Owner. Plants, including trees, which have partially died as to shape, size, or symmetry has been damaged, shall be considered subject to replacement. In such cases, the option of the Owner shall be final.
    - Plants used for replacement shall be of the same kind and size as those originally planted and shall be planted as originally specified. All work, including materials, labor and equipment used in replacement, shall carry a twelve (12) month guarantee. Any damage, including cuts in lawn and bed areas, incurred as a result of making replacements shall be immediately repaired.
    - At the direction of the Owner, plants may be replaced at the start of the next year's planting season. In such cases, dead plants shall be removed from the premises immediately.
    - When plant replacements are made, plants, soil mix, fertilizer and such are to be utilized as originally specified and inspected for full compliance with Contract requirements. All replacements are to be included under "Work" of this section.
  - The Owner agrees that for the guarantee to be effective, he will water plants at least twice a week during dry periods and cultivate beds once a month after final acceptance.
  - The above guarantee shall not apply where plants die after acceptance because of injury by storms, hail, freeze, insects, diseases, injury by humans, machines or theft.
  - Acceptance for all landscape work shall be given after final inspection by the Owner provided the job is in a completed, undamaged condition, and there is no stand of grass in all lawn areas. At this time, the Owner will assume maintenance on the accepted work.

Section 02900 - 02

**1.7 QUALITY ASSURANCE**

- General: Comply with applicable Federal, State, County, and Local regulations covering landscape materials and work.
- Personnel: Employ only experienced personnel who are familiar with the required work. Provide adequate supervision by a qualified foreman acceptable to Landscape Architect.
- Selection of Plant Material:
  - Make contact with suppliers immediately upon obtaining notice of contract acceptance to select and book materials. Develop a program of maintenance (watering and fertilization) which will insure the purchased materials will meet and/or exceed project specifications.
  - Landscape Architect will provide a key identifying each tree location on site. Written verification will be required to document material selection, source and delivery schedules to site.
  - Owner and/or Architect shall inspect all plant materials, when reasonable, at place of growth for compliance with requirements for genus, species, cultivar/variety, size and quality.

Section 02900 - 06

**3.2 INSTALLATION**

- Maintenance of plant materials shall begin immediately after each plant is delivered to the site and shall continue until all construction has been satisfactorily accomplished.
- Plant materials shall be delivered to the site after the beds are prepared and are from the drying yards during transit. All shipments of nursery materials shall be thoroughly protected from the drying yards during transit. All plants which cannot be planted at once, after sun, shall be protected against the possibility of drying by wind and sun. Bags of earth of B & S plants shall be kept covered with soil or other acceptable material. All plants remain the property of the Contractor until final acceptance.
- Position the trees and shrubs in their intended location as per plan.
- Notify the Landscape Architect for inspection and approval of all positions of plant materials.
- Excavate pits with vertical sides and horizontal bottom. Tree pits shall be large enough to permit handling and planting without injury to the crown of the plant. The soil of such depth that when planted and settled, the crown of the plant shall bear the same relation to the finish grade that it did to soil surface in place of growth.

**1.7 QUALITY ASSURANCE**

- Selection of Plant Material (cont)**
  - Owner and/or Architect retains the right to further inspect all plant material upon arrival at the site and during installation for size and condition of root balls, limbs, branching habit, insects, injuries, and latent defects.
  - Owner and/or Architect may reject unsatisfactory or defective material at any time during the process of work. Remove rejected material from the site immediately. Plants damaged in transit or at job site shall be rejected.
- PRODUCT DELIVERY, STORAGE AND HANDLING**
  - Preparation:
    - Balled and Burlapped (BAB) Plants: Dig and prepare shipment in a manner that will not damage roots, branches, shape, and future development.
    - Container Grown Plants: Deliver plants in rigid container to hold ball shape and protect root mass.
  - Delivery:
    - Deliver packaged materials in sealed containers showing weight, analysis and name of manufacturer. Protect materials from deterioration during delivery and deliver only plant materials that can be planted in one day unless adequate storage and watering facilities are available on job site.
    - Protect root balls by hosing in with seawater or other approved moisture retaining material if not planted within 24 hours of delivery.
    - Protect plants during delivery to prevent damage to root balls or desiccation of leaves. Keep plants moist at all times. Cover all materials during transport.
    - Notify Architect of delivery schedule 72 hours in advance so plant material may be observed upon arrival at job site.
    - Remove rejected plant material immediately from site.
    - To avoid damage or stress, do not lift, move, adjust to plumb, or otherwise manipulate plants by trunk or stems.

**PART 2 - PRODUCTS**

**2.1 PLANTS**

- General Well-formed No. 1 grade or better nursery grown stock. Listed plant heights are from top of root ball to nominal top of plants. Plant spread refers to nominal outer width of the plant, not to the outer leaf tips. Plants will be individually approved by the Architect and selected for use to their acceptability shall be final.
  - Quantities: the drawings and specifications are complementary; anything called for on one and not the other is to be included, as it shows and called for on both. The plant schedule is an end to bidders. Confirm all quantities on plan.
  - Quality and size: Plant materials shall conform to the size given on the plan, and shall be healthy, symmetrical, well shaped, full branched, and well rooted. The plants shall be free from injurious insects, diseases, injuries to the bark or roots, gross branches, objectionable distortions, insect eggs and larvae and are to be of specimen quality.
  - Approval: All plant materials shall be subject to approval of the Owner and/or Landscape Architect. All plants which are found unsuitable in growth or in any unhealthy, badly shaped, or undersized condition, will be rejected by the Landscape Architect, either before or after planting, and shall be removed at the expense of the Landscape Contractor and replaced with acceptable plants as specified.
  - Trees shall be healthy, full branched, well shaped, and shall meet the trunk diameter and height requirements of the plant schedule. Balled and Burlapped shall be firm, neat, tightly tapered, and well wrapped in burlap. Any tree loose in the ball or with broken ball at time of planting will be rejected. Balls shall be ten (10) inches in diameter for each one (1") inch of trunk diameter, measured six (6") inches above ball.
    - Nomenclature conforms to customary nursery usage, for clarification, the term "multi-trunk" defines a plant having three (3) or more trunks of nearly equal diameter.
  - Pruning: All pruning of trees and shrubs, as directed by Landscape Architect, shall be executed by Landscape Contractor at no additional cost to the Owner.

Section 02900 - 03

**3.2 INSTALLATION (cont)**

- Shrub and tree pits shall be no less than two (2) feet, twenty-four (24") inches wider than the lateral dimension of earth ball and six (6") inches deeper than its vertical dimension. Remove all soil from site all rocks or stones over one (1") inches in diameter. Plants should be thoroughly moist before removing containers.
- Dig a wide, rough sided hole exactly the same depth as the height of the ball, centered at the surface of the ground. The sides of the hole should be rough and jagged, never slick or glazed.
- Percolation Test: Fill the hole with water. If the water level does not percolate within 24 hours, the tree needs to be moved to another location or have pier hole drainage added.
- Backfill only with 6 parts existing soil or sandy loam and 1 part bed preparation. When hole is dug in solid rock, topsoil from the same area should not be used. Carefully settle by watering to prevent air pockets. Remove the burlap from the top of the ball, as well as all nylon, plastic string and wire mesh. Container trees will usually be pot bound, if so follow standard nursery practice of root scoring.
- Do not wrap trees.
- Do not over prune.
- Mulch the top of the ball. Do not plant grass all the way to the trunk of the tree. Leave the area above the top of the ball unplanted and mulch one (1") inch of (2") inches of specified mulch.
- All plant beds and trees to be mulched with a minimum settled thickness of two (2") inches over the entire bed or pit.
- Obstruction below ground. In the event rock or underground construction work or other obstructions are encountered in any plant pit excavation work to be done under the section, alternate locations may be selected by the Owner. Where alternate locations cannot be changed, the obstructions shall be removed to a depth of not less than three (3) feet below grade and to least six (6") inches below bottom of ball when plant is properly set at the required grade. The work of this section shall include the removal from the site of such rock or underground obstructions encountered at the cost of the Landscape Contractor.

Section 02900 - 07

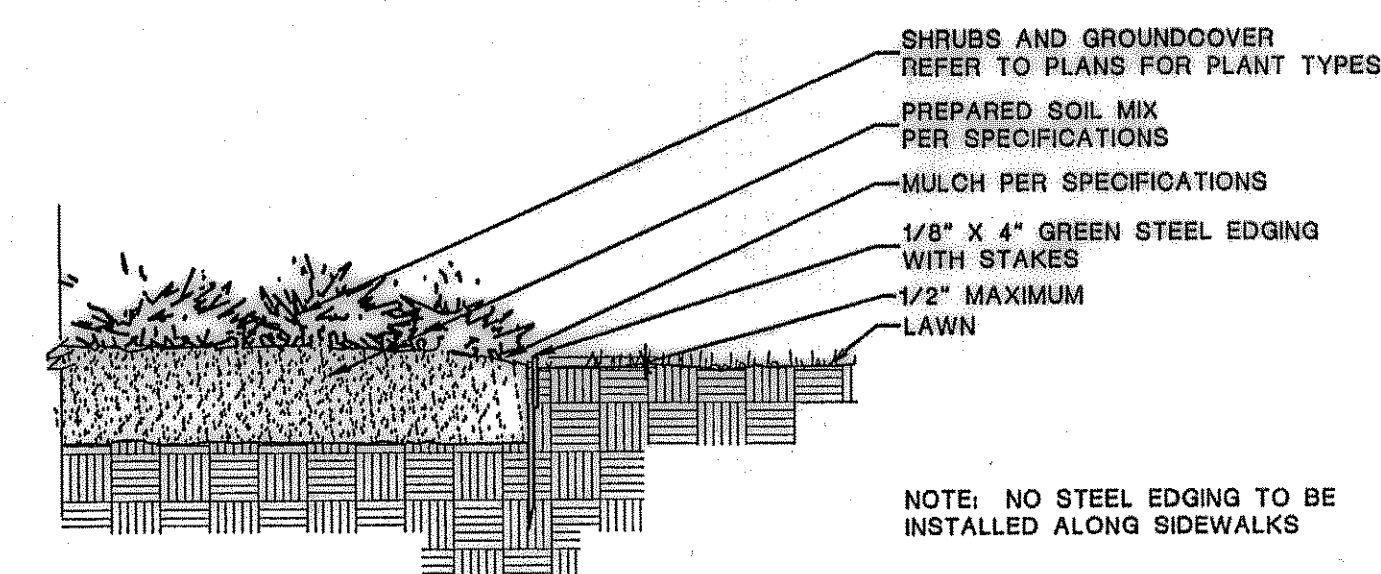

**02 STEEL EDGING DETAIL**  
NOT TO SCALE

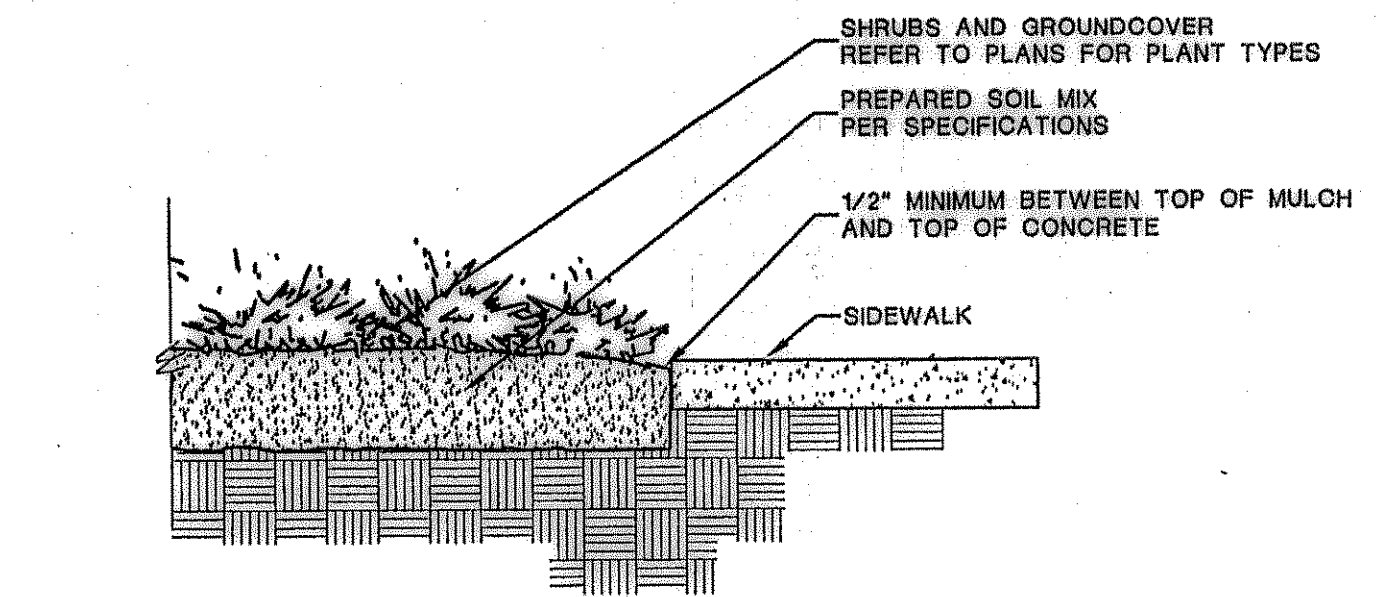

**04 SIDEWALK / MULCH DETAIL**  
no steel along sidewalks NOT TO SCALE

**2.2 SOIL PREPARATION MATERIALS**

- Sandy Loam**
  - Fertile, fertile, dark, loamy soil, free of clay lumps, subsoil, stones and other extraneous material and reasonably free of weeds and foreign grasses. Loam containing Dalisgrass or Nulgrass shall be rejected.
  - Physical properties as follows:
    - Clay-between 7-21 percent
    - Silt-between 45-55 percent
    - Sand-between 24-34 percent
    - Organic matter shall be 3%-10% of total dry weight.
    - Testing laboratory verifying that sandy loam meets the above requirements.
- Organic Material Compost** with a mixture of 80% vegetable matter and 20% animal waste. Ingredients should be a mix of coarse and fine textured material.
- Premixed Bedding Soil** as supplied by Vital Earth Resources, Gladewater, Texas. Professional Bedding Soil as supplied by Living Earth Technology, Dallas, Texas or Acid Gro Municipal Mix as supplied by SGI Building Systems, Dallas, Texas or approved equal.
- Sharp Sand** Sharp sand must be free of seeds, soil particles and weeds.
- Mulch** Double Shredded Hardwood Mulch, partially decomposed, dark brown. Living Earth Technologies or approved equal.
- Organic Fertilizer**: Fertilizer, Sustana, or Green Sense or equal as recommended for required applications. Fertilizer shall be delivered to the site in original unopened containers, each bearing the manufacturer's guaranteed statement of analysis.
- Commercial Fertilizer**: 10-20-10 or similar analysis. Nitrogen source to be a minimum 50% slow release organic Nitrogen (SOL or UFL) with a minimum 5% sulfur and 4% iron, plus micronutrients.
- Peat**: Commercial sphagnum peat moss or partially decomposed shredded pine bark or other approved organic material.

**2.3 MISCELLANEOUS MATERIALS**

- Steel Edging** Shall be Ryerson "Estate Curbing", 1/8"x4" with stakes 4' on center.
- Bleeding Material for Shade Trees**
  - Post: Staked 1/2" Post, with anchor plate; 6'-0" length; paint black
  - Wire: 12 gauge, single strand, galvanized wire.
  - Rubber liner: 2 ply, fiber reinforced hose, minimum 1/2" inch inside diameter. Color: Black
- Gravel**: Washed native pea gravel, graded 1 in. to 1-1/2 in.
- Filter Fabric**: Miraf 140N by Calanese Fibers Marketing Company, Available at Lottland Co., 1241 531-5200 or approved equal.

Section 02900 - 04

**3.2 INSTALLATION (cont)**

- Trees and large shrubs shall be staked as site conditions require. Position stakes to secure tree against seasonal prevailing winds.
- Pruning and Mulching: Each area shall be pruned in accordance with standard horticultural practice to preserve the natural character of the plant and in the manner fitting its use in the landscape design.
  - Dead wood or suckers and broken or badly bruised branches shall be removed. General tipping of all branches is not permitted.
  - Pruning shall be done with clean sharp tools.
  - Immediately after planting operations are completed, all tree pits shall be covered with a layer of specified mulch two (2") inches in depth. The limit of the specified mulch for trees shall be the diameter of the plant pit.
- Steel Curbing Installation:
  - Curbing shall be aligned as indicated on plans.
  - All steel curbing shall be free of kinks or abrupt bends.
  - Top of curbing shall be 1/2" maximum higher than existing grade.
  - Stakes are to be installed on the planting bed side of the curbing, as opposed to the grass side.
  - Do not install steel edging along sidewalks.
  - Cut steel edging at 45 degree angle where edging meets sidewalk.

**3.3 CLEANUP AND ACCEPTANCE**

- Cleanup: During the work, the premises shall be kept neat and orderly at all times. Storage areas for all materials shall be so organized that they, too, are neat and orderly. All trash and debris shall be removed from the site as work progresses. Keep paved areas clean by sweeping or hosing at end of each days' work.

Section 02900 - 08

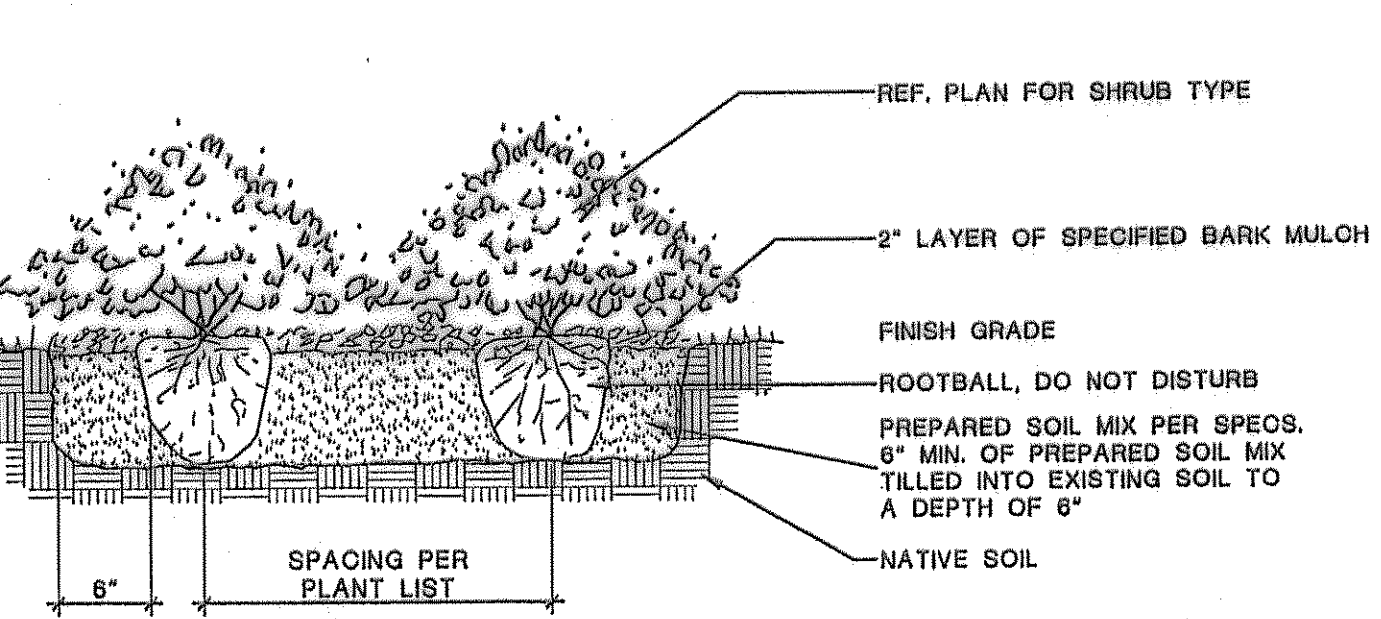

**03 SHRUB / GROUNDCOVER DETAIL**  
NOT TO SCALE



AS BUILT  
DATE 03-03-04

smr  
landscape architects, inc.  
1708 N. Griffin Street  
Dallas, Texas 75202  
Tel 214.871.0083  
Fax 214.871.0016  
Email smr@smr-ls.com

REV.	DATE	REMARKS
2	03/18/03	ISSUE FOR CONSTRUCTION
1	4/20/03	SITE PLAN CHANGES

**LANDSCAPE SPECS AND DETAILS**

LOT 7R, BLOCK A  
HORIZON RIDGE ADDITION  
THE CITY OF ROCKWALL, TEXAS

LAWRENCE A. CATES & ASSOC., INC. CONSULTING ENGINEERS  
14200 MIDWAY ROAD, SUITE 122 (972) 385-2272 DALLAS, TEXAS

DESIGN	DRAWN	DATE	SCALE	NOTES	FILE	NO.
BDA	DJV	03/14	1"=20'			L1.02