

**METES & BOUNDS DESCRIPTION**

**TRACK "A" - MEDICAL DRIVE**

WHEREAS H.GEORGE SCHULER, TRUSTEE, BEING THE OWNER OF A TRACT OF land in the County of Rockwall, State of Texas, said tract being a tract of land situated in the Edward Teal Survey, Abstract No. 207, Rockwall County, Texas, and being a part of Tract 5, conveyed from Whittle Development, Inc. to Schlumberger Technology Corporation by Special Warranty Deed recorded in Volume 597, page 93, Deed Records, Rockwall County, Texas, and being more particularly described by metes and bounds as following;

**BEGINNING** at a 1/2 inch iron rod found in the R.O.W. line of Horizon Road (variable width R.O.W.) said point being the northeast corner of this tract, also being in the northeast corner of the City of Rockwall waste water treatment plant tract;

THENCE S 02°18'48" W, along said north right-of-way line of Horizon Road (Farmer Market 3097) a distance of 109.45 feet to a 1/2 inch iron rod set for a corner;

THENCE N 47°48'43" W, a distance of 32.28 feet to a 1/2 inch iron rod set for a corner;

THENCE S 36°54'18" W, a distance of 286.00 feet to a 1/2 inch iron rod set for a corner;

THENCE continuing along the curve to the RIGHT having a central angle of 204°59'17", a radius of 60.00 feet, a tangent of 270.78 feet, and chord distance of 117.16 feet that bears S 79°23'56" W, for an arc distance of 214.66 feet to a 1/2 inch iron rod set for a corner;

THENCE N 58°06'25" W, a distance of 184.65 feet to a 1/2 inch iron rod set for a corner;

THENCE continuing along the curve to the RIGHT having a central angle of 13°59'11", a radius of 523.82 feet, a tangent of 64.25 feet and chord distance of 127.55 feet that bears N 44°06'07" W, for an arc distance of 127.87 feet to a 1/2 inch iron rod set for a corner;

THENCE continuing along the curve to the RIGHT having a central angle of 56°30'31", a radius of 680.00 feet, a tangent of 354.69 feet and chord distance of 624.87 feet that bears N 00°03'24" W, for an arc distance of 650.93 feet to a 1/2 inch iron rod set for a corner;

THENCE N 08°44'12" W, a distance of 40.60 feet to a 1/2 inch iron rod set for a corner;

THENCE continuing along the curve to the RIGHT having a central angle of 01°10'20", a radius of 5779.58 feet, a tangent of 59.12 feet and chord distance of 118.24 feet that bears S 47°10'06" E, for an arc distance of 118.24 feet to a 1/2 inch iron rod set for a corner;

THENCE S 79°55'15" W, a distance of 31.55 feet to a 1/2 inch iron rod set for a corner;

THENCE continuing along the curve to the LEFT having a central angle of 54°23'24", a radius of 595.00 feet, a tangent of 305.72 feet and chord distance of 543.85 feet that bears S 00°37'51" E, for an arc distance of 564.82 feet to a 1/2 inch iron rod set for a corner;

THENCE continuing along the curve to the LEFT having a central angle of 12°53'07", a radius of 458.82 feet, a tangent of 51.81 feet and chord distance of 102.97 feet that bears S 44°10'17" E, for an arc distance of 103.18 feet to a 1/2 inch iron rod set for a corner;

THENCE S 68°06'25" E, a distance of 175.34 feet to a 1/2 inch iron rod set for a corner;

THENCE N 79°23'56" E, a distance of 37.01 feet to a 1/2 inch iron rod set for a corner;

THENCE N 36°54'18" E, a distance of 346.06 feet to a 1/2 inch iron rod set for a corner;

THENCE N 05°27'13" W, a distance of 37.10 feet to a 1/2 inch iron rod set for a corner;

THENCE S 47°48'43" E, a distance of 60.26 feet to POINT OF BEGINNING and containing 96,707 square feet or 2.220 acres of land, more or less.

**METES & BOUNDS DESCRIPTION**

**TACK "B" - UTILITY EASEMENT**

WHEREAS H.GEORGE SCHULER, TRUSTEE, BEING THE OWNER OF A TRACT OF land in the County of Rockwall, State of Texas, said tract being a tract of land situated in the Edward Teal Survey, Abstract No. 207, Rockwall County, Texas, and being a part of Tract 5, conveyed from Whittle Development, Inc. to Schlumberger Technology Corporation by Special Warranty Deed recorded in Volume 597, page 93, Deed Records, Rockwall County, Texas, and being more particularly described by metes and bounds as following;

**COMMENCING** at a 1/2 inch iron rod found in the R.O.W. line of Horizon Road (variable width R.O.W.) said point being the northeast corner of this tract (POINT OF BEGINNING OF TACK "A"), also being in the northeast corner of the City of Rockwall waste water treatment plant tract. THENCE N 47°48'43" W, along said north right-of-way line of Horizon Road (Farmer Market 3097) a distance of 60.26 feet to a corner. THENCE S 05°27'13" E, a distance of 7.42 feet to POINT OF BEGINNING;

THENCE S 05°27'13" E, a distance of 14.84 feet to a corner;

THENCE N 47°48'43" W, a distance of 599.37 feet to a corner;

THENCE continuing along the curve to the RIGHT having a central angle of 00°10'19", a radius of 5794.58 feet, a tangent of 8.70 feet and chord distance of 17.39 feet that bears N 47°43'33" W, for an arc distance of 17.39 feet to a corner;

THENCE N 79°55'15" E, a distance of 12.62 feet to a corner;

THENCE continuing along the curve to the LEFT having a central angle of 00°05'45", a radius of 5784.58 feet, a tangent of 4.83 feet and chord distance of 9.67 feet that bears S 47°45'51" E, for an arc distance of 9.67 feet to a corner;

THENCE S 47°48'43" E, a distance of 588.40 feet to POINT OF BEGINNING and containing 6,074 square feet or 0.139 acres of land, more or less.

**METES & BOUNDS DESCRIPTION**

**TACK "C" - UTILITY EASEMENT**

WHEREAS H.GEORGE SCHULER, TRUSTEE, BEING THE OWNER OF A TRACT OF land in the County of Rockwall, State of Texas, said tract being a tract of land situated in the Edward Teal Survey, Abstract No. 207, Rockwall County, Texas, and being a part of Tract 5, conveyed from Whittle Development, Inc. to Schlumberger Technology Corporation by Special Warranty Deed recorded in Volume 597, page 93, Deed Records, Rockwall County, Texas, and being more particularly described by metes and bounds as following;

**COMMENCING** at a 1/2 inch iron rod found in the R.O.W. line of Horizon Road (variable width R.O.W.) said point being the northeast corner of this tract (POINT OF BEGINNING OF TACK "A"), also being in the northeast corner of the City of Rockwall waste water treatment plant tract. THENCE continuing along the curve to the RIGHT having a central angle of 01°13'47", a radius of 5779.58 feet, a tangent of 62.02 feet and chord distance of 124.04 feet that bears N 47°11'49" W, for an arc distance of 124.04 feet to a corner. THENCE S 08°44'12" E, a distance of 8.16 feet to POINT OF BEGINNING;

THENCE S 08°44'12" E, a distance of 16.25 feet to a corner;

THENCE continuing along the curve to the RIGHT having a central angle of 01°07'39", a radius of 5794.58 feet, a tangent of 57.01 feet and chord distance of 114.02 feet that bears N 46°12'32" W, for an arc distance of 114.02 feet to a corner;

THENCE N 45°38'43" W, a distance of 390.27 feet to a corner;

THENCE N 52°42'43" W, a distance of 33.51 feet to a corner;

THENCE N 05°40'09" E, a distance of 11.74 feet to a corner;

THENCE S 52°42'43" E, a distance of 40.29 feet to a corner;

THENCE S 45°38'43" E, a distance of 390.89 feet to a corner;

THENCE continuing along the curve to the LEFT having a central angle of 01°00'02", a radius of 5784.58 feet, a tangent of 50.51 feet and chord distance of 101.02 feet that bears S 46°08'44" E, for an arc distance of 101.02 feet to POINT OF BEGINNING and containing 5,350 square feet or 0.123 acres of land, more or less.

**METES & BOUNDS DESCRIPTION**

**TRACK "D" - DRAINAGE EASEMENT**

WHEREAS H.GEORGE SCHULER, TRUSTEE, BEING THE OWNER OF A TRACT OF land in the County of Rockwall, State of Texas, said tract being a tract of land situated in the Edward Teal Survey, Abstract No. 207, Rockwall County, Texas, and being a part of Tract 5, conveyed from Whittle Development, Inc. to Schlumberger Technology Corporation by Special Warranty Deed recorded in Volume 597, page 93, Deed Records, Rockwall County, Texas, and being more particularly described by metes and bounds as following;

**COMMENCING** at a 1/2 inch iron rod found in the R.O.W. line of Horizon Road (variable width R.O.W.) said point being the northeast corner of this tract (POINT OF BEGINNING OF TRACK "A"), also being in the northeast corner of the City of Rockwall waste water treatment plant tract. THENCE S 02°18'48" W, along said north right-of-way line of Horizon Road (Farmer Market 3097) a distance of 109.45 feet to a 1/2 inch iron rod set for a corner. THENCE N 47°48'43" W, a distance of 32.28 feet to a 1/2 inch iron rod set for a corner. THENCE S 36°54'18" W, a distance of 286.00 feet to a 1/2 inch iron rod set for a corner. THENCE continuing along the curve to the RIGHT having a central angle of 204°59'17", a radius of 60.00 feet, a tangent of 270.78 feet, and chord distance of 117.16 feet that bears S 79°23'56" W, for an arc distance of 214.66 feet to a 1/2 inch iron rod set for a corner. THENCE N 58°06'25" W, a distance of 184.65 feet to a 1/2 inch iron rod set for a corner. THENCE continuing along the curve to the RIGHT having a central angle of 13°59'11", a radius of 523.82 feet, a tangent of 64.25 feet and chord distance of 127.55 feet that bears N 44°06'07" W, for an arc distance of 127.87 feet to a 1/2 inch iron rod set for a corner. THENCE continuing along the curve to the RIGHT having a central angle of 00°26'05", a radius of 660.00 feet, a tangent of 2.50 feet and chord distance of 5.01 feet that bears N 28°05'38" W, for an arc distance of 5.01 feet to POINT OF BEGINNING;

THENCE S 65°18'32" W, a distance of 259.38 feet to a corner;

THENCE N 04°49'57" W, a distance of 21.26 feet to a corner;

THENCE N 65°18'32" E, a distance of 251.20 feet to a corner;

THENCE continuing along the curve to the LEFT having a central angle of 01°44'18", a radius of 660.00 feet, a tangent of 10.01 feet and chord distance of 20.02 feet that bears S 27°26'32" E, for an arc distance of 20.02 feet to POINT OF BEGINNING and containing 5,105 square feet or 0.117 acres of land, more or less.

**METES & BOUNDS DESCRIPTION**

**TRACK "E" - UTILITY EASEMENT**

WHEREAS H.GEORGE SCHULER, TRUSTEE, BEING THE OWNER OF A TRACT OF land in the County of Rockwall, State of Texas, said tract being a tract of land situated in the Edward Teal Survey, Abstract No. 207, Rockwall County, Texas, and being a part of Tract 5, conveyed from Whittle Development, Inc. to Schlumberger Technology Corporation by Special Warranty Deed recorded in Volume 597, page 93, Deed Records, Rockwall County, Texas, and being more particularly described by metes and bounds as following;

**COMMENCING** at a 1/2 inch iron rod found in the R.O.W. line of Horizon Road (variable width R.O.W.) said point being the northeast corner of this tract (POINT OF BEGINNING OF TRACK "A"), also being in the northeast corner of the City of Rockwall waste water treatment plant tract. THENCE S 02°18'48" W, a distance of 109.45 feet to a 1/2 inch iron rod set for a corner. THENCE N 47°48'43" W, a distance of 32.28 feet to a 1/2 inch iron rod set for a corner. THENCE S 36°54'18" W, a distance of 286.00 feet to a 1/2 inch iron rod set for a corner. THENCE continuing along the curve to the RIGHT having a central angle of 98°47'09", a radius of 60.00 feet, a tangent of 69.99 feet and chord distance of 91.10 feet that bears N 26°17'52" E, for an arc distance of 103.45 feet to POINT OF BEGINNING;

THENCE S 24°14'53" E, a distance of 51.56 feet to a corner;

THENCE continuing along the curve to the RIGHT having a central angle of 26°33'41", a radius of 55.00 feet, a tangent of 12.98 feet and chord distance of 25.27 feet that bears S 10°58'03" E, for an arc distance of 25.50 feet to a corner;

THENCE S 02°18'48" W, a distance of 322.15 feet to a corner;

THENCE S 05°09'34" E, a distance of 257.94 feet to a corner;

THENCE continuing along the curve to the LEFT having a central angle of 94°45'13", a radius of 55.00 feet, a tangent of 59.76 feet and chord distance of 80.94 feet that bears S 42°13'03" W, for an arc distance of 90.96 feet to a corner;

THENCE S 89°35'39" W, a distance of 229.06 feet to a corner;

THENCE S 05°09'37" E, a distance of 50.17 feet to a corner;

THENCE S 89°35'39" W, a distance of 25.09 feet to a corner;

THENCE N 05°09'37" W, a distance of 339.96 feet to a corner;

THENCE S 84°50'23" W, a distance of 68.43 feet to a corner;

THENCE N 23°41'45" W, a distance of 26.37 feet to a corner;

THENCE N 84°50'23" E, a distance of 121.81 feet to a corner;

THENCE S 05°09'37" E, a distance of 291.78 feet to a corner;

THENCE N 89°35'39" E, a distance of 231.14 feet to a corner;

THENCE continuing along the curve to the LEFT having a central angle of 94°45'13", a radius of 30.00 feet, a tangent of 32.60 feet and chord distance of 44.15 feet that bears N 42°13'03" E, for an arc distance of 49.61 feet to a corner;

THENCE N 05°09'34" W, a distance of 259.57 feet to a corner;

THENCE N 02°18'48" E, a distance of 323.79 feet to a corner;

THENCE continuing along the curve to the RIGHT having a central angle of 26°33'41", a radius of 30.00 feet, a tangent of 7.08 feet and chord distance of 13.78 feet that bears N 10°58'03" W, for an arc distance of 13.91 feet to a corner;

THENCE N 24°14'53" W, a distance of 62.19 feet to a corner;

THENCE continuing along the curve to the LEFT having a central angle of 26°09'57", a radius of 60.00 feet, a tangent of 13.94 feet and chord distance of 27.16 feet that bears N 88°46'26" E, for an arc distance of 27.40 feet to POINT OF BEGINNING and containing 35,404 square feet or 0.813 acres of land, more or less.

**METES & BOUNDS DESCRIPTION**

**TRACK "F" - UTILITY EASEMENT**

WHEREAS H.GEORGE SCHULER, TRUSTEE, BEING THE OWNER OF A TRACT OF land in the County of Rockwall, State of Texas, said tract being a tract of land situated in the Edward Teal Survey, Abstract No. 207, Rockwall County, Texas, and being a part of Tract 5, conveyed from Whittle Development, Inc. to Schlumberger Technology Corporation by Special Warranty Deed recorded in Volume 597, page 93, Deed Records, Rockwall County, Texas, and being more particularly described by metes and bounds as following;

**COMMENCING** at a 1/2 inch iron rod found in the R.O.W. line of Horizon Road (variable width R.O.W.) said point being the northeast corner of this tract (POINT OF BEGINNING OF TRACK "A"), also being in the northeast corner of the City of Rockwall waste water treatment plant tract. THENCE S 02°18'48" W, along said north right-of-way line of Horizon Road (Farmer Market 3097) a distance of 109.45 feet to a 1/2 inch iron rod set for a corner. THENCE N 47°48'43" W, a distance of 22.24 feet to POINT OF BEGINNING;

THENCE S 36°54'18" W, a distance of 279.59 feet to a corner;

THENCE continuing along the curve to the RIGHT having a central angle of 92°30'17", a radius of 70.00 feet, a tangent of 73.13 feet, and chord distance of 101.13 feet that bears S 28°00'26" W, for an arc distance of 113.02 feet to a corner;

THENCE N 24°14'53" W, a distance of 10.13 feet to a corner;

THENCE continuing along the curve to the LEFT having a central angle of 98°47'09", a radius of 60.00 feet, a tangent of 69.99 feet and chord distance of 91.10 feet that bears N 26°17'52" E, for an arc distance of 103.45 feet to a 1/2 inch iron rod set for a corner;

THENCE N 36°54'18" E, a distance of 286.00 feet to a 1/2 inch iron rod set for a corner;

THENCE S 47°48'43" E, a distance of 10.04 feet to POINT OF BEGINNING and containing 3,910 square feet or 0.090 acres of land, more or less.

**METES & BOUNDS DESCRIPTION**

**TRACK "G" - UTILITY EASEMENT**

WHEREAS H.GEORGE SCHULER, TRUSTEE, BEING THE OWNER OF A TRACT OF land in the County of Rockwall, State of Texas, said tract being a tract of land situated in the Edward Teal Survey, Abstract No. 207, Rockwall County, Texas, and being a part of Tract 5, conveyed from Whittle Development, Inc. to Schlumberger Technology Corporation by Special Warranty Deed recorded in Volume 597, page 93, Deed Records, Rockwall County, Texas, and being more particularly described by metes and bounds as following;

**COMMENCING** at a 1/2 inch iron rod found in the R.O.W. line of Horizon Road (variable width R.O.W.) said point being the northeast corner of this tract (POINT OF BEGINNING OF TRACK "A"), also being in the northeast corner of the City of Rockwall waste water treatment plant tract. THENCE S 02°18'48" W, a distance of 109.45 feet to a 1/2 inch iron rod set for a corner. THENCE N 47°48'43" W, a distance of 32.28 feet to a 1/2 inch iron rod set for a corner. THENCE S 36°54'18" W, a distance of 286.00 feet to a 1/2 inch iron rod set for a corner. THENCE continuing along the curve to the RIGHT having a central angle of 98°47'09", a radius of 60.00 feet, a tangent of 69.99 feet and chord distance of 91.10 feet that bears N 26°17'52" E, for an arc distance of 103.45 feet to a corner. THENCE S 24°14'53" E, a distance of 47.09 feet to a corner. THENCE continuing along the curve to the RIGHT having a central angle of 26°33'41", a radius of 55.00 feet, a tangent of 12.98 feet and chord distance of 25.27 feet that bears S 10°58'03" E, for an arc distance of 25.50 feet to a corner. THENCE S 02°18'48" W, a distance of 326.30 feet to a corner. THENCE S 05°09'34" E, a distance of 257.89 feet to POINT OF BEGINNING;

THENCE S 05°09'34" E, a distance of 109.94 feet to a corner;

THENCE S 89°35'39" W, a distance of 15.05 feet to a corner;

THENCE N 05°09'34" W, a distance of 70.94 feet to a corner;

THENCE continuing along the curve to the LEFT having a central angle of 43°20'30", a radius of 55.00 feet, a tangent of 21.85 feet and chord distance of 40.62 feet that bears N 16°30'42" E, for an arc distance of 41.61 feet to POINT OF BEGINNING and containing 1,251 square feet or 0.029 acres of land, more or less.

**METES & BOUNDS DESCRIPTION**

**TRACK "H" - RIGHT-OF-WAY DEDICATION**

WHEREAS H.GEORGE SCHULER, TRUSTEE, BEING THE OWNER OF A TRACT OF land in the County of Rockwall, State of Texas, said tract being a tract of land situated in the Edward Teal Survey, Abstract No. 207, Rockwall County, Texas, and being a part of Tract 5, conveyed from Whittle Development, Inc. to Schlumberger Technology Corporation by Special Warranty Deed recorded in Volume 597, page 93, Deed Records, Rockwall County, Texas, and being more particularly described by metes and bounds as following;

**COMMENCING** at a 1/2 inch iron rod found in the R.O.W. line of Horizon Road (variable width R.O.W.) said point being the northeast corner of this tract (POINT OF BEGINNING OF TRACK "A"), also being in the northeast corner of the City of Rockwall waste water treatment plant tract. THENCE N 47°48'43" W, along said north right-of-way line of Horizon Road (Farmer Market 3097) a distance of 60.26 feet to POINT OF BEGINNING;

THENCE S 05°27'13" E, a distance of 7.42 feet to a corner;

THENCE N 47°48'43" W, a distance of 588.40 feet to a corner;

THENCE continuing along the curve to the RIGHT having a central angle of 00°05'45", a radius of 5784.58 feet, a tangent of 4.83 feet, and chord distance of 9.67 feet that bears N 47°45'51" W, for an arc distance of 9.67 feet to a corner;

THENCE N 79°55'15" E, a distance of 6.32 feet to a 1/2 inch iron rod set for a corner;

THENCE continuing along the curve to the LEFT having a central angle of 00°03'27", a radius of 5779.58 feet, a tangent of 2.90 feet and chord distance of 5.79 feet that bears S 47°47'00" E, for an arc distance of 5.80 feet to a 1/2 inch iron rod set for a corner;

THENCE S 47°48'43" E, a distance of 582.91 feet to POINT OF BEGINNING and containing 2,967 square feet or 0.068 acres of land, more or less.

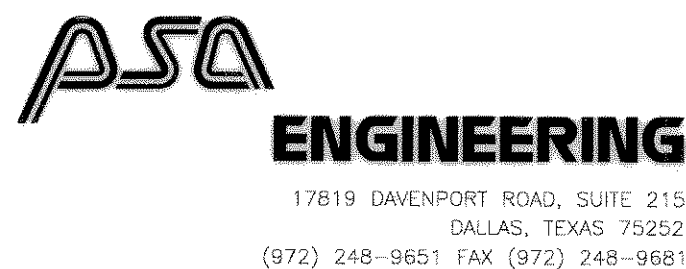

OWNER  
JWS LAND  
1500 E. INDUSTRIAL BOULEVARD  
MCKINNEY, TEXAS 75069  
(972) 562-5555

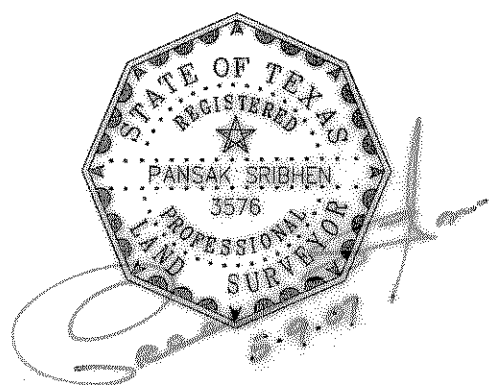

RIGHT OF WAY AND EASEMENTS DEDICATION  
FOR  
HORIZON RIDGE MEDICAL PARK  
SITUATED IN THE  
EDWARD TEAL SURVEY, ABSTRACT NO. 207  
CITY OF ROCKWALL  
ROCKWALL COUNTY, TEXAS  
MAY 9, 2007  
SHEET 2 OF 3

G157

Horizon Medical Park  
2 of 3

Y:\2006\2616.HRM\CURRENT\R.O.W.and DEDICATION.dwg, 5/9/2007 12:13:28 PM