

FILED FOR RECORDS
ROCKWALL COUNTY CLERK
07 MAY 15 PM 12:27
LISA CONSTANT
COUNTY CLERK
BY: _____ DEPUTY

HORIZON ROAD (F.M. 3097)
(VARIABLE R.O.W.)

**EDWARD TEAL SURVEY
ABSTRACT NO. 207**

MEDICAL DRIVE

OWNER
JWS LAND
1500 E. INDUSTRIAL BOULEVARD
McKINNEY, TEXAS 75069
(972) 562-5555

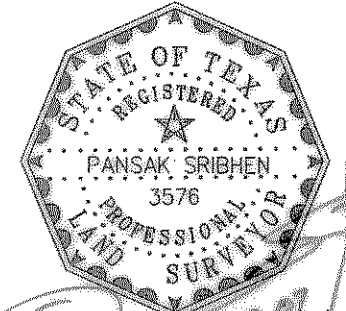

LINE	LENGTH	BEARING
L1	32.28'	N47°48'43"W
L2	40.60'	N08°44'12"W
L3	31.55'	S79°55'15"W
L4	37.01'	N79°23'56"E
L5	37.10'	N05°27'13"W
L6	60.26'	S47°48'43"E
L7	14.84'	S05°27'13"E
L8	7.42'	S05°27'13"E
L9	12.62'	N79°55'15"W
L10	33.51'	N52°42'43"W
L11	11.74'	N05°40'09"E
L12	40.29'	S52°42'43"E
L13	21.26'	N04°49'57"W
L14	51.56'	S24°14'53"E
L15	50.17'	S05°09'37"E
L16	25.09'	S89°35'39"W
L17	26.37'	N23°41'45"W
L18	62.19'	N24°14'53"W
L19	18.25'	S08°44'12"E
L20	8.14'	S08°44'12"E
L21	22.24'	N47°48'43"W
L22	10.13'	N24°14'53"W
L23	10.04'	S47°48'43"E
L24	109.94'	S05°09'34"E
L25	15.05'	S89°35'39"W
L26	70.94'	N05°09'34"W
L27	6.32'	N79°55'15"E
L28	5.87'	N05°40'09"E
L29	43.67'	S52°42'43"E
L30	30.31'	S04°07'16"W
L31	11.80'	S64°49'45"W
L32	25.35'	N58°06'25"W
L33	20.42'	N58°06'25"W
L34	15.00'	S53°05'42"E

CURVE	DELTA	R			CH	CHD
		T	L	T		
C1	204°59'17"	60.00'	270.78'	214.66'	S79°23'56"W	117.16'
C2	56°30'31"	660.00'	354.69'	650.93'	N00°03'24"W	624.87'
C3	1°10'20"	5779.58'	59.12'	118.24'	S47°10'06"E	118.24'
C4	54°23'24"	595.00'	305.72'	564.82'	S00°37'51"E	543.85'
C5	12°53'07"	458.82'	51.81'	103.18'	S44°10'17"E	102.97'
C6	0°05'45"	5784.58'	4.83'	9.67'	S47°45'51"E	9.67'
C7	0°10'19"	5794.58'	6.70'	17.39'	N47°43'33"W	17.39'
C8	1°44'18"	660.00'	10.01'	20.02'	S27°26'32"E	20.02'
C9	98°47'09"	60.00'	69.99'	103.45'	N26°17'52"E	91.10'
C10	26°33'41"	55.00'	12.98'	25.50'	S10°58'03"E	25.27'
C11	94°45'13"	55.00'	59.76'	90.96'	S42°13'03"W	80.94'
C12	94°45'13"	30.00'	32.60'	49.61'	N42°13'03"E	44.15'
C13	26°33'41"	30.00'	7.08'	13.91'	N10°58'03"W	13.78'
C14	26°09'57"	60.00'	13.94'	27.40'	N88°46'25"E	27.16'
C15	92°38'17"	70.00'	73.13'	113.02'	S28°00'26"W	101.13'
C16	43°20'30"	55.00'	21.85'	41.61'	N16°30'48"E	40.62'
C17	0°03'27"	5779.58'	2.90'	5.80'	S47°47'00"E	5.79'
C18	1°00'02"	5784.58'	50.51'	101.02'	S46°08'44"E	101.02'
C19	0°56'13"	5779.58'	47.26'	94.51'	S46°06'50"E	94.51'
C20	13°59'11"	523.82'	64.25'	127.87'	N44°06'07"W	127.55'
C21	1°07'39"	5794.58'	57.01'	114.02'	N46°12'32"W	114.02'
C22	41°51'08"	92.50'	35.37'	67.57'	N57°49'52"E	66.08'
C23	33°53'03"	107.50'	32.75'	63.57'	S53°50'49"W	62.65'

RIGHT OF WAY AND EASEMENTS DEDICATION
FOR
HORIZON RIDGE MEDICAL PARK
SITUATED IN THE
EDWARD TEAL SURVEY, ABSTRACT NO. 207
CITY OF ROCKWALL
ROCKWALL COUNTY, TEXAS
MAY 9, 2007
SHEET 1 OF 3

G 156

Y:\2006\2616.HRM\CURRENT\I.O.W.and DEDICATION.dwg, 5/9/2007 12:13:20 PM

ASA ENGINEERING
17819 DAVENPORT ROAD, SUITE 215
DALLAS, TEXAS 75252
(972) 248-9651 FAX (972) 248-9681

NTMWD
DRRCT
VOL. 184, PG. 154

NTMWD
DRRCT
VOL. 609, PG. 14

JOHN SCOTT
TRACT 4-5
VOL. 727, PG. 9

R.O.W
Horizon Ridge Medical Park