

# CONSTRUCTION PLANS

FOR

## PAVING, DRAINAGE & UTILITY IMPROVEMENTS

### MEDICAL DRIVE

IN

# CITY OF ROCKWALL, TEXAS

**MAYOR**  
**BILL CECIL**

**CITY COUNCIL**

**STEPHEN STRAUGHAN, Mayor Pro Tem**  
**MARGO NIELSEN**  
**GLEN FARRIS**

**MATT SCOTT**  
**DAVID SWEET**  
**CLIFF SEVIER**

**CITY MANAGER**  
**JULIE COUCH**

**DIR OF PUBLIC WORKS & CITY ENGINEER**  
**CHUCK TODD, P.E.**

**AS BUILT**

THIS IS TO CERTIFY THAT CHANGES AND CORRECTIONS HAVE BEEN MADE TO CONFORM TO THE CONTRACTOR'S RECORD OF THIS PROJECT.

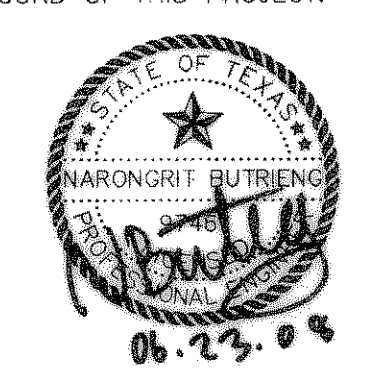

**PROJECT ENGINEER**  
**PANN S. SRIBHEN, P.E.**

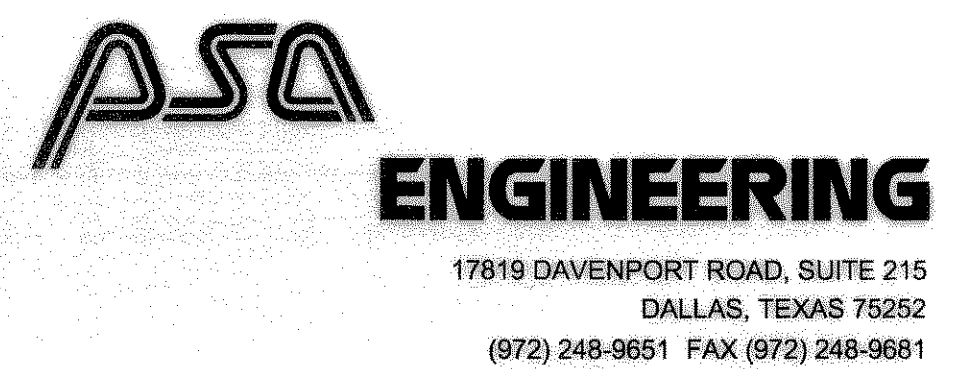

**SCHULER DEVELOPMENT**

1500 INDUSTRIAL BLVD  
MCKINNEY, TX 75069  
(972) 562-5555

SHEET  
**G-1**  
JUNE 23, 2008

AS BUILT

#### SHEET INDEX

- G-1 COVER SHEET
- C-1 CONCEPTUAL PLAN
- C-2 PAVEMENT CROSS SECTIONS
- C-3 GRADING PLAN
- C-4 DRAINAGE AREA MAP
- C-4.1 EXISTING DRAINAGE AREA MAP
- C-5 MEDICAL DRIVE PAVING PLAN AND PROFILE STA. 0+00 TO 8+50
- C-6 MEDICAL DRIVE PAVING PLAN AND PROFILE STA. 8+50 TO 14+50
- C-7 PLAN AND PROFILE STORM DRAIN LINE "A" (1)
- C-8 PLAN AND PROFILE STORM DRAIN LINE "A" (2)
- C-9 PLAN AND PROFILE STORM DRAIN LINE "B"
- C-10 LATERAL OF LINE "A" AND "B"
- C-10.A CULVERT PLAN AND PROFILE
- C-11 WATER LAYOUT PLAN
- C-12 PROFILE WATER LINE "D"
- C-13 PROFILE WATER LINE "E"
- C-14 PLAN AND PROFILE SANITARY SEWER LINE "C" STA. 0+00 TO 8+00
- C-15 PLAN AND PROFILE SANITARY SEWER LINE "C" STA. 8+00 TO 13+70
- C-16 LOCATION PLAN FOR HORIZON ROAD IMPROVEMENT
- C-17 PAVING PLAN
- C-18 MARKING PLAN
- C-19 MARKING DETAILS
- C-20 CROSS SECTION PLAN
- C-21 CROSS SECTION DETAILS-1
- C-22 CROSS SECTION DETAILS-2
- C-23 CROSS SECTION DETAILS-3
- C-24 CROSS SECTION DETAILS-4

\*\*STANDARD CONSTRUCTION DETAILS FOR CITY OF ROCKWALL NOT INCLUDE IN THIS SET

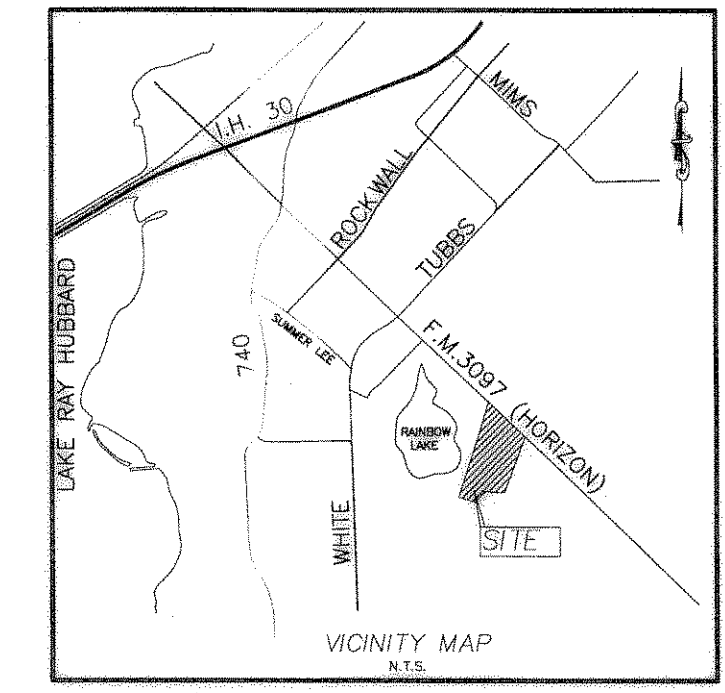

1:300612616.HRM\AS-BUILT\SET 1IG-1.dwg