

PHASE II & III  
 PLUG INLETS AND DIRECT  
 RUNOFF TO SILT POND  
 PHASE III  
 INSTALL INLET TREATMENT  
 AFTER PAVEMENT CONSTRUCTION

PHASE I, II, & III  
 PROVIDE INLET  
 TREATMENT  
 EXISTING INLET

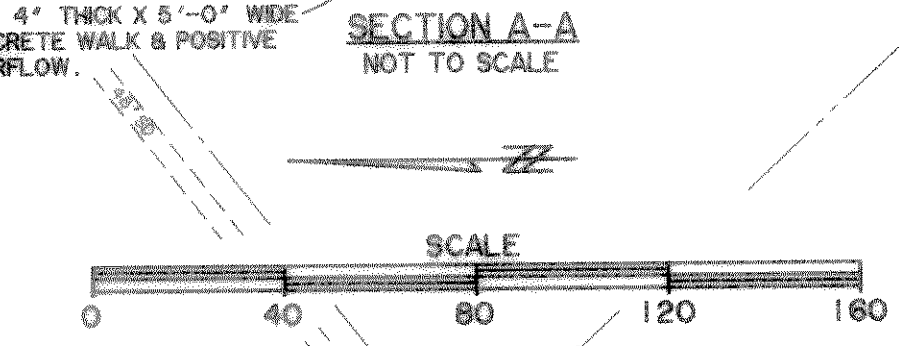
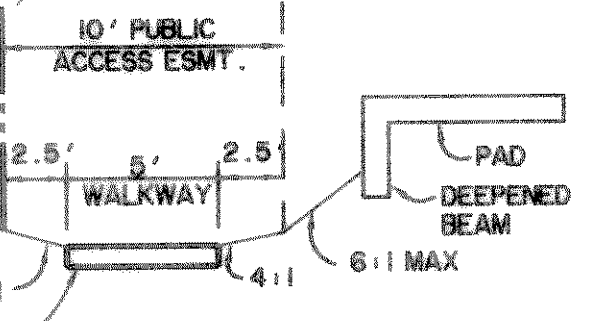

PHASE I, II, & III  
 REPAIR & MAINTAIN  
 EXIST. SILT FENCE

PHASE I, II & III  
 MAINTAIN EXISTING SEDIMENTATION BASIN  
 IN SERVICE ON LOTS 44 & 45 DURING PHASE  
 I & II CONSTRUCTION UNTIL INLET TREATMENT  
 IS IN SERVICE. REMOVE EXISTING SILT POND  
 AFTER PAVEMENT IS CONSTRUCTED. REMOVE  
 EXISTING SILT TO PROVIDE MINIMUM 38,000 C.Y.  
 TO OVER FLOW ELEVATION = 645.0

PHASE I, II & III  
 EXISTING 20' SPILLWAY  
 TO REMAIN IN SERVICE. SEE  
 DETAIL THIS SHEET.

PHASE I, II & III  
 REVEGETATE AREA DISTURBED  
 BY UTILITY CONSTRUCTION  
 REFER TO DETAILS SHEET 5 OF PLANS

TEMPORARY COFFER DAM  
 SEE NOTE 1  
 BACKFILL & COMPACT EXISTING  
 TRENCH. REVEGETATE AREA  
 DISTURBED.

**LEGEND**

- DENOTES SWALE
- EXISTING CONTOURS
- PROPOSED CONTOUR
- PROPOSED GRADING
- RETAINING WALL
- DENOTES NATURAL VEGETATION FILTERS & AREAS WHERE TREES SHALL BE SAVED. AREAS TO REMAIN UNDISTURBED.
- DENOTES SLOPES AND AREAS TO BE SEEDED BY GRADING CONTRACTOR PHASE I.
- DENOTES SLOPES AND AREAS TO BE SEEDED BY UTILITY CONTRACTOR PHASE II. SEE CITY OF DALLAS REQUIREMENTS FOR PORTION ON LAKE RAY HUBBARD.
- DENOTES EXTERNAL PARKWAYS & SLOPE AREAS TO BE SEEDED BY PAVING CONTRACTOR AFTER WALLS & PAVING.
- DENOTES INLET TREATMENT PHASE II & III TYPICAL

PHASE II  
 REVEGETATE DISTURBED AREAS  
 BY UTILITY CONSTRUCTION...  
 REFER TO DETAILS SHEET 5.

PHASE I & II  
 CONSTRUCT SWALE TO DIRECT  
 LOW POINT TO 12" HIGH BY  
 20' LONG ROCK BERM IN  
 "U" SHAPE TO REMAIN  
 IN SERVICE UNTIL STREETS  
 ARE PAVED.

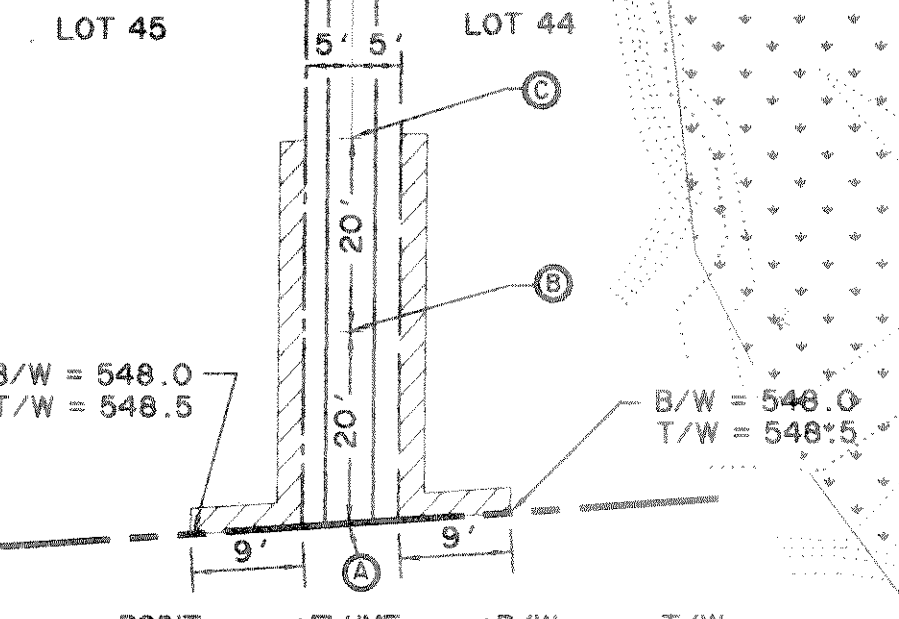

POINT	FLUME	B/W	T/W
A	545.0	545.6	547.5
B	545.9	546.5	547.5
C	546.5	547.1	547.5

\* B/W AND T/W NORTH AND SOUTH OF FLUME

PHASE I, II, & III  
 INSTALL AND MAINTAIN SILT  
 FENCE CONTINUOUSLY  
 ALONG PROPERTY LINE UNTIL  
 RETAINING WALLS CONSTRUCTED  
 AND LOTS REVEGETATED  
 PLACE SILT FENCE ON PROPERTY  
 LINE.

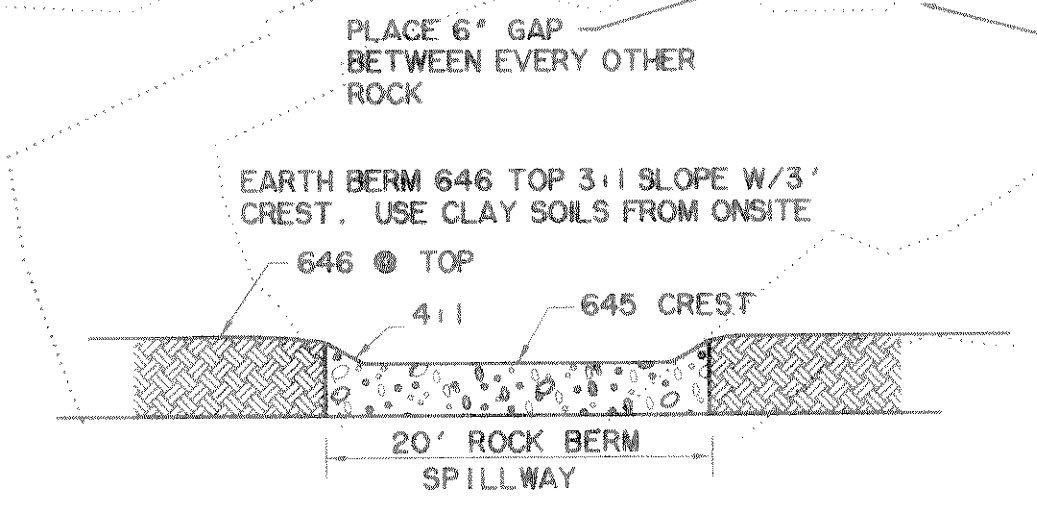

- GENERAL NOTES:**
- USE ONLY OPEN GRADED ROCK 4-8" IN DIAMETER FOR STREAM FLOW CONDITION. USE OPEN GRADED ROCK 3-5" IN DIAMETER FOR OTHER CONDITIONS.
  - THE ROCK BERM SHALL BE SECURED WITH A WOVEN WIRE SHEATHING HAVING A MAXIMUM OPENING OF 1" AND A MINIMUM WIRE SIZE OF 20 GAUGE AND SHALL BE BURIED IN A TRENCH APPROXIMATELY 6" DEEP.

RATING =  $\frac{\text{SEDIMENT RETAINED}}{\text{TOTAL SEDIMENT LOADING}} = 0.75$

**404 JURISDICTIONAL NOTE 1**

THE CONTRACTOR MUST COMPLY WITH APPLICABLE 404 JURISDICTION NATION WIDE PERMITS DURING CONSTRUCTION OF THE STORM DRAIN OUTLET. THE CONTRACTOR SHALL NOT EXTEND GRADING FOR THE OUTLET BEYOND THE SIDE OF THE EXISTING CHANNEL CAUSING DREDGING INTO THE LAKE. THE CONTRACTOR MAY INSTALL SHEET PILING ALONG THE EDGE OR INSTALL A TEMPORARY EARTHEN COFFER DAM AS SHOWN. THE COFFER DAM VOLUME CANNOT EXCEED TEN CUBIC YARDS OF EARTHEN MATERIAL. THE COFFER DAM IF USED MUST BE REMOVED WITHOUT ENTERING THE LAKE BY BACKHOE SET AT THE SHORE. EVERY EFFORT SHALL BE MADE TO AVOID SILT AND EARTHEN MATERIALS ENTERING THE LAKE BY THE CONSTRUCTION OPERATION. PMP DISCHARGES TO DE-WATER BEHIND THE COFFER DAM OR SHEETS PILES SHALL BE DISCHARGED OVER VEGETATIVE FILTERS TO REMOVE SILT OR DISCHARGED IN THE SEDIMENTATION POND. SHEET PILES TO BE REMOVED UPON COMPLETION OF CONSTRUCTION IF USED.

**EXISTING SEDIMENTATION BASIN ROCK BERM**  
 N.T.S.

\* LOTS WITH PADS AND/OR WALLS REVISED I-1-96

NOTE  
 THE REMAINING SLOPES WILL BE SEEDDED AFTER PAVING AND RETAINING WALLS ARE CONSTRUCTED

**RECORD PLANS**  
 2-13-96

PREPARED BY:  
**WIER & ASSOCIATES, INC.**  
 ENGINEERS SURVEYORS LAND PLANNERS  
 4300 BELWAY PLACE SUITE 130 ARLINGTON, TEXAS 76010 (817) 467-7700  
 3908 SOUTH FREEMAN FORT WORTH, TEXAS 76110 (817) 792-0212

**HILLCREST SHORES  
 PHASE II  
 CITY OF ROCKWALL,  
 ROCKWALL COUNTY, TEXAS**

**GRADING & EROSION  
 CONTROL PLAN  
 WEST**

STATE OF TEXAS  
 JULY 1, 1930  
 40864  
 REGISTERED PROFESSIONAL ENGINEER

1/24/96

COPYRIGHT ©  
 WIER & ASSOCIATES, INC.  
 LAST SHEET EDIT  
 DATE 01-24-96  
 FILE C:\93065\G  
 WA# 93065

**SHEET NO.**  
 27