



- * BENCH MARKS ***
- BOX CUT IN TOP OF CURB AT CURB LAYDOWN FOR HANDICAP RAMP AT NORTHEAST CORNER OF INTERSECTION NORTH LAKESHORE DRIVE & BAY HILL DRIVE. ELEV. 523.40
 - BOX CUT IN WEST END CURB INLET TOP AT NORTHEAST CORNER OF INTERSECTION OF BAY HILL DRIVE AND SUNSET HILL DRIVE. ELEV. 449.74

CAUTION !!!
UNDERGROUND UTILITIES

EXISTING UTILITIES AND UNDERGROUND FACILITIES INDICATED ON THESE PLANS HAVE BEEN LOCATED FROM REFERENCE INFORMATION SUPPLIED BY VARIOUS OWNERS OF THE FACILITIES. THE ENGINEER DOES NOT ACCEPT THE RESPONSIBILITY FOR THE UTILITY LOCATIONS SHOWN. IT SHALL BE THE RESPONSIBILITY OF THE CONTRACTOR TO VERIFY BOTH HORIZONTALLY AND VERTICALLY THE LOCATION OF ALL EXISTING UTILITIES AND UNDERGROUND FACILITIES PRIOR TO CONSTRUCTION, TO TAKE NECESSARY PRECAUTIONS IN ORDER TO PROTECT ALL FACILITIES ENCOUNTERED, AND TO NOTIFY THE ENGINEER PROMPTLY OF ALL CONFLICTS OF THE WORK WITH EXISTING FACILITIES. THE CONTRACTOR SHALL PRESERVE AND PROTECT ALL EXISTING UTILITIES FROM DAMAGE DURING CONSTRUCTION. ANY DAMAGE BY THE CONTRACTOR TO EXISTING UTILITIES SHALL BE REPAIRED BY THE CONTRACTOR AT HIS EXPENSE. CONTACT ALL POSSIBLE UTILITY AND UNDERGROUND FACILITY OWNERS.

POINT	CULDESAC T/C ELEV.	ELEV.
A		475.30
B		475.50
C		476.00
D		476.50
E		476.00
F		475.50
G		475.30

CURVE 22

A	27°16'41"	525.00
B	10°54'49"	127.55
C		280.25
D		15.27

CURVE 23

A	35°09'03"	425.00
B	13°28'53"	134.62
C		260.74
D		20.81

CURVE 21

A	07°09'50"	700.00
B	08°11'06"	43.82
C		87.53
D		1.37

CURVE 32

A	09°26'39"	500.00
B	11°27'33"	41.30
C		82.42
D		1.70

CURVE 31

A	29°59'43"	500.00
B	19°06'55"	80.37
C		157.08
D		10.58

MATCH LINE STA. 2+00

EMERALD BAY DRIVE

EMERALD BAY DRIVE

ALLEY "B"

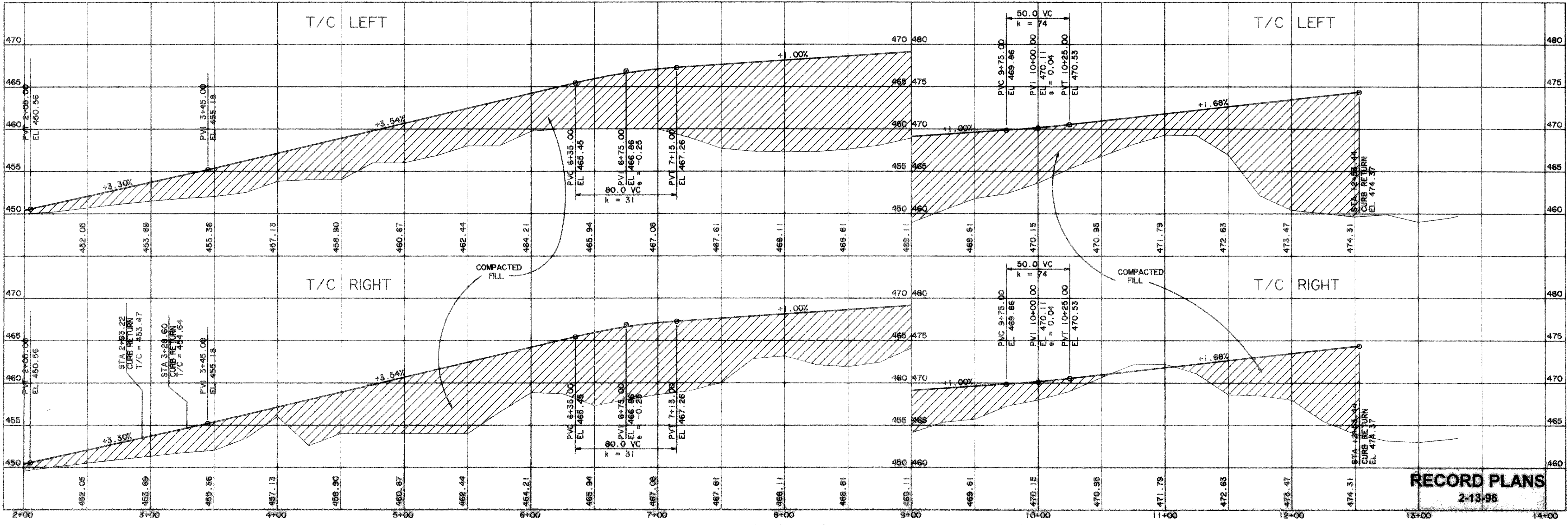

RECORD PLANS
2-13-96

PREPARED BY:
VIA WIER & ASSOCIATES, INC.
ENGINEERS SURVEYORS LAND PLANNERS
4300 BELLEVUE PLACE SUITE 130 ARLINGTON, TEXAS 76018 METRO (817)467-7700
3808 SOUTH FREEDWAY FORT WORTH, TEXAS 76110 (817)926-0212

**HILLCREST SHORES
PHASE II
CITY OF ROCKWALL,
ROCKWALL COUNTY, TEXAS**

**EMERALD BAY DRIVE
PLAN AND PROFILE
STA 2+00 TO STA 13+31.60**



COPYRIGHT ©
WIER & ASSOCIATES, INC.
LAST SHEET EDIT
DATE 02-23-96
FILE PAVE
WA# 93065
SHEET NO. 7