

# HILLCREST SHORES

## CITY OF ROCKWALL, ROCKWALL COUNTY, TEXAS

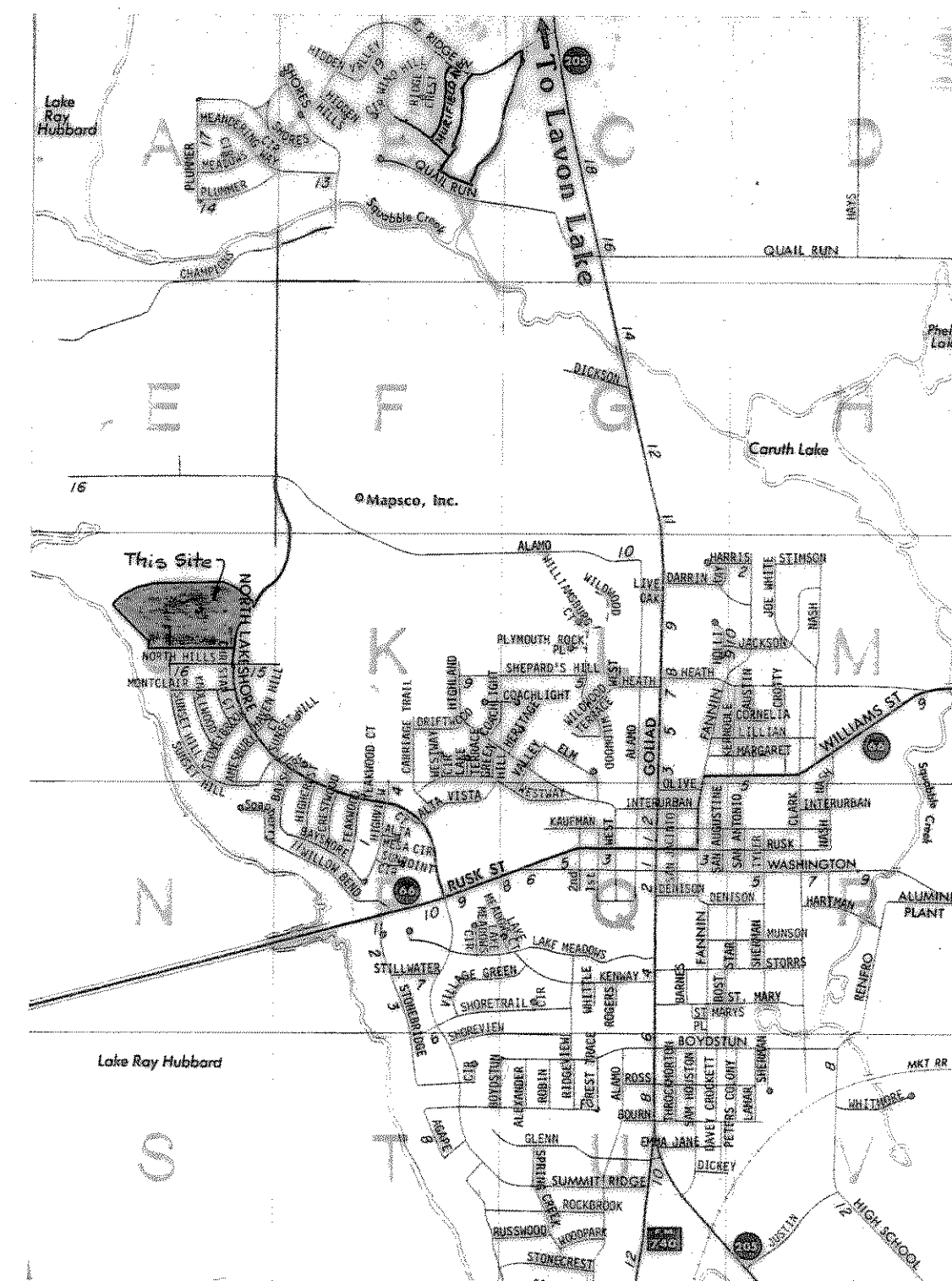

LOCATION MAP

### GENERAL NOTES

1. Excavated material shall be placed as directed by the Owner.
2. All fill areas in street right-of-ways to be density controlled and compacted to 95% density at optimum moisture content.
3. No trees shall be cut except on the specific authority of the Engineer.
4. Construction shall meet the requirements of the latest revision of the "Standard Specifications for Construction", City of Rockwall.
5. Pavement thickness shall be:  
Residential Streets 6"
6. It shall be the responsibility of the Contractor to locate and verify all existing utilities prior to the beginning of construction to insure no conflicts between all utility lines.
7. Where water pipelines either cross or otherwise come within 9 feet of a sanitary sewer pipeline the sewer pipeline shall be either cast iron or PVC pipe with a minimum working pressure Class of 150 PSI.
8. All water services to be 1" installed to the center of each lot with sewer laterals 10' downstream.
9. Conduits for S. W. Bell and Beta Cable T.V. shall have 30" of cover and shall extend 2 feet beyond future paving.

### T. U. ELECTRIC COMPANY GENERAL NOTES

1. Developer to furnish and install all conduit as shown on print.
2. T. U. Electric Company to furnish cable markers.
3. Developer to install 1 (one) cable marker at each end of conduit.
4. All conduit to be Schedule 40 and minimum of 3" in diameter.
5. Each conduit must be buried a minimum of 40" deep (after land is brought to final grade and extend 2 feet beyond future paving).
6. Each conduit must be inspected by the Distribution Department before backfilling in trench. Robert Gaylor 487-2351.
7. Each conduit must have a pull wire installed and be capped at both ends.

OWNER :

MAHR DEVELOPMENT CORPORATION

HAROLD L. EVANS, CONSULTING ENGINEER  
P.O. BOX 28355  
DALLAS, TEXAS 75228  
(214) 328-8133

