

DEMOLITION AND PAVING PLAN

SEE SHEET C5.2 FOR PAVING ON FM 552

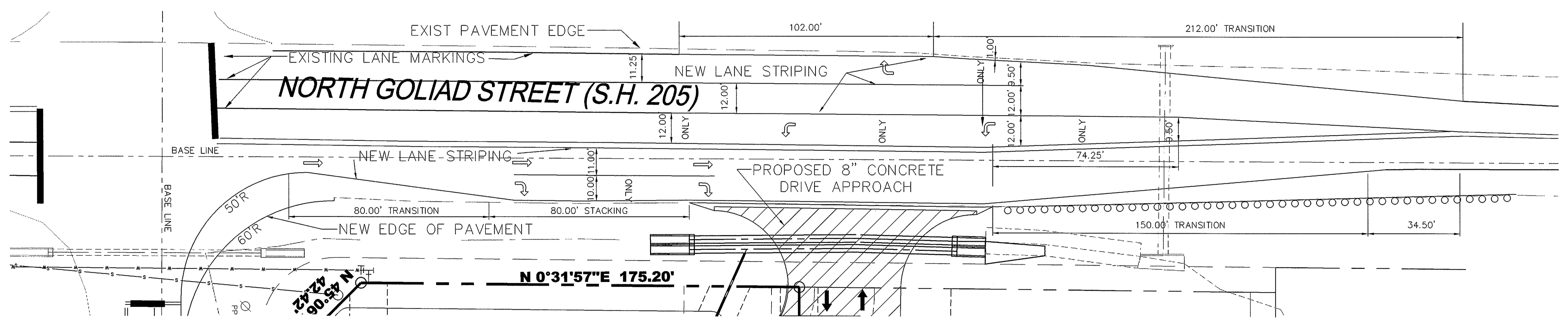

STRIPING PLAN

SEE SHEET C5.2 FOR PAVING ON FM 552

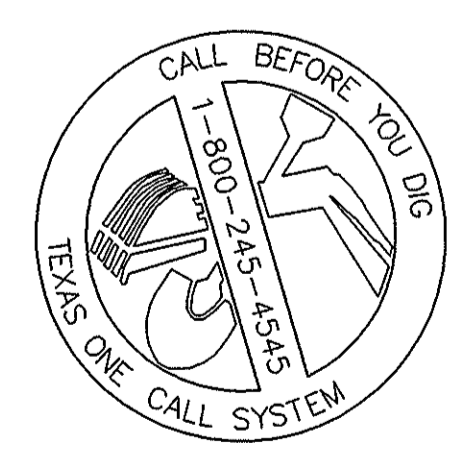
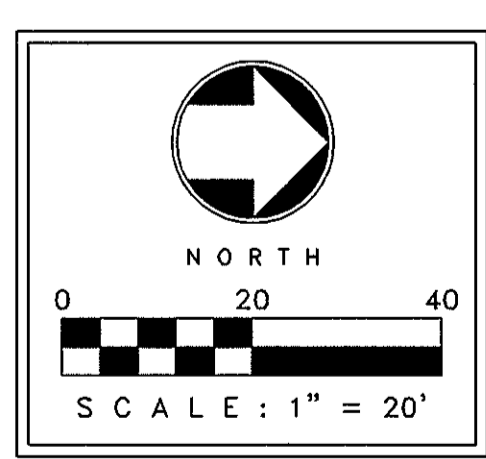

LEGEND	
	SAWCUT (@ 12' MIN - 15'MAX.)
	8" THICK (EXISTING) ASPHALT PAVEMENT. 4000 P.S.I.
	8" THICK ASPHALT PAVEMENT 4000 P.S.I.

No.	DATE	REVISION / DESCRIPTION	BY	No.	DATE	REVISION / DESCRIPTION	BY

THE DIMENSION GROUP
 CIVIL ENGINEERING • LAND DEVELOPMENT • PLANNING • ARCHITECTURE • CONSTRUCTION MANAGEMENT
 10755 SANDHILL ROAD, DALLAS, TEXAS 75238 TEL: 214-343-9400 FAX: 214-341-9060

PROJECT INFO.
 7-ELEVEN
 N.E.C. OF N. GOLIAD STREET
 & FM 552
 ROCKWALL, TEXAS

DRAWING INFO.
 AS-BUILT
 OFFSITE PAVING
 N. GOLIAD STREET
 (S.H. 205)

PROJECT No. 06127
 DATE: 05/18/07
 DRAWN BY: CS
 CHECKED BY: RA

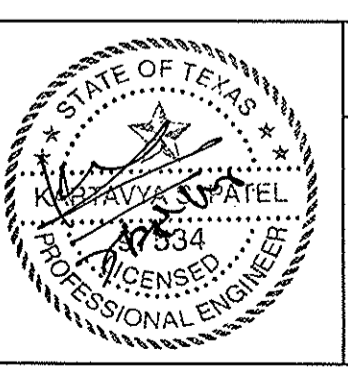

SHEET NUMBER
 C5.1

7-ELEVEN - N.E.C. OF N. GOLIAD STREET (SH 205) & FM 552, ROCKWALL, TEXAS