

CULVERT #1
Scale: N.T.S.

$Q_{100} = 1.42$ cfs
 $D_{100} = 0.38$ cfs
 $V_{100} = 4.09$ cfs

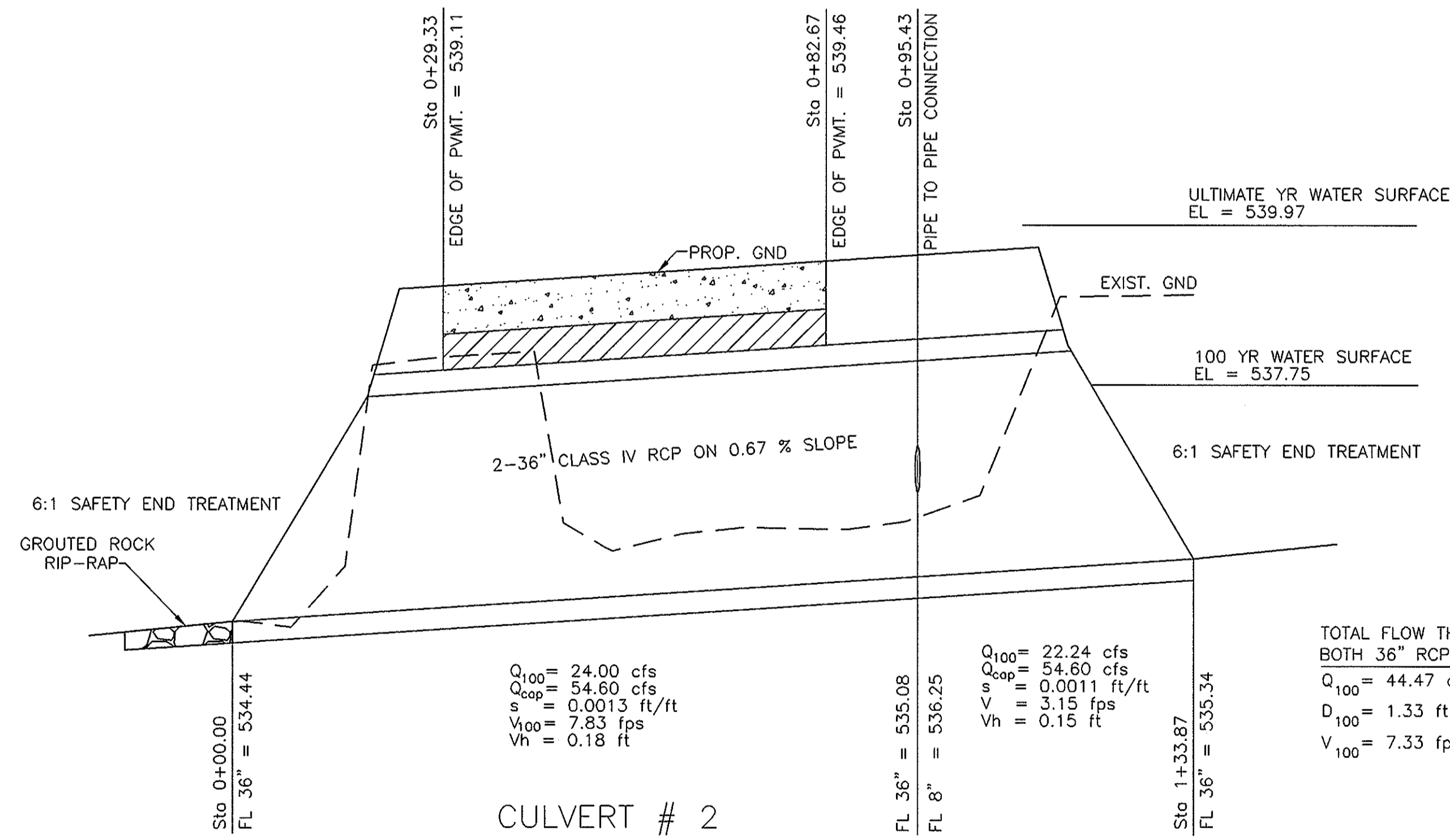

CULVERT #2
Scale: N.T.S.

$Q_{100} = 24.00$ cfs
 $Q_{cap} = 54.60$ cfs
 $s = 0.0013$ ft/ft
 $V_{100} = 7.83$ fps
 $V_h = 0.18$ ft

$Q_{100} = 22.24$ cfs
 $Q_{cap} = 54.80$ cfs
 $s = 0.0011$ ft/ft
 $V = 3.15$ fps
 $V_h = 0.15$ ft

TOTAL FLOW THRU BOTH 36" RCP's
 $Q_{100} = 44.47$ cfs
 $D_{100} = 1.33$ ft.
 $V_{100} = 7.33$ fps

$Q_{ulti} = 115$ cfs
 $D_{ulti} = 2.46$ ft.
 $V_{ulti} = 9.28$ fps

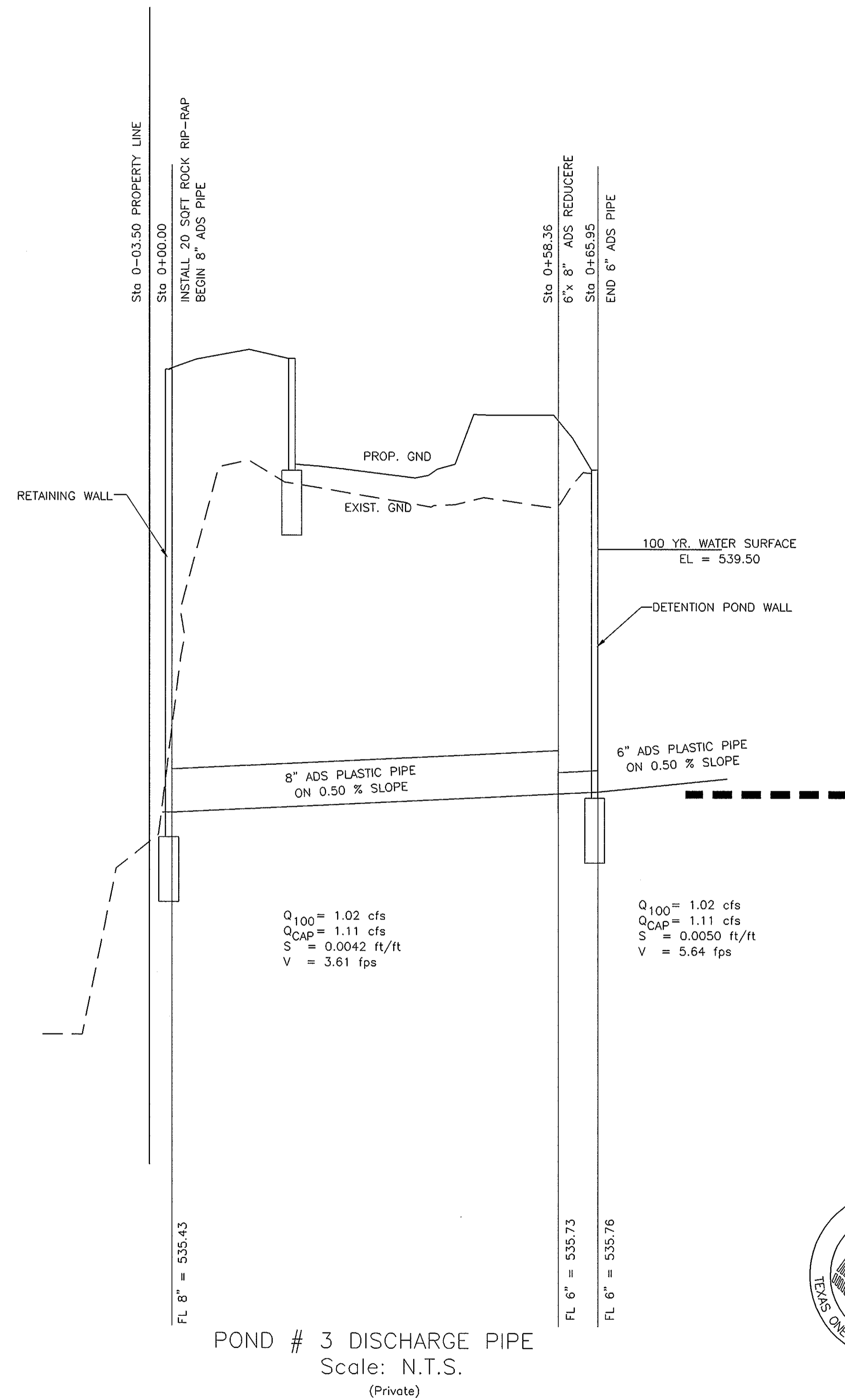

POND # 3 DISCHARGE PIPE
Scale: N.T.S.
(Private)

$Q_{100} = 1.02$ cfs
 $Q_{CAP} = 1.11$ cfs
 $S = 0.0042$ ft/ft
 $V = 3.61$ fps

$Q_{100} = 1.02$ cfs
 $Q_{CAP} = 1.11$ cfs
 $S = 0.0050$ ft/ft
 $V = 5.64$ fps

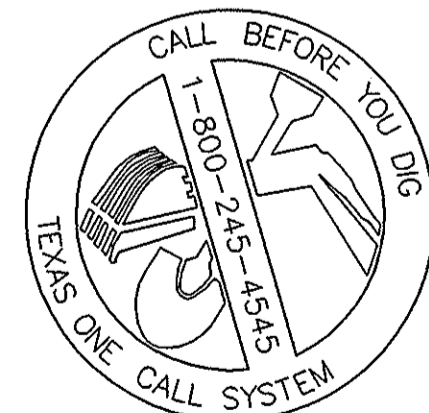

THESE PLANS ARE INSTRUMENTS OF PROFESSIONAL SERVICE AND ARE PROTECTED BY COMMON LAW, STATUTORY AND OTHER RESERVED RIGHTS INCLUDING COPYRIGHT. THEY MAY NOT BE REPRODUCED OR USED FOR ANY PURPOSE WITHOUT THE WRITTEN CONSENT OF THE DIMENSION GROUP

No.	DATE	REVISION / DESCRIPTION	BY	No.	DATE	REVISION / DESCRIPTION	BY

THE DIMENSION GROUP
CIVIL ENGINEERING • LAND DEVELOPMENT • PLANNING • ARCHITECTURE • CONSTRUCTION MANAGEMENT
10755 SANDHILL ROAD, DALLAS, TEXAS 75238 TEL: 214-343-9400 FAX: 214-341-9060

PROJECT INFO.
7-ELEVEN
NE.C. OF N. GOLIAD STREET
& FM 552
ROCKWALL, TEXAS

DRAWING INFO.
AS-BUILT
DRAINAGE CROSS-
SECTIONS

PROJECT No. 06127
DATE: 05/18/07
DRAWN BY: CS
CHECKED BY: RA

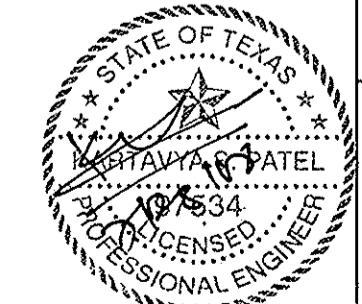

SHEET NUMBER
C4.3