

LINE "B"

SOUTH SIDE OF BOYDSTUN

LINE "C"

NORTH SIDE OF FOREST TRACE

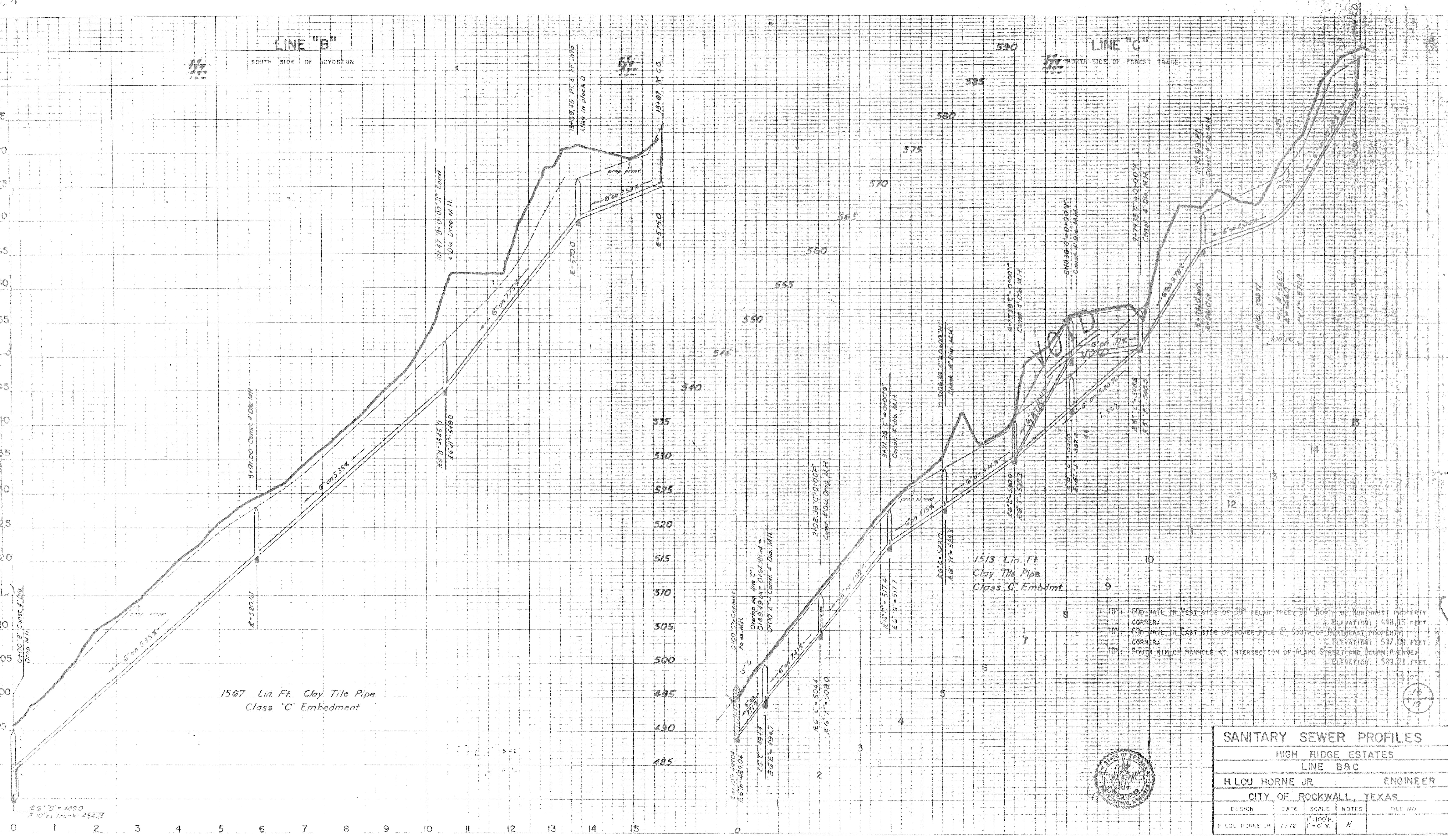

1567 Lin. Ft. Clay Tile Pipe  
Class "C" Embedment

1513 Lin. Ft.  
Clay Tile Pipe  
Class "C" Embedment

- TBM: 600 HAIL IN WEST SIDE OF 30" PECAN TREE, 90' NORTH OF NORTHWEST PROPERTY CORNER. ELEVATION: 488.13 FEET
- TBM: 600 HAIL IN EAST SIDE OF POWER POLE 2', SOUTH OF NORTHEAST PROPERTY CORNER. ELEVATION: 597.09 FEET
- TBM: SOUTH RIM OF MANHOLE AT INTERSECTION OF ALAMO STREET AND BOURN AVENUE. ELEVATION: 589.21 FEET

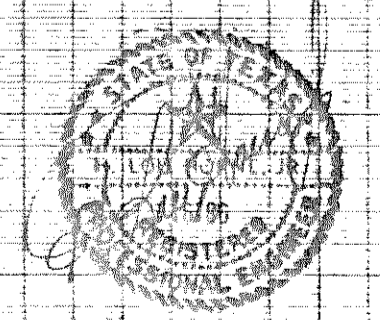

SANITARY SEWER PROFILES				
HIGH RIDGE ESTATES				
LINE B&C				
H LOU HORNE JR.		ENGINEER		
CITY OF ROCKWALL, TEXAS				
DESIGN	DATE	SCALE	NOTES	FILE NO.
H LOU HORNE JR	7/72	1"=100'H 1"=6' V	#	

1B

1B

11  
5'4