

0+00 1+00 2+00 3+00 4+00 5+00 6+00 7+00 8+00 9+00 10+00 11+00 570

550 545 540 535 530 525

575 570 565 560 555

11+00 12+00 13+00 14+00 15+00

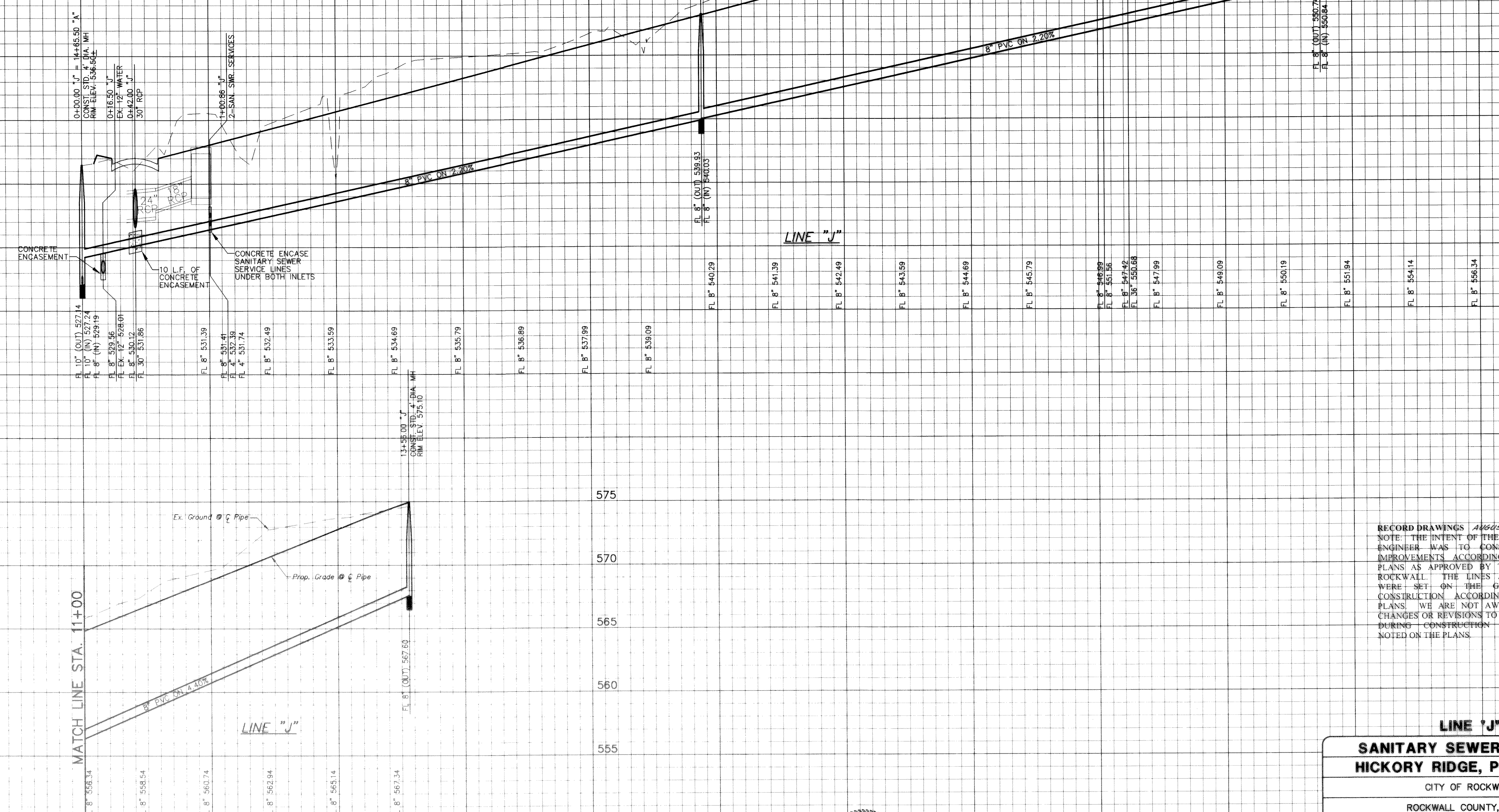

0+00.00 "J" = 14+65.50 "A"
CONST. STD. 4" DIA. MH
RIM ELEV. 536.50±

0+16.50 "J"
EX. 12" WATER
0+42.00 "J"
30" ROP

FL 10" (OUT) 527.14
FL 10" (IN) 527.74
FL 8" (IN) 529.19
FL 8" 529.56
FL EX-12" 528.01
FL 8" 530.12
FL 30" 531.86

FL 8" 531.39
FL 8" 531.41
FL 4" 532.39
FL 4" 531.74
FL 8" 532.49

FL 8" 533.59

FL 8" 534.69

FL 8" 535.79
FL 8" 536.89
FL 8" 537.99
FL 8" 539.09

FL 8" 540.29
FL 8" 541.39
FL 8" 542.49
FL 8" 543.59
FL 8" 544.69
FL 8" 545.79

FL 8" 546.89
FL 8" 551.56
FL 8" 547.42
FL 36" 550.68
FL 8" 547.99

FL 8" 549.09
FL 8" 550.19
FL 8" 551.94
FL 8" 554.14
FL 8" 556.34

11+00.86 "J"
2" SANIT. S.W.P. SERVICES

11+45.00 "J"
CONST. STD. 4" DIA. MH
RIM ELEV. 575.10

FL 8" (OUT) 567.60

FL 8" 567.34
FL 8" 558.54
FL 8" 560.74
FL 8" 562.94
FL 8" 565.14

FL 8" 567.34

FL 8" 567.60

FL 8" 567.60

FL 8" 567.60

FL 8" 567.60

FL 8" 567.60

BENCHMARK:
SQUARE CUT ON TOP OF HEADWALL AT THE MOST NORTHERLY
CORNER OF BRIDGE. NORTHEASTERLY SIDE OF FM 205.
1680± NORTHWEST OF CL OF MIMS ROAD.
ELEV = 529.11

BENCHMARK:
CITY OF ROCKWALL, TEXAS CONTROL MONUMENT #929. TOP OF
HEADWALL IN NORTHWEST CORNER OF BRIDGE OVER SQUABBLE
CREEK, SOUTHWESTERLY SIDE OF FM 205.
ELEV = 524.55

THESE CONSTRUCTION PLANS WERE
PREPARED UNDER THE RESPONSIBLE
SUPERVISION OF DAN M. DOWDEY
REGISTERED PROFESSIONAL ENGINEER,
No. 21433

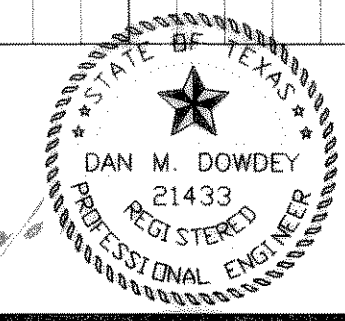

THE SEAL APPEARING ON THIS
DOCUMENT WAS AUTHORIZED BY
DAN M. DOWDEY P.E. # 21433

| NO. | DATE | BY | REVISION |
|-----|------|----|----------|
| | | | |
| | | | |
| | | | |

RECORD DRAWINGS AUGUST 19, 2002
NOTE: THE INTENT OF THE OWNER AND
ENGINEER WAS TO CONSTRUCT THE
IMPROVEMENTS ACCORDING TO THESE
PLANS AS APPROVED BY THE CITY OF
ROCKWALL. THE LINES AND GRADES
WERE SET ON THE GROUND FOR
CONSTRUCTION ACCORDING TO SAID
PLANS. WE ARE NOT AWARE OF ANY
CHANGES OR REVISIONS TO THESE PLANS
DURING CONSTRUCTION EXCEPT AS
NOTED ON THE PLANS.

LINE 'J'

**SANITARY SEWER PROFILES
HICKORY RIDGE, PHASE TWO**

CITY OF ROCKWALL
ROCKWALL COUNTY, TEXAS

DOWDEY, ANDERSON & ASSOCIATES, INC.
5225 VILLAGE CREEK DRIVE (972) 931-0694 PLANO, TEXAS

| DESIGN | DRAWN | CHECKED | DATE | SCALE | JOB | SHEET |
|--------|-------|---------|-----------|---------------------|--------|-------|
| RR | RR | DMD | MAR. 2001 | 1" = 40' 1" = 4' | 99-066 | 3 / 4 |