

TxDOT BARRICADE & CONSTRUCTION STDS. SECTION BC (3) -94

TYPE III

The three (3) rails on Type III barricades shall be reflective red and reflective white stripes on one side facing one-way traffic and both sides for two-way traffic.

4'-0" min. 12'-0" usual, maximum is variable

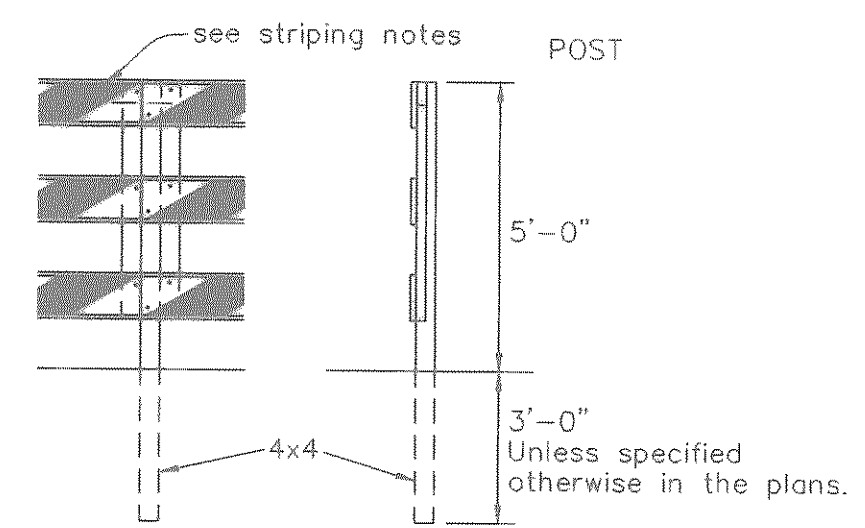
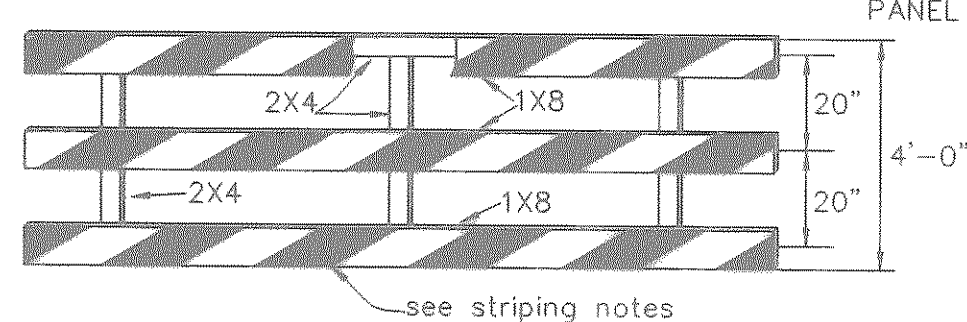

STRIPING TYPICAL DETAIL FOR BARRICADE RAIL

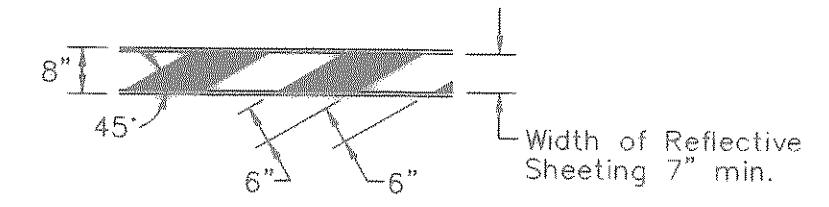

0+39.50 TEMPORARY ASPHALT ROAD END CONCRETE STREET AND BEGIN ASPHALT ROAD

45 L.F. FUTURE CURB TO BE CONSTRUCTED WHEN ASPHALT ROAD IS REMOVED DUE TO FUTURE DEVELOPMENT ON EAST SIDE OF PROJECT.

0+33.30~AR (24.2' RT) EL=572.90
0+50.00~AR

1+48.53~PC
1+24.99~AR

FUTURE STREET R.O.W.

1+68.79~AR
1+62.34~AR

1+18.53~AR
1+68.79~PT

INSTALL: 5-TYPE III BARRICADES AT MAXIMUM WIDTH. SEE DETAIL THIS SHEET.

LOST CREEK COURT

ALLEY "H"

0+33.30~AR (24.2' LF) EL=572.74
0+50.16~AR

24' ASPHALT PAVEMENT

EXIST. 50' LONE STAR GAS EASEMENT

EX. 24" GAS LINE

TRAIL VIEW DRIVE

4+79.99~AR
4+23.23~AR

4+79.99~PT
4+74.35~AR

4+29.73~PC
4+40.56~AR

4+79.99~PT
4+74.35~AR

4+29.73~PC
4+40.56~AR

4+79.99~PT
4+74.35~AR

4+29.73~PC
4+40.56~AR

4+79.99~PT
4+74.35~AR

4+29.73~PC
4+40.56~AR

4+79.99~PT
4+74.35~AR

4+29.73~PC
4+40.56~AR

4+79.99~PT
4+74.35~AR

4+29.73~PC
4+40.56~AR

4+79.99~PT
4+74.35~AR

4+29.73~PC
4+40.56~AR

24' ASPHALT PAVEMENT

EXIST. 50' LONE STAR GAS EASEMENT

EX. 24" GAS LINE

TRAIL VIEW DRIVE

4+79.99~AR
4+23.23~AR

4+79.99~PT
4+74.35~AR

4+29.73~PC
4+40.56~AR

4+79.99~PT
4+74.35~AR

4+29.73~PC
4+40.56~AR

4+79.99~PT
4+74.35~AR

4+29.73~PC
4+40.56~AR

4+79.99~PT
4+74.35~AR

4+29.73~PC
4+40.56~AR

4+79.99~PT
4+74.35~AR

4+29.73~PC
4+40.56~AR

4+79.99~PT
4+74.35~AR

4+29.73~PC
4+40.56~AR

4+79.99~PT
4+74.35~AR

4+29.73~PC
4+40.56~AR

4+79.99~PT
4+74.35~AR

4+29.73~PC
4+40.56~AR

4+79.99~PT
4+74.35~AR

24' ASPHALT PAVEMENT

EXIST. 50' LONE STAR GAS EASEMENT

EX. 24" GAS LINE

TRAIL VIEW DRIVE

4+79.99~AR
4+23.23~AR

4+79.99~PT
4+74.35~AR

4+29.73~PC
4+40.56~AR

4+79.99~PT
4+74.35~AR

4+29.73~PC
4+40.56~AR

4+79.99~PT
4+74.35~AR

4+29.73~PC
4+40.56~AR

4+79.99~PT
4+74.35~AR

4+29.73~PC
4+40.56~AR

4+79.99~PT
4+74.35~AR

4+29.73~PC
4+40.56~AR

4+79.99~PT
4+74.35~AR

4+29.73~PC
4+40.56~AR

4+79.99~PT
4+74.35~AR

4+29.73~PC
4+40.56~AR

4+79.99~PT
4+74.35~AR

4+29.73~PC
4+40.56~AR

4+79.99~PT
4+74.35~AR

CAUTION!
EXISTING GAS LINE IN THIS AREA. CONTRACTOR TO CALL TXU PIPELINE SERVICES AT 972-679-7219 AT LEAST 72 HOURS PRIOR TO CONSTRUCTION TO VERIFY LOCATION & ELEVATION.

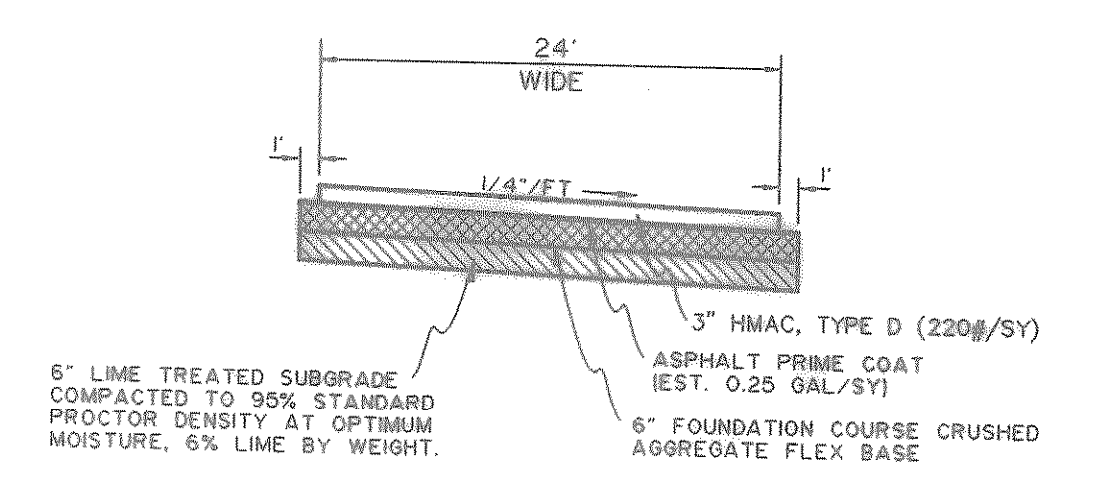

TEMPORARY ASPHALT ROAD SECTION NTS

TAP=TOP ASPHALT PAVEMENT
AR=ASPHALT RETURN

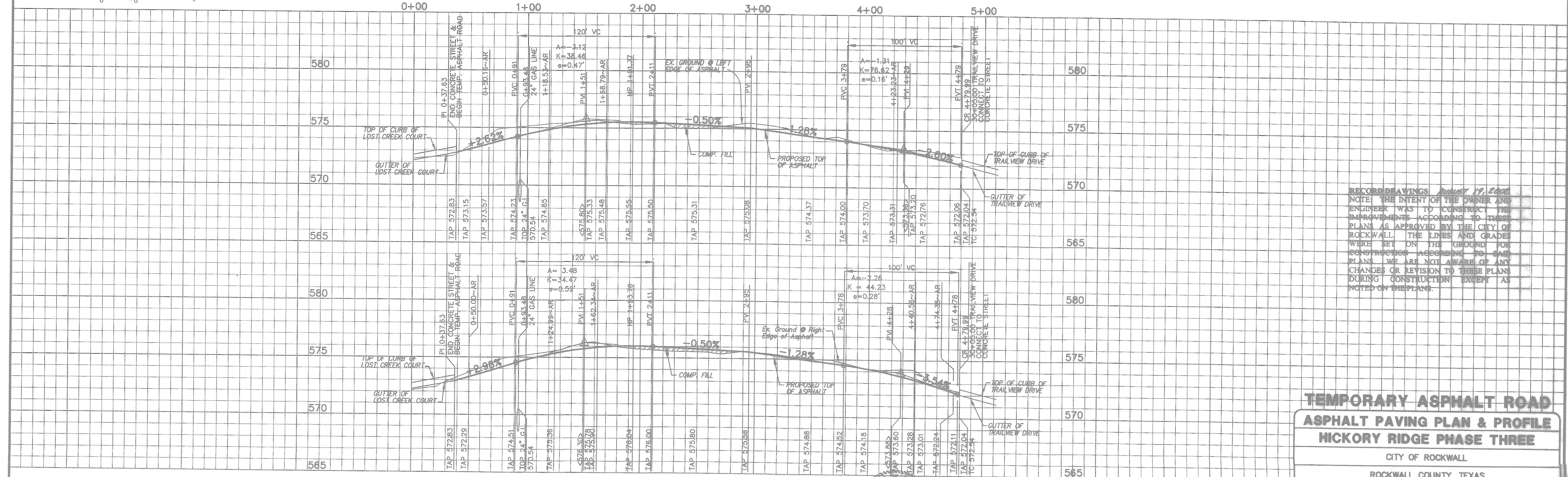

RECORD DRAWINGS August 19, 2000
NOTE: THE INTENT OF THE OWNER AND ENGINEER WAS TO CONSTRUCT THE IMPROVEMENTS ACCORDING TO THESE PLANS AS APPROVED BY THE CITY OF ROCKWALL. THE LINES AND GRADES WERE SET ON THE GROUND FOR CONSTRUCTION ACCORDING TO SAID PLANS. WE ARE NOT AWARE OF ANY CHANGES OR REVISION TO THESE PLANS DURING CONSTRUCTION EXCEPT AS NOTED ON THE PLANS.

TEMPORARY ASPHALT ROAD ASPHALT PAVING PLAN & PROFILE HICKORY RIDGE PHASE THREE

CITY OF ROCKWALL
ROCKWALL COUNTY, TEXAS

DOWDEY, ANDERSON & ASSOCIATES, INC.
5225 VILLAGE CREEK DR., STE. 200 (972) 931-0894 PLANO, TEXAS

DESIGN	DRAWN	CHECKED	DATE	SCALE	JOB	SHEET
JDS	JDS	DD	MAR 2001	H: 1"=40' V: 1"=4'	99-066	6

BENCHMARK:
SQUARE CUT ON TOP OF HEADWALL AT THE MOST NORTHERLY CORNER OF BRIDGE. NORTHEASTERLY SIDE OF FM 205. 1680± NORTHWEST OF CL OF MIMS ROAD. ELEV = 529.11

BENCHMARK:
CITY OF ROCKWALL, TEXAS CONTROL MONUMENT #929. TOP OF HEADWALL IN NORTHWEST CORNER OF BRIDGE OVER SQUABBLE CREEK. SOUTHWESTERLY SIDE OF FM 205. ELEV = 524.55

THESE CONSTRUCTION PLANS WERE PREPARED UNDER THE RESPONSIBLE SUPERVISION OF DAN M. DOWDEY REGISTERED PROFESSIONAL ENGINEER No. 21433

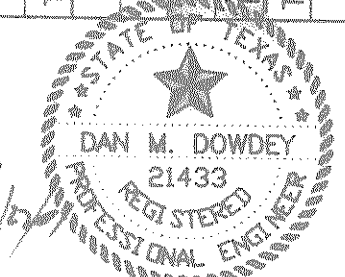

THE SEAL APPEARING ON THIS DOCUMENT WAS AUTHORIZED BY DAN M. DOWDEY P.E. # 21433

NO.	DATE	BY	REVISION