

BENCHMARK: SQUARE CUT ON TOP OF HEADWALL AT THE MOST NORTHERLY CORNER OF BRIDGE, NORTHEASTERNLY SIDE OF FM 205. 1680' NORTHWEST OF CL OF MIMS ROAD. HEADWALL IN NORTHWESTERLY SIDE OF FM 205. CREEK, SOUTHWESTERLY SIDE OF FM 205. ELEV = 529.11

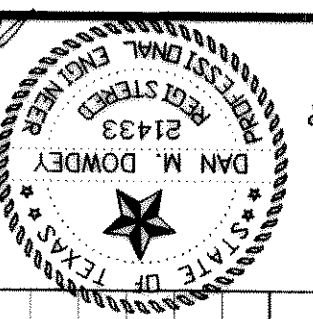

THESE CONSTRUCTION PLANS WERE PREPARED UNDER THE RESPONSIBLE SUPERVISION OF DAN M. DOWDEY, REGISTERED PROFESSIONAL ENGINEER, NO. 21433.

THE SEAL APPEARING ON THIS DOCUMENT WAS AUTHORIZED BY DAN M. DOWDEY, P.E. # 21433.

DESIGN	JDS	JDS	MSD	OCT 2002	H: 1"=40'	V: 1"=4'	99-066	19
CHECKED	JDS	JDS	MSD	OCT 2002	SCALE	DATE	JOB	SHEET
DOWDEY, ANDERSON & ASSOCIATES, INC. ROCKWALL COUNTY, TEXAS CITY OF ROCKWALL HICKORY RIDGE PHASE FOUR PAVING PLAN & PROFILE ALLEY "O" & ALLEY "P"								

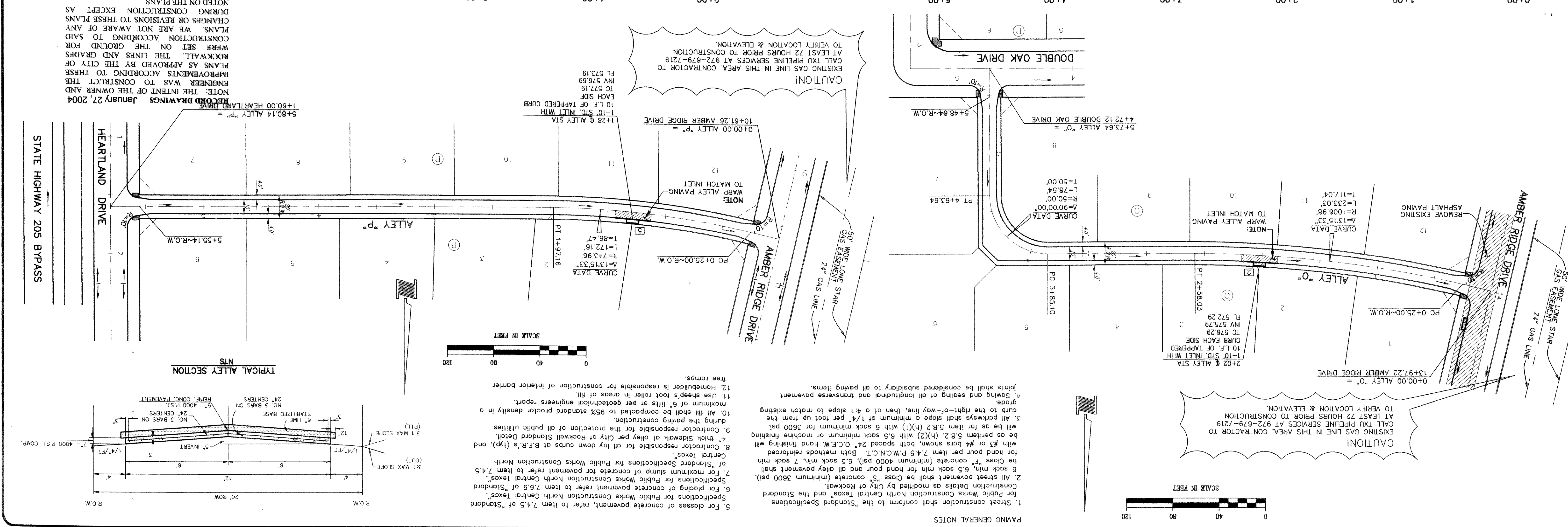
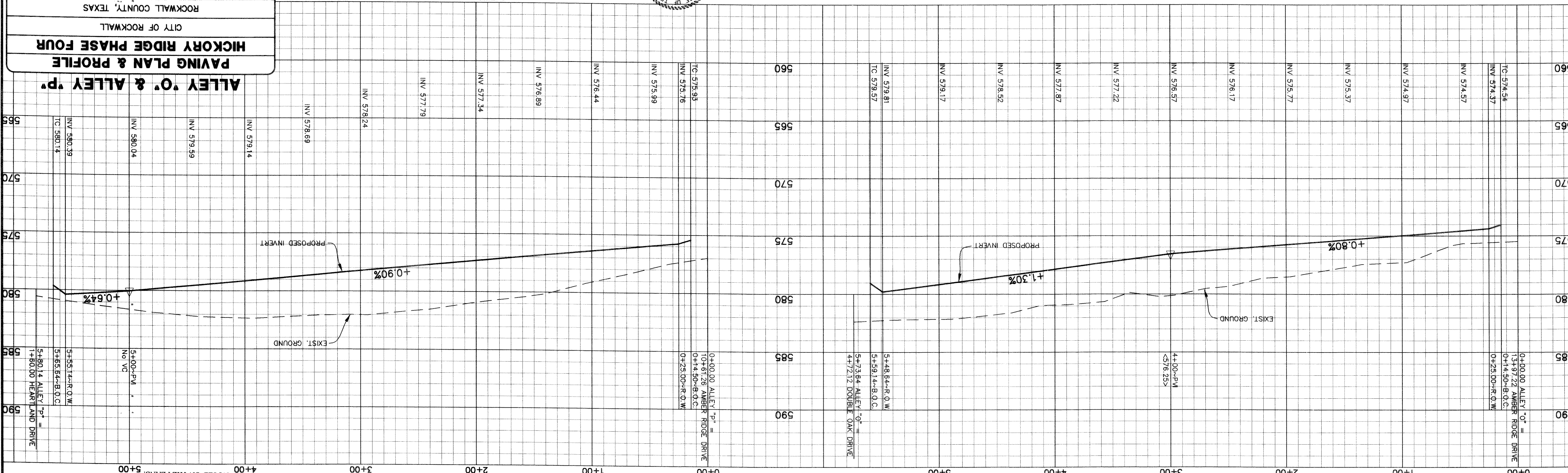

- PAVING GENERAL NOTES
- Street construction shall conform to the "Standard Specifications for Public Works Construction North Central Texas" and the Standard Construction Details as modified by City of Rockwall.
  - All street pavement shall be Class "S" concrete (minimum 3600 psi). 6 sack min, 6.5 sack min for hand pour and all alley pavement shall be Class "F" concrete (minimum 4000 psi), 6.5 sack min, 7 sack min for hand pour per item 7.4.5 P.W.C.N.C.T. Both methods reinforced with #3 or #4 bars shown, both spaced 24" O.C.E.W. hand finishing will be as per item 5.8.2 (h)(2) with 6.5 sack minimum or machine finishing will be as per item 5.8.2 (h)(1) with 6 sack minimum for 3600 psi.
  - All portways shall slope a minimum of 1/4" per foot up from the curb to the right-of-way line, then at a 1:1 slope to match existing grade.
  - Sowing and sealing of all longitudinal and transverse pavement joints shall be considered subsidiary to all paving items.

- For classes of concrete pavement, refer to item 7.4.5 of "Standard Specifications for Public Works Construction North Central Texas".
- For picking of concrete pavement refer to item 7.6.9 of "Standard Specifications for Public Works Construction North Central Texas".
- For maximum slump of concrete for pavement refer to item 7.4.5 of "Standard Specifications for Public Works Construction North Central Texas".
- Contractor responsible for all lay down curbs at B.F.R.'s (typ), and 4" thick sidewalk at alley per City of Rockwall Standard Detail.
- Contractor responsible for the protection of all public utilities during the paving construction.
- All fill shall be compacted to 95% standard proctor density in a maximum of 6" lifts or per geotechnical engineers report.
- Use sheep's foot roller in areas of fill.
- Homebuilder is responsible for construction of interior barrier free ramps.

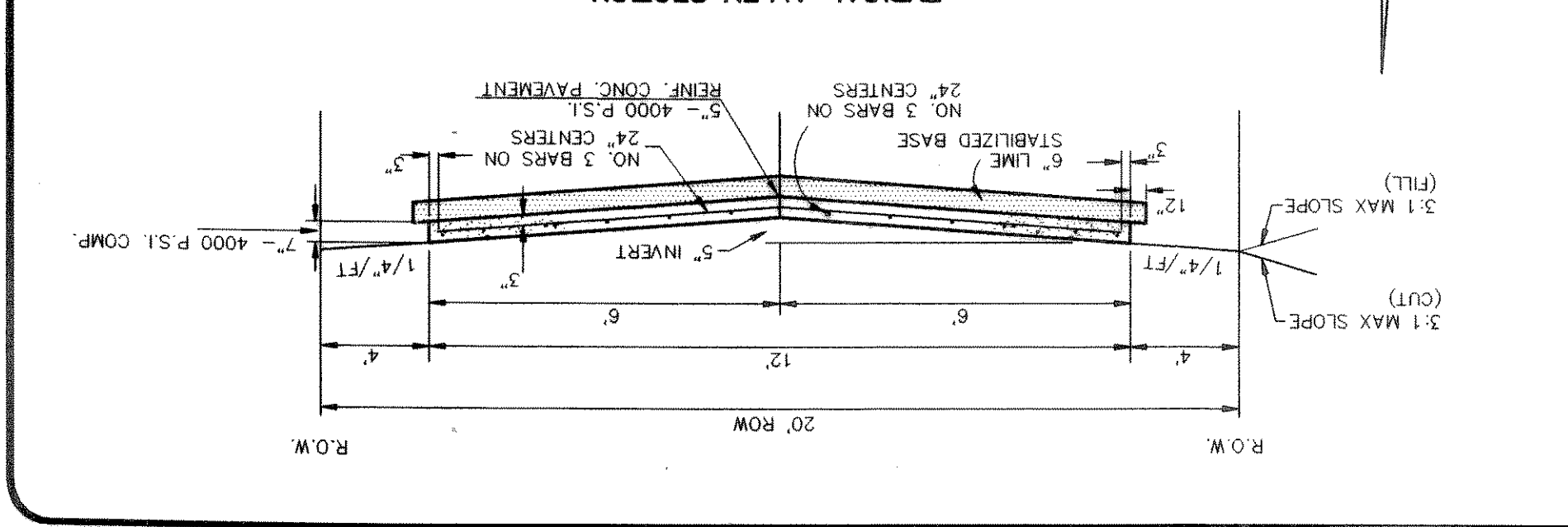

NOTE: THE INTENT OF THE OWNER AND ENGINEER WAS TO CONSTRUCT THESE IMPROVEMENTS ACCORDING TO THESE PLANS AS APPROVED BY THE CITY OF ROCKWALL. THE LINES AND GRADES WERE SET ON THE GROUND FOR CONSTRUCTION ACCORDING TO SAID PLANS. WE ARE NOT AWARE OF ANY CHANGES OR REVISIONS TO THESE PLANS DURING CONSTRUCTION EXCEPT AS NOTED ON THE PLANS.

RECORD DRAWINGS January 27, 2004