

CURVE DATA
 $\Delta = 70^{\circ}39'56''$
 $R = 275.00'$
 $T = 194.95'$
 $L = 339.17'$

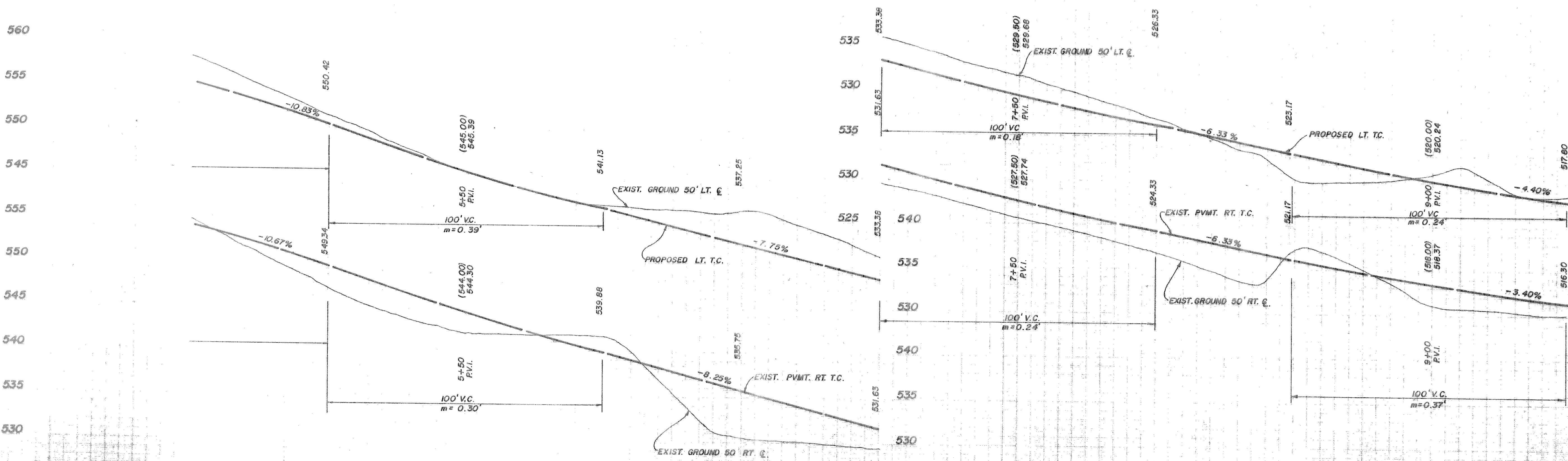
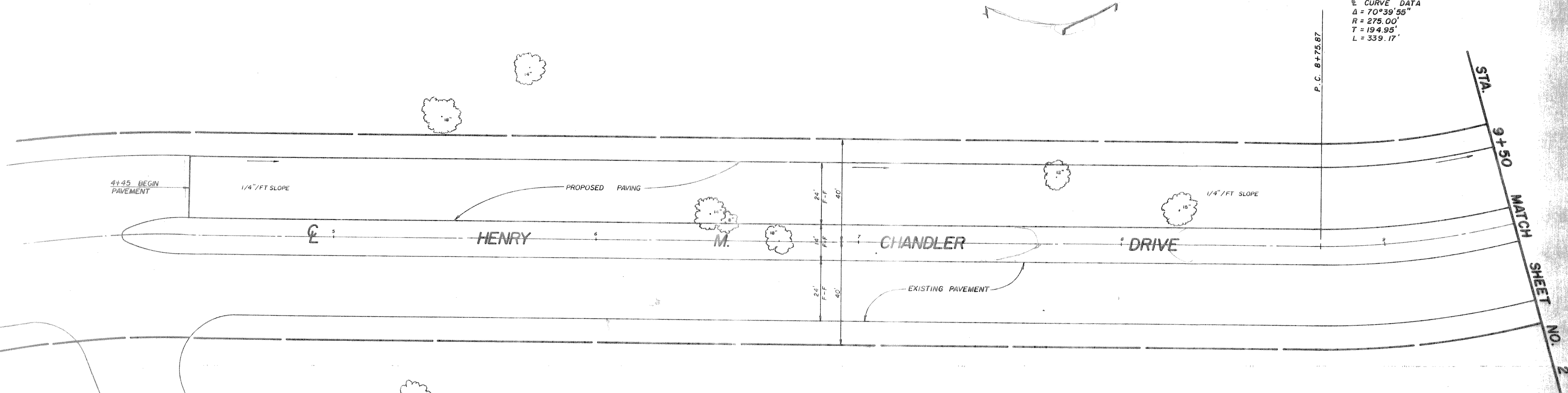

CHANDLERS LANDING						
PROPOSED PAVING						
HENRY M. CHANDLER DRIVE						
ROCKWALL, TEXAS						
HAROLD L. EVANS & CONSULTING ENGINEER						
DESIGN	DRAWN	DATE	SCALE	NOTES	FILE	NO.
N.L.E.		7/81	1"=20'H. 1"=6'V.			72122