

CURVE DATA
 A = 70°39'55"
 R = 275.00'
 T = 194.95'
 L = 339.17'

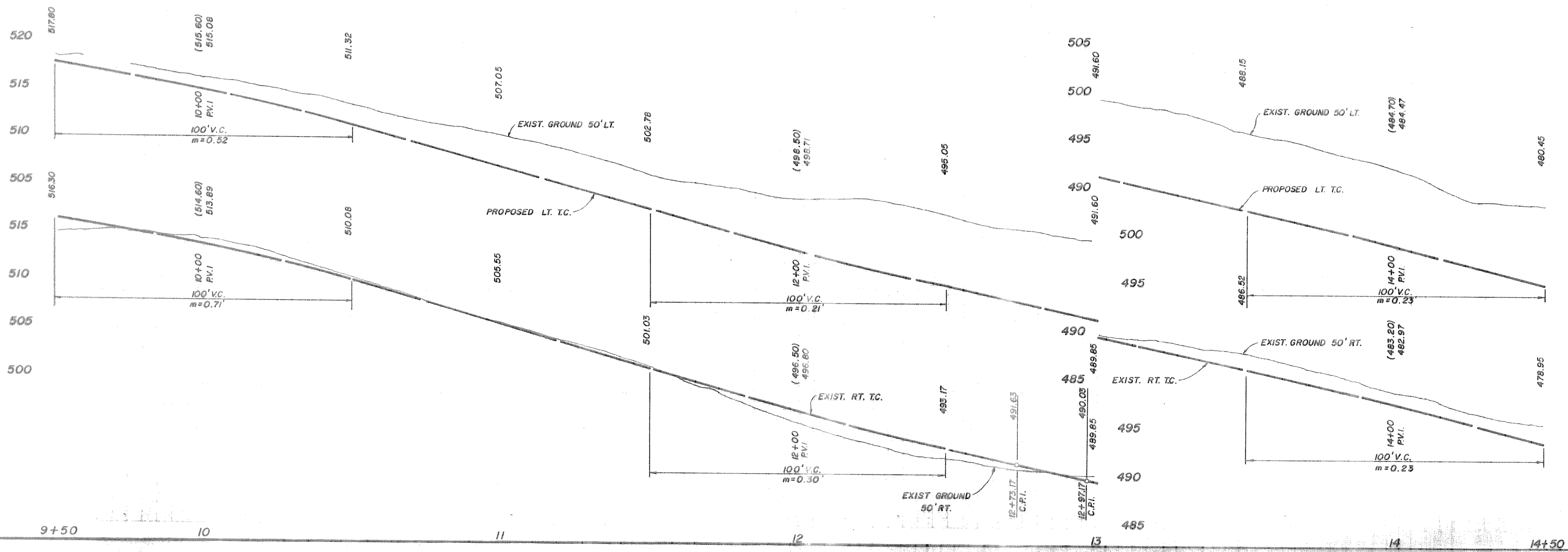
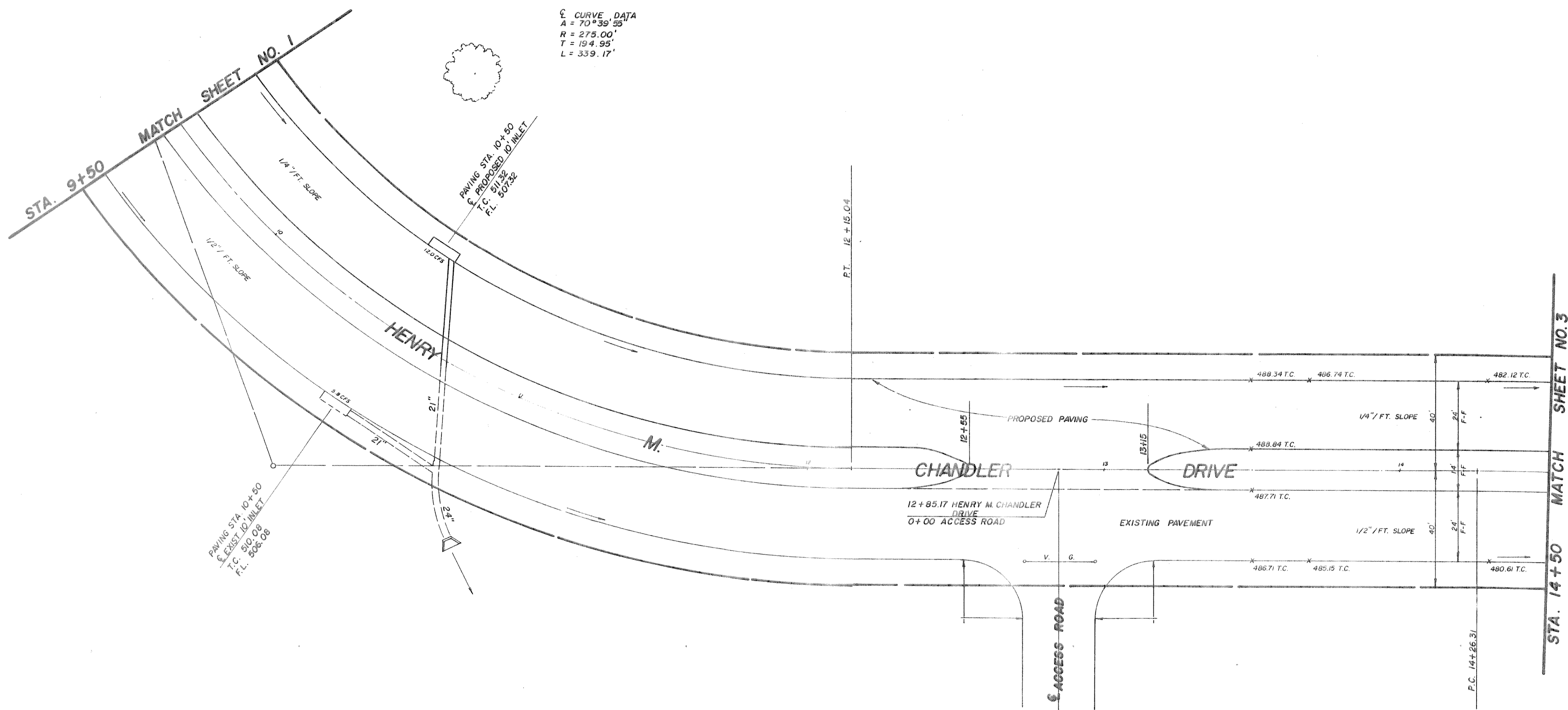

CURVE DATA
 A = 24°11'13"
 R = 1000.00'
 T = 214.26'
 L = 422.14'

CHANDLERS LANDING						
PROPOSED PAVING						
HENRY M. CHANDLER DRIVE						
ROCKWALL, TEXAS						
HAROLD L. EVANS, CONSULTING ENGINEER						
DESIGN	DRAWN	DATE	SCALE	NOTES	FILE	NO.
H.L.E.		7-81	1" = 20'H 1" = 6'V			72122