

# THE HARBOR - ROCKWALL

HILTON HOTEL

CITY OF ROCKWALL, ROCKWALL COUNTY, TEXAS

INDEX

ITEM	SHEET
CONCRETE REMOVAL.....	1
DIMENSION CONTROL.....	2
GRADING AND PAVING.....	3
UTILITIES & DRAINAGE...	4-5

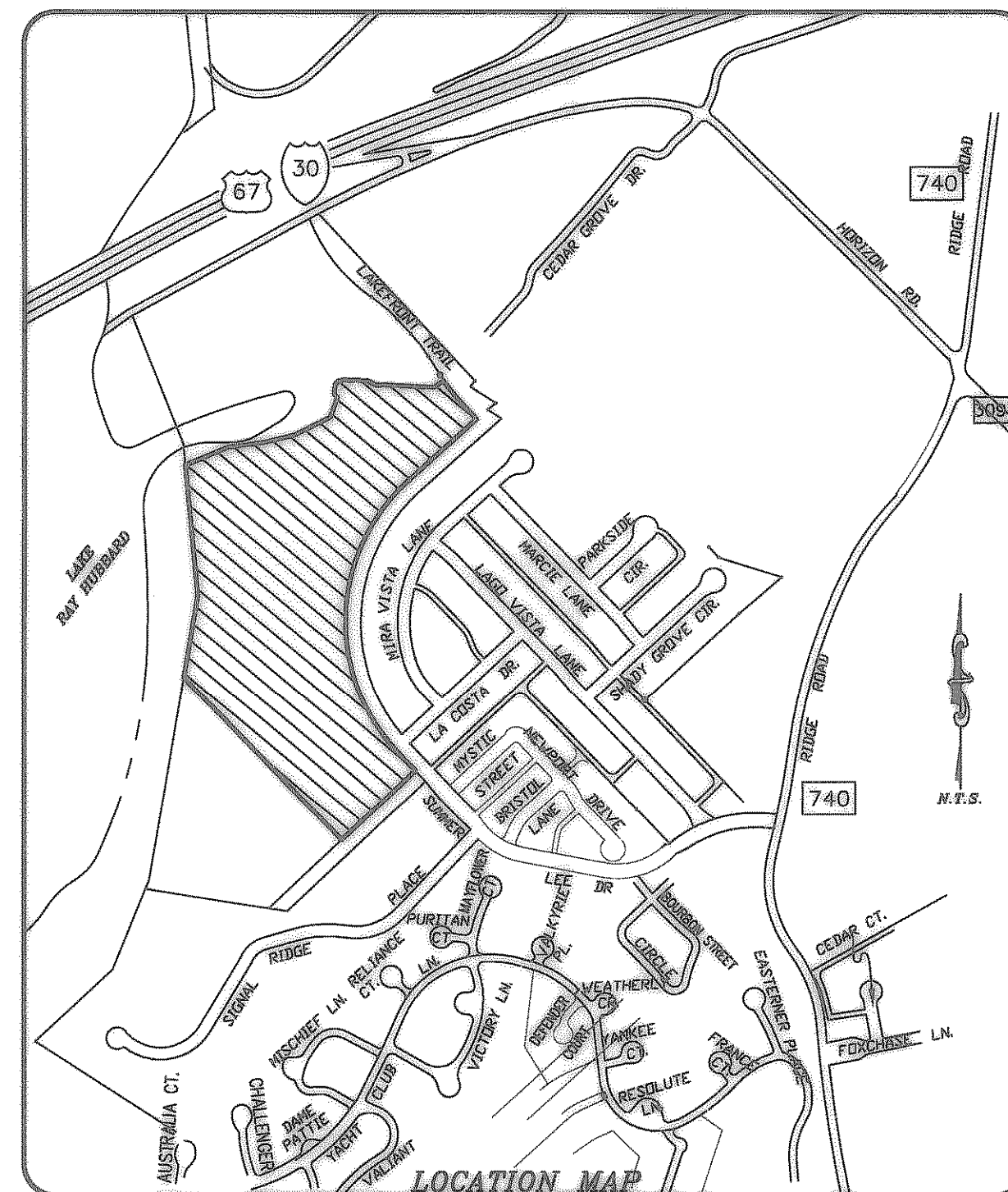
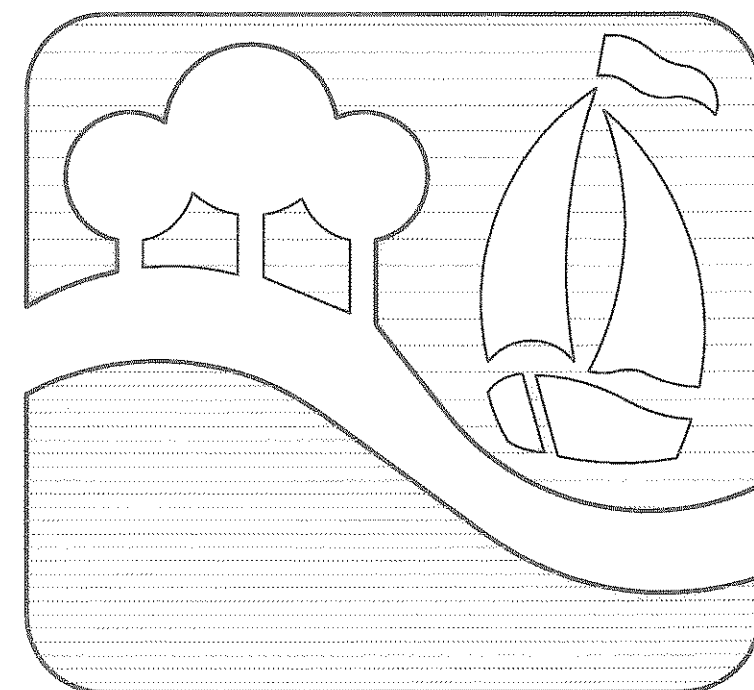

GENERAL NOTES

- EXCAVATED MATERIAL SHALL BE PLACED AS DIRECTED BY THE OWNER.
- ALL FILL AREAS IN STREET RIGHT - OF - WAYS TO BE DENSITY CONTROLLED AND COMPACTED TO 95% DENSITY AT OPTIMUM MOISTURE CONTENT. FILL SHALL BE COMPACTED WITH A SHEEPS FOOT ROLLER.
- NO TREES SHALL BE CUT EXCEPT ON THE SPECIFIC AUTHORITY OF THE CITY.
- CONSTRUCTION SHALL MEET THE REQUIREMENTS OF THE LATEST REVISION OF THE "STANDARD SPECIFICATIONS FOR CONSTRUCTION", CITY OF ROCKWALL.
- PAVEMENT THICKNESS SHALL BE AS FOLLOWS:
 

RESIDENTIAL STREETS	= 6" THICK, 3600 P.S.I. CONCRETE
MINOR COLLECTOR STREET	= 6" THICK, 3600 P.S.I. CONCRETE
MAJOR COLLECTOR & ARTERIAL STREETS	= 8" THICK, 3600 P.S.I. CONCRETE
- IT SHALL BE THE RESPONSIBILITY OF THE CONTRACTOR TO LOCATE AND VERIFY ALL EXISTING UTILITIES PRIOR TO THE BEGINNING OF CONSTRUCTION TO INSURE NO CONFLICT BETWEEN ALL UTILITY LINES.
- WHERE WATER PIPELINES EITHER CROSS OR OTHERWISE COME WITHIN 9 FEET OF A SANITARY SEWER PIPELINE THE SEWER PIPELINE SHALL BE CONCRETE ENCASED.
- ALL WATER SERVICES TO BE 1" INSTALLED TO THE CENTER OF EACH LOT WITH SEWER LATERALS 10' DOWNSTREAM. WATER SERVICES SHALL BE PE 200 PSI SDR 9 WITH METAL INSERTS.
- CONDUITS FOR S. W. BELL AND NORTH TEXAS CABLE COMM T.V. SHALL HAVE 30" OF COVER AND SHALL EXTEND 2 FEET BEYOND FUTURE PAVING.
- ALL FITTINGS SHALL BE BRASS COMPRESSION.
- RESILIENT SEATED GATE VALVES ONLY WILL BE ALLOWED.
- BLUE MARKER E. M. S. #1252 SHALL BE PLACED UNDER EACH CORPORATION STOP AND AT ALL TEES, VALVES, AND CHANGE IN DIRECTIONS.
- GREEN MARKER E. M. S. #1253 SHALL BE PLACED UNDER EACH SEWER SERVICE AND AT EACH MANHOLE AT A DEPTH NOT TO EXCEED 5 FEET.
- WATER LINES TO BE CLASS 200 PVC DR 14.

T.U. ELECTRIC COMPANY GENERAL NOTES

- CONTRACTOR TO INSTALL ALL CONDUIT AS SHOWN ON PRINT.
- T.U. ELECTRIC COMPANY TO FURNISH CONDUIT AND CABLE MARKERS.
- DEVELOPER TO INSTALL 1 ( ONE ) CABLER MARKER AT EACH END OF CONDUIT.
- EACH CONDUIT MUST BE BURIED A MINIMUM OF 40" DEEP ( AFTER LAND IS BROUGHT TO FINAL GRADE AND EXTEND 2 FEET BEYOND FUTURE PAVING ) .
- EACH CONDUIT MUST BE INSPECTED BY THE DISTRIBUTION DEPARTMENT BEFORE BACKFILLING IN TRENCH. ROBERT GAYLOR 487-2351.
- EACH CONDUIT MUST HAVE A PULL WIRE INSTALLED AND BE CAPPED AT BOTH ENDS.
- TRENCHES WITHIN CITY STREETS SHALL BE COMPACTED TO 95% DENSITY.



**RECORD DRAWINGS**  
 Received from Engineer  
 8/15/08

**SOLID STRUCTURAL SOLUTIONS, INC.**

**OWNER :**  
**ROBERT S. AND SARAH WHITTLE**  
 P.O. BOX 369  
 ROCKWALL, TEXAS 75087  
 972-772-5253

**P.O. BOX 851830**  
**MESQUITE, TX 75185-1830**  
 214-417-6520  
 FAX: 972-288-5714