

TREES TO BE REMOVED

T 1	12' COTTONWOOD	T 41	16' ELM	T 57	10' WILLOW
T 2	14' WILLOW	T 42	9' HACKBERRY	T 58	16' COTTONWOOD
T 3	36' PECAN	T 43	10' ELM	T 59	14' COTTONWOOD
T 4	18' DOUBLE PECAN/ELM	T 44	14' ELM	T 60	10' COTTONWOOD
T 5	36' ELM	T 45	10' HACKBERRY	T 61	18' WILLOW
T 6	48' PECAN	T 46	10' HACKBERRY	T 62	14' COTTONWOOD
T 26	12' CEDAR	T 47	9' CEDAR	T 63	14' CEDAR
T 28	12' HACKBERRY/ 4 TRUNKS	T 48	14' HACKBERRY	T 64	14' COTTONWOOD
T 29	18' ELM	T 49	24' ELM	T 65	16' COTTONWOOD
T 30	14' HACKBERRY	T 50	14' PECAN	T 66	9' WILLOW
T 31	14' ELM	T 51	9' HACKBERRY	T 67	14' COTTONWOOD
T 33	9' CEDAR	T 52	9' HACKBERRY	T 68	10' COTTONWOOD
T 32	12' ELM	T 54	12' CEDAR	T 69	9' COTTONWOOD
T 38	9' HACKBERRY	T 55	9' BOIS D' ARC	T 74	10' COTTONWOOD
T 39	14' ELM			T 75	10' WILLOW
				T 76	24' DOUBLE WILLOW
				T 77	18' ELM

TREES TO BE SAVED

T 7	24' CEDAR	T 21	10' ELM
T 8	12' CEDAR	T 22	12' ELM
T 9	9' CEDAR	T 23	12' ELM
T 10	10' ELM	T 24	9' ELM
T 11	14' ELM	T 25	9' ELM
T 12	14' DOUBLE ELM	T 34	24' PECAN
T 13	12' ELM	T 35	9' CEDAR
T 14	9' CEDAR	T 36	9' ELM
T 15	24' HACKBERRY	T 56	9' DOUBLE HACKBERRY
T 16	12' ELM	T 70	9' COTTONWOOD
T 18	9' ELM	T 71	36' HACKBERRY
T 19	24' DOUBLE PECAN	T 72	10' DOUBLE WILLOW
T 20	10' ELM	T 73	12' LIVE OAK

TREES TO BE TRANSPLANTED

T 17	9' TRIPLE TRUNK ELM
T 27	9' PECAN
T 37	9' ELM
T 40	9' ELM
T 63	9' ELM

RETAINING WALL DETAIL

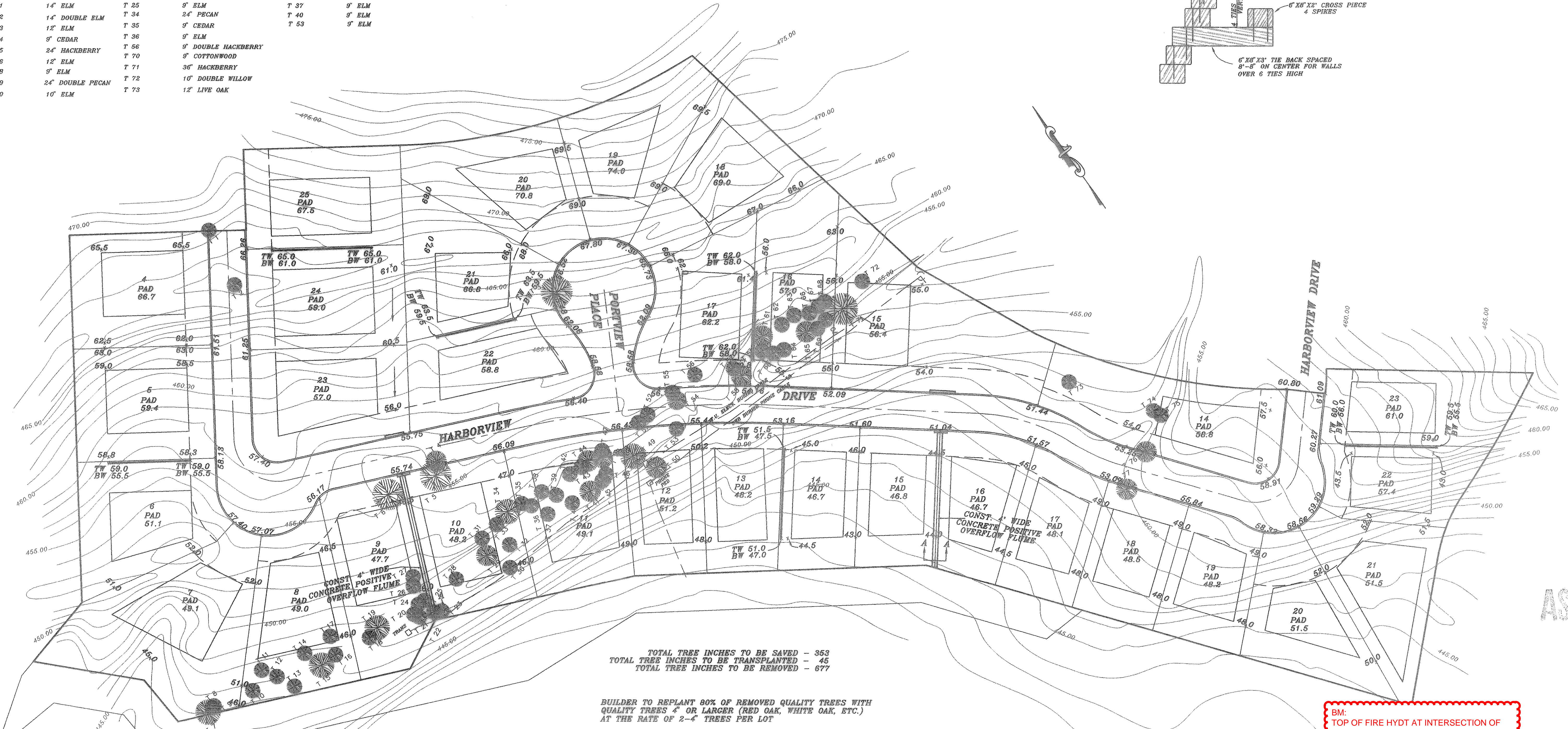
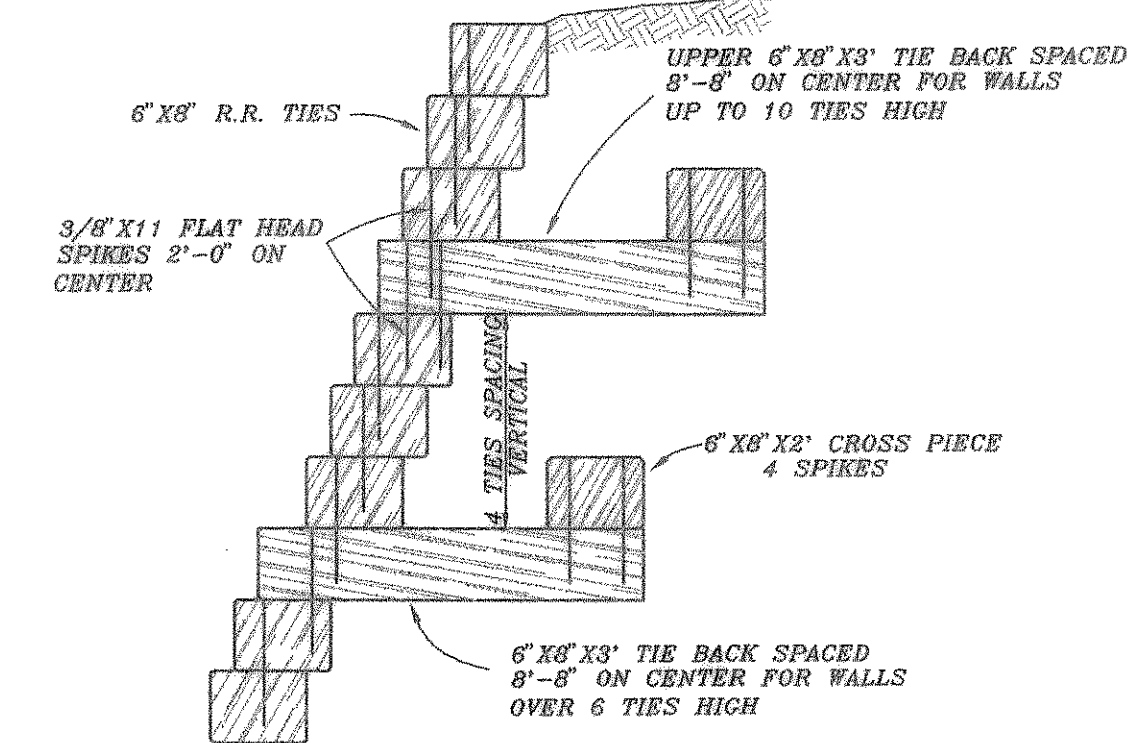

TOTAL TREE INCHES TO BE SAVED - 363
 TOTAL TREE INCHES TO BE TRANSPLANTED - 45
 TOTAL TREE INCHES TO BE REMOVED - 677

BUILDER TO REPLANT 80% OF REMOVED QUALITY TREES WITH QUALITY TREES 4" OR LARGER (RED OAK, WHITE OAK, ETC.) AT THE RATE OF 2-4 TREES PER LOT

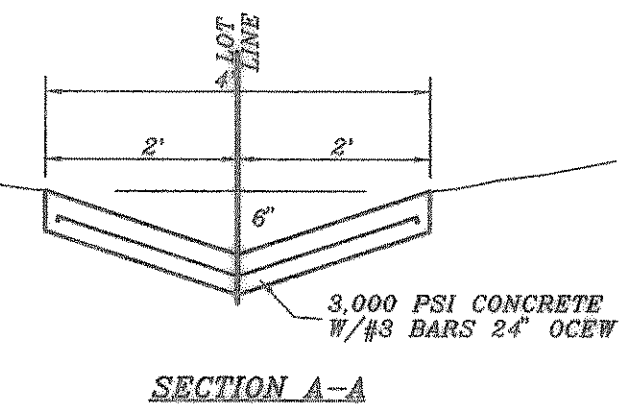

BM:
 TOP OF FIRE HYDT AT INTERSECTION OF
 YACHT CLUB DR. & HARBOR LANDING DR.
 ELEV. = 514.57



HAROLD L. EVANS CONSULTING ENGINEER P.O. BOX 28955 2331 GUS THOMASSON ROAD, SUITE 102 DALLAS, TEXAS 75228, (214) 328-9133		LOT GRADING PLAN & TREE SURVEY HARBOR LANDING PHASE TWO CITY OF ROCKWALL		SHEET NO. 9 10 JOB NO. 9873
REVISION DESCRIPTION REVISED PAD ELEVATIONS GRADING REV. REV. PER CITY REVIEW REV. PER CITY REVIEW	DATE 12/28/99 9/30/99 1/27/99 10/2/98	SCALE 1" = 40'	DESIGN H.L.E.	DRAWN