

GENERAL NOTES

- All necessary conduit installations shown on print.
- Developer to furnish and install all conduit as shown on print.
- Texas Power and Light to furnish cable markers.
- Developer to install 1 (one) cable marker at each end of conduit.
- All conduit to be Schedule 40 and minimum of 2" in diameter. (Unless otherwise noted.)
- Each conduit must be buried a minimum of 40" deep (after land is brought to final grade).
- Each conduit must have a pull wire installed and be capped at both ends.
- It shall be the responsibility of the Developer to obtain inspection and approval of conduit installation from Texas Power and Light.

===== PROPOSED CONDUIT
(AS PER T.P.&L.)

SANITARY SEWER SYSTEM SUMMARY

MANHOLE	FROM	TO	RESIDENTIAL FLOW		Commercial or Industrial Point Source Flow Average Flow (gpm)	Peak Infiltration/Inflow (gpm)	Total Design Flow Maximum Wet-Weather Day (gpm)	
			AVERAGE DRY-DAY FLOW (gpm)	MAXIMUM DRY-DAY FLOW (gpm)				
4435.0 Ln-B	0400 Ln-B	4 lots	11.20	0.78	1.90	—	0.05	1.95
2171.24 Ln-A	2408.73 Ln-A	14 Ex. lots	39.20	2.70	6.80	—	0.01	6.81
2108.73 Ln-A	1471.12 Ln-A	14 Ex. lots	42.0	2.90	7.30	—	0.01	7.31
1417.12 Ln-A	0400 Ln-A	21 Ex. lots	58.80	4.10	10.20	—	0.01	10.21
2466.70 Ln-B	1450.46 Ln-B	32 Ex. lots	89.60	6.20	15.60	—	0.01	15.61
5495 Ln-D	3442.04 Ln-D	4 lots	11.20	0.78	1.90	—	0.02	1.92
3442.04 Ln-D	1450.46 Ln-D	44 Ex. lots	22.40	1.60	3.90	—	0.04	3.94
4445 Ln-E	0400 Ln-E	7 lots	19.00	1.40	3.40	—	0.05	3.45
1450.46 Ln-C	1100 Ln-C	32 Ex. lots	131.60	9.10	22.80	—	0.02	22.82
5490 Ln-F	2456.40 Ln-F	4 lots	11.20	0.78	1.90	—	0.04	1.94
1450.46 Ln-F	1450.46 Ln-F	44 Ex. lots	22.40	1.60	3.90	—	0.03	3.93
2422.40 Ln-G	0400 Ln-G	47 Ex. lots	162.40	11.30	28.20	—	0.03	28.23
2400 Ln-H	0400 Ln-H	4 lots	11.20	0.78	1.90	—	0.03	1.93
0400 Ln-G	TO EX. SAN. SEW.	58 Ex. lots	173.60	12.06	30.10	—	0.01	30.11

General Notes

- Where water pipelines either cross or otherwise come within 9 feet of a Sanitary Sewer Pipeline the sewer pipeline shall be either cast iron or PVC pipe with a minimum working pressure class of 150 PSI.
- It shall be the responsibility of the contractor to locate and verify all existing utilities prior to the beginning of construction to insure no conflicts between all utility lines.

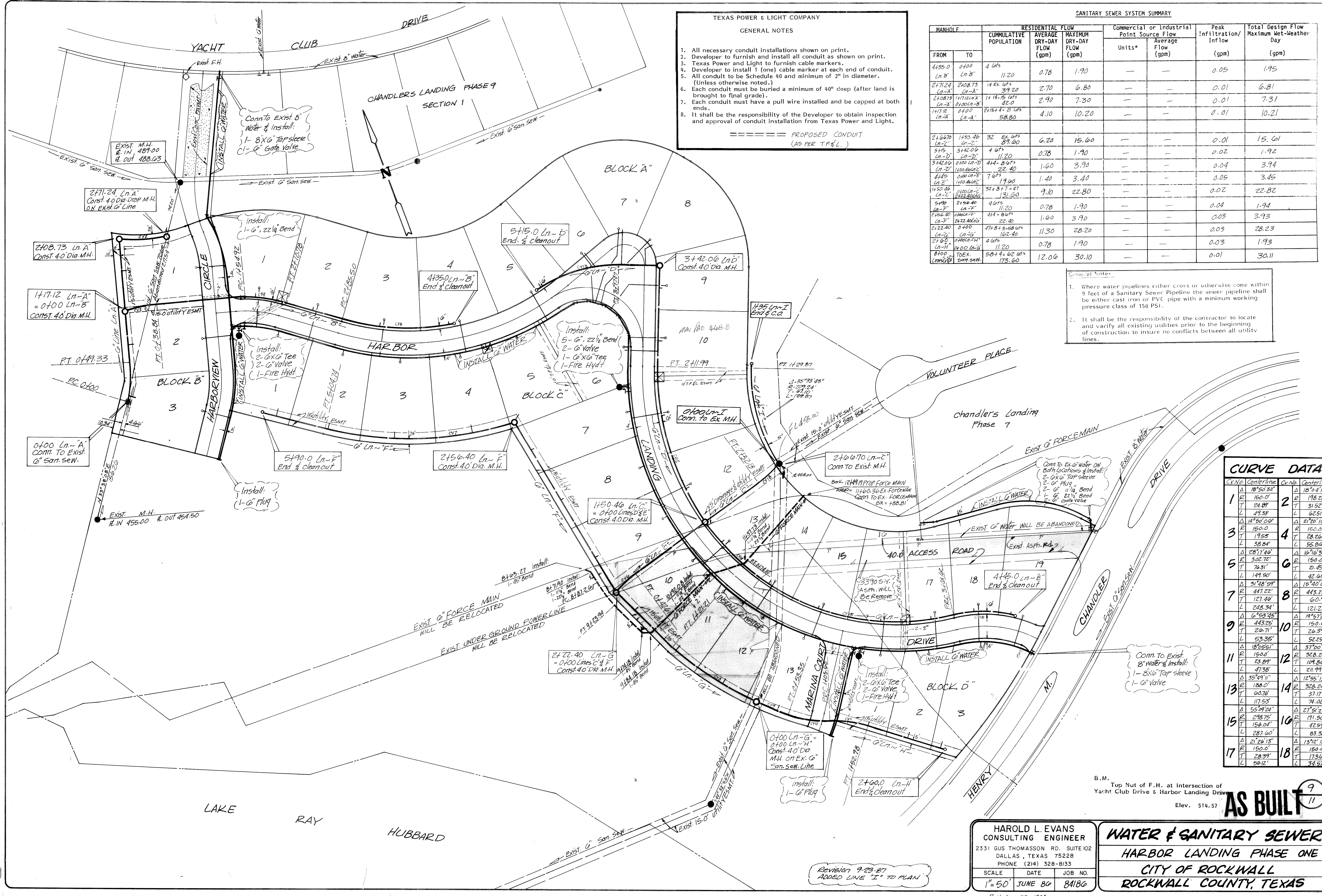

CURVE DATA

Cv No.	Centerline	Cv No.	Centerline
1	18°50'32"	2	18°24'14"
R 150.0'		R 198.25'	
T 24.89'		T 31.52'	
L 49.33'		L 62.51'	
3	14°50'00"	4	21°20'10"
R 150.0'		R 150.0'	
T 19.55'		T 28.26'	
L 38.84'		L 55.86'	
5	28°17'40"	6	16°06'36"
R 302.70'		R 150.0'	
T 76.51'		T 21.45'	
L 149.50'		L 42.61'	
7	51°48'59"	8	15°40'05"
R 447.22'		R 443.25'	
T 121.46'		T 60.99'	
L 248.34'		L 121.21'	
9	6°53'45"	10	19°57'29"
R 443.25'		R 150.0'	
T 20.71'		T 26.39'	
L 53.35'		L 52.25'	
11	18°26'51"	12	37°00'14"
R 150.0'		R 328.24'	
T 23.89'		T 109.84'	
L 47.38'		L 211.99'	
13	35°49'11"	14	12°55'13"
R 188.0'		R 328.24'	
T 60.76'		T 37.17'	
L 117.53'		L 74.02'	
15	55°29'24"	16	27°51'22"
R 278.75'		R 171.50'	
T 156.04'		T 42.53'	
L 287.60'		L 83.38'	
17	21°26'18"	18	13°12'18"
R 150.0'		R 150.0'	
T 28.39'		T 17.56'	
L 50.12'		L 34.57'	

B.M. Top Nut of F.H. at Intersection of Yacht Club Drive & Harbor Landing Drive
Elev. 514.57

AS BUILT

HAROLD L. EVANS
CONSULTING ENGINEER
2331 GUS THOMASSON RD. SUITE 102
DALLAS, TEXAS 75228
PHONE (214) 328-8133

SCALE DATE JOB NO.
1"=50' JUNE 80 84186

WATER & SANITARY SEWER
HARBOR LANDING PHASE ONE
CITY OF ROCKWALL
ROCKWALL COUNTY, TEXAS

Revision 9-23-87
ADDED LINE "I" TO PLAN