

NOTES TO CONTRACTOR:

- CONTRACTOR TO CALL CITY FOR EX. UTILITIES LOCATIONS
- CONTRACTOR TO MAINTAIN EXISTING ROADWAY DITCHES
- CONTRACTOR TO USE BENCHMARKS SHOWN ON THESE PLANS
- CONTRACTOR TO PLACE FIRE LANE MARKING PER DETAIL ON CE-1.
- THERE SHALL BE NO OBSTRUCTION TO THE REQUIRED FIRE LANE INCLUDING GATES WITHOUT FIRE DEPARTMENT APPROVAL

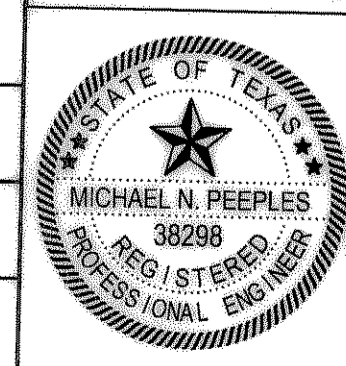
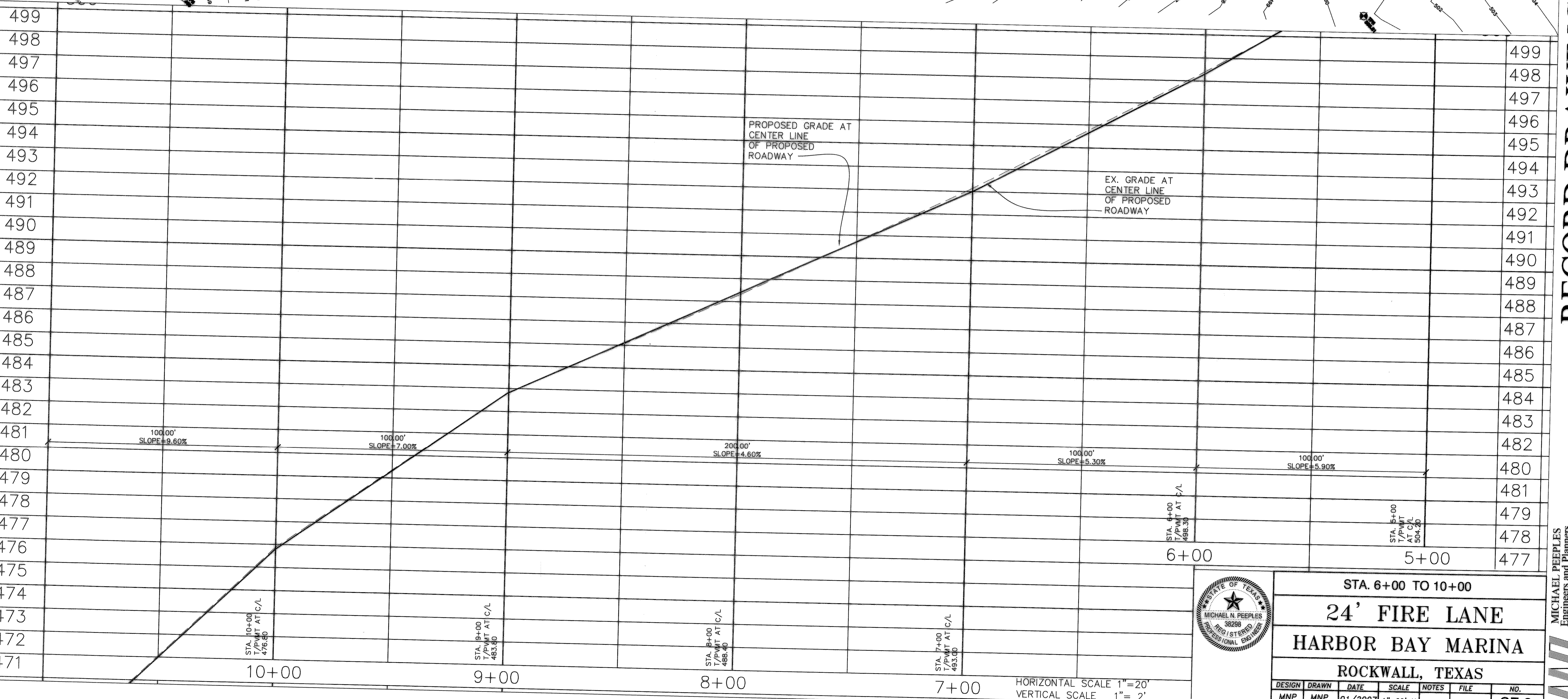
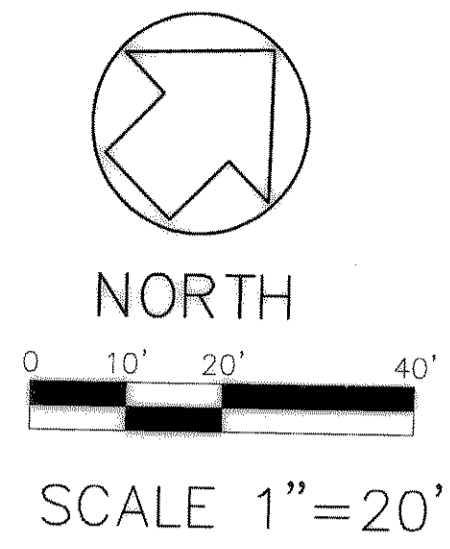

| | | | | | |
|--------------------------|-------|---------|----------|-------|------|
| STA. 6+00 TO 10+00 | | | | | |
| 24' FIRE LANE | | | | | |
| HARBOR BAY MARINA | | | | | |
| ROCKWALL, TEXAS | | | | | |
| DESIGN | DRAWN | DATE | SCALE | NOTES | FILE |
| MNP | MNP | 01/2007 | 1"=20' H | | |
| | | | | | NO. |
| | | | | | CE-2 |

RECORD DRAWING
 MICHAEL PEEPLES
 Engineers and Planners
 1930 E. ROSEMEADE #205 - CARROLLTON, TX 75007
 972-416-1968 (TEL) 214-731-9949 (FAX)
 Texas Firm No. F-3754