

NOTES TO CONTRACTOR:

- CONTRACTOR TO CALL CITY FOR EX. UTILITIES LOCATIONS
- CONTRACTOR TO MAINTAIN EXISTING ROADWAY DITCHES
- CONTRACTOR TO USE BENCHMARKS SHOWN ON THESE PLANS
- CONTRACTOR TO PLACE FIRE LANE MARKING ON ENTIRE LENGTH OF FIRELANE PER DETAIL ON CE-1.
- THERE SHALL BE NO OBSTRUCTION TO THE REQUIRED FIRE LANE INCLUDING GATES WITHOUT FIRE DEPARTMENT APPROVAL
- PLACE CONSTRUCTION/EXPANSION JOINTS MIN. 100' OC. SAWCUT JOINTS 15' OC±

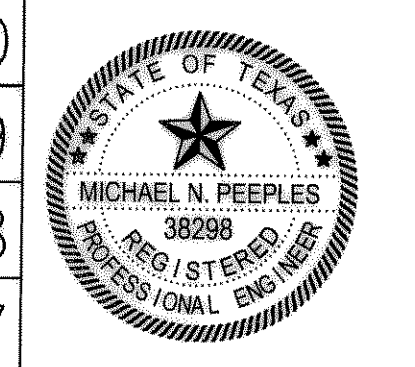
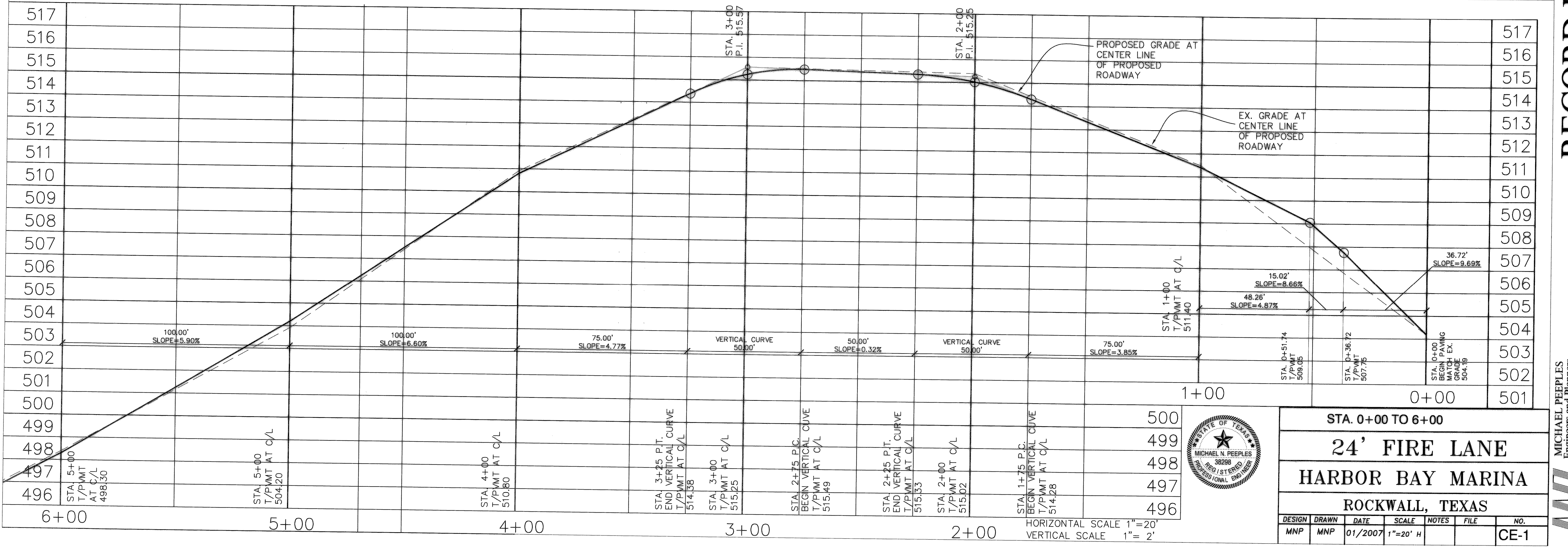
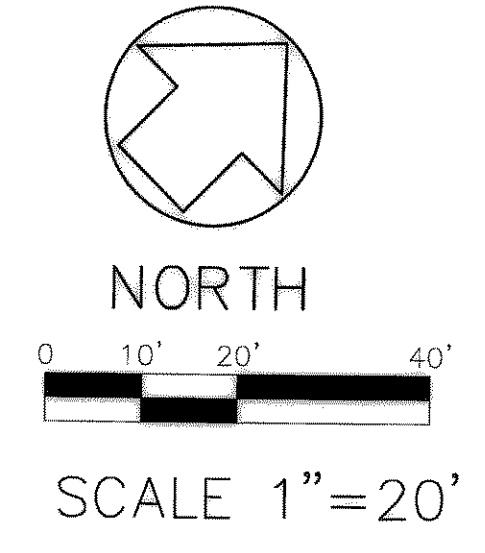

| | | | | | |
|--------------------------|-------|---------|----------|-------|----------|
| STA. 0+00 TO 6+00 | | | | | |
| 24' FIRE LANE | | | | | |
| HARBOR BAY MARINA | | | | | |
| ROCKWALL, TEXAS | | | | | |
| DESIGN | DRAWN | DATE | SCALE | NOTES | FILE NO. |
| MNP | MNP | 01/2007 | 1"=20' H | | CE-1 |

RECORD DRAWING
 MICHAEL PEEPLES
 Engineers and Planners
 1930 E. ROSEMEADE #205 - CARROLLTON, TX 75007
 972-416-1968 (TEL) 214-731-9949 (FAX)
 Texas Firm No. F-3754