

PROPOSED CONDITIONS

DRAINAGE AREA	AREA (acres)	C (coeff.)	C _p (coeff.)	t _c (min)	I100	O100
A	0.701	0.90	n/o	10	9.8	6.18
B	0.689	0.90	n/o	10	9.8	6.08
C	0.360	0.90	n/o	10	9.8	3.18

DRAINAGE NOTES:

- DRAINAGE AREA A FLOWS INTO NEW 10" CURB INLET AND 18" LATERAL RCP PIPE AS LOCATED, WHICH CONNECTS TO EXISTING INLET ON PROPERTY. THE EXISTING INLET WAS DESIGNED TO HOLD A DEVELOPED FLOW OF 8.31 cfs PER LA JOLLA POINTE ADDITION DEVELOPMENT PLANS BY ASA ENGINEERING DATED JANUARY 26, 2001. THE FLOW AS CALCULATED FOR PROPOSED CONDITIONS IS 6.18 cfs AND DOES NOT EXCEED THE EXISTING Q-DESIGN OF THE EXISTING STORM DRAIN SYSTEM.
- DRAINAGE AREA B FLOWS INTO NEW 10" CURB INLET AND 18" LATERAL RCP PIPE AS LOCATED, WHICH CONNECTS TO EXISTING INLET ON PROPERTY. THE EXISTING INLET WAS DESIGNED TO HOLD A DEVELOPED FLOW OF 6.12 cfs PER LA JOLLA POINTE ADDITION DEVELOPMENT PLANS BY ASA ENGINEERING DATED JANUARY 26, 2001. THE FLOW AS CALCULATED FOR PROPOSED CONDITIONS IS 6.08 cfs AND DOES NOT EXCEED THE EXISTING Q-DESIGN OF THE EXISTING STORM DRAIN SYSTEM.
- ALL RUNOFF CALCULATIONS SHOWN ARE BY RATIONAL METHOD. ABOVE CALCULATIONS MADE BY USING CITY OF ROCKWALL STANDARDS OF DESIGN AND CONSTRUCTION MANUAL.

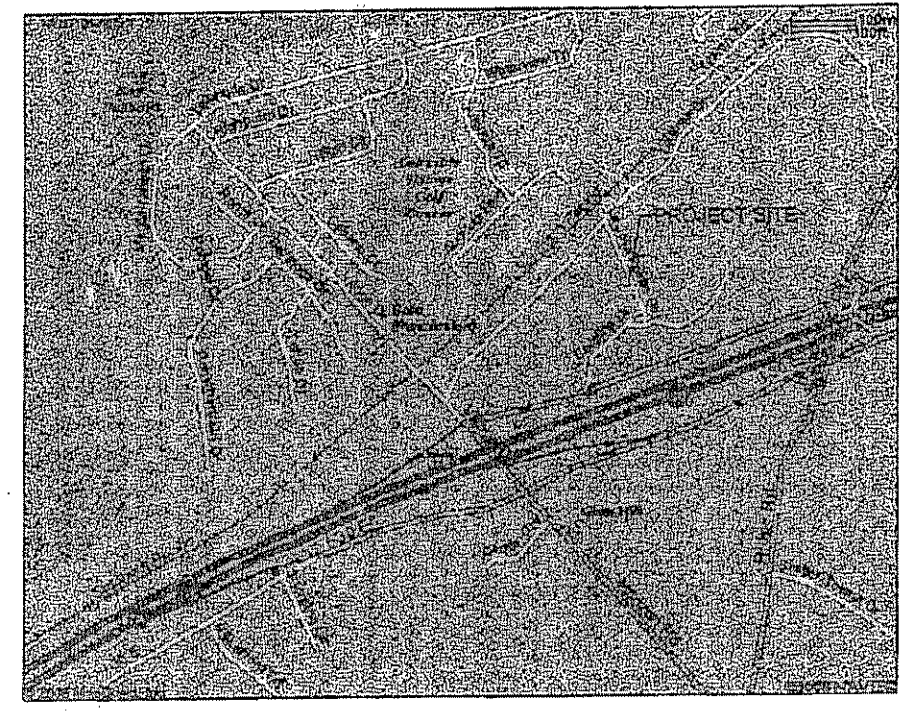

SITE MAP
SCALE: NONE

SITE BENCH MARK - FOUND BOX CUT TOP OF WEST CURB OF LAKESIDE DR. APPROX. 120-FT NORTH OF RAILROAD AT NW CORNER OF LA JOLLA POINTE ADDIT., PH II, ELEVATION = 503.23 CONTOURS ARE @ 1-FOOT INTERVALS TOPOGRAPHIC SURVEY FURNISHED BY ARTHUR SURVEYING CO., INC.

SITE BENCH MARK + 0.24' = CITY OF ROCKWALL GIS MONUMENT. BASED ON MONUMENTS R1, R6, AND M929, AS PUBLISHED IN THE CITY OF ROCKWALL SURVEY CONTROL BOOKLET. ALL ELEVATIONS SHOWN ON THESE PLANS ARE BASED ON OFF THE SITE BENCH MARK.

REVISIONS
REVISED ON 12-06-2006
& ON 01-08-2007
PER CITY COMMENTS

DEVELOPER: MR. KAVEN R. PATEL
6005 SILVERLEAF LANE
GARLAND, TEXAS 75043
(214) 629 - 2840

HAMPTON INN
LA JOLLA POINTE DRIVE, ROCKWALL, TX
LOT 7, BLOCK C
LA JOLLA POINTE ADDITION
CITY OF ROCKWALL, TEXAS

NOAKES ENGINEERING COMPANY, INC.
3603 W. PIONEER PKWY, STE B
ARLINGTON, TEXAS 76013
(817) 261-7900 FAX (817) 275-2154

FILE NO.
06-7194
SCALE
1" = 30'
SHEET NO.
C5.0

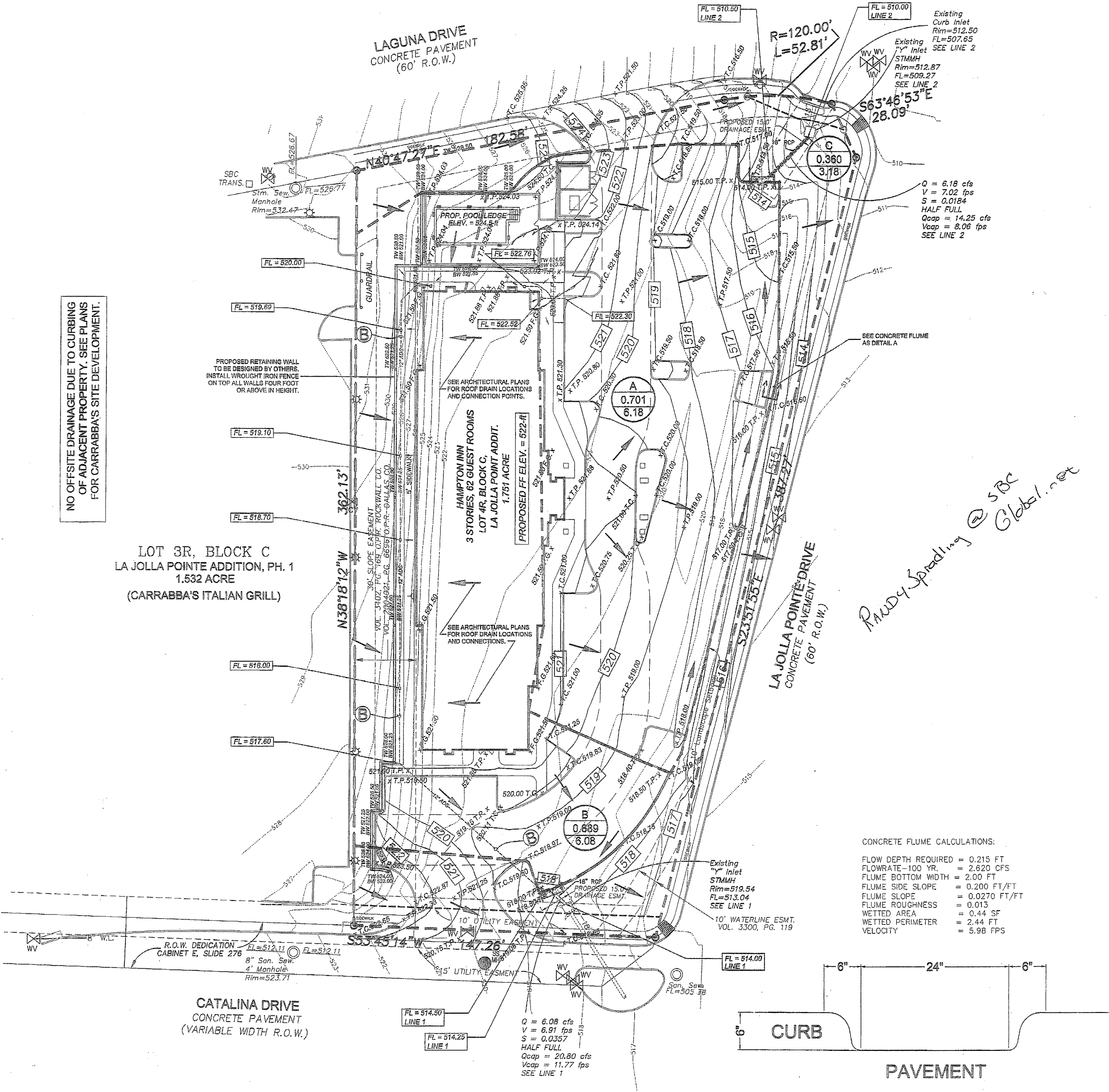

Randy Spreddy @ SBC Global.net

CONCRETE FLUME CALCULATIONS:
FLOW DEPTH REQUIRED = 0.215 FT
FLOWRATE-100 YR. = 2.620 CFS
FLUME BOTTOM WIDTH = 2.00 FT
FLUME SIDE SLOPE = 0.200 FT/FT
FLUME SLOPE = 0.0270 FT/FT
FLUME ROUGHNESS = 0.013
WETTED AREA = 0.44 SF
WETTED PERIMETER = 2.44 FT
VELOCITY = 5.98 FPS

PRIVATE ADS STORM DRAIN PIPE CALCULATIONS:
DIAMETER REQUIRED = 12 IN
FLOWRATE-100 YR. = 4.53 CFS
VELOCITY = 7.22 FPS
FLOWRATE-FULL/100 YR. = 5.817 CFS
PIPE SLOPE = 0.0170 FT/FT

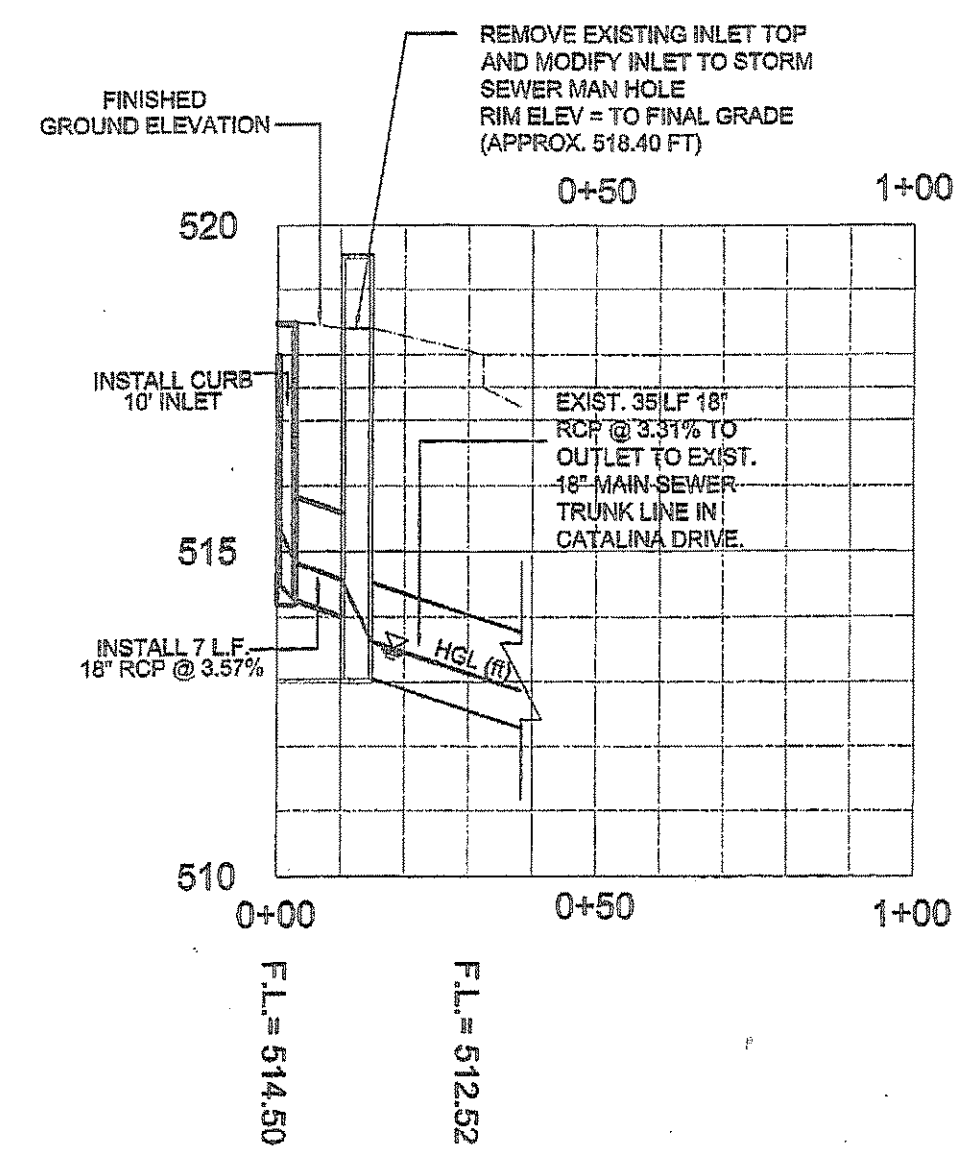

① LINE-1 PLAN PROFILE

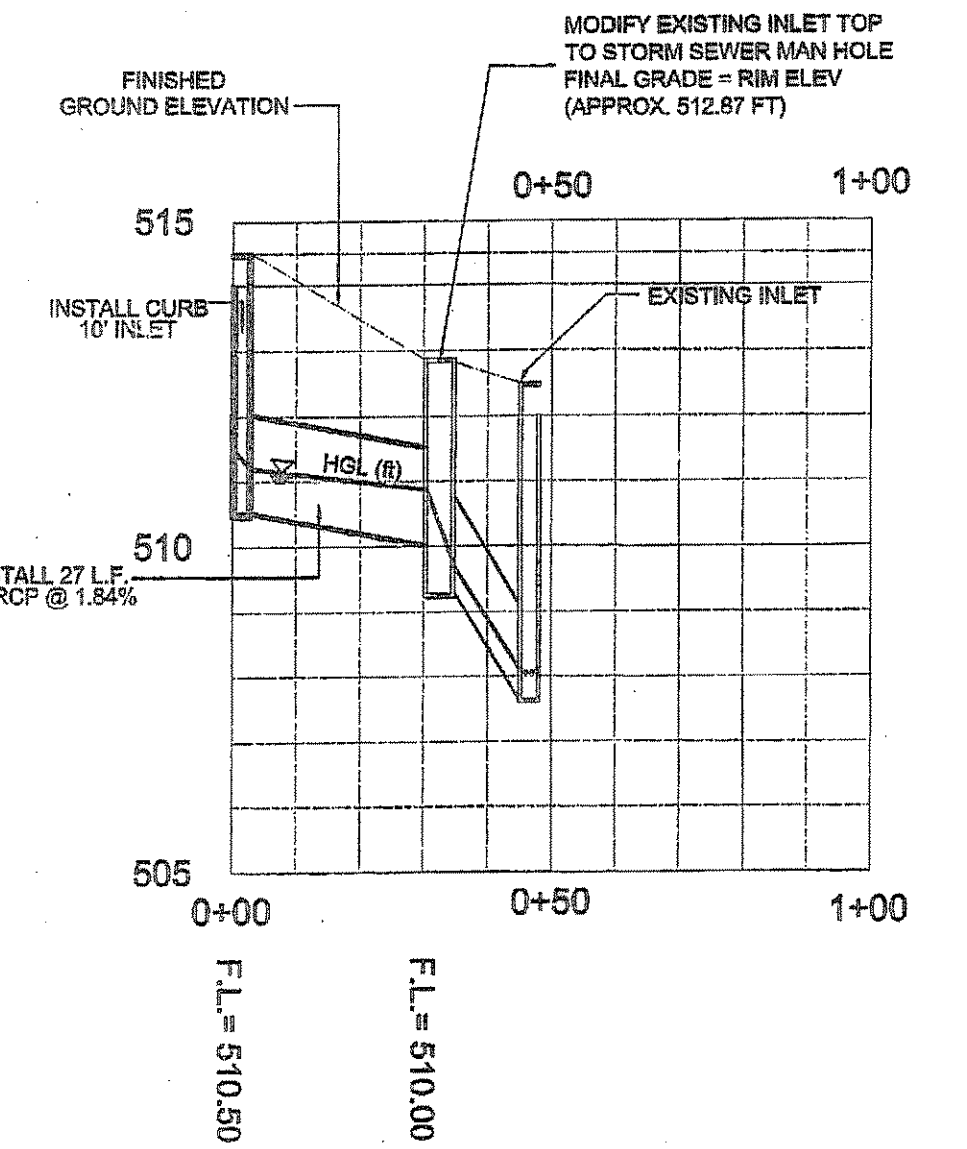

② LINE-2 PLAN PROFILE

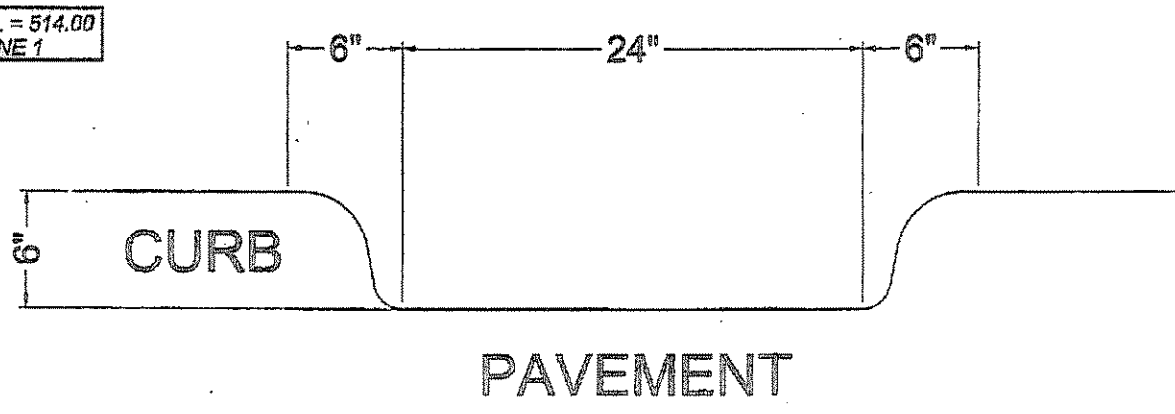

A CONCRETE FLUME

B PROPOSED STORM DRAIN PIPE (PRIVATE) (BEHIND PROPOSED BUILDING STRUCTURE)

C5 DRAINAGE / STORM SEWER PLAN

SCALE: 1" = 30'-0"

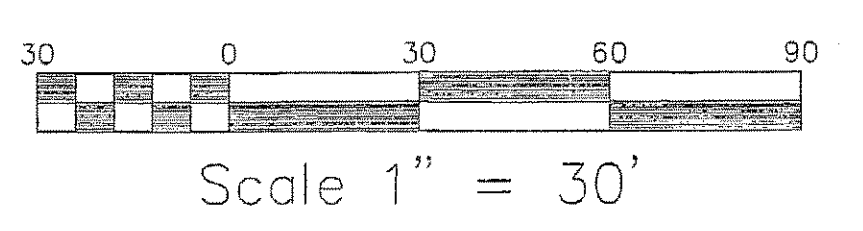

APPROVED FOR CONSTRUCTION
FEB. 14 2007

City of Rockwall Engineering Dept.
City Engineer

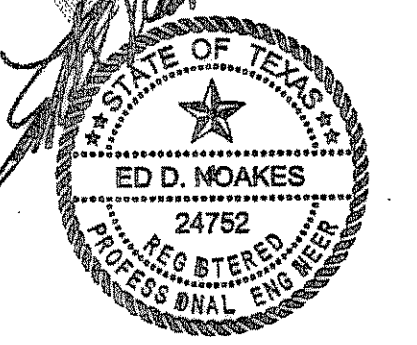

THE SEAL APPEARING ON THIS DOCUMENT WAS AUTHORIZED BY ED D. NOAKES, P.E. 24752 ON 9-30-2006

CONTRACTOR TO USE CITY OF ROCKWALL DETAILS TO BE OBTAINED AT TIME OF PERMITTING

CONTRACTOR TO CONTACT ALL UNDERGROUND UTILITY COMPANIES PRIOR TO BEGINNING OF ANY EXCAVATION WORK.

- x525.0
- 525 PROPOSED SPOT ELEV.
- 525 PROPOSED CONTOUR
- 525 PROPERTY LINE
- 525 EXISTING CONTOUR
- 525 DRAINAGE AREA BOUNDARY
- 525 DIRECTION OF FLOW
- 525 12"x12" SURFACE INLET
- B DRAINAGE AREA
- 0.689 AREA (acres)
- 6.08 Q₁₀₀

NO OFFSITE DRAINAGE DUE TO CURBING OF ADJACENT PROPERTY. SEE PLANS FOR CARRABBA'S SITE DEVELOPMENT.

LOT 3R, BLOCK C
LA JOLLA POINTE ADDITION, PH. 1
1.532 ACRE
(CARRABBA'S ITALIAN GRILL)

CATALINA DRIVE
CONCRETE PAVEMENT
(VARIABLE WIDTH R.O.W.)

LAGUNA DRIVE
CONCRETE PAVEMENT
(60' R.O.W.)

LA JOLLA POINTE DRIVE
CONCRETE PAVEMENT
(60' R.O.W.)