

7/21/99
BY ANPH INC.

ANPH, Inc. Architects and Planners 5499 Glen Lakes Drive Dallas, Texas 75231 (214)396-9086

ROCKWALL OFFICE/RETAIL
CITY OF ROCKWALL, TEXAS

JOB NO. 99-339
DRAWN BY
CHECKED BY
ISSUE DATE
10-25-99
REVISIONS
SHEET NUMBER
C7
SHEET OF

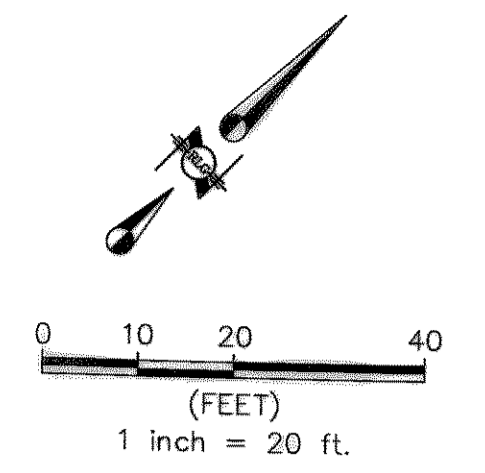

ISAAC BROWN'S LAND PARTITIONED TO HIS HEIRS
VOL. 1, PG. 57 & CAB. A, SL. 57

LOT 1, BLOCK A
ECKERD ADDITION
CAB. D, SL. 61-62

LOT 4A

LOT 3A

LOT 2A

LOT 1
BLOCK 1
53,786 (NET) SQ. FT. OR
1.2343 (NET) ACRES
13,500 S.F.
61 SPACES=223 S.F.
F.F.=564.00

0+00 LINE "S-1"=27+95 LINE "A"
MURPHY PLAZA PLANS
DATED 8/1/90
REMOVE EXIST CLEANOUT
CONST 4.0" DIA M.H. W/ INSIDE
DROP CONNECTION
FL 6" SS (IN) = 548.30
FL 6" SS (OUT) = 547.50

0+85.0 LINE "S-1"
CONST 4" DIA MH
FL 6" SS (IN) = 550.30
FL 6" SS (OUT) = 548.35

END & PLUG 6"
FIRE SERVICE
& 2" DOM SERVICE
5' FROM BLDG

1+62.0 LINE "A"
END & PLUG
6" SS 5' FROM BLDG
FL 6" SS = 558.00

INSTALL: 6" FIRE SERVICE
INSTALL: 1-8" 90° HORIZ BEND
1-8" x 6" REDUCER
1-6" VALVE
INSTALL: 2" DOM SERVICE
INSTALL: 2-6" 45° HORIZ BENDS

INSTALL: 1-6" 90° HORIZ BEND
1-6" VALVE
1-FH

INSTALL: 2" DOM SERVICE
(2" METER W/ BACKFLOW PREVENTER BY PLUMBER)
1-2" IRRIGATION SERVICE
(2" METER & BACKFLOW PREVENTER BY IRRIGATION CONTRACTOR)

INSTALL: 6" WATER
50'± TO 30'± W 124.52'

INSTALL: 1-8" x 6" TEE
1-6" VALVE
1-8" x 6" REDUCER
1-6" 22 1/2° HORIZ BEND

INSTALL: 1-16" x 8" TAP
(BY GIFFORD HILL AMERICAN)
1-8" VALVE
1-8" 1 1/4" HORIZ BEND

INSTALL: 1-8" x 6" TEE
1-6" x 6" TEE
2-6" VALVES

MURPHY PLAZA
CAB. C, SL. 79

RIDGE ROAD (F. M. ROAD NO. 740)
(VARIABLE RIGHT-OF-WAY)

NOTE: CONTRACTOR TO
FIELD VERIFY LOCATION
& ELEVATION PRIOR TO
CONSTRUCTION

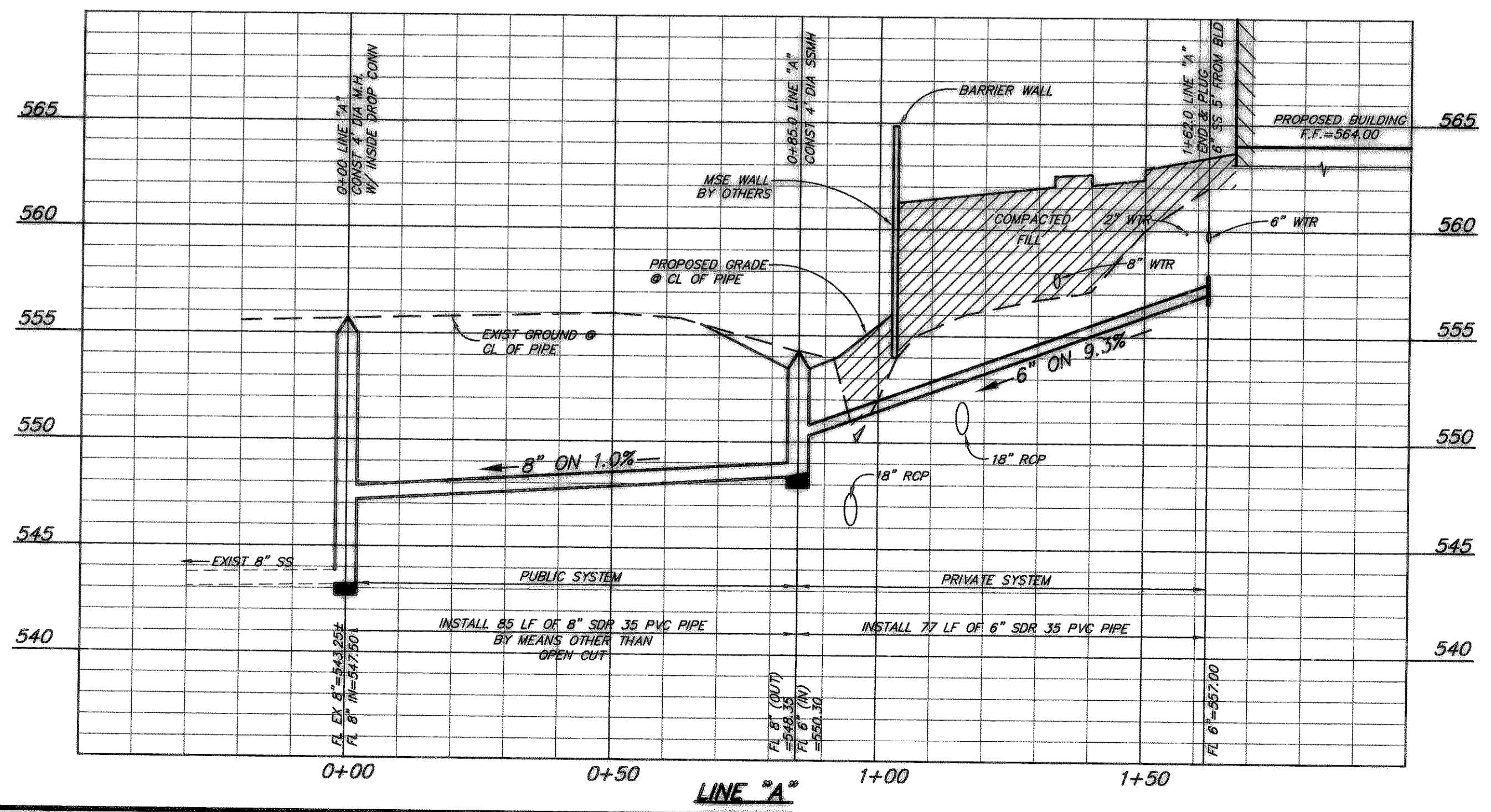

LEGEND

---	PROPERTY LINE	○	WATER MANHOLE
---	EASEMENT LINE	○	TELEPHONE MANHOLE
---	BUILDING	○	SANITARY SEWER MANHOLE
---	ASPHALT	○	STORM SEWER MANHOLE
---	CONCRETE	○	GAS MANHOLE
---	FENCE LINE	○	LIGHT STANDARD
---	8" SANITARY SEWER LINE	○	WATER VALVE
---	8" WATER LINE	○	WATER METER
---	8" W/IR	○	FIRE HYDRANT
---	EXISTING CONDUIT LINE	○	CLEAN OUT
---	OVERHEAD POWER	○	TELEPHONE PEDESTAL
---	EXISTING SPOT ELEVATION	○	IRRIGATION BOX
---	POWER POLE	○	TRAFFIC SIGNAL
---	GUY WIRE	○	TRAFFIC SIGNAL BOX
---	1/2" R/W ROD SET / FOUND	○	GAS METER
---	TREE	○	GAS VALVE
---	SIGN	○	BOLLARD

- UTILITY GENERAL NOTES
- All material and workmanship shall conform to the Standard Specifications for Public Works Construction for North Central Texas latest edition, and the City of Rockwall.
 - All water mains shall be PVC water pipe AWWA C-900 CLASS 200.
 - All 6" through 15" wastewater mains where PVC pipe is used as an alternate shall be ASTM 3034 (SDR-35) or ASTM F789/D3212.
 - The maximum allowable trench width for all pipe through 12" diameter shall be 32".

BENCHMARK #1
Top of sanitary sewer manhole at the northwest corner of Horizon Road and Ridge Road; 36 feet west of the point of reverse curvature on Horizon Road and 21 feet north of the back of curb. Elev. - 562.26

BENCHMARK #2
60d nail in power pole at the southwest corner of Ridge Road and Horizon Road, on Horizon Road 5 feet + or - off of back of curb. Elev. - 561.29

BENCHMARK #3
"I" in top center of 10 foot inlet on the south side of Horizon Road and 357 feet + or - west of west right-of-way of F.M. 740. Elev. - 557.32

CHAD SHING FANG
88314
9-12-00

ASBUILT
DATE: 9/12/00

WATER & SANITARY SEWER PLAN
SCALE: 1"=20'

RLG
RAYMOND L. GOODSON JR., INC.
CONSULTING ENGINEERS
SUITE 300, 5445 LA SIERRA DRIVE
DALLAS, TEXAS 75231 214/739-8100
RLG # 99339