

7/21/99
BY ANPH INC.

ANPH, Inc. Architects and Planners 5400 Glen Lakes Drive Dallas, Texas 75231 (214)265-9066

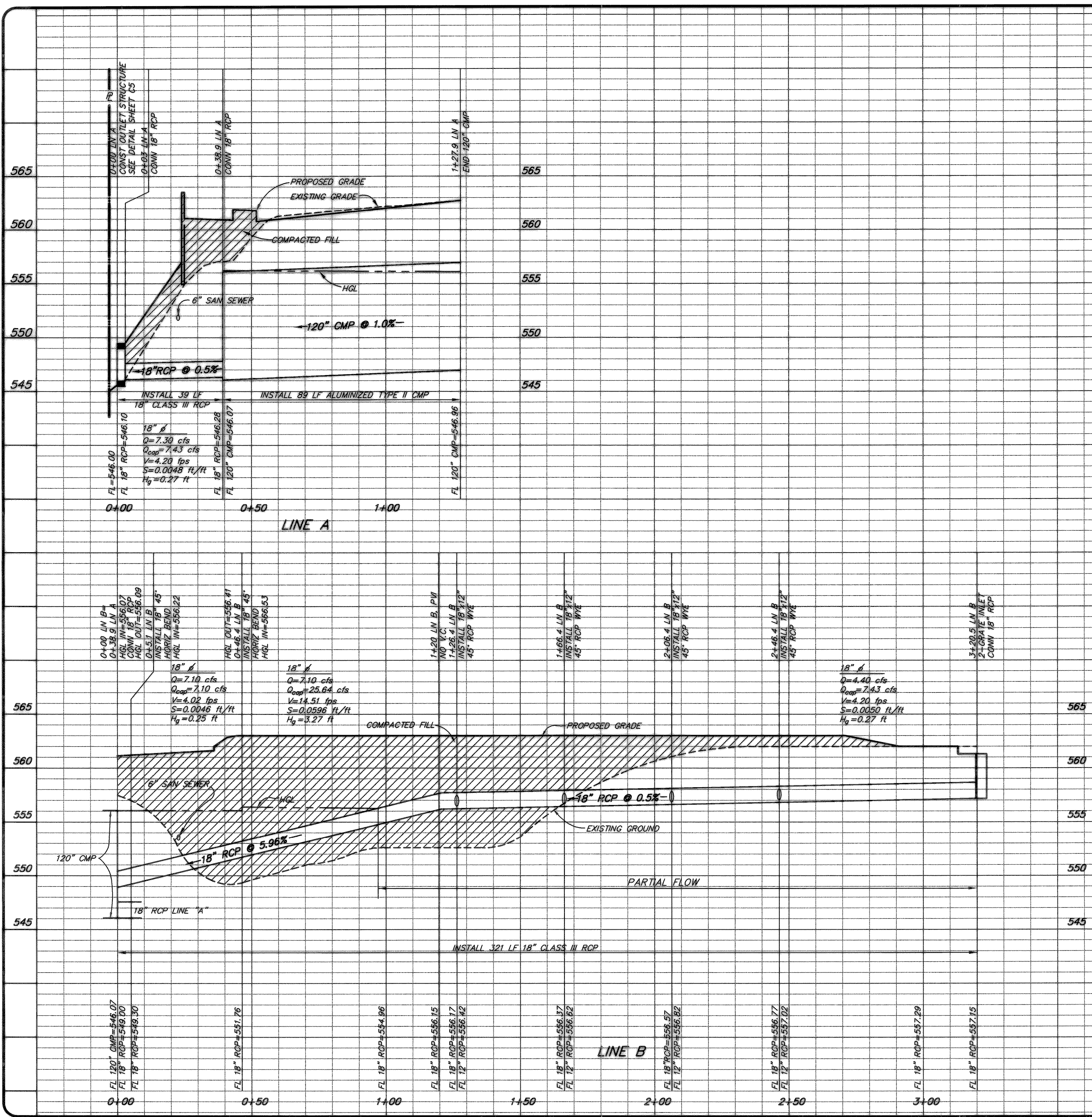

ROCKWALL OFFICE/RETAIL
CITY OF ROCKWALL, TEXAS



BENCHMARK #1
Top of sanitary sewer manhole at the northwest corner of Horizon Road and Ridge Road; 36 feet west of the point of reverse curvature on Horizon Road and 21 feet north of the back of curb. Elev. - 562.26

BENCHMARK #2
50d nail in power pole at the southwest corner of Ridge Road and Horizon Road, on Horizon Road 5 feet + or - off of back of curb. Elev. - 561.29

BENCHMARK #3
"C" in top center of 10 foot inlet on the south side of Horizon Road and 357 feet + or - west of west right-of-way of F.M. 740. Elev. - 557.32

ASBUILT
DATE: 9/12/02

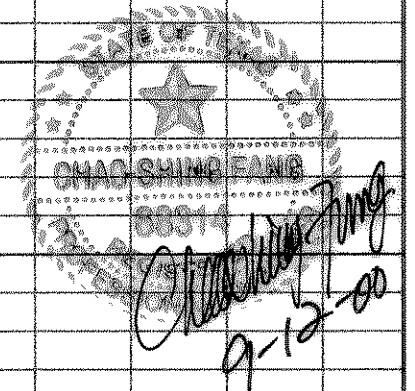

RLG
RAYMOND L. GOODSON JR., INC.
CONSULTING ENGINEERS
SUITE 300, 5445 LA SIERRA DRIVE
DALLAS, TEXAS 75241 214/709-8100
R.L.G. # 58339

STORM SEWER PROFILES
SCALE - H: 1"=20' V: 1"=5'

JOB NO. 99-339
DRAWN BY _____
CHECKED BY _____
ISSUE DATE 10-25-99
REVISIONS _____

SHEET NUMBER
C6
SHEET OF _____