

STORM DRAIN B2.1A
(STA 0+00.00 TO END)

STORM DRAIN B2.1B
(STA 0+00.00 TO END)

STORM DRAIN B2.3A
(STA 0+00.00 TO END)

STORM DRAIN B2.3B
(STA 0+00.00 TO END)

STORM DRAIN B2.2B
(STA 0+00.00 TO END)

HORIZ. SCALE: 1" = 40'
VERT. SCALE: 1" = 4'

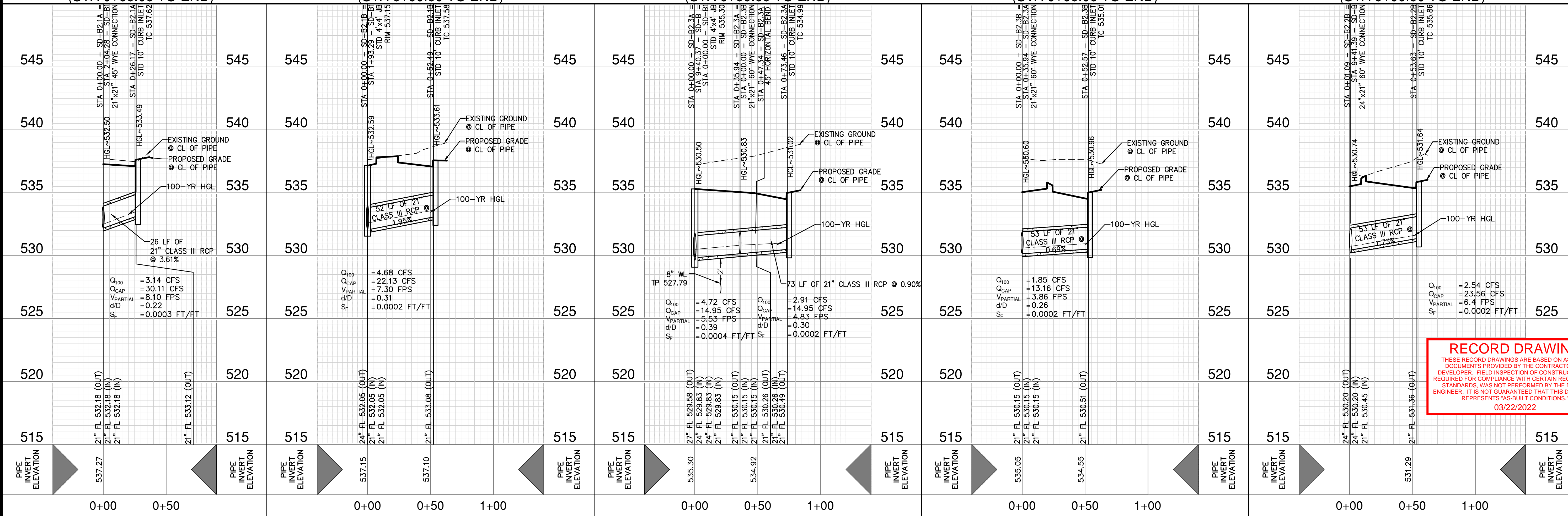

RECORD DRAWING
THESE RECORD DRAWINGS ARE BASED ON AS-BUILT DOCUMENTS PROVIDED BY THE CONTRACTOR OR DEVELOPER. FIELD INSPECTION OF CONSTRUCTION IS REQUIRED FOR COMPLIANCE WITH CERTAIN REGULATORY STANDARDS. WAS NOT PERFORMED BY THE DESIGN ENGINEER. IT IS NOT GUARANTEED THAT THIS DOCUMENT REPRESENTS AS-BUILT CONDITIONS.
03/22/2022

DATE: _____
NO. _____
REVISION _____

ADAM S. REEVES
98410
LICENSED PROFESSIONAL ENGINEER
6.8.2021

PAPE-PAWSON ENGINEERS
FORT WORTH | SAN ANTONIO | AUSTIN | HOUSTON | DALLAS
6500 W HWY. STE 700 | FT. WORTH, TX 76102 | 817.870.8668
TEXAS BOARD OF PROFESSIONAL ENGINEERS, FIRM REGISTRATION #470

STORM DRAIN B2.2A
(STA 0+00.00 TO END)

STORM DRAIN B3B
(STA 0+00.00 TO END)

STORM DRAIN B4A
(STA 0+00.00 TO END)

STORM DRAIN B4B
(STA 0+00.00 TO END)

STORM DRAIN B5A
(STA 0+00.00 TO END)

STORM DRAIN B5B
(STA 0+00.00 TO END)

HORIZ. SCALE: 1" = 40'
VERT. SCALE: 1" = 4'

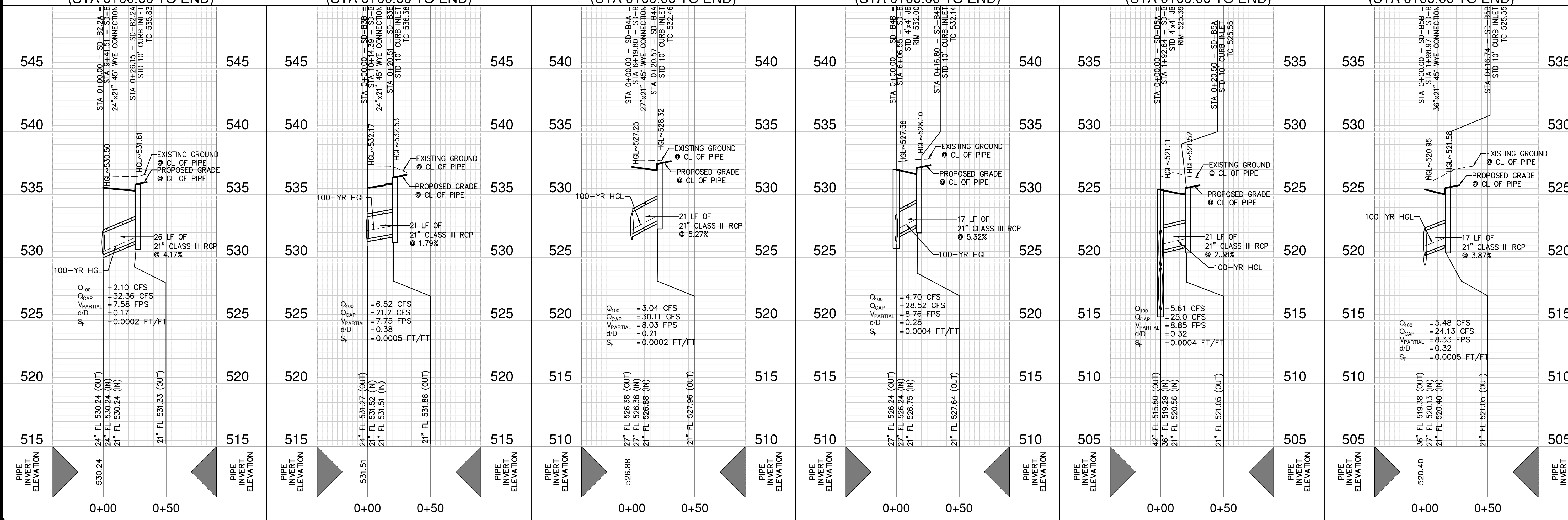

GIDEON GROVE - PHASE 2
CITY OF ROCKWALL, ROCKWALL COUNTY, TEXAS
STORM DRAIN B LATERAL PROFILES

PLAT NO. _____
JOB NO. 6126300
DATE June 21
DESIGNER ML
CHECKED ASR DRAWN TB
SHEET 14

Date: Jun 08, 2021, 8:52am User: P:\Engineering\Plan Sheets\Gideon Grove\2.4.3 Plan Sheets\SD-B-6126300.dwg

THIS DOCUMENT HAS BEEN PRODUCED FROM MATERIAL THAT WAS STORED AND/OR TRANSMITTED ELECTRONICALLY AND MAY HAVE BEEN INADVERTENTLY ALTERED. RELY ONLY ON FINAL HARD COPY MATERIALS BEARING THE CONSULTANT'S ORIGINAL SIGNATURE AND SEAL. AERIAL IMAGERY PROVIDED BY GOOGLE/© UNLESS OTHERWISE NOTED. Imagery © 2016, CAROL Digital Globe, Texas Orthographic Program, USDA Farm Service Agency.