

# GIDEON GROVE - PHASE 2

## CITY OF ROCKWALL, TEXAS

### CIVIL CONSTRUCTION PLANS

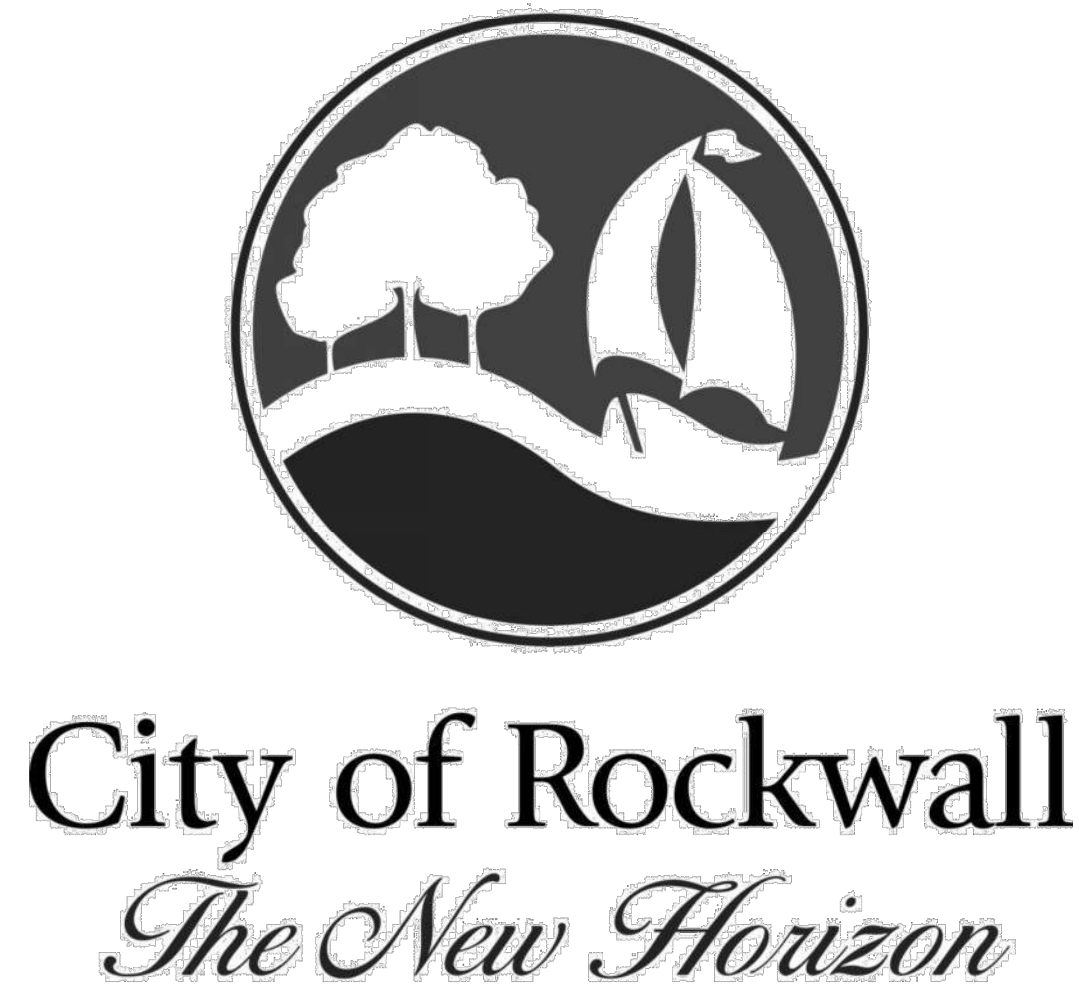

CONTAINING LOTS 1-12, 1X BLK A; LOTS 1-4, 1X, 3X, BLK B; LOTS 1-29, 1X, 18X, 23X, 27X, BLK C; LOTS 1-26, 1X, 14X BLK D; LOTS 1-13, 1X & 6X, BLK E FOR A TOTAL OF 84 SINGLE FAMILY LOTS AND 11 OPEN SPACE LOTS

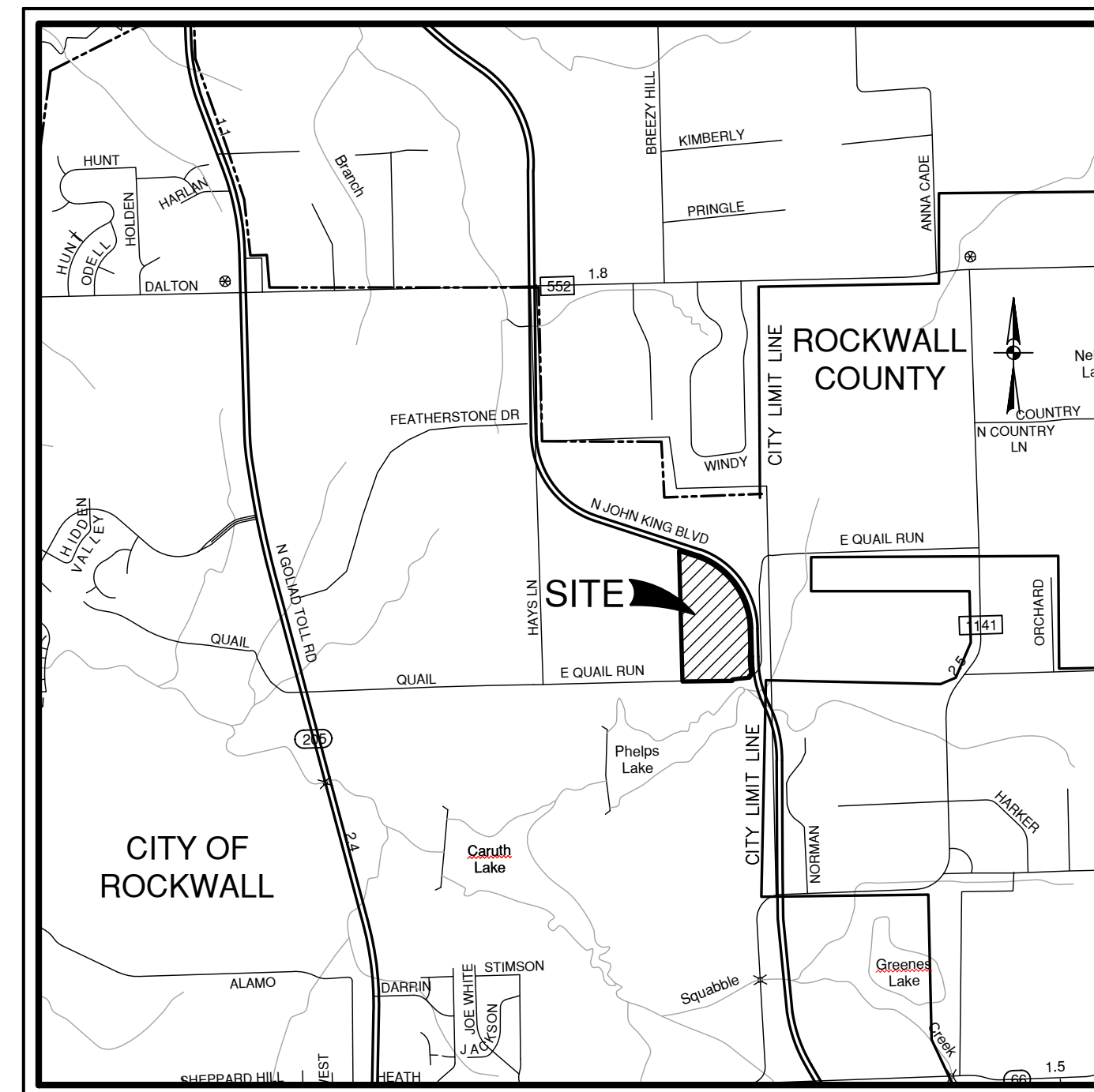

LOCATION MAP  
MAPSCO GRID REF: 200-A  
SCALE: 1" = 2000'

PREPARED FOR:  
**QUALICO COMMUNITIES**  
6950 TCP DRIVE, SUITE 350  
McKINNEY, TEXAS 75070  
CONTACT: JOHN VICK  
PHONE: 469-659-6150  
EMAIL: john.vick@qualico.com

June 2021



FORT WORTH | SAN ANTONIO | AUSTIN | HOUSTON | DALLAS  
6500 W FWY, STE 700 | FT. WORTH, TX 76102 | 817.870.3668  
TEXAS BOARD OF PROFESSIONAL ENGINEERS, FIRM REGISTRATION #470

#### SHEET INDEX

Sheet No	Sheet Description
1	COVER SHEET
2-3	FINAL PLAT
4	CONSTRUCTION NOTES
5	DEMOLITION PLAN
6	DRAINAGE AREA MAP - EXISTING
7	DRAINAGE AREA MAP - PROPOSED
8	HYDRAULIC CALCULATIONS
9	STORM DRAIN LINE A - PLAN AND PROFILE
10	STORM DRAIN LINE A - LATERAL PROFILES
11	STORM DRAIN LINE B - PLAN AND PROFILE 1 OF 2
12	STORM DRAIN LINE B - PLAN AND PROFILE 2 OF 2
13	STORM DRAIN LINE B1 & B2 - PLAN AND PROFILE
14	STORM DRAIN B - LATERAL PROFILES
15	STORM DRAIN LINE C - PLAN & PROFILE
16	STORM DRAIN LINE C2 - PLAN & PROFILE
16B	STORM DRAIN LINE C1 - PLAN & PROFILE (ULTIMATE CONDITION)
17	DETENTION POND
18	DETENTION POND OUTFALL
19	STORM DRAINAGE DETAILS (1)
20	STORM DRAINAGE DETAILS (2)
21	STORM DRAINAGE DETAILS (3)
22	E QUAIL RUN ROAD - PLAN AND PROFILE
23	RUBY WAY - PLAN AND PROFILE
24	SAPPHIRE ROAD - PLAN & PROFILE
25	OPAL DRIVE - PLAN AND PROFILE
26	GEM DRIVE - PLAN AND PROFILE
27	GEM DRIVE & JASPER STREET- PLAN AND PROFILE
28	PEBBLE LANE - PLAN AND PROFILE
29	JADE DRIVE - PLAN AND PROFILE
30	PAVING DETAILS
31	PAVING DETAILS
32	STREET LIGHT AND SIGNAGE PLAN
33	PAVEMENT MARKING DETAILS
34	WATER DISTRIBUTION PLAN 1 OF 2
35	WATER DISTRIBUTION PLAN 2 OF 2
36	WATER PLAN AND PROFILE
37	SANITARY SEWER PLAN 1 OF 2
38	SANITARY SEWER PLAN 2 OF 2
39	SANITARY SEWER PROFILES SS-1, SS-2, SS-3
40	SANITARY SEWER PROFILE SS-4
41	SANITARY SEWER PROFILE SS-5 & SS-6
42	GRADING PLAN - 1 OF 2
43	GRADING PLAN - 2 OF 2
44	OVERALL EROSION CONTROL PLAN
45	EROSION CONTROL DETAILS

#### ENGINEER'S NOTES TO CONTRACTOR:

- BY COMMENCING CONSTRUCTION, CONTRACTOR AFFIRMS THEY HAVE REVIEWED AND UNDERSTAND THE PLANS AND SPECIFICATIONS. ANY QUESTIONS AND DISCREPANCIES MUST BE ADDRESSED PRIOR TO COMMENCING CONSTRUCTION.
- ALL CONSTRUCTION SPECIFICATIONS WITHIN THE CITY RIGHTS-OF-WAY AND EASEMENTS SHOULD COMPLY WITH CITY OF ROCKWALL STANDARDS. PRIOR APPROVAL TO USE ANY NON-STANDARD MATERIAL IS REQUIRED.
- CONTRACTOR MUST VERIFY THE LOCATION OF ALL EXISTING UTILITIES PRIOR TO THE START OF CONSTRUCTION.
- CONTRACTOR MUST INSURE THAT ALL AREAS ARE GRADED TO DRAIN.
- CONTRACTOR MUST NOTIFY ENGINEER OF ANY DISCREPANCIES BETWEEN THESE PLANS AND ONSITE CONDITIONS.

THE DETENTION POND SHALL BE CONSTRUCTED BEFORE ANY OTHER CONSTRUCTION CAN BEGIN

#### STANDARDS NOTE

WITHIN THIS PLAN SET, THE TERM "CITY OF ROCKWALL STANDARDS" IS MEANT TO INCLUDE THE CITY OF ROCKWALL STANDARDS OF DESIGN AND CONSTRUCTION MANUAL, DATED OCTOBER 2016, AND THE PUBLIC WORKS CONSTRUCTION STANDARDS AND SPECIFICATIONS, NORTH CENTRAL TEXAS, 5TH EDITION, DATED OCTOBER 2017 - PUBLISHED BY THE NORTH CENTRAL COUNCIL OF GOVERNMENTS. CONTRACTOR SHALL REFER TO BOTH MANUALS PRIOR TO BEGINNING CONSTRUCTION.

#### RESPONSIBILITY NOTE

ALL RESPONSIBILITY FOR THE ADEQUACY OF DESIGN REMAINS WITH THE DESIGN ENGINEER. THE CITY OF ROCKWALL, IN REVIEWING AND RELEASING PLANS FOR CONSTRUCTION, ASSUMES NO RESPONSIBILITY FOR THE ADEQUACY OR ACCURACY OF DESIGN.

#### RECORD DRAWING

THESE RECORD DRAWINGS ARE BASED ON AS-BUILT DOCUMENTS PROVIDED BY THE CONTRACTOR OR DEVELOPER. FIELD INSPECTION OF CONSTRUCTION, IF REQUIRED FOR COMPLIANCE WITH CERTAIN REGULATORY STANDARDS, WAS NOT PERFORMED BY THE DESIGN ENGINEER. IT IS NOT GUARANTEED THAT THIS DOCUMENT REPRESENTS "AS-BUILT CONDITIONS."  
03/22/2022

#### REVISION TABLE

NO.	REVISION DESCRIPTION	DATE



Date: Jun 08, 2021, 4:17:41 AM, User: fb, Location: C:\Users\fb\Documents\Projects\2021\Gideon Grove\2.3 Plan Sheets\CS-6126300.dwg

PD JOB NO. 6126300 GIDEON GROVE - PHASE 2